

V. ITEMS FOR DISCUSSION

- a. Districtwide HVAC Air Filters, quote - \$47,511.93

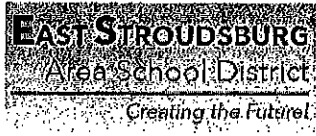

Scott Ihle <scott-ihle@esasd.net>

Form 611

1 message

Google Forms <forms-receipts-noreply@google.com>
To: scott-ihle@esasd.net

Thu, Aug 19, 2021 at 12:59 PM

Thanks for filling out Form 611

Here's what was received.

[Edit response](#)

Form 611

MUST BE COMPLETED FOR ANY PROCUREMENT OF A SERVICE OR ITEM
OVER \$5,000.00

Your email (scott-ihle@esasd.net) was recorded when you submitted this form.

Untitled Section

Untitled Section

FORM 611

EAST STROUDSBURG AREA SCHOOL DISTRICT

Procurement Form

Name of Requestor *

Scott Ihle

Untitled Title

Department *

Facilities

Building *

District wide

What service or item are you requesting *

HVAC Air Filters

Why are you requesting the service or item *

Preventative Maintenance

Suggested replacement *

Filters

Please complete an independent Cost Analysis. (Pre-determine costs prior to contacting a vendor.)

\$50,000

Cost Estimate: If over \$5,000, were three (3) quotes obtained? If yes, Please list the vendor's information and quoted amount. *

No

What is the total cost of the purchase? *

47,511.93

Procurement Method: *

Quote

Request for Proposal (RFP)

Bid

Other: _____

Was this purchase budgeted? *

Yes

Was this purchased through a PA State Contract or Approved Consortiums? If yes, select group.

- Yes
- Pennsylvania State Contract
- COSTARS
- Keystone Purchasing Network
- PEPPM National Contract Program (Technology Bidding and Purchasing)
- US Communities
- NO

If item was purchased through a Pa State Contract or approved Consortium, please include contract number.

Pennsylvania 008-481

Which Fund will be charged? *

10

What account will be charged *

2620-610-000-00-000-008

Selection of the winning proposal, was the lowest price selected? If not, please explain why and the process of selecting the vendor. *

Meler Supply Co./State Contract Participant

Any additional information you would like to provide.

This same purchase takes place 3x per year

[Create your own Google Form](#)

[Report Abuse](#)



Commonwealth of Pennsylvania
Department of General Services
Bureau of Procurement
355 Walnut Street, 6th Floor
Harrisburg, PA 17101-1914

Toll Free Telephone: 1-866-768-7827
Local Telephone: 717-346-9009
Fax: 717-783-6241
Email: GS-PACostars@state.pa.us
Website: www.costars.state.pa.us

Date: 10/28/2020

Meier Supply Inc.
Attn: Bill Spengler
374 Marcon BLVD STE. 120
Allentown, PA 18109

Subject: COSTARS Participation – Renewal Confirmation
Contract Number: 008-481 - Maintenance, Repair, & Operation Equipment & Supplies ("MRO")

Dear Contractor:

The Department of General Services, Bureau of Procurement, has received your payment of the \$1500.00 administrative fee required to renew your COSTARS participation for contract number 008-481. This will confirm that your company is authorized to continue to sell the awarded items/services under this contract to registered COSTARS members for the contract term 11/15/2017 through 11/15/2021 .

Thank you for your continued participation in the COSTARS Program. Should you have any questions, please contact COSTARS Program staff by email to GS-PACostars@pa.gov or toll-free telephone at 1.866.768.7827.

Regards,

David Gibson
(P): 717-346-2680
(F) :717-783-6241
E-Mail: davgibson@pa.gov



MEIER SUPPLY CO., INC.
 Phone: (807)797-7700 Fax: (807)797-4372
 www.MeierSupply.com

MEIER SUPPLY CORPORATE OFFICE
 275 Broome Corporate Parkway
 Conklin, NY 13748-1511

Branch: Stroudsburg

INVOICE

INVOICE DATE	INVOICE #	ACCOUNT NUMBER
7/27/21	2397709	101338
PLEASE SEND PAYMENTS TO:		
MEIER SUPPLY CO., INC. 275 Broome Corporate Parkway Conklin, NY 13748-1511		
ENROLLMENT TOKEN	QMP GBX VHL	

BILL TO:

EAST STROUDSBURG AREA SCH DIST
 ACCOUNTS PAYABLE
 50 VINE ST.
 E STROUDSBURG, PA 18301

SHIP TO:

EAST STROUDSBURG AREA SCH DIST
 ACCOUNTS PAYABLE
 50 VINE ST.
 E STROUDSBURG, PA 18301

20200803

District air filters

PO Number	Terms	Description	Net Due Date	Disc Due Date	Discount Amount		
DISTRICT WIDE FILTERS FEB 2021	Net 30		8/26/21				
Order Date	Order #	Primary Salesrep Name		Taker			
2/24/21	4675993	Jake Livingston		PSPERRAZZA			
Ordered QTY	Shipped QTY	Remaining QTY	Disp.	Item ID Item Description	UOM	Unit Price	Extended Price

Instructions: ALL INVOICES REQUIRE P.O. #'S

12	12	0		PREAIR 14X20X1 MERV 13 M1314201 M1314201	EA	7.2785	87.34
36	32	0		PREAIR 24X24X2 MERV 13 24X24X2 - MERV 13 M1324242	EA	18.0759	578.43
96	96	0		PREAIR 20X25X4 MERV 13 SP 20X25X4 MERV 13 SPECIALIST M1320254	EA	23.7722	2,282.13
216	216	0		PREAIR 20X20X2 M13 20X20X2 - MERV 13 M1320202	EA	13.0000	2,808.00
54	54	0		PREAIR 16X25X4 MERV13 M1316254 M1316254	EA	19.4810	1,051.97
90	90	0		PREAIR 16X20X4 MERV13 M1316204 M1316204	EA	16.7215	1,504.94
132	132	0		PREAIR 16X25X2 M13 16X25X2 - MERV 13 M1316252	EA	13.3165	1,757.78
612	84	0		PREAIR 16X20X2 M13 16X20X2 - MERV 13 M1316202	EA	10.9873	922.93
492	492	0		PREAIR 14X30X1 MERV13 M1314301	EA	12.1392	5,972.49

RECEIVED
 JUL 28 2021

RY:



MEIER SUPPLY CO., INC.
 Phone: (607)797-7700 Fax: (607)797-4372
 www.MeierSupply.com
 MEIER SUPPLY CORPORATE OFFICE
 275 Broome Corporate Parkway
 Conklin, NY 13748-1511

Branch: Stroudsburg

INVOICE

INVOICE DATE	INVOICE #	ACCOUNT NUMBER
7/27/21	2397709	101338
PLEASE SEND PAYMENTS TO:		
MEIER SUPPLY CO., INC. 275 Broome Corporate Parkway Conklin, NY 13748-1511		
ENROLLMENT TOKEN	QMP GBX VHL	

Ordered QTY	Shipped QTY	Remaining QTY	Disp.	Item ID Item Description	UOM	Unit Price	Extended Price
				M1314301			
288	288	0		PREAIR 14X24X1 MERV13 M1314241 M1314241	EA	12.0759	3,477.86
36	36	0		PREAIR 10X24X1 MERV13 M1310241 M1310241	EA	11.0759	398.73
24	24	0		PREAIR 14X20X1 MERV13 M1314201 M1314201	EA	7.2785	174.68
12	12	0		PREAIR 18X24X2 M13 18X24X2 MERV13 M1318242	EA	14.4051	172.86
12	12	0		PREAIR 12X24X1 MERV13 M1312241 M1312241	EA	7.1266	85.52
24	24	0		PREAIR 14X54X1 MERV13 M13SP14541 M13SP14541	EA	25.1519	603.65
48	48	0		PREAIR 14X66X1 MERV13 M13SP14661 M13SP14661	EA	28.0253	1,345.21
300	300	0		PREAIR 8.875X19.125X1 MERV13 M13SP8P18B1 M13SP8P19B1	EA	9.0253	2,707.59
60	60	0		PREAIR 8X24X1 MERV13 M13SP8241 M13SP8241	EA	9.0253	541.52
60	60	0		PREAIR 9X24X1 MERV13 M13SP9241 M13SP9241	EA	10.1519	609.11
156	153	0		PREAIR 10X28X1 MERV13 M13SP10281 M13SP10281	EA	11.1772	1,710.11
72	72	0		PREAIR 10X33X1 MERV13 M13SP10331	EA	12.5686	905.01

RECEIVED
 JUL 28 2021
 12:56 PM

BY: _____



MEIER SUPPLY CO., INC.
 Phone: (607)797-7700 Fax: (607)797-4372
 www.MeierSupply.com

MEIER SUPPLY CORPORATE OFFICE
 275 Broome Corporate Parkway
 Conklin, NY 13748-1511

Branch: Stroudsburg

INVOICE

INVOICE DATE	INVOICE #	ACCOUNT NUMBER
7/27/21	2397709	101338
PLEASE SEND PAYMENTS TO:		
MEIER SUPPLY CO., INC. 275 Broome Corporate Parkway Conklin, NY 13748-1511		
ENROLLMENT TOKEN	QMP GBX VHL	

Ordered QTY	Shipped QTY	Remaining QTY	Disp.	Item ID Item Description	UOM	Unit Price	Extended Price
				M13SP10331			
108	108	0		PREAIR 9X33X1 MERV13 M13SP9331 M13SP9331	EA	11.1772	1,207.14
24	24	0		PREAIR 14X42X1 MERV13 M13SP14421 M13SP14421	EA	22.3544	536.51
132	132	0		PREAIR 8.875X42.125X1 MERV13 M13SP8P42B1 M13SP8P42B1	EA	18.0506	2,382.68
36	36	0		PREAIR 15X66X1 MERV13 M13SP15661 M13SP15661	EA	28.0253	1,008.91
204	204	0		PREAIR 14X78X1 MERV13 M13SP14781 M13SP14781	EA	30.0506	6,130.32
180	180	0		PREAIR 16X78X1 MERV13 M13SP16781 M13SP16781	EA	32.3038	5,814.68
12	12	0		PREAIR 12X24X2 M13 12X24X2 - MERV 13 M1312242	EA	8.8481	106.18
24	24	0		PREAIR 15X41.5X1 M13 15 X 41.5 X 1 M13 M13SP1541H1	EA	26.1519	627.65

Total Lines: 29

Sc

SUB-TOTAL: 47,511.93
 TAX: 0.00
 AMOUNT DUE: 47,511.93

RECEIVED
 JUL 28 2021
 BY: [Signature]

NY Locations

Albany
 Binghamton
 Buffalo
 Middletown
 Rochester
 Syracuse
 Utica

PA Locations

Allentown
 Alloua
 Erie
 Hanover
 Harrisburg
 Scranton
 Stroudsburg
 Wilkes-Barre
 Williamsport

Shipment Accepted By:
 JEAN JOSEPH

See Reverse for branch phone, address, terms and conditions.

V. ITEMS FOR DISCUSSION

b. Portable Toilets for Athletic Fields, quote - \$8,640.00

Form 611

MUST BE COMPLETED FOR ANY PROCUREMENT OF A SERVICE OR ITEM OVER \$5,000.00

The respondent's email (**elizabeth-kolcun@esasd.net**) was recorded on submission of this form.

Untitled Section

Untitled Section

FORM 611

EAST STROUDSBURG AREA SCHOOL DISTRICT

Procurement Form

Name of Requestor *

Lisa Kolcun

Untitled Title

Department *

Athletics

Building *

Administration

What service or item are you requesting *

Portable toilet rentals for Athletic fields

Why are you requesting the service or item *

Outdoor restrooms are needed for athletes and spectators

Suggested replacement *

none

Please complete an independent Cost Analysis. (Pre-determine costs prior to contacting a vendor.)

Cost Estimate: If over \$5,000, were three (3) quotes obtained? If yes, Please list the vendor's information and quoted amount. *

Gotta Go Potties \$960 per month for 9 months

What is the total cost of the purchase? *

\$8640 for 2 high schools and 2 intermediate schools

Procurement Method: *

- Quote
- Request for Proposal (RFP)
- Bid
- Other:

Was this purchase budgeted? *

Yes ▼

Was this purchased through a PA State Contract or Approved Consortiums? If yes, select group.

- Yes
- Pennsylvania State Contract
- COSTARS
- Keystone Purchasing Network
- PEPPM National Contract Program (Technology Bidding and Purchasing)
- US Communities
- NO

If item was purchased through a Pa State Contract or approved Consortium, please include contract number.

Which Fund will be charged? *

10 ▼

What account will be charged *

- 10-3250-442-000-30-820-550-000-5000
- 10-3250-442-000-30-819-550-000-5000
- 10-3250-442-000-20-517-550-000-5000
- 10-3250-442-000-20-518-550-000-5000

Selection of the winning proposal, was the lowest price selected? If not, please explain why and the process of selecting the vendor. *

yes

Any additional information you would like to provide.

This form was created inside of East Stroudsburg Area School District.



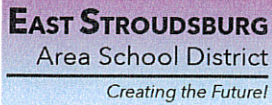

Craig Neiman <craig-neiman@esasd.net>

Fwd: Website Inquiry

1 message

Lisa Kolcun <elizabeth-kolcun@esasd.net>

Thu, Aug 26, 2021 at 1:51 PM

To: Craig Neiman <craig-neiman@esasd.net>, Diane Kelly <diane-kelly@esasd.net>, Denise Rogers <denise-rogers@esasd.net>, Charles Dailey <charles-dailey@esasd.net>

Here is the second quote for the porta-potty 611 form. I did request a 3rd quote from a company called On Site and have not heard anything back from them.

Lisa

----- Forwarded message -----

From: **Mandy Hower** <portables@allstatesepctic.com>

Date: Thu, Aug 26, 2021 at 12:56 PM

Subject: RE: Website Inquiry

To: elizabeth-kolcun@esasd.net <elizabeth-kolcun@esasd.net>

Hi Lisa,

My name is Linda and I'm filling in for our portable restroom division manager while she's on vacation this week. I received your inquiry.

Pricing for your units are as follows : 4 Regular units with Hand Sanitizer @ 175./unit = \$700 and with tax = \$742.

4 Handicap with Hand Sanitizer @ \$210 / unit = \$840 and with tax = \$890.40

The monthly total would be \$1632.40 w/tax and \$1540. If you're tax exempt. If you are tax exempt you would need to forward a copy of your tax exemption certificate so we can keep on file.

The price includes delivery, pick up and once a week cleaning on each unit. Payment is due at time of delivery which can be cash, check or credit card.

I need to know what day in September you wanted delivery of these units and need to know placement at each location and a contact name and phone # if we have any issues with units while there.

Thanks,

Linda Hill

From: Bruce Fox
Sent: Tuesday, August 24, 2021 2:44 PM
To: Mandy Hower <portables@allstatesepctic.com>
Subject: FW: Website Inquiry

Bruce E. Fox
Partner
Allstate Septic Systems, LLP
800-858-3111

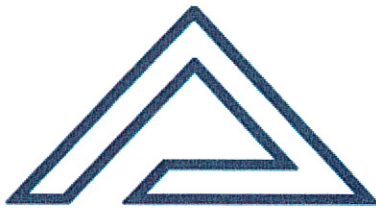

It is our mission to consistently exceed our customers' expectations, and we are committed to providing first-class service while ensuring there is no harm to the environment.

From: mailer@multiscreensite.com <mailer@multiscreensite.com> **On Behalf Of** form-processor
Sent: Tuesday, August 24, 2021 2:18 PM
To: Bruce Fox <bfox@allstatesepctic.com>; lutzkomarketing@gmail.com
Subject: Website Inquiry

Form Response Notification

The following form has been submitted from your website - <http://www.allstatesepctic.com>.

Name: Lisa
Address: [50 Vine Street, East Stroudsburg PA 18301](#)
Email: elizabeth-kolcun@esasd.net
Phone: 570-424-8500 X10501
Services Needed Check One: Portable Restrooms

Message: I am requesting a quote to be emailed to me for portable restrooms for three different locations in our school district. I would need 1 portable unit, 2 handicap units for our South Campus ([279 N Courtland Street, East Stroudsburg](#)), 1 handicap unit for J.T. Lambert Intermediate ([2000 Milford Rd, East Stroudsburg](#)) and 3 portable units and 1 handicap unit for our North Campus (279 Timberwolf Drive off of Bushkill Falls Rd, Bushkill) All units would need hand sanitizer. They would be on property from September until November 12, 2021 and then returned to the campuses March 1, 2022 to June 30, 2022. Thanks, Lisa

Reply to customer

--

Lisa Kolcun
District Athletic Secretary
Athletic Department
East Stroudsburg Area School District
50 Vine Street
East Stroudsburg PA 18301
elizabeth-kolcun@esasd.net
Twitter: @ESASDNORTHATH
Twitter: @ESASDSOUTHATH
570-424-8500 X10501
570-420-8387 (FAX)

"In times to come, when we are all gone, people not yet born will walk in the sunshine of their own days because of what women and men did at this hour to feed the sick, to heal and to comfort." - Jim Dwyer NYT

CONFIDENTIALITY NOTICE: This email message, including any attachments, is for the sole use of the intended recipient(s) and contains confidential and privileged information. Any unauthorized review, use, disclosure or distribution is prohibited. If you are not the intended recipient, please contact the sender by reply email, and destroy all copies of the original message.

GOTTA GO POTTIES, INC.

205 ROUTE 196
TOBYHANNA, PA 18466

Phone #	570-894-8690
Fax #	570-839-5378



Name / Address
E. STROUDSBURG AREA SCHOOL DISTRICT 50 VINCE ST EAST STROUDSBURG, PA 18301

Quote Date	8/11/2021	Terms		Estimate #	841
Rental Date		Project			
Description		Qty	Rate	Total	
SOUTH CAMPUS					
1-PORTABLE TOILET RENTAL WITH HAND SANITIZER		1	100.00	100.00	
1-HANDICAP UNIT RENTAL WITH HAND SANITIZER		2	140.00	280.00	
JTL CAMPUS					
1-HANDICAP UNIT RENTAL WITH HAND SANITIZER		1	140.00	140.00	
NORTH CAMPUS					
1-PORTABLE TOILET RENTAL WITH HAND SANITIZER		3	100.00	300.00	
1-HANDICAP UNIT RENTAL WITH HAND SANITIZER		1	140.00	140.00	
PRICE INCLUDES WEEKLY SERVICE WITH RESTOCKING OF SUPPLIES.					

Book your luxury restroom trailer with us today! Perfect for any wedding, graduation, party, or event that needs one step up from a portable unit. Call today and refer to this estimate and we'll waive the delivery fee!

Subtotal	\$960.00
Sales Tax (6.0%)	\$0.00
Total	\$960.00

Email	gottagornd@outlook.com	gottagoteam@outlook.com
--------------	------------------------	-------------------------

V. ITEMS FOR DISCUSSION

- c. Ice Machine for Lehman Athletics, quote - \$7,074.00

Form 611

MUST BE COMPLETED FOR ANY PROCUREMENT OF A SERVICE OR ITEM OVER \$5,000.00

The respondent's email (**elizabeth-kolcun@esasd.net**) was recorded on submission of this form.

Untitled Section

Untitled Section

FORM 611

EAST STROUDSBURG AREA SCHOOL DISTRICT

Procurement Form

Name of Requestor *

Christopher Rossi

Untitled Title

Department *

Lehman Athletics

Building *

Lehman

What service or item are you requesting *

Ice Machine for Lehman Athletics

Why are you requesting the service or item *

The current machine is broke and not able to be repaired

Suggested replacement *

Manitowoc iYT 1200W-261 water-cooled, 230V, 1ph and Manitowoc D-570 storage bin

Please complete an independent Cost Analysis. (Pre-determine costs prior to contacting a vendor.)

Cost Estimate: If over \$5,000, were three (3) quotes obtained? If yes, Please list the vendor's information and quoted amount. *

Commercial Refrigeration #5228

What is the total cost of the purchase? *

\$7047.00

Procurement Method: *

Quote

Request for Proposal (RFP)

Bid

Other:

Was this purchase budgeted? *

No ▼

Was this purchased through a PA State Contract or Approved Consortiums? If yes, select group.

Yes

Pennsylvania State Contract

COSTARS

Keystone Purchasing Network

PEPPM National Contract Program (Technology Bidding and Purchasing)

US Communities

NO

If item was purchased through a Pa State Contract or approved Consortium, please include contract number.

PAOAGHIC REG #004313 PENNA COSTARS 36-11

Which Fund will be charged? *

10

What account will be charged *

10-3250-762-000-20-518-550-000-5000

Selection of the winning proposal, was the lowest price selected? If not, please explain why and the process of selecting the vendor. *

Commercial Refrigeration is COSTARS and we ordered the North ice machine from them

Any additional information you would like to provide.

We maybe could get reimbursed from St. Luke's since this is for the athletic trainers to use

This form was created inside of East Stroudsburg Area School District.

Google Forms

SALES AGREEMENT
COMMERCIAL REFRIGERATION OF HARRISBURG, INC.
 7841 Witmer Drive Harrisburg, Pennsylvania 17111
Phone (717) 564-2034 Fax (717) 564-4540
 PAOAGHIC Reg. # 004313 PENNA. COSTARS 36-11
 www.crhinc.com



PROPOSAL SUBMITTED TO Lisa Kolcun, District Athletic Secretary	PHONE (570) 424-8500 X 10501	EMAIL Elizabeth-kolcun@esasd.net	DATE 8/20/2021	Page 1 of 1
---	---------------------------------	-------------------------------------	-------------------	-------------

JOB INFORMATION: EAST STROUDSBURG NORTH HIGH SCHOOL – ATHLETIC DEPARTMENT
ADDRESS: Bushkill Falls Road Bushkill, PA 18324

Commercial Refrigeration of Harrisburg, Inc. will provide the following equipment:

- (1) MANITOWOC iYT 1200W-261 water-cooled, 230v, 1ph (up to 1200# of ice per 24 hours)
- (1) MANITOWOC D-570 STORAGE BIN

PRICE \$7,047.00 TOTAL, DROPPED OFF IN CARTONS

EQUIPMENT WARRANTY:

3-YEARS MANITOWOC PARTS AND LABOR, PLUS 5 YEAR COMPRESSOR PART

LEAD TIME: MANITOWOC ESTIMATING 1 MONTH TO FILL BACKORDERS.

By others: Permits, inspections, applications and any associated fees.

PRICES GOOD FOR 15 DAYS FROM DATE OF QUOTATION. PRICES SUBJECT TO CHANGE AFTER THAT DATE DUE TO MARKET VOLATILITY. A SIGNED AGREEMENT WILL LOCK YOU INTO CURRENT PRICING.

TERMS: SIGNED AGREEMENT. UPON RECEIPT OF INVOICE

All material is guaranteed to be as specified. All work to be completed in a workmanlike manner according to standard practices. Any alteration or deviation from above specifications involving extra costs will be executed only upon written orders, and will become an extra charge over and above the estimate. All agreements contingent upon strikes, accidents or delays beyond our control. Owner to carry fire, tornado and other necessary insurance. Our workers are fully covered by Workman's Compensation Insurance. **NOTICE: You, the buyer, may cancel this transaction at any time prior to midnight of the third business day after the date of this transaction. Cancellation must be done in writing.**

Authorized
Signature _____

Timothy D. Zimmerman, Sr.
 Sales Manager/Maintenance Coordinator

Note: This proposal may be
 Withdrawn by us if not accepted within 15 days.

Acceptance of Proposal – The above prices, specifications and conditions are satisfactory and are hereby accepted. You are authorized to do the work as specified. Payment will be made as outlined above. **Date of Acceptance** _____

Signature _____

Signature _____

V. ITEMS FOR DISCUSSION

- d. John Deere Gator for JT Lambert Athletics, quote -
\$10,199.47

Form 611

MUST BE COMPLETED FOR ANY PROCUREMENT OF A SERVICE OR ITEM OVER \$5,000.00

The respondent's email (**elizabeth-kolcun@esasd.net**) was recorded on submission of this form.

Untitled Section

Untitled Section

FORM 611

EAST STROUDSBURG AREA SCHOOL DISTRICT

Procurement Form

Name of Requestor *

Christopher Rossi

Untitled Title

Department *

Athletics

Building *

J. T. Lambert Intermediate

What service or item are you requesting *

John Deere Gator

Why are you requesting the service or item *

Gator will be used for transport of hydration materials, medical supplies and transporting injured athletes in an expedited fashion (especially emergencies)

Suggested replacement *

They have nothing at the school now

Please complete an independent Cost Analysis. (Pre-determine costs prior to contacting a vendor.)

Cost Estimate: If over \$5,000, were three (3) quotes obtained? If yes, Please list the vendor's information and quoted amount. *

Deere & Company, (#4376) PA Ag and Grounds keeping type power equip 4400020085 (pg 61 cg 22)

What is the total cost of the purchase? *

10,199.47

Procurement Method: *

Quote

Request for Proposal (RFP)

Bid

Other: _____

Was this purchase budgeted? *

No ▼

Was this purchased through a PA State Contract or Approved Consortiums? If yes, select group.

Yes

Pennsylvania State Contract

COSTARS

Keystone Purchasing Network

PEPPM National Contract Program (Technology Bidding and Purchasing)

US Communities

NO

If item was purchased through a Pa State Contract or approved Consortium, please include contract number.

PA Ag and Grounds keeping type power equip 4400020085 (pg 61 cg 22)FED ID#36-2382580, DUNS # 60-7690989

Which Fund will be charged? *

10

What account will be charged *

10-3250-762-000-20-517-550-000-5000

Selection of the winning proposal, was the lowest price selected? If not, please explain why and the process of selecting the vendor. *

Deere & Company sold us the North Gator and are a government contractor PA Ag and Grounds keeping type power equip 4400020085 (pg 61 cg 22)

Any additional information you would like to provide.

Possibly apply St Luke's money to purchase

This form was created inside of East Stroudsburg Area School District.

Google Forms



JOHN DEERE



Quote Id: 25101624

ALL PURCHASE ORDERS MUST BE MADE OUT TO (VENDOR):

Deere & Company
2000 John Deere Run
Cary, NC 27513
FED ID: 36-2382580; DUNS#: 60-7690989

ALL PURCHASE ORDERS MUST BE SENT TO DELIVERING DEALER:

Hilltop Sales & Service, Inc
158 Falcone Road
Bangor, PA 18013
610-588-4088
dfalcone@hilltopsales.com

Prepared For:
Christopher Rossi
EAST STROUDSBURG AREA SCHOOL DISTRICT

Proposal For:
Christopher Rossi

Delivering Dealer:

Michael Labarre

Hilltop Sales & Service, Inc
158 Falcone Road
Bangor, PA 18013

dfalcone@hilltopsales.com

Quote Prepared By:

Michael Labarre

mlabarre@hilltopsales.com

Date: 23 August 2021

Offer Expires: 22 September 2021

Confidential



ALL PURCHASE ORDERS MUST BE MADE OUT TO (VENDOR):
 Deere & Company
 2000 John Deere Run
 Cary, NC 27513
 FED ID: 36-2382580; DUNS#: 60-7690989

ALL PURCHASE ORDERS MUST BE SENT TO DELIVERING DEALER:
 Hilltop Sales & Service, Inc
 158 Falcone Road
 Bangor, PA 18013
 610-588-4088
 dfalcone@hilltopsales.com

Quote Summary

Prepared For:
 Christopher Rossi
 EAST STROUDSBURG AREA SCHOOL DISTRICT
 Christopher Rossi
 50 VINE ST
 EAST STROUDSBURG, PA 18301
 Mobile: 570-620-8313
 christopher-rossi@esasd.net

Delivering Dealer:
 Hilltop Sales & Service, Inc
 Michael Labarre
 158 Falcone Road
 Bangor, PA 18013
 Phone: 610-588-4088
 mlabarre@hilltopsales.com

Quote ID: 25101624
Created On: 23 August 2021
Last Modified On: 23 August 2021
Expiration Date: 22 September 2021

Equipment Summary	Suggested List	Selling Price	Qty	Extended
JOHN DEERE GATOR™ TS (Model Year 2022)	\$ 12,288.52	\$ 10,199.47 X	1 =	\$ 10,199.47
Contract: PA Ag and Grounds Keeping Type Power Equip 4400020085 (PG 61 CG 22)				
Price Effective Date: August 22, 2021				
Equipment Total				\$ 10,199.47

* Includes Fees and Non-contract Items

Quote Summary

Equipment Total	\$ 10,199.47
Trade In	
SubTotal	\$ 10,199.47
Est. Service Agreement Tax	\$ 0.00
Total	\$ 10,199.47
Down Payment	(0.00)
Rental Applied	(0.00)
Balance Due	\$ 10,199.47

Salesperson : X _____

Accepted By : X _____

Confidential



JOHN DEERE



Selling Equipment

Quote Id: 25101624

Customer Name: EAST STROUDSBURG AREA SCHOOL DISTRICT

ALL PURCHASE ORDERS MUST BE MADE OUT TO (VENDOR):

Deere & Company
2000 John Deere Run
Cary, NC 27513
FED ID: 36-2382580; DUNS#: 60-7690989

ALL PURCHASE ORDERS MUST BE SENT TO DELIVERING DEALER:

Hilltop Sales & Service, Inc
158 Falcone Road
Bangor, PA 18013
610-588-4088
dfalcone@hilltopsales.com

JOHN DEERE GATOR™ TS (Model Year 2022)

Hours:

Stock Number:

Contract: PA Ag and Grounds Keeping Type Power Equip
4400020085 (PG 61 CG 22)

Price Effective Date: August 22, 2021

Suggested List *

\$ 12,288.52

Selling Price *

\$ 10,199.47

* Price per item - includes Fees and Non-contract items

Code	Description	Qty	List Price	Discount%	Discount Amount	Contract Price	Extended Contract Price
56B2M	GATOR™ TS (Model Year 2022)	1	\$ 7,649.00	17.00	\$ 1,300.33	\$ 6,348.67	\$ 6,348.67
Standard Options - Per Unit							
001A	US/Canada	1	\$ 0.00	17.00	\$ 0.00	\$ 0.00	\$ 0.00
0501	PR - Base	1	\$ 0.00	17.00	\$ 0.00	\$ 0.00	\$ 0.00
1015	Turf Tires	1	\$ 0.00	17.00	\$ 0.00	\$ 0.00	\$ 0.00
2016	Non Adjustable Seat	1	\$ 0.00	17.00	\$ 0.00	\$ 0.00	\$ 0.00
3100	Cargo Box Manual Lift	1	\$ 0.00	17.00	\$ 0.00	\$ 0.00	\$ 0.00
4099	Less Front Protection Package	1	\$ 0.00	17.00	\$ 0.00	\$ 0.00	\$ 0.00
4199	Less Rear Protection Package	1	\$ 0.00	17.00	\$ 0.00	\$ 0.00	\$ 0.00
6018	Less Rear Receiver Hitch	1	\$ 0.00	17.00	\$ 0.00	\$ 0.00	\$ 0.00
Standard Options Total			\$ 0.00		\$ 0.00	\$ 0.00	\$ 0.00
Dealer Attachments/Non-Contract/Open Market							
BM22600	Deluxe Glass Cab	1	\$ 4,443.71	17.00	\$ 755.43	\$ 3,688.28	\$ 3,688.28
BM20414	Heavy-Duty Suspension Kit	1	\$ 195.81	17.00	\$ 33.29	\$ 162.52	\$ 162.52
Dealer Attachments Total			\$ 4,639.52		\$ 788.72	\$ 3,850.80	\$ 3,850.80
Value Added Services Total			\$ 0.00			\$ 0.00	\$ 0.00
Total Selling Price			\$ 12,288.52		\$ 2,089.05	\$ 10,199.47	\$ 10,199.47



JOHN DEERE

A Purchase Order or Letter of Intent is required for all orders.

To expedite the delivery of equipment, the below information must be included on your Purchase Order or Letter of Intent.

For any questions, please contact:

- Vendor: Deere & Company
 - 2000 John Deere Run
Cary, NC 27513
 - Contract name and number
 - Signature
 - Shipping address
 - Billing address
 - Membership number (if applicable)
 - Tax exempt certificate (if applicable). Must be made out to Deere & Company.
- Michael Labarre**
Hilltop Sales & Service, Inc
158 Falcone Road
Bangor, PA 18013
Tel: 610-588-4088
Fax: 610-599-1098
Email: mlabarre@hilltopsals.com

If information is not included, the Purchase Order or Letter of Intent will be returned.

The John Deere Government Sales Team

V. ITEMS FOR DISCUSSION

- e. Furniture for JTL Transition Cafe, quote - \$21,828.21

Form 611

MUST BE COMPLETED FOR ANY PROCUREMENT OF A SERVICE OR ITEM OVER \$5,000.00

The respondent's email (**matthew-krauss@esasd.net**) was recorded on submission of this form.

Untitled Section

Untitled Section

FORM 611

EAST STROUDSBURG AREA SCHOOL DISTRICT

Procurement Form

Name of Requestor *

Matthew Krauss/Craig Reichl

Untitled Title

Department *

Special Education - ACCESS

Building *

JT Lambert

What service or item are you requesting *

Furniture for JTL Transition Cafe that will be operated by Special Education Transition students.

Why are you requesting the service or item *

By age 14 or earlier a transition plan needs to start being developed for Special Education students. IEPs are updated to include a plan as well as address student's post secondary goals. The creation of a Special Education student run cafe at JTL will address these requirements as well as provide a foundation for these students to build on at the High School level.

Suggested replacement *

New

Please complete an independent Cost Analysis. (Pre-determine costs prior to contacting a vendor.)

\$20,000 - \$25,000

Cost Estimate: If over \$5,000, were three (3) quotes obtained? If yes, Please list the vendor's information and quoted amount. *

No, PEMCO utilizes COSTAR vendors.

What is the total cost of the purchase? *

\$21,828.21

Procurement Method: *

Quote

Request for Proposal (RFP)

Bid

Other:

Was this purchase budgeted? *

Yes ▼

Was this purchased through a PA State Contract or Approved Consortiums? If yes, select group.

Yes

Pennsylvania State Contract

COSTARS

Keystone Purchasing Network

PEPPM National Contract Program (Technology Bidding and Purchasing)

US Communities

NO

If item was purchased through a Pa State Contract or approved Consortium, please include contract number.

CO-STARS 035-015

Which Fund will be charged? *

10

What account will be charged *

10-1211-610-891-20-517-310-000-9891

Selection of the winning proposal, was the lowest price selected? If not, please explain why and the process of selecting the vendor. *

PEMCO (vendor) works with various manufacturers to supply different furniture styles for education purposes. A representative worked with us on design, space planning, product comparison, price evaluation, content selection and project management. Special consideration was given to the quality of materials that are both made to last and easy to clean. Furniture costs are based on Co-stars pricing.

Any additional information you would like to provide.

Fully funded by ACCESS.

This form was created inside of East Stroudsburg Area School District.

Google Forms



DESIGN PACKAGE FOR:

TRANSITION SPACE

SHEET INDEX

PRODUCT LISTING (DP...)	PROJECT #	320948
RENDERINGS (DR...)	DATE	8-23-21
FLOOR PLANS (DF...)	DESIGN BY	ANGELINA
ELEVATIONS (DE...)	SALESPERSON	TOBY
CUSTOM UNITS (DX...)	CONTACT:	BILL L
COLOR CHOICES (DC...)		

NEW
Lotz Armor Edge™
COLORS!



WB Mfg
 WB Manufacturing LLC





S:\Cabinet Group\Project\2021\VP_E.M. Col\East Stroudsburg Transition Space_320948\Drawings\Concept\Initial_8-18-21\320948_Stroudsburg_Transition Space_8-18-21_DP.dwg

PROJECT NAME: TRANSITION SPACE

DEALER: PEM CO
 PROJECT #: 320948

SCALE: NO SCALE

DRAWN BY: ANGELINA
 DATE: 8-23-21
 SHEET NUMBER: DRI





S:\Cabinet Group\Projects\2021\PEM Co\East Stroudsburg Transition Space_320948\Drawings\Concept\Initial_8-18-21\320948_Stroudsburg Transition Space_8-18-21_DP.dwg

PROJECT NAME: TRANSITION SPACE

DEALER:
PEM CO

PROJECT #:
320948

DRAWN BY:
ANGELINA

DATE:
8-23-21

SCALE:
NO SCALE

SHEET NUMBER:
DR2



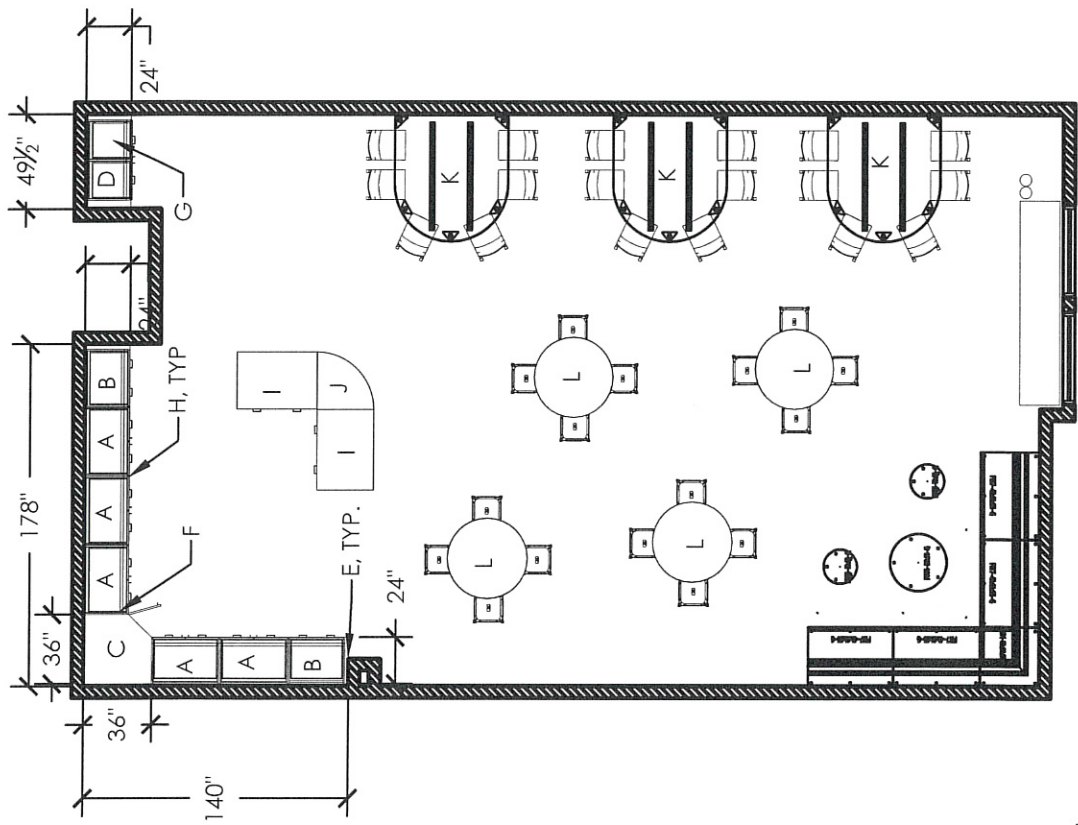

NOTE: SOFT SEATING, CHAIRS AND STOOLS TO BE PROVIDED BY OTHERS

S:\Cabinet Group\Projects\2021\PEM Co\East Stroudsburg Transition Space_320948\Drawings\Concept\Initial_8-18-21\320948_Stroudsburg Transition Space_8-18-21_DP.dwg

PROJECT NAME: TRANSITION SPACE

DEALER: PEM CO	PROJECT #: 320948	DRAWN BY: ANGELINA	DATE: 8-23-21	SCALE: 1/8" = 1'-0"	SHEET NUMBER: DF1
-------------------	----------------------	-----------------------	------------------	------------------------	----------------------





PROPOSAL

Number PEMQ8101

Date Aug 26, 2021

Educational & Contract Furniture
1700 N. Highland Road, Suite 107
Pittsburgh, Pa 15241
Phone: 412-831-7601 Fax: 412-831-7662

Proposal Expires on: 9/25/2021

Website: www.pemcofurniture.com

Sold To	Ship To	Your Sales Rep
East Stroudsburg SD Matt Krauss 50 Vine Street East Stroudsburg, PA 18301 Phone 570-424-8500 Fax	JT Lambert Intermediate School Matt Krauss 2000 Milford Road East Stroudsburg, PA 18301 Phone 570-424-8430 Email	Bill Lindstrom Office: 412-831-7601 Ext. 119 Cell: 814-553-1640 Email: Bill@pemcofurniture.com

Terms	PO Number
--------------	------------------

Qty	Mfg	Model #	Description	Unit Price	Ext. Price
4	Fomcore	F017-45x31x35-G	Linear armless loveseat. 18" seat height with glides. Standard Grade 1 Silvertex vinyl color TBD.	\$1,075.55	\$4,302.20
1	Fomcore	F024-31x31x35-G	Linear armless corner unit. 18" seat height with glides. Standard Grade 1 Silvertex vinyl color TBD.	\$1,384.25	\$1,384.25
1	Fomcore	F005-30x18-G	30" Round ottoman. 18" seat height with glides. Standard Grade 1 Silvertex vinyl color TBD.	\$524.31	\$524.31
6	Fomcore	F005-18x18-G	18" Round ottoman. 18" seat height with glides. Standard Grade 1 Silvertex vinyl color TBD. <i>Exceeds \$5000 list price - qualifies for free freight.</i>	\$196.00	\$1,176.00

Product shipping direct. School responsible for receiving and placement.

Purchase Order instructions below

PA-CoStars Pricing is Valid for 30 days

Pricing Per: PA Co-Stars 035-015
 Make PO out to: PEMCO
 1700 N. Highland Rd Suite 107
 Pittsburgh, PA 15241

SubTotal	\$7,386.76
Tax	\$0.00
Shipping	0.00
Total	\$7,386.76

Please Sign Proposal and return with PO:
Email: Bill@pemcofurniture.com
or Fax: 412-831-7662

Print: _____

Signature: _____

Date: _____



PROPOSAL

Number PEMQ8102

Date Aug 26, 2021

Proposal Expires on: 9/25/2021

Educational & Contract Furniture
1700 N. Highland Road, Suite 107
Pittsburgh, Pa 15241
Phone: 412-831-7601 Fax: 412-831-7662

Website: www.pemcofurniture.com

Sold To	Ship To	Your Sales Rep
East Stroudsburg SD Matt Krauss 50 Vine Street East Stroudsburg, PA 18301 Phone 570-424-8500 Fax	JT Lambert Intermediate School Matt Krauss 2000 Milford Road East Stroudsburg, PA 18301 Phone 570-424-8430 Email	Bill Lindstrom Office: 412-831-7601 Ext. 119 Cell: 814-553-1640 Email: Bill@pemcofurniture.com

Terms	PO Number

Qty	Mfg	Model #	Description	Unit Price	Ext. Price
15	Scholar Craft	SC5418XLCO	Thrive 18" cantiliver chair. Chrome frame. Standard shell color TBD.	\$122.40	\$1,836.00
16	Scholar Craft	SC5129	Thrive 29" four leg stool. Chrome frame. Standard shell color TBD.	\$131.41	\$2,102.56
1	Scholar Craft		Freight	\$969.33	\$969.33

Product shipping direct. School responsible for receiving and placement.

Purchase Order instructions below

PA-CoStars Pricing is Valid for 30 days

Pricing Per: PA Co-Stars 035-015
 Make PO out to: PEMCO
 1700 N. Highland Rd Suite 107
 Pittsburgh, PA 15241

SubTotal	\$4,907.89
Tax	\$0.00
Shipping	0.00
Total	\$4,907.89

Please Sign Proposal and return with PO:
Email: Bill@pemcofurniture.com
or Fax: 412-831-7662

Print: _____

Signature: _____

Date: _____



PROPOSAL

Number PEMQ8109

Date Aug 27, 2021

Educational & Contract Furniture
1700 N. Highland Road, Suite 107
Pittsburgh, Pa 15241
Phone: 412-831-7601 Fax: 412-831-7662

Proposal Expires on: 9/26/2021

Website: www.pemcofurniture.com

Sold To		Ship To	Your Sales Rep
East Stroudsburg SD Matt Krauss 50 Vine Street East Stroudsburg, PA 18301 Phone 570-424-8500 Fax		JT Lambert Intermediate School Matt Krauss 2000 Milford Road East Stroudsburg, PA 18301 Phone 570-424-8430 Email	Bill Lindstrom Office: 412-831-7601 Ext. 119 Cell: 814-553-1640 Email: Bill@pemcofurniture.com
Terms	PO Number		

Qty	Mfg	Model #	Description	Unit Price	Ext. Price
2	Wisconsin Bench	CD2425	Replay station with 2 drawers above two doors, one partition and adjustable shelves. 42"W x 28"D x 36"H. Finished both ends.	\$1,226.01	\$2,452.02
1	Wisconsin Bench	CD2000-LG	replay curved outside corner shelving unit. 29"W x 29"D x 36"H. Finished both ends.	\$689.32	\$689.32
3	Wisconsin Bench	ELS7379-FX	ELO Court table with five legs and stretcher bar. 60"L x 66"W x 29.36"H.	\$724.73	\$2,174.19
4	Wisconsin Bench	GIB7191-7532-B	42" round cafe height tables. Tubular steel X base. 42"H	\$669.51	\$2,678.04
2	Wisconsin Bench		Banding Fee	\$133.33	\$266.66
1	Wisconsin Bench		Freight	\$1,273.33	\$1,273.33

All colors TBD - standard laminates/edge and paint colors.

Product shipping direct. School responsible for receiving and placement.

Purchase Order instructions below

PA-CoStars Pricing is Valid for 30 days

Pricing Per: PA Co-Stars 035-015
Make PO out to: PEMCO
1700 N. Highland Rd Suite 107
Pittsburgh, PA 15241

SubTotal	\$9,533.56
Tax	\$0.00
Shipping	0.00
Total	\$9,533.56

Please Sign Proposal and return with PO:
 Email: Bill@pemcofurniture.com
 or Fax: 412-831-7662

Print:

Signature:

Date:

V. ITEMS FOR DISCUSSION

f. JTL Food Service Freezer Repair, quote - \$9,335.00

Form 611

MUST BE COMPLETED FOR ANY PROCUREMENT OF A SERVICE OR ITEM OVER \$5,000.00

The respondent's email (**craig-neiman@esasd.net**) was recorded on submission of this form.

Untitled Section

Untitled Section

FORM 611

EAST STROUDSBURG AREA SCHOOL DISTRICT

Procurement Form

Name of Requestor *

Melissa Collevchio

Untitled Title

Department *

Food Service Department

Building *

JT Lambert

What service or item are requesting *

New refrigeration system

Why are you requesting the service or item *

Current system is not functioning properly

Suggested replacement *

New Refrigeration System

Please complete an independent Cost Analysis. (Pre-determine costs prior to contacting a vendor.)

Cost Estimate: if over \$5,000, were three (3) quotes obtained? If yes, please list the vendor's information and quoted amount. *

No, only one bid

What is the total cost of the purchase? *

\$9,335.00

Procurement Method: *

- Quote Received only one Proposal
- Request for Proposal (RFP)
- Bid
- Other: _____

Was this purchase budgeted? *

Yes ▼

Was this purchased through a PA State Contract or Approved Consortiums? If yes, select group.

- Yes
- Pennsylvania State Contract
- COSTARS
- Keystone Purchasing Network
- PEPPM National Contract Program (Technology Bidding and Purchasing)
- US Communities
- No

If item was purchased through a Pa State Contract or approved Consortium, please include contract number.

Which Fund will be charged? *

50 ▼

What account will be charged? *

Food Service Fund - equipment repairs

Selection of the winning proposal, was the lowest price selected? If not, please explain why and the process of selecting the vendor. *

Yes

Any additional information you would like to provide.

This form was created inside of East Stroudsburg Area School District.

Google Forms

Proposal

Chapman Refrigeration LLC

555 Prices Dr
Cresco, Pa. 18326
570-595-2117 fax 570-595-6156

3222

JTL

PROPOSAL SUBMITTED TO East Stroudsburg Sch. Dist.		PHONE	DATE 7/20/2021
STREET		JOB NAME JTL New refig system indoor walk in freezer	
CITY, STATE and ZIP CODE		JOB LOCATION Indoor walk in freezer @ JTL	
ARCHITECT	DATE OF PLANS	JOB PHONE	

We hereby submit specifications and estimates for:

The removal of old refrigeration system on indoor walk in freezer & the installation of a new refrigeration system for walk in freezer

Includes: outdoor condensing unit to be placed on roof indoor evaporator, hook up to existing electrical, New temp controls, freon, Crane, line set labor + freight (District is tax exempt)

Warranty: 1yr parts + labor

*Note as of today, this system is in stock, but that changes daily!

If you agree to these terms, please, sign, date + email it back to us @ chapmanrefrigeration@yahoo.com

We propose hereby to furnish material and labor -- complete in accordance with above specifications, for the sum of:

Nine thousand Three hundred thirty five & 00/100 dollars (\$ 9,335.00)

Payment to be made as follows:

Due in full within 30 days of install completion

All material is guaranteed to be as specified. All work to be completed in a workmanlike manner according to standard practices. Any alteration or deviation from above specifications involving extra costs will be executed only upon written orders, and will become an extra charge over and above the estimate. All agreements contingent upon strikes, accidents or delays beyond our control. Owner to carry fire, tornado and other necessary insurance. Our workers are fully covered by Workman's Compensation Insurance.

Authorized Signature

Note: This proposal may be withdrawn by us if not accepted within 5 days.

Acceptance of Proposal - The above prices, specifications and conditions are satisfactory and are hereby accepted. You are authorized to do the work as specified. Payment will be made as outlined above.

Date of Acceptance:

9/7/21

Signature

Signature

V. ITEMS FOR DISCUSSION

- g. AFL Teleco Fiber Optic Testing Equipment, quote -
\$9,925.00

AFL Teleco Fiber Optic Testing Equipment

A. Why are you requesting the service/needs?

Why: The district needs fiber optic testing equipment now that we transitioned from a Lit Fiber Circuit (PenTeleData managed) to a Dark Fiber Circuit (ESASD managed).

Need: The district is in need of fiber optic testing equipment to test and troubleshoot the fiber optic circuits (dark fiber) it now manages.

Suggested equipment: AFL Teleco from AccuTech. NOTE: Our fiber optic partners, Colonial IU#20 and Blue Ridge Cable/PenTeleData utilize AFL equipment.

B. Cost Estimate: if over \$5,000, were 3 quotes obtained? If yes, please list the vendors and the amounts. No. CDW, Graybar, AccuTech and Anixter were contacted for quotes and we received only two responses: AccuTech and Anixter

- AccuTech (AFL Teleco) – \$9,925.00
- Anixter (Fluke) - \$14,910.26

C. Procurement Method:

- David Cooper, Network Analyst, spec'd and reviewed both Fluke (Anixster) and AFL (AccuTech) equipment. AccuTech provided us with an AFL Teleco demo unit, while Anixster (Fluke) did not. The AFL Teleco unit worked well when we transitioned over to our dark fiber WAN. Four companies were solicited for pricing with only 2 providing quotes.

D. Funds account to be charged for Procurement (Was this purchase budgeted?)

- Yes – 2021-2022 Fiscal Year
- Fund 10
- Account #10-2844-650-000-00-006-000-000-0600
 - Technology Services Initiatives Account

E. Selection of winning proposal

- AccuTech (AFL Teleco)
- \$9,925.00

FlexScan® OTDR with SmartAuto®, FleXpress™ and LinkMap®

Pocket-sized, Performance-packed, User-friendly, *and* Affordable



Features

- Fast, accurate OTDR network characterization or fault location
- Integrated MPO Switch control via USB
- Test up to 1:64 PON with 25 m PON dead zone
- Easy to understand LinkMap results with pass/fail indications
- Single, dual or triple wavelength single-mode
- Integrated Source, Power Meter, VFL (visual fault locator)
- Bluetooth and WiFi communications
- Compatible with FOCIS Flex connector inspection system
- Rugged, lightweight, hand-held for field use
- Large, bright touchscreen display easily viewed indoors and out
- Internal / external data storage

Applications

- PON or point-to-point network verification or troubleshooting
- OTDR testing plus Insertion Loss and Power measurements
- Locate faults exceeding industry or user pass/fail thresholds
- Visually pinpoint location of macro-bends or breaks

Performance-packed: With SmartAuto multi-pulse acquisition, up to 37 dB dynamic range and best-in-class 25 m PON dead zone, FlexScan PON OTDRs test FTTH PONs up to 1:64 while still detecting and measuring events only meters apart.

Fast! FleXpress mode completes dual-wavelength tests in <5 seconds – 10 x faster than conventional OTDRs! For multi-fiber testing, FleXpress mode automatically controls 12-fiber MPO Switch to further reduce multi-fiber test time.

User-friendly: FlexScan OTDRs enable both novice and expert technicians to quickly, reliably and accurately detect, locate, identify and measure optical network components and faults. After applying industry-standard or user-set pass/fail criteria, the network is displayed using FlexScan’s intuitive, icon-based LinkMap view. Acquired results may be stored internally or externally. FlexScan automates test setup, shortens test time and simplifies results interpretation, improving efficiency and reducing the cost of test.

Pocket-sized: At 3.5 x 6 x 1.75 in. (86 x 160 x 43 mm) and less than one pound (0.4 kg), FlexScan OTDRs truly fit in your pocket, yet still provide a large, bright indoor/outdoor touchscreen display and all-day operation.

And Affordable: With optional connector inspection, integrated source, power meter and VFL, FlexScan offers an all-in one solution, ensuring technicians have everything they need to locate and resolve optical network issues. Uploaded results may be viewed and reports may be generated using the included Windows-compatible TRM® 2.0 Test Results Manager software.

Available in Convenient, Cost-saving Installation and Troubleshooting Kits - Bundle FlexScan with your choice of launch cable, FOCIS Flex connector inspection probe and tips, and/or AFL’s universal optical fiber identifier (OFI).

FlexScan® OTDR with SmartAuto®, FleXpress™ and LinkMap®

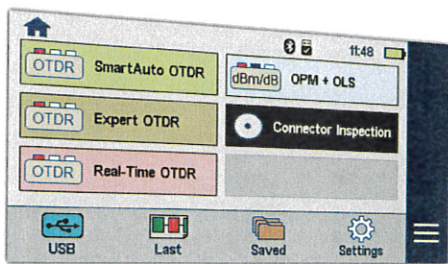

SmartAuto FleXpress Dramatically Cuts Test Time

In SmartAuto mode, a FlexScan OTDR automatically determines the characteristics of the network under test and rapidly completes multiple scans using a variety of network-optimized acquisition settings. It precisely locates and identifies network events, as well as measures loss and reflectance for each detected event. For even greater ease-of-use, FlexScan checks for live fiber and verifies the OTDR launch connection before initiating a test. Dual and triple-wavelength FlexScan OTDRs also provide automatic macro-bend detection.

FlexScan's new FleXpress mode completes dual wavelength tests in seconds, reducing test time by a factor of 10x compared to conventional OTDRs. For multi-fiber testing, FleXpress mode automatically controls AFL's MPO Switch, testing 12 fibers at the touch of a single button.

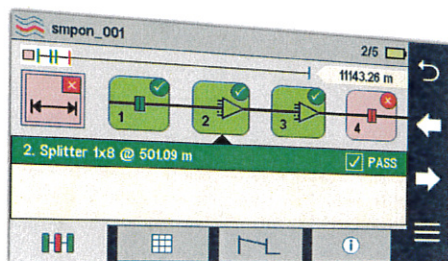

LinkMap Simplifies Network Troubleshooting

LinkMap with Pass/Fail enables even novice users to easily and accurately troubleshoot optical networks. LinkMap presents an icon-based view of the tested network clearly identifying fiber start, end, connectors, splices, PON splitters, and macro-bends.

A LinkMap Summary provides end-to-end link length, loss, loss per distance and ORL. Loss and reflectance of detected events is compared to industry-standard or user-settable pass/fail thresholds and displayed with clear pass/fail indications. Users can instantly toggle between LinkMap and Trace views.



Bluetooth and WiFi for Faster Connectivity

Pair FlexScan with AFL's FOCIS Flex connector inspection probe for fast, easy connector end-face inspection.

FOCIS Flex provides auto-focus, auto-centering, integrated IEC pass/fail analysis, and automatic Bluetooth transfer of images and pass/fail results to FlexScan for display and archiving.

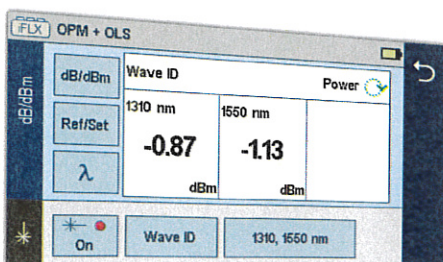

Complete Testing with a Single Tool

FlexScan integrates a Visual Fault Locator (VFL) plus an optional optical laser source (OLS) and optical power meter (OPM) supporting AFL's unique Wave ID capability. With Wave ID, the power meter automatically synchronizes to a single or multi-wavelength Wave ID optical signal sent by an AFL light source. The power meter automatically identifies received wavelengths and measures power and loss at each wavelength, saving significant test time and eliminating setup errors.

The VFL's eye-safe red laser enables users to visually pinpoint the location of macro-bends and fiber breaks often found in splice closures and fiber cabinets.

FlexScan® OTDR with SmartAuto®, FleXpress™ and LinkMap®

FlexScan OTDRs are available with 1310/1550/1650, 1310/1550, and 1550 or 1650 nm only wavelengths. 1310 & 1550 nm versions are available with integrated optical light source (OLS), optical power meter (OPM), visual fault locator (VFL) and Bluetooth/WiFi.

Specifications^a

MODEL: FS200-#	-50	-60	-100	-300	-304
OTDR					
Emitter Type	Laser				
Safety Class ^b	Class I				
Fiber Type	Single-mode				
Wavelengths (nm)	1550	1650	1310/1550	1310/1550	1310/1550/1650
Center λ Tolerance	± 20 nm (CW mode)				
Dynamic Range (dB) ^c	28	37	32/30	37/36	37/36/37
Event Dead Zone ^d (m)	1.0	0.8	0.8	0.8	0.8
Atten. Dead Zone ^e (m)	6.0	3.5	3.6	3.5	3.5
PON Dead Zone ^f (m)	N/A	30	N/A	25/25	25/25/30
Pulse Widths	3, 5, 10, 20, 30, 50, 100, 200, 300, 500 ns; 1, 2, 3, 10 μ s; 20 μ s (FS200-60/300/304 only)				
Range Settings	250 m to 240 km				
Data Points	Up to 300,000 (Expert mode .SOR file)				
Data Spacing	5 cm to 16 m				
Group Index of Refraction	1.3000 to 1.7000				
Distance Uncertainty (m)	$\pm(1 + 0.003\% \times \text{distance} + \text{data point spacing})$				
Linearity (dB/dB)	± 0.05				
Trace File Format	Telcordia SR-4731 Issue 2				
Trace File Storage Medium	4 GB internal memory (>1000 traces); External USB memory stick				
Data Transfer to PC	USB cable or Bluetooth® or WiFi (option)				
Standard OTDR Modes	SmartAuto, Expert, Real Time				
Display Modes	LinkMap Summary, LinkMap Events, Trace				
FleXpress Fast Test	No	No	No	Yes	Yes
Real-time Refresh Rate	Up to 4 Hz				
Live Fiber Protection	No OTDR damage with input power $\leq +3$ dBm for wavelength(s) in range 1260 to 1675 nm				
Live Fiber Detection	Reports live fiber with input signal ≥ -35 dBm for wavelength(s) in range 1260 to 1675 nm				
Live PON Filter Isolation	>50 dB for 1260 nm \leq wavelength \leq 1600 nm				
Live PON OTDR Test	1650 nm using filtered detector				
VISUAL FAULT LOCATOR (VFL)					
Emitter Type	Visible red laser, 650 ± 20 nm				
Safety Class ^b	Class II				

MODEL: FS200-#	-50	-60	-100	-300	-304
Output Power (nominal)	0.8 mW into single-mode fiber				
Modes	CW, 2 Hz flashing				
OPTICAL LASER SOURCE - OLS (Optional)					
Emitter Type	Laser				
Safety Class ^b	Class I				
Fiber Type	Single-mode				
Wavelengths (nm)	1550	N/A	1310/1550	1310/1550	1310/1550
Center λ Tolerance	± 20 nm (CW mode)				
Spectral Width (FWHM)	5 nm (maximum)				
Internal Modulation	270 Hz, 330 Hz, 1 kHz, 2 kHz, CW, Wave ID				
Wave ID	Compatible with AFL OPM/OLS				
Output Power Stability	$\leq \pm 0.1$ dB (15 minutes); $\leq \pm 0.15$ dB (8 hours)				
Output Power	-3 dBm ± 1.5 dB				
OPTICAL POWER METER - OPM (Optional)					
Calibrated Wavelengths	1310, 1490, 1550, 1625, 1650 nm				
Detector Type	InGaAs, 1 mm diameter				
Measurement Range	$+23$ to -50 dBm				
Tone Detect Range	$+3$ to -35 dBm				
Wavelength ID Range	$+3$ to -35 dBm				
Accuracy ^h	± 0.25 dB				
Resolution	0.01 dB				
Measurement Units	dB, dBm or Watts (nW, μ W, mW)				
GENERAL					
Size (in boot)	86 x 160 x 43 mm				
Weight	0.4 kg				
Operational Temperature	-10 °C to $+50$ °C, 0 to 95 % RH (non-condensing)				
Storage Temperature	-40 °C to $+70$ °C, 0 to 95 % RH (non-condensing)				
Power	Rechargeable Li-Pol or AC adapter				
Battery Life	>12 hours, Telcordia test conditions				
Display	Color touchscreen 4.3 in LCD, 480 x 272, backlit				
USB Ports	1 host; 1 micro-USB function				
Bluetooth (optional)	Compatible with Windows PC, Android				
WiFi (optional)	IEEE 802.11 / WLAN				

Notes:

- All specifications valid at 25 °C unless otherwise specified.
- FDA 21 CFR 1040.10 and 1040.11, IEC 60825-1: 2007-03.
- (RMS, SNR=1) - Measured using maximum range, widest pulse width and 3 minutes averaging.
- Typical distance between the two points 1.5 dB down each side of a reflective spike caused by a -45 dB event using 5 ns pulse width.
- Typical distance from the location of a -45 dB reflective event to the point where the trace falls and stays within 0.5 dB of backscatter, using a 5 ns pulse width.
- Recovery to within 0.5 dB of backscatter after 1:16 splitter (≤ 13 dB loss) using 100 ns pulse width.
- At calibration wavelengths and power levels of approximately -10 dBm.

FlexScan® OTDR with SmartAuto®, Flexpress™ and LinkMap®

FlexScan Kit Configurations

All kits include FlexScan with AC charger, battery, carry strap, SC/2.5 mm connector adapters, TRM® 2.0, quick reference guide, USB cable and carry case. PLUS kits add a 150 m fiber ring, One-Click cleaner, plus upgrade to TRM 2.0 Advanced. PRO kits additionally include a FOCIS Flex auto-focusing connector inspection probe with IEC pass/fail analysis and two adapter tips. Complete kits expand on PRO Kits by adding a bend-insensitive fiber identifier with optional power meter (OFI-BI or OFI-BIPM). MPO Kits bundle FS200-300/304 with MPO switch, MPO launch cable plus USB cable and jumper to connect FlexScan to MPO switch.

Ordering Information

FS200-[MOD]-[KIT]-[PW]-[C]-[LNG]-[AC]-[FR]-[TIP]^a where:

[MOD]	FS200 FlexScan OTDR Configuration
50	1550 nm only Troubleshooting OTDR
60	1650 nm filtered Live PON Troubleshooting OTDR
100	1310/1550 nm Verification & Troubleshooting OTDR
300	1310/1550 Pt-to-Pt & PON Verification & Troubleshooting OTDR
304	1310/1550/1650 Pt-to-Pt & PON Verification & Troubleshooting OTDR

[KIT]	FS200 FlexScan Kit Configuration
BAS	Basic kit with soft case, TRM 2.0 Basic, USB cable
PLUS	Adds 150 m Fiber Ring, One-Click cleaner, TRM 2.0 Advanced
PRO	Adds Fiber Ring, One-Click cleaner, TRM 2.0 Advanced, FOCIS Flex
BI	BI Complete kit adds OFI-BI to PRO kit
BIPM	BIPM Complete kit adds OFI-BIPM to PRO kit
MPO	Multi-fiber kit includes FlexScan plus MPO Switch, MPO launch cable, OTDR-to-Switch patch cord, OTDR-to-Switch USB cable

[PW]	Power Meter / Wireless option
PO-WO	No Source, Power Meter, or Bluetooth/WiFi (FS200-50/60/100 only)
PO-W1	No Source or Power Meter; Includes Bluetooth/WiFi (FS200-300/304 only)
P1-WO	No Bluetooth/WiFi (-304 only); Includes Source, Power Meter
P1-W1	Includes Source, Power Meter, Bluetooth/WiFi (all models except -50)
P1-W1H	Includes Source, Power Meter, Bluetooth/WiFi, hard carry case (all models except -50)

[C]	OTDR / Source Connector Type
A	APC (recommended)
U	UPC

[LNG]	Language	[DNK]	Danish	[NOR]	Norwegian
ENG	English	[FIN]	Finnish	[POL]	Polish
CHS	Chinese Simp.	[FRA]	French	[POR]	Portuguese
CHT	Chinese Trad.	[ITA]	Italian	[SPA]	Spanish
CZE	Czech	[JPN]	Japanese	[TUR]	Turkish
DEU	German	[KOR]	Korean		

[AC]	Destination Country	AC Plugs
US	USA	2-pin, US
EU	European Union	2-pin, EU
UK	United Kingdom	2-pin, UK
CN	China, Australia	2-pin, SAA

[FR]	150 m SMF Fiber Ring	[FR]	150 m SMF Fiber Ring
Blank	N/A in Basic kits	ASC/ASC	FR1-SM-150-ASC-ASC
SC/SC	FR1-SM-150-SC-SC	ASC/AFC	FR1-SM-150-ASC-AFC
SC/FC	FR1-SM-150-SC-FC	ASC/ALC	FR1-SM-150-ASC-ALC
SC/LC	FR1-SM-150-SC-LC	ALC/ALC	FR1-SM-150-ALC-ALC
SC/ST	FR1-SM-150-SC-ST	FC/FC	FR1-SM-150-FC-FC
SC/ASC	FR1-SM-150-SC-ASC	FC/ST	FR1-SM-150-FC-ST
SC/AFC	FR1-SM-150-SC-AFC	FC/LC	FR1-SM-150-FC-LC
SC/ALC	FR1-SM-150-SC-ALC	FC/AFC	FR1-SM-150-FC-AFC
LC/LC	FR1-SM-150-LC-LC	AFC/AFC	FR1-SM-150-AFC-AFC
LC/ASC	FR1-SM-150-LC-ASC	ASC-	FR1-SM-150-
LC/ALC	FR1-SM-150-LC-ALC	AE2000	ASC-AE2000
ASC/FC	FR1-SM-150-ASC-FC	SC-E2000	FR1-SM-150-SC-E2000
ASC/ST	FR1-SM-150-ASC-ST		

[TIP] *	FOCIS Flex Tips & Cleaning (PRO only)
Blank	Option not available in Basic & PLUS kits
SC	SC-UPC bulkhead tip, 2.5 mm UPC ferrule tip, 2.5 mm cleaning
FC	FC-UPC bulkhead tip, 2.5 mm UPC ferrule tip, 2.5 mm cleaning
LC	LC-UPC bulkhead tip, 1.25 mm UPC ferrule tip, 1.25 mm cleaning
ASC	SC-APC bulkhead tip, 2.5 mm APC ferrule tip, 2.5 mm cleaning
AFC	FC-APC bulkhead tip, 2.5 mm APC ferrule tip, 2.5 mm cleaning
ALC	LC-APC bulkhead tip, 1.25 mm APC ferrule tip, 1.25 mm cleaning

* For additional FOCIS Flex adapter tips, see FOCIS Flex data sheet or Buyer's Guide.

International Sales and Service Contact Information

Available at www.AFLglobal.com/Test/Contacts



FOCIS Duel Fiber Optic Connector Inspection System



Features

- Auto-focus (both ports) and auto-centering (Port 1) for fast, easy inspection
- Self-contained, tether-free, compact, hand-held inspection solution
- IEC 61300-3-35 (2015), IPC 8497-1, AT&T TP-76461 and user-defined auto-inspection (Port 1)
- Available with more than three dozen tips supporting all commonly used connector types, including MPO/MTP multi-fiber connectors and bulkheads
- Rechargeable, field-replaceable NiMH battery lasts more than 8 hours
- Snout and adapter tip slots eliminate loosening during normal operation
- Fast 1X/2X zoom toggle

Applications

- Inspect connectors on bulkhead adapters (Port 1) and patch cords (Port 2) without swapping adapter tips
- Optimal tool for optical network installation, turn-up, troubleshooting and maintenance
- MPO/MTP multi-fiber multi-row connectors inspection
- Critical fiber infrastructure performance assurance
- Maintenance of fiber connections at highest optical performance levels
- Verification that proper connector cleaning practices are being used

FOCIS Duel is a self-contained twin-ported Bluetooth connected fiber optic connector inspection probe with integrated screen. The first port (right hand side Port 1) is fully featured, identical to AFL's FOCIS Flex. The second port (left hand side Port 2) has fast and convenient female "click-in" adapters, auto-focus and 2X zoom capabilities. The FOCIS Duel can perform IEC, IPC, AT&T and user-defined end-face cleanliness analysis and store Port 1 images and reports locally. The AFL FOCIS App (iOS and Android) provides a comprehensive and user-friendly feature set as well as connectivity with AFL's cloud-based aeRos® workflow automation platform.

Pass / fail results in seconds: With the press of a single button, Port 1 of the FOCIS Duel auto-focuses, captures, centers and analyzes the end-face image to industry standard IEC 61300-3-35 (2015), IPC, AT&T and user-defined criteria.

Untethered operation: With rechargeable battery and integrated 2.4" color TFT LCD screen, FOCIS Duel can be used independently.

Wide range of adapter tips: Port 1 – Interchangeable adapter tips support single and multi-fiber connector inspection for a wide range of patch cords and bulkhead-mounted connectors having either PC/UPC or APC polished end-faces. A key on the probe snout combined with a slot on the adapter tips assures that adapter tips never loosen during use, under any circumstances. Quad-slotted APC adapter tips ensure the screen is visible in any use case. Port 2 – A slot on the adapter tips combined with a keyed snout eliminates loosening during normal use. Port 2 adapter tips are available for all common connector types – Universal 1.25 mm and 2.5 mm, SC and LC in both UPC and APC polish types.

Inspection kits include AC charger, carry strap, two user-selected adapter tips (optionally), and soft carry case.



IEC 61300-3-35



IPC 8497-1



ATT-TP-76450

FOCIS Duel Fiber Optic Connector Inspection System

Specifications ^a

FIRST PORT (Port 1) PARAMETERS	SPECIFICATION
Field of View (FOV; viewed on FOCIS Duel)	Live: 710 x 860 μ m; Captured, Zoomed Out: 560 x 600 μ m; Captured, Partially Zoomed In: 360 x 390 μ m; Captured, Fully Zoomed In: 180 x 195 μ m
Field of View (FOV; viewed on a PC)	Captured, Zoomed Out: 525 x 700 μ m; Captured, Partially Zoomed In: 355 x 475 μ m; Captured, Zoomed In: 175 x 235 μ m
Manual Detection Capability (minimum)	0.25 μ m
Auto Analysis Resolution	<1.0 μ m
Internally Stored Image Size (pixels)	640 x 480 VGA; images stored internally in three .JPG files, one at each FOV
Bluetooth Image and Overlay	2 x QVGA (320 x 240; image + overlay) to AFL test instruments (SPP) 1 x VGA (640 x 480) file to Apple iOS devices (IAP / MFi)
Maximum No Damage Live Fiber Power Level	+20 dBm; Image cannot be viewed if fiber is live
Focus Methods and Speeds	Auto-focus (\leq 3 sec) and manual focus
Centering	Auto-centering (<1 sec)
Zoom in Live Mode	1x and 2x modes
Image Capture with Pass/Fail Analysis	IEC 61300-3-35 (2015), AT&T TP-76461, IPC-8497-1, user-set criteria
Results Storage (Image and Pass/Fail Results)	Yes
File Format	JPG, GIF, Port 1 only
File Storage Capacity	10,000 files
SECOND PORT (Port 2) PARAMETERS	
Field of View (FOV; Viewed on FOCIS Duel)	Live: 365 x 440 μ m and 183 x 220 μ m
Manual Detection Capability (minimum)	0.25 μ m
Maximum No Damage Live Fiber Power Level	+20 dBm; Image cannot be viewed if fiber is live
Zoom in Live Mode	1x and 2x modes
Focus Methods and Speeds	Auto-focus (\leq 3 sec) and manual focus
OPERATING FEATURES	
Bluetooth Characteristics	IAP (iPod accessory protocol), SPP 0 x 1101
USB Characteristics	USB 2.0 mass storage device
Supported Languages	English, Chinese Simplified, Chinese Traditional, Finnish, French, German, Italian, Japanese, Korean, Polish, Russian, Spanish, Turkish
ENVIRONMENT PARAMETERS	
Storage Temperature	-40°C to +70°C
Operating Temperature	0°C to +50°C
Relative Humidity	0 to 95% RH
Vibration Limits	2G (transportation)
Transit Drop (without soft case)	300 mm (12 inches, all sides, dust cover installed)
Transit Drop (with soft case)	460 mm (18 inches, all sides, dust cover installed)

Notes:

- a. All specifications valid at 23°C \pm 2°C (73.4°F \pm 3.6°F).
- b. Operating conditions: 60 tests in 20 minutes, then auto-off; repeat each hour.

Continued >>

FOCIS Duel Fiber Optic Connector Inspection System

Specifications ^a

PHYSICAL AND POWER CHARACTERISTICS	
Display Size, Type, Resolution	2.4", color TFT, backlit, 240 x 320 with brightness control
Battery Type	NiMH, user replaceable
Operating Time (typical)	8 hours ^b ; 3 hours continuous
Power Save Features	Auto-off (disabled, 2, 5, 10 min)
Recharge Time	≤4 hours
Low-Battery Warning	Alerts when ≤15 minutes battery operation remains
AC Charger Voltage, Frequency, Current	100-240VAC, 50/60Hz, 5VDC, 2A
Charger Jack	3.2 mm, center positive
Size	47 x 37 x 175 mm (1.8 x 1.5 x 6.8 in)
Weight	280 g (0.62 lb)
Safety & Compliance Certifications	UL, CE, FCC

Notes:

- a. All specifications valid at 23°C ±2°C (73.4°F ±3.6°F).
 b. Operating conditions: 60 tests in 20 minutes, then auto-off; repeat each hour.

Ordering Information

DESCRIPTION	AFL NO.
FOCIS Duel Kit, soft carry case, AC charger, with no tips or One-Click® cleaner	FOCIS-DUEL-N
FOCIS Duel Kit, soft carry case, AC charger, user-selected: (2) UPC ferrule & bulkhead adapter tips, and (1) One-Click cleaner	FOCIS-DUEL-U
FOCIS Duel Kit, soft carry case, AC charger, user-selected: (2) APC ferrule & bulkhead adapter tips, and (1) One-Click cleaner	FOCIS-DUEL-A
FOCIS Duel Kit, soft carry case, AC charger, user-selected: (2) UPC and (2) APC ferrule & bulkhead adapter tips, and (1) One-Click cleaner	FOCIS-DUEL-UA

FOCIS Duel Adapter Tips

PORT USAGE	DESCRIPTION	TIP ID	AFL NO.
1	SC-APC bulkhead adapter tip, quad-slotted	XASC	FFLX-4S-ASC
1	FC-APC bulkhead adapter tip, quad-slotted	X AFC	FFLX-4S-AFC
1	LC-APC bulkhead adapter tip, quad-slotted	XALC	FFLX-4S-ALC
2	LC-UPC ferrule adapter tip, single-slotted female "click-in"	SULC	FDUO-01-U1C
2	LC-APC ferrule adapter tip, single-slotted female "click-in"	SALC	FDUO-01-ALC
2	SC-UPC ferrule adapter tip, single-slotted female "click-in"	SUSC	FDUO-01-USC
2	SC-APC ferrule adapter tip, single-slotted female "click-in"	SASC	FDUO-01-ASC
2	Universal 1.25 mm UPC ferrule adapter tip, single-slotted	U1	FDUO-01-U125
2	Universal 1.25 mm APC ferrule adapter tip, single-slotted	A1	FDUO-01-A125
2	Universal 2.5 mm UPC ferrule adapter tip, single-slotted	U2	FDUO-01-U25
2	Universal 2.5 mm APC ferrule adapter tip, single-slotted	A2	FDUO-01-A25



International Sales and Service Contact Information

Available at www.AFLglobal.com/Test/Contacts

VFI4 Visual Fault Identifier



Features

- Eye-safe Class 3R visible red laser source, 650 nm
- Output power of 5.0 mW with 10 km range
- Universal connector interface for quick connection
- 2.5 mm universal adapter (included) accepts FC, SC, ST, etc. connectors
- 1.25 mm universal adapter (included) accepts LC and MU connectors

Applications

- Identify and trace fibers during activation and installation
- Identify poorly mated connectors
- Verify AFL's FASTConnect® field-installable connector installation
- Find faults inside OTDR dead zones

A Visible Fault Identifier (VFI), also referred to as a Visual Fault Locator (VFL), is an essential tool for fiber installation and maintenance technicians.

AFL's compact VFI4 injects high-powered red-laser light to provide exceptional brightness and range for locating defects in single-mode and multimode fibers. The light generated by these units will escape from sharp bends and breaks in jacketed or bare fibers, as well as poorly mated connectors enabling technicians to quickly spot faults. The universal connector interface mates with many connector styles without needing an adapter.

Rugged and Compact: The rugged VFI4 is designed for the rigors of real-life field testing. It has a range of up to 10 km, fits on a keychain, and features extensions that protect the red-laser port. It has both CW and pulsating modes and is powered by a single AA battery for up to 30 hours of operation.

Installation and Activation: VFI4 is used for quick continuity checks, fiber tracing, splice verification, and Pass/Fail validation for mechanical connectors. VFI4 is also an excellent complement to any OTDR because it can locate faults inside the OTDR's dead zone.

Essential Troubleshooting Tool: The VFI4 highlights sharp bends, breaks, faulty connectors, and other defects that "leak" light. Other applications include end-to-end continuity checks, as well as identifying connectors in patch panels and fibers during splicing operations.

VFI4 Visual Fault Identifier

Specifications^a

OPTICAL	
Emitter Type	Laser, Class IIIa FDA 21 CFR 1040.10 and 1040.11, Class 3R IEC 60825-1:2014
Wavelength	650 nm ±15 nm
Output Power	5 mW maximum
Modulation	2 Hz or CW selected

GENERAL	
Adapter	2.5 mm Universal, 1.25 mm Universal
Power	1 AA battery, <30 hours (Flash mode)
Operating Temperature	-10°C to 50°C, 85 % humidity non condensing
Storage Temperature	-30°C to 60°C, 95 % humidity non condensing
Size (H x W x D)	7.9 x 5.1 x 2.2 cm (3.1 x 2.0 x 0.9 in)
Weight	43 g (1.5 oz)

Notes:

a. All specifications valid at 25°C unless otherwise specified.

Ordering Information

DESCRIPTION	AFL NO.
VFI4 visual fault identifier with 2.5 mm and 1.25 mm adapters	VFI4-01-0900PR

Adapters

DESCRIPTION	AFL NO.
2.5 mm Universal for VFI port	2900-50-0013MR
1.25 mm Universal for VFI port	2900-50-0012MR

Recommended Products



One-Click® Cleaner Mini

- Small compact design with single action cleaning
- Automatically advance ensures each clean is performed with fresh cleaning tape
- 100 clean and 500 clean versions available
- Low cost per clean



FASTConnect® Field-Installable Connectors

- Field-installable, takes less than a minute to complete
- Fast and easy to terminate
- Low insertion/return loss
- Reusable

Qualifications

CATEGORY	REGULATION/STANDARD	QUALIFICATION
CE Marking	EU	Compliant to relevant EU Directives on health, safety, and environmental protection, and certified with CE marking
Safety/EMC/EMI	IEC	Compliant to IEC 61010-1 for safety requirements for electrical equipment
	EN	Compliant to EN 61010-1 for safety requirements for electrical equipment
	IEC	Compliant to IEC 61326-1 for EMC requirements for electrical equipment
	EN	Compliant to EN 61326-1 for EMC requirements for electrical equipment
	EN	Compliant to EN 55011 for EMC requirements for industrial, scientific and medical equipment
	FDA	Compliant to code of federal regulations FDA 21 CFR 1040.10 and 1040.11 on laser products
RoHS	IEC	Compliant to IEC 60825-1 for safety of laser products
	EU	Compliant to EU regulations Directive 2011/65/EU (RoHS 2) and Directive 2015/863 (RoHS 3)

Contact Sales@AFLglobal.com to schedule a demonstration or learn how to buy.

Visit www.AFLglobal.com/Test to learn more about VFI4 Visual Fault Identifier.

International Sales and Service Contact Information available at www.AFLglobal.com/Test/Contacts.

QUOTATION

Page	1 of 2
Date	07/15/2021
Quote	Q0003MLH
Customer	Prospect

11350 Old Roswell Road
Suite 100
Alpharetta, GA 30009
Phone - (770) 740-2240
Fax - (770) 740-2260
Toll Free - (888) 222-8832

C U S T O M E R	East Stroudsburg Area SD
	, David Cooper
	Phone: 570-424-8500
	Email: david-cooper@esasd.net

Quotation Description: Joseph Riccitelli Quick Quote 07/15/2021 14:49 (CDT)

Line	Quantity	Part Number and Description	UM	Unit Price	Extended Price
1	1	Non-Stock AFL TELECO FOCIS-DUEL-UA FOCIS DUEL KIT, SOFT CARRY CASE, AC CHARGER, USER-SELECTED: (2) U	EA	2,556.00	2,556.00
2	1	Non-Stock AFL TELECO VFI4-01-0900PR VFI4 VISUAL FAULT LOCATOR WITH 2.5 MM AND 1.25 MM ADAPTERS 12-14 WEEK ARO	EA	146.00	146.00
3	1	Non-Stock AFL TELECO FS200-304-PLUS-P1-W1-A-H1-ENG-US-ASC/ FLEXSCAN, FS200-304 PLUS KIT, 1310/1550/1650 PON OTDR W/VFL, OLS/OPM, BT/WIFI, AP	EA	6,578.00	6,578.00
4	1	Non-Stock AFL TELECO FR-SMF-150-ASC-USC FR1-SM-150-ASC-SC, FIBER RING, SM, 150M LEAD TIME: 3 TO 4 WEEKS ARO	EA	215.00	215.00
5	1	Non-Stock AFL TELECO FR-SMF-150-ASC-UST FR1-SM-150-ASC-ST, FIBER RING, SM, 150M LEAD TIME: 3 TO 4 WEEKS ARO	EA	215.00	215.00
6	1	Non-Stock AFL TELECO FR-SMF-150-ASC-ULC FR1-SM-150-ASC-LC, FIBER RING, SM, 150M LEAD TIME: 3 TO 4 WEEKS ARO	EA	215.00	215.00

The impacts of COVID-19 cannot be reasonably determined at this time. This quote/proposal does not account for any potential adverse impacts COVID-19 may have on Accu-Tech's performance or obligations herein. In the event of any delays or adverse impacts, Accu-Tech reserves the right for an equitable adjustment of the delivery schedule and prices herein to offset the effects of COVID-19 delays, without fault or penalty of any kind.

BY ACCEPTING THIS QUOTE, YOU AGREE THAT THE ACCU-TECH TERMS AND CONDITIONS OF SALE PUBLISHED AT WWW.ACCU-TECH.COM/TERMSANDCONDITIONS ARE EXPRESSLY INCORPORATED INTO AND SHALL GOVERN THIS TRANSACTION.

QUOTATION

Page	2 of 2
Date	07/15/2021
Quote	Q0003MLH
Customer	Prospect

Line	Quantity	Part Number and Description	UM	Unit Price	Extended Price
------	----------	-----------------------------	----	------------	----------------

Quote Total: 9,925.00

Thank you for your business

Terms:

Freight Terms: PREPAID

Shipment:

Notes:

Currency: USD

Please refer all inquiries to:

Joseph Riccitelli

Phone: 484-498-9007

Mobile: 215-906-9834

Email: joseph.riccitelli@accu-tech.com

11 Darby Commons
FOLCROFT, PA 19032
US

Special Notes:

The impacts of COVID-19 cannot be reasonably determined at this time. This quote/proposal does not account for any potential adverse impacts COVID-19 may have on Accu-Tech's performance or obligations herein. In the event of any delays or adverse impacts, Accu-Tech reserves the right for an equitable adjustment of the delivery schedule and prices herein to offset the effects of COVID-19 delays, without fault or penalty of any kind.

BY ACCEPTING THIS QUOTE, YOU AGREE THAT THE ACCU-TECH TERMS AND CONDITIONS OF SALE PUBLISHED AT WWW.ACCU-TECH.COM/TERMSANDCONDITIONS ARE EXPRESSLY INCORPORATED INTO AND SHALL GOVERN THIS TRANSACTION.

Part Number	MSRP	Description
VF14-01-0900PR	\$150	VF14 Visual Fault Locator
FOCIS-DUEL-UA	\$2,800	FOCIS Duel Digital Connector Microscope
FS200-304-PLUS-P1-W1H-A-ENG-US-ASC/ASC	\$7,195	FlexScan FS200 - 1310/1550/1650 Pt-to-Pt & PON Verification & Troubleshooting OTDR
		Adds 150m ASC/ASC Fiber Ring, One-Click cleaner, TRM 2.0 Advanced
		Includes Source, Power Meter, Bluetooth/WiFi, hard carry case
		US power adapter
FR1-SM-150-SC-ASC	\$235	Additional 150m Fiber ring, Angled SC to SC
FR1-SM-150-ASC-ST	\$235	Additional 150m Fiber ring, Angled SC to ST
FR1-SM-150-LC-ASC	\$235	Additional 150m Fiber ring, Angled SC to LC
TRM 3.0		
	Included in above	Software to review stored inspection files (SOR) and also export them to PDF
	Included in above	Advanced license to use expert mode when reviewing/exporting stored inspection files.
Total	\$10,850	

VI. RECOMMENDATIONS BY THE PROPERTY/FACILITIES
COMMITTEE

d. Colorado Time Systems Sport Scoreboards



August 13, 2021

Denise Rogers
East Stroudsburg High School (North)
Customer # 011898

Dear Denise,

The following is the price quotation you requested. Colorado Time Systems has been the leader in sports timing for over 40 years and we are pleased that you have considered CTS to be a part of your team. Colorado Time Systems also offers a wide range of multi-sport scoreboards tailored to fit your needs – and your budget.

If you have any questions or comments, please call me at (860)882-3460 or e-mail carrie.spencer@coloradotime.com. For general sales assistance, please call (800)279-0111, option 2. Look for us online at <http://www.coloradotime.com>.

IN-DECK

<u>Qty</u>	<u>Model</u>	<u>Description</u>
6	TDP-200	Titanium deck plate

Titanium deck plates require a 4" square or 4,125" diameter circular opening at a minimum. Written verification and sign off required from customer.

**Note: Includes 5 year warranty.
CTS is the only Manufacturer of Titanium Deck Plate.**

WALL PLATE

<u>Qty</u>	<u>Model</u>	<u>Description</u>
1	WLPA	Basic aluminum wall plate kit includes near end timing components and mounting hardware

TIMING SYSTEM

<u>Qty</u>	<u>Model</u>	<u>Description</u>
1	SYS6	System 6 Sports Timer

Hardware:

Multi-sport computer console, swim keyboard insert and swimming and diving software, backlit full-color 10.4" LCD display, USB drive for software upgrades; unlimited race storage, external mouse and keyboard port, back-up rechargeable system, and built-in start input.

Software:

Swimming and diving software included, stored lap & cumulative splits, display of lap and cumulative splits to matrix displays, 12 lane competitive timing, back-up timing (software only), unlimited "meet memory", relay judging software, and direct scoreboard use.

TOUCHPADS

<u>Qty</u>	<u>Model</u>	<u>Description</u>
6	TP-60G	Aquagrip gutterhung touchpads (60" x 22") US PATENT 5,702,799
7	4000-0040	Special size Touchpad brackets

Gutter diagram/measurements must be supplied upon order

TOUCHPAD CADDY

<u>Qty</u>	<u>Model</u>	<u>Description</u>
1	CAD-TP/P	Touchpad caddy for gutterhung touchpads. Holds up to ten touchpads. Some assembly required.

START SYSTEM

<u>Qty</u>	<u>Model</u>	<u>Description</u>
1	INF-SSM	Infinity series start system with one internal, moisture and corrosion resistant 40-watt speaker, wired microphone with 25ft of data cable, internal battery with charger, and external 360-degree strobe. Tabletop or deck mounting options.

START SYSTEM ACCESSORIES

<u>Qty</u>	<u>Model</u>	<u>Description</u>
1	INF-SJ25	25' jumper cable for the Infinity series start system
1	START-FPM-2	Flagpole mount for the Infinity or Champ series start system

SCOREBOARD

<u>Qty</u>	<u>Model</u>	<u>Description</u>
1	LED-REX	Six-line LED Scoreboard: (with extended brackets)

Each module includes:

10-inch LED digits. Standard slotted strut, galvanized steel channel mounting hardware, data cables, Red digits.

Scoreboard functions:

Displays Lane, Place, and Time for lanes 1-6

SCOREBOARD ACCESSORIES

<u>Qty</u>	<u>Model</u>	<u>Description</u>
6	SP-LED-REX	Sign Panel Frame with (extended brackets) <ul style="list-style-type: none">• Three (3) Lane/Place Time Panels• Three (3) Artwork/Facility Panels

Artwork for facility and/or sponsor panel Artwork is to be provided by facility within 5 business days after receipt of order. The following graphic formats are accepted and should be sent in a 360dpi or higher scalable to 1ft in height.

- .cdr - Corel Draw
- .ai - Adobe Illustrator
- .eps - Encapsulated Post Script
- .svg - Scalable Vector Graphics

- .png - Portable Network Graphics
- .psd - Photoshop
- Jpg or jpeg - JPEG files must be a high resolution otherwise pixilation will occur.

If specific school colors are to be matched, please provide the PMS number for each color.

1 LED6-BH-REX **Single-line 6 digit Red LED Scoreboard: (with extended brackets)**

Each module includes:

10-inch LED digits. Standard slotted strut, galvanized steel channel mounting hardware, data cables.

*White letters on red lexan or White letters on clear lexan
EVENT/HEAT*

2 LED6-HG-REX **Single-line 6 digit Red LED Scoreboard: (with extended brackets)**

Each module includes:

10-inch LED digits. Standard slotted strut, galvanized steel channel mounting hardware, data cables.

*White letters on red lexan or White letters on clear lexan
HOME/GUEST - SPECIAL*

- One (1) Girls
- One (1) Boys

SHIPPING

<u>Qty</u>	<u>Model</u>	<u>Description</u>
1	ZSHIP	Estimated cost for ground shipping from Colorado Time Systems to destination.

PRICE \$31,200

Substitute:

GEN7 TIMING SYSTEM

<u>Qty</u>	<u>Model</u>	<u>Description</u>
1	GEN7-TMR-L	GEN 7 Sports Timer with legacy connections

The Gen7 Sports Timer is designed to work exclusively with existing CTS timing components and display boards. Incorporates the latest technology with all of the key features of a Colorado Time Systems Console, including up to 12-lane timing, enhanced split handling, start reaction display, automatic lane arming, interface to 3rd party meet management software, scoreboard cycling and more. The hardware and software combination gives you the flexibility to run your meets your way.

Features:

- Intuitive software interface with modern Windows user interface and is touchscreen friendly. *Software to be loaded on owner provided laptop.*

- Flexible user interface options: Windows laptop or tablet is primary user interface, with Ethernet connectivity to the timer.
- Robust safeguards, all data is logged and saved on the Gen7. Any issues with user interface are recoverable. Timer will continue running and will finish race without user interface.
- Rich diagnostics, integrated pre-meet diagnostic mode to check system set up and allows proactive equipment maintenance
- Integrated 2.4GHz Wireless to Scoreboards
- Facility network connectivity

ADD \$1,150 TO BASE PRICE

INSTALLATION

<u>Qty</u>	<u>Model</u>	<u>Description</u>
1	INSTALL	Standard Installation & Training

Installation Agreement must be signed and returned upon order

PRICE \$3,200

REMOVAL

<u>Qty</u>	<u>Model</u>	<u>Description</u>
1	REMOV	Removal of Existing Scoreboard

PRICE \$900

***Disposal of current board is the responsibility of the customer. ***

TERMS:

Purchase order or 50% down, net 30 days. Visa, MasterCard or American Express are acceptable. Quote does not include power, permits, engineering fees, delivery charges or installation, unless otherwise noted. Change order fee of 5% will apply after purchase. Returns are subject to a 25% restocking fee; custom orders including Matrix displays are nonreturnable.

Unless noted, the above pricing **DOES NOT** reflect cooperative agreement pricing, including but not limited to BuyBoard, U.S. Communities, TIPS, GoodBuy, YMCA Shared Services. Please reach out to your regional sales manager for additional information regarding the contracted pricing.

WARRANTY:

Two Year limited Warranty (One year on Dolphin Systems)

SHIPPING:

Estimated 4-6 weeks after receipt of order plus transit time, Matrix displays estimated 18-20 weeks after receipt of order.

Shipping charges are estimated and subject to change. Tailgate delivery, all unloading is done by receiver. If inside delivery is needed, please call our Sales Team at (800) 279-0111, option 2. Any additional fees will be billed to end user/facility.

TAXES:

If purchaser is tax-exempt or purchasing for resale, a copy of purchaser's tax-exempt certificate shall be required at time of order. If purchaser's tax-exempt certificate is not available purchaser shall be charged all appropriate tax.

FORCE MAJEURE:

No Party to this Agreement shall be responsible for any delays or failure to perform any obligation under this Agreement due to acts of God, outbreaks, epidemic/pandemic or the spreading of disease or contagion strikes or other disturbances, including, without limitation, war, insurrection, embargoes, governmental restrictions, acts of governments or governmental authorities, and any other cause beyond the control of such party. During an event of force majeure, the Parties' duty to perform obligations shall be suspended.

NOTE:

Price quotations valid for 30 days. All quotations are in U.S. Dollars.

Best Regards,

Carrie Tupper Spencer

Carrie Tupper Spencer
Eastern Regional Sales Manager

CS/AF



August 13, 2021

Denise Rogers
East Stroudsburg High School (South)
Customer # 014230

Dear Denise,

The following is the price quotation you requested. Colorado Time Systems has been the leader in sports timing for over 40 years and we are pleased that you have considered CTS to be a part of your team. Colorado Time Systems also offers a wide range of multi-sport scoreboards tailored to fit your needs – and your budget.

If you have any questions or comments, please call me at (860)882-3460 or e-mail carrie.spencer@coloradotime.com. For general sales assistance, please call (800)279-0111, option 2. Look for us online at <http://www.coloradotime.com>.

IN-DECK

<u>Qty</u>	<u>Model</u>	<u>Description</u>
4	TDP-200	Titanium deck plate

Titanium deck plates require a 4" square or 4.125" diameter circular opening at a minimum. Written verification and sign off required from customer.

**Note: Includes 5 year warranty.
CTS is the only Manufacturer of Titanium Deck Plate.**

WALL PLATE

<u>Qty</u>	<u>Model</u>	<u>Description</u>
1	WLPA	Basic aluminum wall plate kit includes near end timing components and mounting hardware

CABLE HARNESS

<u>Qty</u>	<u>Model</u>	<u>Description</u>
1	CHI-25-CPUA	25' interface cable from the wall plate to the Timing Console

TOUCHPADS

<u>Qty</u>	<u>Model</u>	<u>Description</u>
5	TP-60G	Aquagrip gutterhung touchpads (60" x 22") US PATENT 5,702,799
5	4000-0040	Special size Touchpad brackets

Gutter diagram/measurements must be supplied upon order

TOUCHPAD CADDY

<u>Qty</u>	<u>Model</u>	<u>Description</u>
1	CAD-TP/P	Touchpad caddy for gutterhung touchpads. Holds up to ten touchpads. Some assembly required.

SIX-LANE TOUCHPAD SYSTEM

<u>Qty</u>	<u>Model</u>	<u>Description</u>
1	TP-SYS-6	Six-lane touchpad system for the CTS timing system Includes a six-lane cable harness, one pushbutton per lane, vacuum pump and touchpad meter.

START SYSTEM

<u>Qty</u>	<u>Model</u>	<u>Description</u>
1	SS	Champion series start system with wired microphone, volume control on each microphone input, external connections for additional strobe lights, LED battery indication light, AC/DC power capabilities and an external 360° strobe. Tripod or table top options.

START SYSTEM ACCESSORIES

<u>Qty</u>	<u>Model</u>	<u>Description</u>
1	START-FPM-2	Flagpole mount for the Infinity or Champ series start system
1	R-SJ25	25' jumper cable for the Champion series start system

TIMING SYSTEM

<u>Qty</u>	<u>Model</u>	<u>Description</u>
1	SYS6	System 6 Sports Timer <i>Hardware:</i> Multi-sport computer console, swim keyboard insert and swimming and diving software, backlit full-color 10.4" LCD display, USB drive for software upgrades; unlimited race storage, external mouse and keyboard port, back-up rechargeable system, and built-in start input. <i>Software:</i> Swimming and diving software included, stored lap & cumulative splits, display of lap and cumulative splits to matrix displays, 12 lane competitive timing, back-up timing (software only), unlimited "meet memory", relay judging software, and direct scoreboard use.

SHIPPING

<u>Qty</u>	<u>Model</u>	<u>Description</u>
1	ZSHIP	Estimated cost for ground shipping from Colorado Time Systems to destination.

PRICE \$14,150

Substitute:

GEN7 TIMING SYSTEM

<u>Qty</u>	<u>Model</u>	<u>Description</u>
1	GEN7-TMR-L	GEN 7 Sports Timer with legacy connections The Gen7 Sports Timer is designed to work exclusively with existing CTS timing components and display boards. Incorporates the latest technology with all of the key features of a Colorado Time Systems Console,

including up to 12-lane timing, enhanced split handling, start reaction display, automatic lane arming, interface to 3rd party meet management software, scoreboard cycling and more. The hardware and software combination gives you the flexibility to run your meets your way.

Features:

- Intuitive software interface with modern Windows user interface and is touchscreen friendly. *Software to be loaded on owner provided laptop.*
- Flexible user interface options: Windows laptop or tablet is primary user interface, with Ethernet connectivity to the timer.
- Robust safeguards, all data is logged and saved on the Gen7. Any issues with user interface are recoverable. Timer will continue running and will finish race without user interface.
- Rich diagnostics, integrated pre-meet diagnostic mode to check system set up and allows proactive equipment maintenance
- Integrated 2.4GHz Wireless to Scoreboards
- Facility network connectivity

ADD \$1,100 TO BASE PRICE

Customer would like to re-use current board. Scoreboard is 15 years old.

INSTALLATION

<u>Qty</u>	<u>Model</u>	<u>Description</u>
1	INSTALL	Standard Installation & Training

Installation Agreement must be signed and returned upon order

PRICE \$3,200

***If install for both North and South is completed at same time, the install price will drop to \$2500 per school.**

TERMS:

Purchase order or 50% down, net 30 days. Visa, MasterCard or American Express are acceptable. Quote does not include power, permits, engineering fees, delivery charges or installation, unless otherwise noted. Change order fee of 5% will apply after purchase. Returns are subject to a 25% restocking fee; custom orders including Matrix displays are nonreturnable.

Unless noted, the above pricing **DOES NOT** reflect cooperative agreement pricing, including but not limited to BuyBoard, U.S. Communities, TIPS, GoodBuy, YMCA Shared Services. Please reach out to your regional sales manager for additional information regarding the contracted pricing.

WARRANTY:

Two Year limited Warranty (One year on Dolphin Systems)

SHIPPING: Estimated 4-6 weeks after receipt of order plus transit time, Matrix displays estimated 18-20 weeks after receipt of order.

Shipping charges are estimated and subject to change. Tailgate delivery, all unloading is done by receiver. If inside delivery is needed, please call our Sales Team at (800) 279-0111, option 2. Any additional fees will be billed to end user/facility.

TAXES: If purchaser is tax-exempt or purchasing for resale, a copy of purchaser's tax-exempt certificate shall be required at time of order. If purchaser's tax-exempt certificate is not available purchaser shall be charged all appropriate tax.

FORCE MAJEURE: No Party to this Agreement shall be responsible for any delays or failure to perform any obligation under this Agreement due to acts of God, outbreaks, epidemic/pandemic or the spreading of disease or contagion strikes or other disturbances, including, without limitation, war, insurrection, embargoes, governmental restrictions, acts of governments or governmental authorities, and any other cause beyond the control of such party. During an event of force majeure, the Parties' duty to perform obligations shall be suspended.

NOTE: Price quotations valid for 30 days. All quotations are in U.S. Dollars.

Best Regards,

Carrie Tupper Spencer

Carrie Tupper Spencer
Eastern Regional Sales Manager

CS/AF



INSTALLATION AGREEMENT Aquatic Timing/Scoring Equipment

FACILITY NAME:

TO:

FAX:

PHONE:

FROM: Installation Coordinator – Phil Woods

NUMBER OF PAGES TOTAL (2)

Date:

Customer #

Colorado Time Systems. (CTS) is pleased to supervise and/or assist with the installation of CTS products at your facility.

To provide you with professional assistance, CTS requires all of the following items prior to our arrival:

1. 120 VAC circuits must be supplied to each Display or Scoreboard as designated in the electrical information provided by CTS and ongoing access must be given to the electrical switches and or breakers as necessary. (CTS highly recommends the addition of a main power ON/OFF switch for each scoreboard location at a location readily available to the equipment operators.)
2. PVC conduits with wall/deck boxes must be installed per CTS specifications and must have pull strings in place.
3. Equipment for installation must be physically present at installation location and readily available.
4. Mounting location (wall) must be of CMU type material. If not, a special structural mount may be required for the Display/Scoreboard; it must be completed prior to the arrival of CTS's Customer Service Specialist.
5. A two-man scissors lift (or equivalent) must be provided, and available for the entire time the CTS Customer Service Specialist is on-site.
6. All deck work must be completed (concrete, tile, grout, etc.), all painting in the vicinity of the install location must be completed and the installation areas must be free of any obstructions (including dust, dirt, construction materials, and trash) prior to the arrival of CTS's Customer Service Specialist.
7. Two semi-skilled labors must be available to assist with the installation process under the direction of the CTS's Customer Service Specialist, and be dedicated for that sole purpose. The number and quality of laborers determines the time necessary for completion.

Is the labor to be provided Union Workers YES NO

8. Your intended equipment operators of the CTS products must be available for a training session to be conducted by the Customer Service Specialist. The training session typically occurs on the last day of the installation process, but this is to be scheduled thru the Customer Service Specialist and may be subject to change.
9. Pictures (digital or otherwise) of any intended mounting location(s) of scoreboards, etc.

As your equipment arrives from CTS, please keep all the boxes and pallets together. If the packages show visible damage, it is permissible to check the contents for damage. We ask that you immediately report any damage to your CTS Sales Representative.

Initial here: _____

Please indicate on the line below, any deadline dates such as grand openings, competitive meets, of which you would like to have the installation completed for.

DATES: _____

Date you may require the installation assistance/ supervision to occur: _____

When committing CTS to an install date, please verify that the installation location will be ready for installation on the agreed date as postponement of this date will be subject to a \$500.00 rescheduling fee and possible lengthy delays (typically 4 to 6 weeks). If the Customer Service Specialist arrives at the installation location and determines that installation or training can not take place due to non-compliance of items 1 thru 9 or consequences beyond CTS's control a \$2500.00 fee will be imposed to cover the costs of a second trip to your installation location.

Your Name: _____
Your Title: _____
Company: _____
Phone/Fax: _____

IMPORTANT Names of additional contacts with their title and as many phone numbers or E-mail addresses as possible:

Contacts: _____

Scheduling of the installation date is contingent on the completion of this form. *Please respond as soon as possible by faxing a signed copy of both pages of this Installation Agreement to (970) 667-1032 ATTN: Installation Coordinator.* Please allow us 4 to 6 weeks notice prior to your desired installation date.

I have read, understand and accept the terms of this Colorado Time Systems. *Installation Agreement.* Please sign below:

(Your Signature)

(Today's Date)

If you have any questions pertaining to this agreement, please feel free to contact your Installation Coordinator at (970) 667-1000 X 3, FAX: (970) 667-1032. Thank you for your attention and business.

Our Contact
 EVE JULIAN
 811/835-2611
 safes@istime.com



Ship To
 East Stroudsburg High School - South
 Samantha Munford
 East Stroudsburg PENNSYLVANIA 18301
 570-424-8471 ext. 34611
 samantha-munford@esasd.net

Quote	
Quote	Customer
Q17788	10660
Quote Date	Quote Valid Until
4/27/2021	5/27/2021

Your Reference	Account Manager	Payment Terms
	Eve - 800-835-2611	NET 30
Sales Terms	Freight Terms	Lead Time
FOB DESTINATION	Billed	4 Weeks

Item	Description	Quantity	% Disc	Unit Price	Amount
TIMEWARE3	TIMEWARE3 SWIM TIMING SOFTWARE. TURNS YOUR LAPTOP INTO A TIMING CONSOLE (LAPTOP NOT INCLUDED).	1.00	10	\$540.00	\$540.00
TMW-R	ADD RESULTS INTERFACE TO HY-TEK MEET MANAGER. HY-TEK'S TIMING CONSOLE INTERFACE ALSO REQUIRED.	1.00	10	\$180.00	\$180.00
TMW-S	ADD SCOREBOARD INTERFACE TO SEND DATA TO IST SCOREBOARDS. HY-TEK'S ALPHA SCOREBOARD INTERFACE REQUIRED TO SHOW NAMES	1.00	10	\$180.00	\$180.00
CTH11-S-C	COMPUTER TIMING INTERFACE - 20 INPUTS FOR 1 DECK CABLE, IST/COLO PADS, COLO SCBD	1.00	10	\$765.00	\$765.00
SWDECK4-10Y	DECK CABLE 4 LANE WITH 10 YARD TAIL & STANDARD IST 25 PIN CN ACCOMMODATES 2 BACKUP BUTTONS OR 1 BUTTON & 1 PAD PER LANE	1.00	10	\$558.00	\$558.00
SWBACKUP-10	BACKUP BUTTON WITH 10' WIRE	4.00	10	\$54.00	\$216.00
TP6022	SEALED TOUCHPAD 60 x 22 WITH SLIP-FREE COMFORT SURFACE INCLUDES CUSTOM BRACKETS (FOR 78 PADS ADD \$279 PER PAD)	4.00	10	\$846.00	\$3,384.00
Total:					

Our Contact

EVE JULIAN
 811/835-2611
 sales@istime.com



Industrial Service Technology
 OR International Sports Timing
 3286 Kentland Ct. SE
 Grand Rapids, MI 49548

Ship To

East Stroudsburg High School - South
 Samantha Munford
 East Stroudsburg PENNSYLVANIA 18301
 570-424-8471 ext. 34611
 samantha-munford@esasd.net

Quote

Quote	Customer
Q17788	10660
Quote Date	Quote Valid Until
4/27/2021	5/27/2021

Your Reference	Account Manager	Payment Terms
	Eve - 800-835-2611	NET 30
Sales Terms	Freight Terms	Lead Time
FOB DESTINATION	Billed	4 Weeks

Item	Description	Quantity	% Disc	Unit Price	Amount
BR0445-X	GENERIC BRACKET, CHOOSE YOUR BRACKET FROM IST BRACKET SELECTOR	4.00	0	\$0.00	\$0.00
SWIMSTART	ELECTRONIC STARTING SYSTEM WITH WIRED MICROPHONE.	1.00	10	\$801.00	\$801.00
SWSTRTCBL-25	SWIMSTART CABLE - 25' CONNECTS START TO TIMER	1.00	10	\$63.00	\$63.00
Sub-Total:					\$6,687.00
Estimated Freight: TRUCK SWM					\$530.00
Total:					\$7,217.00

VI. RECOMMENDATIONS BY THE PROPERTY/FACILITIES
COMMITTEE

e. Resica and Middle Smithfield Water Filtration



D'HUY Engineering, Inc.

East Stroudsburg Area School District
 Resica E.S. Middle Smithfield E.S. Water Filtration
 DEI Project No. 287016

BID TABULATION
 September 1, 2021

	KC Mechanical Services, Inc.	Leon Clapper Plumbing
CONTRACT 1 - BASE BID - RESICA ELEMENTARY SCHOOL	\$ 142,000.00	NO BID
CONTRACT 2 - BASE BID - MIDDLE SMITHFIELD ELEMENTARY SCHOOL	\$ 79,000.00	NO BID
CONTRACT 3 - BASE BID - TOTAL CONTRACT PRICE FOR BOTH SCHOOLS	\$ 221,000.00	\$ 170,000.00

CONTRACT 1 - Base Bid Plus Proposed Alternates:	\$ 142,000.00	NO BID
\$ Above Low:	\$ -	NO BID

CONTRACT 2 - Base Bid Plus Proposed Alternates:	\$ 79,000.00	NO BID
\$ Above Low:	\$ -	NO BID

CONTRACT 3 - Base Bid Plus Proposed Alternates:	\$ 221,000.00	\$ 170,000.00
\$ Above Low:	\$ 51,000.00	\$ -



D'HUY Engineering, Inc.

East Stroudsburg Area School District
 Resica E.S. Middle Smithfield E.S. Water Filtration
 DEI Project No. 287016

BID TABULATION
 September 1, 2021

	KC Mechanical Services, Inc.	Leon Clapper Plumbing
CONTRACT 1 - BASE BID - RESICA ELEMENTARY SCHOOL	\$ 142,000.00	NO BID
CONTRACT 2 - BASE BID - MIDDLE SMITHFIELD ELEMENTARY SCHOOL	\$ 79,000.00	NO BID
CONTRACT 3 - BASE BID - TOTAL CONTRACT PRICE FOR BOTH SCHOOLS	\$ 221,000.00	\$ 170,000.00
CONTRACT 1 - Base Bid Plus Proposed Alternates: \$ 142,000.00 NO BID		
\$ Above Low: \$ - NO BID		
CONTRACT 2 - Base Bid Plus Proposed Alternates: \$ 79,000.00 NO BID		
\$ Above Low: \$ - NO BID		
CONTRACT 3 - Base Bid Plus Proposed Alternates: \$ 221,000.00 \$ 170,000.00		
\$ Above Low: \$ 51,000.00 \$ -		

VI. RECOMMENDATIONS BY THE PROPERTY/FACILITIES
COMMITTEE

f. Current Projects List

	North HS/Lehman Roof Project 30-819-3036		Resica Roof Project 10-215-3060		Resica Flooring Replacement A/C 10-215-3073	
Vendor	6084	Jottan, Inc	1237	C&D WaterProofing Corp.	6554	Cope Carpet Project # 287020
Original Bid	3/18/2019	\$ 7,008,635.00	3/18/2019	\$ 667,715.00	4/14/2020	\$ 303,780.00
Application 1	7/11/2019	\$ 1,215,862.00	8/5/2019	\$ 8,685.00	5/27/2020	\$ 119,970.00
Application 2	8/25/2019	\$ 1,606,698.90	8/5/2019	\$ 55,401.75	6/24/2020	\$ 65,700.00
Application 3	9/3/2019	\$ 251,595.00	8/6/2019	\$ 207,513.90	8/16/2020	\$ 73,746.50
Application 4	9/23/2019	\$ 430,171.08	9/3/2019	\$ 176,615.10	11/17/2020	\$ 18,193.50
Application 5	10/31/2019	\$ 286,863.89	9/30/2019	\$ 78,601.50		
Application 6	12/27/2019	\$ 191,004.88	10/31/2019	\$ 26,318.25		
Application 7	6/24/2020	\$ 684,263.62	12/9/2019	\$ 5,175.00		
Application 8	7/27/2020	\$ 809,515.90	2/26/2020	\$ 35,230.50		
Application 9	8/19/2020	\$ 688,435.55	3/31/2020	\$ 9,860.00		
Application 10	9/18/2020	\$ 219,415.32	6/30/2020	\$ 35,757.95		
Application 11	11/20/2020	\$ 304,220.48				
Application 12	4/26/2021	\$ 160,488.38				
Application 13	6/29/2021	\$ 17,500.00				
Total Payments to Date		\$ 6,866,035.00		\$ 639,158.95		\$ 277,610.00
Left on Contract		\$ 142,600.00		\$ 28,556.05		\$ 26,170.00
Completion Percentage		98%		96%		91%
		\$ 451,768.00		\$ 9,700.00		
		30 year warranty		30 year warranty		
D'Huy Engineering 1446	9/28/2018	\$ 1,295.33	02/27/2019	\$ 1,656.02	3/31/2020	\$ 4,500.00
	9/28/2018	\$ 8,179.67	03/26/2019	\$ 7,793.98	4/24/2020	\$ 5,784.75
	12/3/2018	\$ 3,425.00	04/16/2019	\$ 5,499.99	6/24/2020	\$ 2,943.70
	2/27/2019	\$ 8,595.06	05/13/2019	\$ 2,000.01	8/11/2020	\$ 8,800.30
	3/26/2019	\$ 18,500.30	06/25/2019	\$ 6,420.03	8/31/2020	\$ 2,938.50
	3/26/2019	\$ 38,129.94	08/23/2019	\$ 5,638.76	10/20/2020	\$ 1,469.25
	5/13/2019	\$ 24,500.28	08/23/2019	\$ 1,372.24	11/17/2020	\$ 1,469.25
	6/5/2019	\$ 18,207.30	10/25/2019	\$ 4,674.01	12/14/2020	\$ 881.55
	6/25/2019	\$ 15,000.22	11/20/2019	\$ 2,337.00	1/20/2021	\$ 550.00
	8/23/2019	\$ 20,000.45	1/3/2020	\$ 2,337.00		
	8/23/2019	\$ 20,000.45	1/28/2020	\$ 2,337.00		
	8/31/2019	\$ 25,000.20	2/26/2020	\$ 2,337.00		
	8/31/2019	\$ 1,577.48	3/19/2020	\$ 1,402.20		
	9/27/2019	\$ 25,000.20	4/8/2020	\$ 934.80		
	9/27/2019	\$ 425.00				
	10/25/2019	\$ 32,367.60				
	12/27/2019	\$ 3,067.25				
	1/31/2020	\$ 2,748.37				
	2/28/2020	\$ 2,295.04				
	3/31/2020	\$ 1,350.14				
	6/24/2020	\$ 12,000.18				
	6/26/2020	\$ 33,000.48				
	7/31/2020	\$ 24,500.27				
	8/28/2020	\$ 34,189.21				
	9/25/2020	\$ 30,000.43				
	10/30/2020	\$ 19,059.97				
	1/20/2021	\$ 3,340.52				
	2/16/2021	\$ 3,000.05				
	6/30/2021	\$ 1,092.08				
		\$ 429,848.47		\$ 46,740.04		\$ 29,337.30

	North HS/Lehman Hot Water Replacement 30-19-3061		JM Hill Modify Vestibule/Replace Interior Gym Doors Board Approved 4/19/21 10-213-3084		North HS Sanitary Lagoon Liner Replacement Board Approval 4/19/21 30-819-3085	
Vendor	JBM Mechanical, inc Contr.Project # M19007		Bognet Inc. Project# 287028		Atlantic Lining Company Project # 2875023	
Original Bid	6466	3585	6926			
	\$ 300,000.00	\$ 138,286.00	\$ 549,833.60			
Application 1	1/28/2020	\$ 230,850.00	6/29/2021	\$ 9,000.54	7/15/2021	\$ 261,000.00
Application 2	3/8/2021	\$ 36,150.00	7/12/2021	\$ 3,477.55		
Application 3			8/24/2021	\$ 18,609.39		
Application 4						
Application 5						
Application 6						
Application 7						
Application 8						
Application 9						
Application 10						
Application 11						
Application 12						
Application 13						
Total Payments to Date	\$ 267,000.00		\$ 31,087.48		\$ 261,000.00	
Left on Contract	\$ 33,000.00		\$ 107,198.52		\$ 288,833.60	
Completion Percentage	89%		22%		47%	
D'Huy Engineering 1446	03/26/2019	\$ 1,556.24	5/10/2021	\$ 1,787.00		
	04/16/2019	\$ 8,943.76	6/30/2021	\$ 420.17		
	05/13/2019	\$ 5,267.50	8/10/2021	\$ 643.55		
	06/05/2019	\$ 1,126.25				
	06/25/2019	\$ 2,252.50				
	08/23/2019	\$ 840.00				
	08/23/2019	\$ 980.00				
	10/25/2019	\$ 599.99				
	11/20/2019	\$ 840.00				
	3/18/2021	\$ 491.41				
	\$ 22,897.65		\$ 2,850.72		\$ -	

VII. RECOMMENDATIONS BY THE EDUCATION P & R
COMMITTEE

- a. Houghton Mifflin Harcourt - Leveled Readers pilot, quote
- \$11,050 to be funded by ESSERs III

Name of Requestor *

Vitulli

Untitled Title

Department *

C&I

Building *

admin

What service or item are requesting *

Grade 3-5 leveled readers

Why are you requesting the service or item *

new ELA program pilot program

Suggested replacement *

none

Please complete an independent Cost Analysis. (Pre-determine costs prior to contacting a vendor.)

cost analysis was part of the vetting process

Cost Estimate: if over \$5,000, were three (3) quotes obtained? If yes, please list the vendor's information and quoted amount. *

N/A

What is the total cost of the purchase? *

\$11,050

Procurement Method: *

- Quote Received only one Proposal
- Request for Proposal (RFP)
- Bid
- Other: _____

Was this purchase budgeted? *

Yes

Was this purchased through a PA State Contract or Approved Consortiums? If yes, select group.

- Yes
- Pennsylvania State Contract
- COSTARS
- Keystone Purchasing Network
- PEPPM National Contract Program (Technology Bidding and Purchasing)

US Communities

No

If item was purchased through a Pa State Contract or approved Consortium, please include contract number.

Which Fund will be charged? *

10

What account will be charged? *

ESSERs III

Selection of the winning proposal, was the lowest price selected? If not, please explain why and the process of selecting the vendor. *

n/a

Any additional information you would like to provide.

[Quoted text hidden]

Form 611

MUST BE COMPLETED FOR ANY PROCUREMENT OF A SERVICE OR ITEM OVER \$5,000.00

The respondent's email (**william-vitulli@esasd.net**) was recorded on submission of this form.

Untitled Section

Untitled Section

FORM 611

EAST STROUDSBURG AREA SCHOOL DISTRICT

Procurement Form

Name of Requestor *

Vitulli

Untitled Title

Department *

C&I

Building *

admin

What service or item are you requesting *

Houghton Mifflin Harcourt - Elementary ELA resource

Why are you requesting the service or item *

need for new resource

Suggested replacement *

Houghton Mifflin Harcourt

Please complete an independent Cost Analysis. (Pre-determine costs prior to contacting a vendor.)

n/a

Cost Estimate: If over \$5,000, were three (3) quotes obtained? If yes, Please list the vendor's information and quoted amount. *

10 different vendors were reviewed

What is the total cost of the purchase? *

\$11,050

Procurement Method: *

- Quote
- Request for Proposal (RFP)
- Bid
- Other:

Was this purchase budgeted? *

Yes ▼

Was this purchased through a PA State Contract or Approved Consortiums? If yes, select group.

- Yes
- Pennsylvania State Contract
- COSTARS
- Keystone Purchasing Network
- PEPPM National Contract Program (Technology Bidding and Purchasing)
- US Communities
- NO

If item was purchased through a Pa State Contract or approved Consortium, please include contract number.

Which Fund will be charged? *

10 ▼

What account will be charged *

For Craig to decide - Curriculum or ESSERS III

Selection of the winning proposal, was the lowest price selected? If not, please explain why and the process of selecting the vendor. *

10 vendors reviewed over past year

Any additional information you would like to provide.

none

This form was created inside of East Stroudsburg Area School District.





Houghton Mifflin Harcourt

Proposal
Prepared For
East Stroudsburg Area Sch Dist

50 Vine St
E Stroudsburg PA 18301

Attention:
Tabitha Bradley
tabitha-bradley@esasd.net

For the Purchase of:
Into Reading GR3-5 Leveled Libraries

Prepared By
Colleen LaBarbera
colleen.labarbera@hmc.com

Please submit this proposal with your purchase order.

Purchase orders or duly executed service agreements for **Professional Services** purchased, must be submitted at least 30 days before the service event date.

Attention:
Tabitha Bradley
tabitha-bradley@esasd.net

Customer Experience
9400 South Park Center Loop
Orlando, FL 32819
FAX: 800-269-5232
k12orders@hmc.com

HMH Confidential and Proprietary

Proposal for East Stroudsburg Area Sch Dist

ISBN	Title	Price	Quantity	Value of All Materials
Grade 3				
Student				
1736280 9780358001539	Into Reading Rigby Leveled Library with Take and Teach Lessons Grade 3	\$1,000.00	3	\$3,000.00
Total for Student				
Total for Grade 3		\$3,000.00		
Grade 4				
Student				
1736281 9780358001546	Into Reading Rigby Leveled Library with Take and Teach Lessons Grade 4	\$1,000.00	3	\$3,000.00
Total for Student				
Total for Grade 4		\$3,000.00		
Grade 5				
Student				
1736282 9780358001553	Into Reading Rigby Leveled Library with Take and Teach Lessons Grade 5	\$1,000.00	4	\$4,000.00
Total for Student				
Total for Grade 5		\$4,000.00		

<i>Total Savings:</i>	\$0.00
<i>Subtotal Purchase Amount:</i>	\$10,000.00
<i>Shipping & Handling:</i>	\$1,050.00
<i>Total Cost of Proposal (PO Amount):</i>	\$11,050.00

Please add proper sales tax to your order

Attention:
Tabitha Bradley
tabitha-bradley@esasd.net

Customer Experience
9400 South Park Center Loop
Orlando, FL 32819
FAX: 800-269-5232
k12orders@hnhco.com

HMH Confidential and Proprietary

Proposal for
East Stroudsburg Area Sch Dist

Total Cost of Proposal (PO Amount): \$11,050.00

Thank you for considering HMH as your partner. We are committed to providing an excellent experience and delivering ongoing, high-quality service to our customers. To meet these goals, we want to ensure you are aware of the below Terms of Purchase. These terms help us process your order quickly, efficiently, and accurately, ensuring successful delivery and implementation of our solutions.

- Please return this cost proposal with your signed purchase order that matches product, prices and shipping charges.
- Provide the exact address for *delivery* of print materials. The shipping address may be your district warehouse or individual school sites, but it is essential that this is accurate.
- Please supply the name of each important district point of contact for all aspects of the solution including their direct contact information (email/phone):
 - o Point of Contact for Print materials
 - o Point of Contact for Digital materials
 - o Point of Contact for Scheduling Professional Development
- Please confirm that we have the correct 'Ship to' and 'Sold to' information on the cost proposal.

Ship to:
 East Stroudsburg Area Schl Dist
 50 Vine St
 East Stroudsburg, PA 18301-2150

Sold to:
 East Stroudsburg Area Schl Dist
 50 Vine St
 East Stroudsburg, PA 18301-2150

- Please provide funding start and end dates.
- Please note that all products and services will be billed upon the processing of your purchase order.
- Our payment terms are 30 days from the invoice date.
- Print subscription material quantities may be adjusted across grades for like products, to accommodate enrollment fluctuations, quantities cannot be adjusted between different programs or copyrights.
- Our shipping terms are FOB shipping point. The shipping term for your proposal is Shipping Point.
- Should any of these Terms of Sale conflict with any preprinted terms on your purchase order, the HMH terms of service shall apply.

Thank you in advance for supplying us with the necessary information at time of purchase. Our goal is to ensure your success throughout the duration of this agreement, which starts with a highly successful delivery of our solution.

For greater detail, the complete Terms of Purchase may be reviewed here: <http://www.hmhco.com/common/terms-conditions>

Date of Proposal: 8/16/2021

Proposal Expiration Date: 9/30/2021



Houghton Mifflin Harcourt

Attention:
 Tabitha Bradley
 tabitha-bradley@esasd.net

Customer Experience
 9400 South Park Center Loop
 Orlando, FL 32819
 FAX: 800-269-5232
 k12orders@hnhco.com

HMH Confidential and Proprietary

VII. RECOMMENDATIONS BY THE EDUCATION P & R
COMMITTEE

b. Acadience, quote - \$2,325 to be funded by ESSERs III

Form 611

MUST BE COMPLETED FOR ANY PROCUREMENT OF A SERVICE OR ITEM OVER \$5,000.00

The respondent's email (william-vitulli@esasd.net) was recorded on submission of this form.

Untitled Section

Untitled Section

FORM 611

EAST STROUDSBURG AREA SCHOOL DISTRICT
Procurement Form

Name of Requestor *

vitulli

Untitled Title

Department *

C&I

Building *

admin

What service or item are requesting *

Acadience subscription

Why are you requesting the service or item *

Evaluation tool for reading progress...used by district for at least last 10 years

Suggested replacement *

none

Please complete an independent Cost Analysis. (Pre-determine costs prior to contacting a vendor.)

n/a

Cost Estimate: if over \$5,000, were three (3) quotes obtained? If yes, please list the vendor's information and quoted amount. *

n/a

What is the total cost of the purchase? *

\$2,325.00

Procurement Method: *

- Quote Received only one Proposal
- Request for Proposal (RFP)
- Bid
- Other:

Was this purchase budgeted? *

Yes ▼

Was this purchased through a PA State Contract or Approved Consortiums? If yes, select group.

- Yes
- Pennsylvania State Contract
- COSTARS
- Keystone Purchasing Network
- PEPPM National Contract Program (Technology Bidding and Purchasing)
- US Communities
- No

If item was purchased through a Pa State Contract or approved Consortium, please include contract number.

Which Fund will be charged? *

10

What account will be charged? *

ESSERs III

Selection of the winning proposal, was the lowest price selected? If not, please explain why and the process of selecting the vendor. *

n/a sole provider

Any additional information you would like to provide.

This form was created inside of East Stroudsburg Area School District.

Google Forms



Voyager Sopris Learning
 Cambium Learning Group, Inc.
 Attn: Order Entry Department
 17865 Dallas Pkwy, Suite 400
 Dallas, Texas 75287
 Phone: (800) 547-6747
 Fax: (888) 819-7767
 Email: CustomerService@voyagersopris.com

Quote Number 00108514
 Created Date 8/16/2021

Quote To Tabitha Bradley
 Phone 5704248500
 Email tabitha-bradley@esasd.net

Bill To Name East Stroudsburg Area Sch Dist
 Bill To 50 Vine St
 E Stroudsburg, PA 18301
 US
 Ship To Name East Stroudsburg Area Sch Dist
 Ship To 50 Vine St
 E Stroudsburg, PA 18301
 US

Sales Executive

Dutch Whigham
 9456
dutch.whigham@voyagersopris.com

Description	Product Code	Quantity	Sales Price	Total Price
Acadience Reading Customer Loyalty for previous ADM users	371362	2,325.00	\$1.00	\$2,325.00
Total Price			\$2,325.00	
S&H			\$0.00	
Tax			\$0.00	
Total Due			\$2,325.00	

Comments

*Add sales tax for your state (from subtotal) if applicable. Taxes on quote are an estimate only and are subject to change when the order is placed.

All Acadience licenses are annual licenses (Aug 1-July 31). Licenses may expire at a later date if a multi-year deal is purchased; the expiration date will be noted at the time of receiving the Purchase Order.

- Support Services purchased (days, webinar & virtual hours) will expire 12 months from the received date of the Purchase Order.
- A contact name and email address are required for all products with digital components.

VII. RECOMMENDATIONS BY THE EDUCATION P & R
COMMITTEE

c. Discovery Education Services CIU20, quote - \$4,418.52

Form 611

MUST BE COMPLETED FOR ANY PROCUREMENT OF A SERVICE OR ITEM OVER \$5,000.00

The respondent's email (william-vitulli@esasd.net) was recorded on submission of this form.

Untitled Section

Untitled Section

FORM 611

EAST STROUDSBURG AREA SCHOOL DISTRICT
Procurement Form

Name of Requestor *

Vitulli

Untitled Title

Department *

C&I

Building *

Admin

What service or item are requesting *

Discovery Ed - Video Streaming Service

Why are you requesting the service or item *

For use with classroom teaching

Suggested replacement *

sole provider

Please complete an independent Cost Analysis. (Pre-determine costs prior to contacting a vendor.)

n/a

Cost Estimate: if over \$5,000, were three (3) quotes obtained? If yes, please list the vendor's information and quoted amount. *

n/a

What is the total cost of the purchase? *

\$4,418.52

Procurement Method: *

Quote Received only one Proposal

Request for Proposal (RFP)

Bid

Other: _____

Was this purchase budgeted? *

Yes



Was this purchased through a PA State Contract or Approved Consortiums? If yes, select group.

Yes

Pennsylvania State Contract

COSTARS

Keystone Purchasing Network

PEPPM National Contract Program (Technology Bidding and Purchasing)

US Communities

No

If item was purchased through a Pa State Contract or approved Consortium, please include contract number.

Purchased through CIU20 @ 50% discount

Which Fund will be charged? *

10 ▼

What account will be charged? *

ESSERs III

Selection of the winning proposal, was the lowest price selected? If not, please explain why and the process of selecting the vendor. *

n/a

Any additional information you would like to provide.

This form was created inside of East Stroudsburg Area School District.



COLONIAL INTERMEDIATE UNIT 20
A Regional Service Agency
6 Danforth Drive
Easton, Pennsylvania 18045-7899

CONTRACT FOR SERVICE
(REVENUE GENERATING)

This contract is entered into by Colonial Intermediate Unit 20, 6 Danforth Drive, Easton, Pennsylvania 18045-7899 and East Stroudsburg Area School District, 50 Vine Street, East Stroudsburg, PA 18301, (570) 424-8500.

Colonial Intermediate Unit 20 will provide Discovery Education Streaming Plus to East Stroudsburg Area School District.

The fee for this service is \$0.73 per student, for 5,280 students and a minimum fee charge for two buildings at \$262.50 per building. This contract shall not exceed \$4,379.40 and will be in effect from July 1, 2021 through June 30, 2022.

East Stroudsburg Area School District will be billed for services rendered by Colonial Intermediate Unit 20.

The signed contract must be returned to Mr. Jon Wallitsch, Director of Fiscal Affairs, at the Intermediate Unit Office.



Mr. Jon Wallitsch
Director of Fiscal Affairs

8/27/21
Date

East Stroudsburg Area School District
Superintendent

Date

Federal ID Number

To comply with Federal laws, State laws, and State Department of Education regulations concerning equal rights and opportunities and to assure these within our Intermediate Unit, the Colonial Intermediate Unit 20 declares itself to be an equal rights and opportunities agency. As an equal rights and opportunities agency, it does not discriminate against individuals or groups because of race, color, national origin, religion, age, sex and disabilities as defined by law. The Intermediate Unit's commitment to non-discrimination extends to students, employees, prospective employees, and the community.

Successful performance and affirmative action program efforts will provide positive benefits to the Intermediate Unit through fuller utilization and development of previously underutilized human resources. Coordinator of Title IX, Section 504 and ADA is The Director of Human Resources and Research Services, Colonial Intermediate Unit 20, 6 Danforth Drive, Easton, PA 18045, (610) 515-6405, TDD/TTY Hearing Impaired (610) 252-3786.



COLONIAL

Intermediate Unit 20

Dedicated to your children and the people who serve them

6 Danforth Drive
 Easton PA 18045-7899
 p 610-252-5550
 f 610-252-5740
 www.clu20.org

August 11, 2021

Renewal of Discovery Education Services (DEX) for 2021-22 School Year

East Stroudsburg Area SD
 William Vitulli
william-vitulli@esasd.net
 50 Vine Street
 East Stroudsburg, PA 18301
 570-424-8060

Discovery Education Experience (DEX)	\$1.46 per student \$525.00 minimum per building
---	---

*Cost Per Student	\$.73
	Bushkill 306
	ESE 556
	North 942
	South 1256
	Lehman 583
	JTL 912
	Resica 360
*Number of Students	MSE 323
	JMH 365
	SMI 296
	*Minimum Fees Apply \$525.00 minimum if under 360 students
	Total 5899 students (4,974 x .1.46) and 3 Buildings at \$525.00
*Total Cost	\$4,418.52

VII. RECOMMENDATIONS BY THE EDUCATION P & R
COMMITTEE

- d. Furniture purchase for South High School, quote -
\$26,814.56 funded by ATSI Grant

Form 611

MUST BE COMPLETED FOR ANY PROCUREMENT OF A SERVICE OR ITEM OVER \$5,000.00

The respondent's email (william-vitulli@esasd.net) was recorded on submission of this form.

Untitled Section

Untitled Section

FORM 611

EAST STROUDSBURG AREA SCHOOL DISTRICT
Procurement Form

Name of Requestor *

vitulli

Untitled Title

Department *

C&I

Building *

Admin

What service or item are requesting *

Furniture for HS South

Why are you requesting the service or item *

replace existing furniture with more modern to impact student learning

Suggested replacement *

None

Please complete an independent Cost Analysis. (Pre-determine costs prior to contacting a vendor.)

Using CoStars Vendor

Cost Estimate: if over \$5,000, were three (3) quotes obtained? If yes, please list the vendor's information and quoted amount. *

Cumulative order is \$26,814.56 as a result of PEM CO. working with various vendors

What is the total cost of the purchase? *

\$26,814.56

Procurement Method: *

Quote Received only one Proposal

Request for Proposal (RFP)

Bid

Other:

Was this purchase budgeted? *

No

Was this purchased through a PA State Contract or Approved Consortiums? If yes, select group.

Yes

Pennsylvania State Contract

COSTARS

Keystone Purchasing Network

PEPPM National Contract Program (Technology Bidding and Purchasing)

US Communities

No

If item was purchased through a Pa State Contract or approved Consortium, please include contract number.

Which Fund will be charged? *

10

What account will be charged? *

ATSI Grant - See Angela Burns

Selection of the winning proposal, was the lowest price selected? If not, please explain why and the process of selecting the vendor. *

n/a

Any additional information you would like to provide.

Final dollars for ATSI grant - South

This form was created inside of East Stroudsburg Area School District.





Educational & Contract Furniture
 1700 N. Highland Road, Suite 107
 Pittsburgh, PA 15241
 Phone: 412-831-7601 Fax: 412-831-7662

26,814.56

PROPOSAL

Number PEMQ8128

Date Sep 7, 2021

Proposal Expires on: 10/7/2021

Website: www.pemcofurniture.com

Sold To	Ship To	Your Sales Rep
East Stroudsburg SD Amy Polmouter 50 Vine Street East Stroudsburg, PA 18301 Phone 570-424-8500 Fax	East Stroudsburg HS - South Amy Polmouter 279 North Courtland Street East Stroudsburg, PA 18301 Phone 570-424-8471 Email	Bill Lindstrom Office: 412-831-7601 Ext. 119 Cell: 814-553-1640 Email: Bill@pemcofurniture.com

Terms	PO Number

Qty	Mfg	Model #	Description	Unit Price	Ext. Price
16	KI	RC4100H18	Ricochet 18" Stool, Standard color option TBD.	\$106.80	\$1,708.80
1	KI		Estimated materials and commodity surcharge	\$85.44	\$85.44

Product shipping direct. Customer responsible for offload and assembly.

Purchase Order instructions below:

Pricing via COSTARS #035-018
 Make PO out to:
 Corbett c/o PEMCO
 56 Buttonwood Street
 Norristown PA 19401

SubTotal	\$1,794.24
Tax	\$0.00
Shipping	0.00
Total	\$1,794.24

Signature _____

Date: _____



PROPOSAL

Educational & Contract Furniture
1700 N. Highland Road, Suite 107
Pittsburgh, PA 15241
Phone: 412-831-7601 Fax: 412-831-7662

Number PEMQ8126
Date Sep 7, 2021

Proposal Expires on: 10/7/2021

Website: www.pemcofurniture.com

Sold To	Ship To	Your Sales Rep
East Stroudsburg SD Amy Polmouter 50 Vine Street East Stroudsburg, PA 18301 USA Phone 570-424-8500 Fax	East Stroudsburg HS South Amy Polmouter 279 Courtland Street East Stroudsburg, PA 18301 USA Phone 570-424-8471 Email	Bill Lindstrom Office: 412-831-7601 Ext. 119 Cell: 814-553-1640 Email: Bill@pemcofurniture.com

Terms	PO Number

Qty	Mfg	Model #	Description	Unit Price	Ext. Price
2	Sit on It	1203BK2	Hexy High Back Task Chair. Mesh back pneumatic height adjustable, synchro tilt mechanism. Adjustable height arms. Element Onyx Vinyl seat. <i>1203BK2.MB.US.F.FC1.AR4.BT1.BC1.CS6.MC20.V G2.KD</i> <i>Product shipping direct. Customer responsible for offload and placement.</i>	\$281.50	\$563.00

Purchase Order instructions below:

Pricing Per PA State Contract #4400017037
Make PO out to:
Exemplis c/o PEMCO
6415 Katella Avenue
Cypress CA 90630

SubTotal	\$563.00
Tax	\$0.00
Shipping	0.00
Total	\$563.00

Signature _____

Date: _____



PROPOSAL

Educational & Contract Furniture
1700 N. Highland Road, Suite 107
Pittsburgh, Pa 15241
Phone: 412-831-7601 Fax: 412-831-7662

Number PEMQ8121
Date Sep 6, 2021

Proposal Expires on: 10/6/2021

Website: www.pemcofurniture.com

Sold To		Ship To	Your Sales Rep
East Stroudsburg SD Amy Polmouter 50 Vine Street East Stroudsburg, PA 18301 Phone 570-424-8500 Fax		East Stroudsburg HS South Amy Polmouter 279 Courtland Street East Stroudsburg, PA 18301 Phone 570-424-8471 Email	Bill Lindstrom Office: 412-831-7601 Ext. 119 Cell: 814-553-1640 Email: Bill@pemcofurniture.com
Terms	PO Number		

Qty	Mfg	Model #	Description	Unit Price	Ext. Price
48	Scholar Craft	SC6200SP	Intersect hard plastic desk, four legs, adjustable height. Standard plastic color TBD. Felt glides.	\$184.32	\$8,847.36
32	Scholar Craft	SC5118XL	Thrive four leg 18" chair. Standard shell color and frame TBD. Felt glides.	\$61.76	\$1,976.32
2	Scholar Craft	FS949UND-8600	Undulate activity table, adjustable height. Standard laminate color and leg finish TBD. Spray on edge, felt glides.	\$312.00	\$624.00
1	Scholar Craft		Freight	\$1,768.00	\$1,768.00

Product shipping direct. Customer responsible for offload and assembly.

Purchase Order Instructions below

PA-CoStars Pricing is Valid for 30 days

Pricing Per: PA Co-Stars 035-015
Make PO out to: PEMCO
1700 N. Highland Rd Suite 107
Pittsburgh, PA 15241

SubTotal	\$13,215.68
Tax	\$0.00
Shipping	0.00
Total	\$13,215.68

Please Sign Proposal and return with PO:
 Email: Bill@pemcofurniture.com
 or Fax: 412-831-7662

Print:

Signature:

Date:



PROPOSAL

Educational & Contract Furniture
1700 N. Highland Road, Suite 107
Pittsburgh, Pa 15241
Phone: 412-831-7601 Fax: 412-831-7662

Number PEMQ8122
Date Sep 6, 2021

Proposal Expires on: 10/6/2021

Website: www.pemcofurniture.com

Sold To	Ship To	Your Sales Rep
East Stroudsburg SD Amy Polmounter 50 Vine Street East Stroudsburg, PA 18301 Phone 570-424-8500 Fax	East Stroudsburg HS - South Amy Polmounter 279 North Courtland Street East Stroudsburg, PA 18301 Phone 570-424-8471 Email	Bill Lindstrom Office: 412-831-7601 Ext. 119 Cell: 814-553-1640 Email: Bill@pemcofurniture.com

Terms	PO Number

Qty	Mfg	Model #	Description	Unit Price	Ext. Price
2	Invincible	TCPMSBF-PV/TCM-TB LBKT-KIT/ITM4824SP TT-PV	Podium and table combination. Detachable 24 x 48 table with locking casters. Non Handed. Mobile podlum with storage. Standard laminate and paint colors TBD.	\$1,543.16	\$3,086.32
1	Invincible		Freight	\$658.41	\$658.41

Product shipping direct. Customer responsible for offload and assembly.

Purchase Order Instructions below

PA-CoStars Pricing is Valid for 30 days

Pricing Per: PA Co-Stars 035-015
Make PO out to: PEMCO
1700 N. Highland Rd Suite 107
Pittsburgh, PA 15241

SubTotal	\$3,744.73
Tax	\$0.00
Shipping	0.00
Total	\$3,744.73

Please Sign Proposal and return with PO:
 Email: Bill@pemcofurniture.com
 or Fax: 412-831-7662

Print:

Signature:

Date:



PROPOSAL

Number PEMQ8123

Date Sep 6, 2021

Educational & Contract Furniture
1700 N. Highland Road, Suite 107
Pittsburgh, Pa 15241
Phone: 412-831-7601 Fax: 412-831-7662

Proposal Expires on: 10/6/2021

Website: www.pemcofurniture.com

Sold To	Ship To	Your Sales Rep
East Stroudsburg SD Amy Polmouter 50 Vine Street East Stroudsburg, PA 18301 Phone 570-424-8500 Fax	East Stroudsburg HS South Amy Polmouter 279 Courtland Street East Stroudsburg, PA 18301 Phone 570-424-8471 Email	Bill Lindstrom Office: 412-831-7601 Ext. 119 Cell: 814-553-1640 Email: Bill@pemcofurniture.com

Terms	PO Number

Qty	Mfg	Model #	Description	Unit Price	Ext. Price
8	Fomcore	F005-18x18-G	Round Ottoman, 18" seat height. Standard Silvertex vinyl color TBD. Glides	\$196.00	\$1,568.00
8	Fomcore	F110-42x20x30-Z	Anderson XL chair. Standard Silvertex vinyl color TBD.	\$629.65	\$5,037.20
1	Fomcore		Freight	\$891.71	\$891.71

Product shipping direct. Customer responsible for offload and placement.

Purchase Order instructions below

PA-CoStars Pricing is Valid for 30 days

Pricing Per: PA Co-Stars 035-015
Make PO out to: PEMCO
1700 N. Highland Rd Suite 107
Pittsburgh, PA 15241

SubTotal	\$7,496.91
Tax	\$0.00
Shipping	0.00
Total	\$7,496.91

Please Sign Proposal and return with PO:
Email: Bill@pemcofurniture.com
or Fax: 412-831-7662

Print:

Signature:

Date:

VII. RECOMMENDATIONS BY THE EDUCATION P & R
COMMITTEE

- e. Furniture purchase for North High School, quote -
\$26,814.56 funded by ATSI Grant

Form 611

MUST BE COMPLETED FOR ANY PROCUREMENT OF A SERVICE OR ITEM OVER \$5,000.00

The respondent's email (**william-vitulli@esasd.net**) was recorded on submission of this form.

Untitled Section

Untitled Section

FORM 611

EAST STROUDSBURG AREA SCHOOL DISTRICT
Procurement Form

Name of Requestor *

vitulliw

Untitled Title

Department *

C&I

Building *

admin

What service or item are requesting *

furniture for North HS

Why are you requesting the service or item *

Improved student experience replacing old with modern

Suggested replacement *

none

Please complete an independent Cost Analysis. (Pre-determine costs prior to contacting a vendor.)

Using Costars vendor

Cost Estimate: if over \$5,000, were three (3) quotes obtained? If yes, please list the vendor's information and quoted amount. *

Cumulative order is \$26,814.56 as a result of PEM Co. working with various vendors

What is the total cost of the purchase? *

\$26,814.56

Procurement Method: *

- Quote Received only one Proposal
- Request for Proposal (RFP)
- Bid
- Other:

Was this purchase budgeted? *

No ▼

Was this purchased through a PA State Contract or Approved Consortiums? If yes, select group.

- Yes
- Pennsylvania State Contract
- COSTARS
- Keystone Purchasing Network
- PEPPM National Contract Program (Technology Bidding and Purchasing)
- US Communities
- No

If item was purchased through a Pa State Contract or approved Consortium, please include contract number.

Which Fund will be charged? *

10 ▼

What account will be charged? *

ATSI grant - See Angela Byrnes

Selection of the winning proposal, was the lowest price selected? If not, please explain why and the process of selecting the vendor. *

n/a

Any additional information you would like to provide.

final dollars for ATSI grant - North

This form was created inside of East Stroudsburg Area School District.





Educational & Contract Furniture
1700 N. Highland Road, Suite 107
Pittsburgh, PA 15241
Phone: 412-831-7601 Fax: 412-831-7662

JK, 814.56

PROPOSAL

Number PEMQ8131
Date Sep 7, 2021

Proposal Expires on: 10/7/2021

Website: www.pemcofurniture.com

Sold To	Ship To	Your Sales Rep
East Stroudsburg SD Amanda Parrish 50 Vine Street East Stroudsburg, PA 18301 Phone 570-424-8500 Fax	East Stroudsburg HS - North Amanda Parrish 279 Timberwolf Drive Dingmans Ferry, PA 18328 Phone 570-588-4420 Email	Bill Lindstrom Office: 412-831-7601 Ext. 119 Cell: 814-553-1640 Email: Bill@pemcofurniture.com

Terms	PO Number
--------------	------------------

Qty	Mfg	Model #	Description	Unit Price	Ext. Price
16	KI	RC4100H18	Ricochet 18" Stool, Standard color option TBD.	\$106.80	\$1,708.80
1	KI		Estimated materials and commodity surcharge	\$85.44	\$85.44

Product shipping direct. Customer responsible for offload and assembly.

Purchase Order instructions below:

Pricing via COSTARS #035-018
 Make PO out to:
 Corbett c/o PEMCO
 56 Buttonwood Street
 Norristown PA 19401

SubTotal	\$1,794.24
Tax	\$0.00
Shipping	0.00
Total	\$1,794.24

Signature _____
 Date: _____



PROPOSAL

Educational & Contract Furniture
1700 N. Highland Road, Suite 107
Pittsburgh, Pa 15241
Phone: 412-831-7601 Fax: 412-831-7662

Number PEMQ8130
Date Sep 7, 2021

Proposal Expires on: 10/7/2021

Website: www.pemcofurniture.com

Sold To		Ship To	Your Sales Rep
East Stroudsburg SD Amanda Parrish 50 Vine Street East Stroudsburg, PA 18301 Phone 570-424-8500 Fax		East Stroudsburg HS North Amanda Parrish 279 Timberwolf Drive Dingmans Ferry, PA 18328 Phone 570-588-4420 Email	Bill Lindstrom Office: 412-831-7601 Ext. 119 Cell: 814-553-1640 Email: Bill@pemcofurniture.com
Terms	PO Number		

Qty	Mfg	Model #	Description	Unit Price	Ext. Price
48	Scholar Craft	SC6200SP	Intersect hard plastic desk, four legs, adjustable height. Standard plastic color TBD. Felt glides.	\$184.32	\$8,847.36
32	Scholar Craft	SC5118XL	Thrive four leg 18" chair. Standard shell color and frame TBD. Felt glides.	\$61.76	\$1,976.32
2	Scholar Craft	FS949UND-8600	Undulate activity table, adjustable height. Standard laminate color and leg finish TBD. Spray on edge, felt glides.	\$312.00	\$624.00
1	Scholar Craft		Freight	\$1,768.00	\$1,768.00

Product shipping direct. Customer responsible for offload and assembly.

Purchase Order instructions below

PA-CoStars Pricing is Valid for 30 days

Pricing Per: PA Co-Stars 035-015
Make PO out to: PEMCO
1700 N. Highland Rd Suite 107
Pittsburgh, PA 15241

SubTotal	\$13,215.68
Tax	\$0.00
Shipping	0.00
Total	\$13,215.68

Please Sign Proposal and return with PO:
 Email: Bill@pemcofurniture.com
 or Fax: 412-831-7662

Print:

Signature:

Date:



PROPOSAL

Educational & Contract Furniture
1700 N. Highland Road, Suite 107
Pittsburgh, Pa 15241
Phone: 412-831-7601 Fax: 412-831-7662

Number PEMQ8134
Date Sep 7, 2021

Proposal Expires on: 10/7/2021

Website: www.pemcofurniture.com

Sold To	Ship To	Your Sales Rep
East Stroudsburg SD Amanda Parrish 50 Vine Street East Stroudsburg, PA 18301 Phone 570-424-8500 Fax	East Stroudsburg HS North Amanda Parrish 279 Timberwolf Drive Dingmans Ferry, PA 18328 Phone 570-588-4420 Email	Bill Lindstrom Office: 412-831-7601 Ext. 119 Cell: 814-553-1640 Email: Bill@pemcofurniture.com
Terms	PO Number	

Qty	Mfg	Model #	Description	Unit Price	Ext. Price
8	Fomcore	F005-18x18-G	Round Ottoman, 18" seat height. Standard Silvertex vinyl color TBD. Glides	\$196.00	\$1,568.00
8	Fomcore	F110-42x20x30-Z	Anderson XL chair. Standard Silvertex vinyl color TBD.	\$629.65	\$5,037.20
1	Fomcore		Freight	\$891.71	\$891.71

Product shipping direct. Customer responsible for offload and placement.

Purchase Order instructions below

PA-CoStars Pricing is Valid for 30 days

Pricing Per: PA Co-Stars 035-015
Make PO out to: PEMCO
1700 N. Highland Rd Suite 107
Pittsburgh, PA 15241

SubTotal	\$7,496.91
Tax	\$0.00
Shipping	0.00
Total	\$7,496.91

Please Sign Proposal and return with PO:
 Email: Bill@pemcofurniture.com
 or Fax: 412-831-7662

Print:

Signature:

Date:



PROPOSAL

Educational & Contract Furniture
1700 N. Highland Road, Sulte 107
Pittsburgh, PA 15241
Phone: 412-831-7601 Fax: 412-831-7662

Number PEMQ8133
Date Sep 7, 2021

Proposal Expires on: 10/7/2021

Website: www.pemcofurniture.com

Sold To	Ship To	Your Sales Rep
East Stroudsburg SD Amanda Parrish 50 Vine Street East Stroudsburg, PA 18301 USA Phone 570-424-8500 Fax	East Stroudsburg HS North Amanda Parrish 279 Timberwolf Drive Dingmans Ferry, PA 18328 USA Phone 570-588-4420 Email	Bill Lindstrom Office: 412-831-7601 Ext. 119 Cell: 814-553-1640 Email: Bill@pemcofurniture.com

Terms	PO Number

Qty	Mfg	Model #	Description	Unit Price	Ext. Price
2	Sit on It	1203BK2	Hexy High Back Task Chair. Mesh back pneumatic height adjustable, synchro tilt mechanism. Adjustable height arms. Element Onyx Vinyl seat. 1203BK2.MB.US.F.FC1.AR4.BT1.BC1.CS6.MC20.V G2.KD <i>Product shipping direct. Customer responsible for offload and placement.</i>	\$281.50	\$563.00

Purchase Order instructions below:

Pricing Per PA State Contract #4400017037
Make PO out to:
Exemplis c/o PEMCO
6415 Katella Avenue
Cypress CA 90630

Signature _____

Date: _____

SubTotal	\$563.00
Tax	\$0.00
Shipping	0.00
Total	\$563.00



PROPOSAL

Educational & Contract Furniture
1700 N. Highland Road, Suite 107
Pittsburgh, Pa 15241
Phone: 412-831-7601 Fax: 412-831-7662

Number PEMQ8132
Date Sep 7, 2021

Proposal Expires on: 10/7/2021

Website: www.pemcofurniture.com

Sold To	Ship To	Your Sales Rep
East Stroudsburg SD Amanda Parrish 50 Vine Street East Stroudsburg, PA 18301 Phone 570-424-8500 Fax	East Stroudsburg HS - North Amanda Parrish 279 Timberwolf Drive Dingmans Ferry, PA 18328 Phone 570-588-4420 Email	Bill Lindstrom Office: 412-831-7601 Ext. 119 Cell: 814-553-1640 Email: Bill@pemcofurniture.com
Terms	PO Number	

Qty	Mfg	Model #	Description	Unit Price	Ext. Price
2	Invincible	TCPMSBF-PV/TCM-TB LBKT-KIT/ITM4824SP TT-PV	Podium and table combination. Detachable 24 x 48 table with locking casters. Non Handed. Mobile podium with storage. Standard laminate and paint colors TBD.	\$1,543.16	\$3,086.32
1	Invincible		Freight	\$658.41	\$658.41

Product shipping direct. Customer responsible for offload and assembly.

Purchase Order instructions below

PA-CoStars Pricing is Valid for 30 days

Pricing Per: PA Co-Stars 035-015
Make PO out to: PEMCO
1700 N. Highland Rd Suite 107
Pittsburgh, PA 15241

SubTotal	\$3,744.73
Tax	\$0.00
Shipping	0.00
Total	\$3,744.73

Please Sign Proposal and return with PO:
 Email: Bill@pemcofurniture.com
 or Fax: 412-831-7662

Print:

Signature:

Date:

VII. RECOMMENDATIONS BY THE EDUCATION P & R
COMMITTEE

f. SmartMusic - District subscriptions, quote - \$20,987.76 -
3 year subscription - 20% discount - funded by ESSERs III (other
options exist, see attachments)

Form 611

MUST BE COMPLETED FOR ANY PROCUREMENT OF A SERVICE OR ITEM OVER \$5,000.00

The respondent's email (william-vitulli@esasd.net) was recorded on submission of this form.

Untitled Section

Untitled Section

FORM 611

EAST STROUDSBURG AREA SCHOOL DISTRICT
Procurement Form

Name of Requestor *

Vitulli

Untitled Title

Department *

C&I - Music

Building *

Admin

What service or item are requesting *

Online music practice tool

Why are you requesting the service or item *

MakeMusic

Suggested replacement *

sole provider

Please complete an independent Cost Analysis. (Pre-determine costs prior to contacting a vendor.)

n/a

Cost Estimate: if over \$5,000, were three (3) quotes obtained? If yes, please list the vendor's information and quoted amount. *

We obtained 3 different quotes for various years with different discount rates.

What is the total cost of the purchase? *

20,987.76

Procurement Method: *

- Quote Received only one Proposal
- Request for Proposal (RFP)
- Bid
- Other:

Was this purchase budgeted? *

No ▼

Was this purchased through a PA State Contract or Approved Consortiums? If yes, select group.

- Yes
- Pennsylvania State Contract
- COSTARS
- Keystone Purchasing Network
- PEPPM National Contract Program (Technology Bidding and Purchasing)
- US Communities
- No

If item was purchased through a Pa State Contract or approved Consortium, please include contract number.

Which Fund will be charged? *

10

What account will be charged? *

ESSERs III

Selection of the winning proposal, was the lowest price selected? If not, please explain why and the process of selecting the vendor. *

n/a

Any additional information you would like to provide.

This form was created inside of East Stroudsburg Area School District.

Google Forms

makemusic.
 285 Century Place, Louisville, CO 80027

Ref. Code:
Email:
Issued:
Expires:

KNWY-RXEQ
paul-bakner@esasd.net
Wednesday, August 11, 2021 10:25 AM
Sunday, October 10, 2021 10:25 AM

Purchase Orders and Tax Exemption forms should be uploaded to <https://quotes.smartmusic.com/find>. This will ensure the fastest platform activation time. You will need your email address and Reference Code listed below.
paul-bakner@esasd.net
KNWY-RXEQ

Bill To:
 East Stroudsburg Area Sch Dist
 50 Vine St
 E Stroudsburg, PA, US 18301

Ship To:
 East Stroudsburg Area Sch Dist
 50 Vine St
 E Stroudsburg, PA, US 18301

If you're paying with a credit card, call 866-240-4041 (US) or 952-937-9611 (INT) and have your reference code handy. Tax will be applied to the final price, if applicable.

Qty	Item	Description	Unit Price	Total
7	Full Access Teacher Subscription	A Full Access Teacher subscription for SmartMusic Web	\$39.99	\$279.93
305	Performer Subscription with Bulk Discount	A Performer subscription for SmartMusic Web with bulk discount	\$13.99	\$4,266.95

Sales Contact:
 866-240-4041
 sales@makemusic.com

Subtotal (USD): \$4,546.88
Tax (USD): \$0.00
Amount Due (USD): \$4,546.88

*Not Preferred
 for*

makemusic.

285 Century Place, Louisville, CO 80027

Ref. Code:

Email:

Issued:

Expires:

CEMY-X42W

paul-bakner@esasd.net

Wednesday, August 11, 2021 10:21 AM

Sunday, October 10, 2021 10:21 AM

Purchase Orders and Tax Exemption forms should be uploaded to <https://quotes.smartmusic.com/find>. This will ensure the fastest platform activation time.

You will need your email address and Reference Code listed below.

paul-bakner@esasd.net

CEMY-X42W

Bill To:

East Stroudsburg Area Sch Dist

50 Vine St

E Stroudsburg, PA, US 18301

Ship To:

East Stroudsburg Area Sch Dist

50 Vine St

E Stroudsburg, PA, US 18301

If you're paying with a credit card, call 866-240-4041 (US) or 952-937-9611 (INT) and have your reference code handy. Tax will be applied to the final price, if applicable.

Qty	Item	Description	Unit Price	Total
7	Full Access Teacher Subscription	A Full Access Teacher subscription for SmartMusic Web	\$39.99	\$279.93
605	Performer Subscription with Bulk Discount	A Performer subscription for SmartMusic Web with bulk discount	\$13.99	\$8,463.95

Sales Contact:

866-240-4041

sales@makemusic.com

Subtotal (USD):

\$8,743.88

Tax (USD):

\$0.00

Amount Due (USD):

\$8,743.88

*1-year
no discount*



285 Century Place, Suite 100
 Louisville, CO 80027
 United States

Quote # **Q-MM949654**

Issued: 9/9/2021
 Expires: 10/9/2021

Sales Rep:

Mike Ferry
 Email: mferry@makemusic.com

Customer Bill To:

East Stroudsburg Area Sch Dist
 50 Vine St
 E Stroudsburg PA 18301-2150
 paul-bakner@esasd.net
 570-424-8500

Customer Ship To:

East Stroudsburg Area Sch Dist
 50 Vine St
 E Stroudsburg PA 18301-2150
 570-424-8500

Customer Message:

PRICING INCLUDES 10% DISCOUNT IN ADDITION TO BULK PRICING AND IS ONLY VALID FOR 2 YEAR SUBSCRIPTION TERM.

Send this proposal along with a purchase order to mferry@makemusic.com. Paying with a credit card? Call 866-240-4041 (US) or 952-937-9611 (CAN) and reference the number in the upper right corner. Tax will be applied to the final price, if applicable. Please provide any certificates or documentation to support tax exemption. Subscriptions start on the day orders are processed unless otherwise noted on the purchase order.

Customer: 18301-East Stroudsburg Area Sch Dist

Qty	Item	Description	Unit Price	Extended Price
7	SmartMusic Teacher - Full Library and Toolset Access -	SmartMusic Teacher - Full Library and Toolset Access - 2 year subscription - Includes 10% multi-year discount in addition to bulk pricing.	71.98	503.86
605	SmartMusic Performer	SmartMusic Performer - Full Library and Assignment Access - 2 year subscription - Includes 10% multi-year discount in addition to bulk pricing.	25.18	15,233.90

*2 years
10% disc.*

Please include a copy of this quote and proof of Tax Exemption with Purchase Orders.

Subtotal (USD): \$15,737.76
Tax (USD): \$0.00
Amount Due (USD): \$15,737.76



285 Century Place, Suite 100
Louisville, CO 80027
United States

Quote # **Q-MM949655**

Issued: 9/9/2021
Expires: 10/9/2021

Sales Rep:

Mike Ferry
Email: mferry@makemusic.com

Customer Bill To:

East Stroudsburg Area Sch Dist
50 Vine St
E Stroudsburg PA 18301-2150
paul-bakner@esasd.net
570-424-8500

Customer Ship To:

East Stroudsburg Area Sch Dist
50 Vine St
E Stroudsburg PA 18301-2150
570-424-8500

Customer Message:

PRICING INCLUDES 20% DISCOUNT IN ADDITION TO BULK PRICING AND IS ONLY VALID FOR 3 YEAR SUBSCRIPTION TERM.

Send this proposal along with a purchase order to mferry@makemusic.com. Paying with a credit card? Call 866-240-4041 (US) or 952-937-9611 (CAN) and reference the number in the upper right corner. Tax will be applied to the final price, if applicable. Please provide any certificates or documentation to support tax exemption. Subscriptions start on the day orders are processed unless otherwise noted on the purchase order.

Customer: 18301-East Stroudsburg Area Sch Dist

Qty	Item	Description	Unit Price	Extended Price
7	SmartMusic Teacher - Full Library and Toolset Access -	SmartMusic Teacher - Full Library and Toolset Access - 3 year subscription - Includes 20% multi-year discount in addition to bulk pricing	95.98	671.86
605	SmartMusic Performer	SmartMusic Performer - Full Library and Assignment Access - 3 year subscription - Includes 20% multi-year discount in addition to bulk pricing	33.58	20,315.90

*3-year
20% discount
Preferred
PO*

Please include a copy of this quote and proof of Tax Exemption with Purchase Orders.

Subtotal (USD): \$20,987.76
Tax (USD): \$0.00
Amount Due (USD): \$20,987.76

VII. RECOMMENDATIONS BY THE EDUCATION P & R
COMMITTEE

g. SWPBS \$5 per student- school incentive programs, quote
- \$31,240.00 - funded by ESSERs III

Form 611

MUST BE COMPLETED FOR ANY PROCUREMENT OF A SERVICE OR ITEM OVER \$5,000.00

The respondent's email (**william-vitulli@esasd.net**) was recorded on submission of this form.

Untitled Section

Untitled Section

FORM 611

EAST STROUDSBURG AREA SCHOOL DISTRICT
Procurement Form

Name of Requestor *

Vitulli

Untitled Title

Department *

C&I

Building *

admin

What service or item are requesting *

Financial support to each school for SWPBS

Why are you requesting the service or item *

Support student attendance, behavior, performance

Suggested replacement *

n/a

Please complete an independent Cost Analysis. (Pre-determine costs prior to contacting a vendor.)

n/a

Cost Estimate: if over \$5,000, were three (3) quotes obtained? If yes, please list the vendor's information and quoted amount. *

n/a

What is the total cost of the purchase? *

\$31,240.00

Procurement Method: *

- Quote Received only one Proposal
- Request for Proposal (RFP)
- Bid
- Other: provided by us

Was this purchase budgeted? *

No

Was this purchased through a PA State Contract or Approved Consortiums? If yes, select group.

- Yes
- Pennsylvania State Contract
- COSTARS
- Keystone Purchasing Network
- PEPPM National Contract Program (Technology Bidding and Purchasing)
- US Communities
- No

If item was purchased through a Pa State Contract or approved Consortium, please include contract number.

n/a

Which Fund will be charged? *

10

What account will be charged? *

ESSERs III

Selection of the winning proposal, was the lowest price selected? If not, please explain why and the process of selecting the vendor. *

n/a

Any additional information you would like to provide.

This form was created inside of East Stroudsburg Area School District.

Google Forms

School Wide Positive Behavior Support (SWPBS)

BES	348x\$5.00=	\$1,740.00
ESE	607x\$5.00=	\$3,035.00
JMH	386x\$5.00=	\$1,930.00
MSE	378x\$5.00=	\$1,890.00
RES	406x\$5.00=	\$2,030.00
SMI	326x\$5.00=	\$1,630.00
JTL	900x\$5.00=	\$4,500.00
LIS	619x\$5.00=	\$3,095.00
HSS	1330x\$5.00=	\$6,650.00
HSN	948x\$5.00=	\$4,740.00
		\$31,240.00