

V. Items for Discussion

c. HP SAN & Server RFP Results & Financing

HP SAN (Storage Area Network)/Servers

A. Why are you requesting the service/needs?

Why: We are requesting to upgrade our SAN and Servers in our District Data Centers. The current lease expires in June on the equipment that will be 4 years old.

Need: Our metro-cluster SAN is hosted in two separate datacenters allowing for replication of all data at both sites. We also host servers at both datacenters in order to reduce the load at one site or the other. We have the ability to shift services to the alternate site in the case of a site going down or to load-balance our services (disaster recovery). We have 80 virtual servers serving a variety of services such as: Active Directory, Domain Name Services, File Hosting Services, Apple Software Distribution, Windows Software Distribution, Moodle, Network Access Control, Password Reset, Print Servers, Inventory Control, Pro-Watch Key Card Access, Copier Management, Telephone System Management, Cafeteria PoS System, Microsoft Licensing Management, Time Synchronization Service, Police Reporting Server, Transportation Server, Backup Servers. All virtual servers are hosted by eight physical servers (four in each datacenter) and connected to the metro-cluster storage with a dedicated replication link between them. All servers are configured for high-availability and are load-balanced for best performance at each site.

Suggested replacement: HPE dHCI Nimble Solution

B. Cost Estimate: if over \$5,000, were 3 quotes obtained? If yes, please list the vendors and the amounts. Yes.

<u>Manufacturer</u>	<u>Solution</u>	<u>Price</u>
HP Enterprise	dHCI -- Nimble	\$538,898.64
Nutanix	7 Node Option / Acropolis/VMWare	\$569,718.19
HP Enterprise	Synergy/Nimble	\$570,184.26
Nutanix	8 Node Option / Acropolis/VMWare	\$600,562.92
Dell/EMC	VxRail	\$605,357.00
Pure Storage	Pure Storage	\$617,123.00
Cisco	Hyperflex	\$649,621.08
HP Enterprise	Simplivity	\$698,696.75

C. Procurement Method:

- Vendors were contacted in November to review options and configurations for our replacement SAN & Servers. We had meetings and site visits with resellers, including CDW-G, IntegraOne, and SHI. The due date for quotes was February 19, 2020. Technology department staff carefully vetted and reviewed 8 proposals from each vendor, picking the solution that best fit the district needs and was the lowest cost solution.

D. Funds account to be charged for Procurement (Was this purchase budgeted?)

- Yes
- Fund 10
- Account # 10-5110-911-000-00-000-100-909-9092-
 - Technology Services Lease Account

E. Selection of winning proposal

- IntegraOne – HPE dHCI Nimble Solution - lowest priced solution. Pricing is per COSTARS contract # HW 003-085 & SW #006-004.

F. Other

N/A

Form 611

MUST BE COMPLETED FOR ANY PROCUREMENT OF A SERVICE OR ITEM OVER \$5,000.00

Your email address (thomas-mcintyre@esasd.net) will be recorded when you submit this form. Not you? [Switch account](#)

* Required

FORM **611**

EAST STROUDSBURG AREA SCHOOL DISTRICT

Procurement Form

Name Of Requester *

Thomas J McIntyre

Department *

Business Office

Building *

Administration

What service or item are you requesting? *

Financing for SAN & Server

Why are you requesting the service or item? *

To purchase the district's new SAN & Server equipment

You're editing your response. Sharing this URL allows others to also edit your response.

FILL OUT A NEW RESPONSE

Suggested Replacement: *

HPE Financial Services

Please complete an independent Cost Analysis. (Pre-determine costs prior to contacting a vendor.)

N/a

Cost Estimate: If over \$5,000, were three (3) quotes obtained? If yes, Please list the vendor's information and quoted amount. *

HPE Financial Services	\$127,525.00	-3.540%
Insight Financial Services	\$128,225.54	-3.200%
First American	\$129,465.01	-2.5920%
American Capital	\$130,106.99	-2.2766%
Vantage Financial, LLC	\$131,580.00	-1.550%
TEQ lease	\$138,011.94	4.5000%
M&T Bank	No Bid	
Trinity3 Financial Services	No Bid	
TD Equipment Finance	No Bid	
ESSA Bank	No Bid	

What is the total cost of the purchase? *

4 annual payments of \$127,525.00

Procurement Method: *

- Quote
- Request for Proposal (RFP)
- Bid
- Other:

Was this purchase budgeted? *

Yes

Was this purchased through a PA State Contract or Approved Consortiums? If yes, select group.

- Yes
- Pennsylvania State Contract
- COSTARS
- Keystone Purchasing Network
- PEPPM National Contract Program (Technology Bidding and Purchasing)
- US Communities
- NO

If item was purchased through a Pa State Contract or approved Consortium, please include contract number.

No

Which Fund will be charged? *

10

What account will be charged? *

10-5110-911-000-00-000-100-909-9092-

Selection of winning proposal, Was the lowest price selected? If not, please explain why and the process of selecting the vendor. *

Yes, the lowest interest rate was selected.

Any additional information you would like to provide.

Your answer

A copy of your responses will be emailed to thomas-mcintyre@esasd.net.

Submit

Never submit passwords through Google Forms.

This form was created inside of East Stroudsburg Area School District. [Report Abuse](#)

Google Forms

You're editing your response. Sharing this URL allows others to also edit your response.

FILL OUT A NEW RESPONSE



**Hewlett Packard
Enterprise**

HPE Financial Services

HPE Financial Services Lease Proposal

Prepared for: East Stroudsburg Area School District

Submitted: March 1, 2020

Vendor: IntegraOne

With technology changing every day, HPFS provides you with the flexibility you need to meet your ongoing technology and leasing needs. The following payment alternatives are available from HP Financial Services.

Lease Type: Fair Market Value Lease

Following the base term, the Lessee has several options; 1) the equipment may be returned without penalty; 2) the lease term may be re-negotiated and extended; 3) the equipment may be purchased at its then Fair Market Value; or 4) the Lessee may continue to make monthly payments beyond the original term until they are ready to exercise one of the three previously listed options.

Lease Term:	4 Years
Lease Amount:	\$538,898.64 (Based on IntegraOne Product Quote # 022395v5)
Billing:	Annual Advance
4 Annual Payments:	\$127,525.00(ea.)
Blended Lease Rate Factor:	.23664
Customer Implicit Rate:	-(3.54%)

Lease Payments to commence as outlined by the East Stroudsburg Area School District RFQ.
Lease quote good through date as outlined by the East Stroudsburg Area School District RFQ.

We appreciate the opportunity to provide you with this proposal. Please call me if you have any questions, or if I can be of further help.

Sincerely,

Sean Capria
Financial Area Manager – Public Sector/SLED
HP Financial Services
Ph. 315-317-0668
sean.capria@hpe.com

Confidentiality: This letter is delivered to you with the understanding that neither this letter nor its substance shall be disclosed by Lessee to any third party.

Basis of Proposal: This letter is a proposal for discussion purposes only and does not represent either an offer or a commitment of any kind on the part of HPFS. It does not purport to be inclusive of all terms and conditions that will apply to a leasing transaction between us. Neither party to the proposed transaction shall be under any legal obligation whatsoever until, among other things, HPFS has obtained all required internal approvals (including credit approvals) and both parties have agreed upon all essential terms of the proposed transaction and executed mutually acceptable definitive written documentation. This proposal can be modified or withdrawn by HPFS at any time.

Either party may terminate discussions and negotiations regarding a possible transaction at any time, without cause and without any liability whatsoever.

Allentown

7248 Tilghman Street
Suite 120
Allentown, PA 18106
1-800-582-6399
www.integra1.net



HP Refresh dHCI Option

Quote # 022395 Version 5

January 21, 2020

Prepared for:

East Stroudsburg Area School District

Prepared by:

Ashley Miller, Account Manager
Joe Strubeck, Inside Support Representative

dHCI

Description	Price	Qty	Ext. Price
HPE dHCI	\$538,898.64	1	\$538,898.64
HPE NS dHCI Base Config Trk		2	
HPE 42U 600x1200mm Adv G2 Kit Shock Rack		2	
HPE Factory Express Base Racking Service		2	
HPE Rack Hardware Kit		2	
HPE G2 Basic 4.9kVA/C13 C19 NA/JP PDU		4	
HPE DL360 Gen10 8SFF CTO Server		8	
HPE DL360 Gen10 Xeon-G 6234 FIO Kit		8	
HPE DL360 Gen10 Xeon-G 6234 Kit		8	
HPE 16GB 1Rx4 PC4-2933Y-R Smart Kit		192	
HPE 240GB SATA RI SFF SC MV SSD		16	
HPE Eth 10/25Gb 2p 621SFP28 Adptr		8	
HPE 96W Smart Storage Battery 145mm Cbl		8	
HPE Smart Array P408i-a SR Gen10 Ctrlr		8	
HPE Eth 10/25Gb 2p 622FLR-SFP28 CNA		8	
HPE 800W FS Plat Ht Plg LH Pwr Sply Kit		16	
HPE iLO Adv 1-svr Lic 3yr Support		8	
HPE 1U CMA for Easy Install Rail Kit		8	
HPE 1U Gen10 Bezel Kit		8	
HPE 1U Gen10 SFF BB Rail Kit		8	
HPE ProStack DL3x0 Add Cust ESXi FIO SW		8	
HPE SN2100M 100GbE 16QSFP28 Switch		2	
HPE SN2100M 100GbE 16QSFP28 Switch		2	
HPE SN2100M Rack Installation Kit		2	
HPE 10GBASE-T SFP+ RJ45 30m XCVR		8	

dHCI

Description	Price	Qty	Ext. Price
HPE BLc VC 1G SFP RJ45 Transceiver		8	
HPE QSFP28 to SFP28 Adapter		16	
HPE BLc 40G QSFP+ 4x10G SFP+ 3m DAC Cbl		8	
HPE BLc QSFP+ to 4x10G SFP+ AOC 15m Opt		8	
HPE 100Gb QSFP28 to 4x25Gb SFP28 3m DAC		8	
HPE X240 100G QSFP28 1m DAC Cable		4	
HPE NS AF40 All Flash CTO Base Array		2	
HPE NS 6x10GbE 2p FIO Adptr Kit		2	
HPE NS AF40 R2 23TB FIO Flash Bndl		2	
HPE NS AF40/60/80 46TB FIO Flash Bndl		2	
HPE NS C13 to C14 FIO Power Cord		4	
HPE NS dHCI NOS PG FIO SW		2	
HPE NS AF/HF Array Standard Trk		2	
HPE 4 Year Proactive Care 24x7 Support			
HPE iLO Advanced Non Blade Support		8	
HPE DL360 Gen10 Support		8	
HPE SN2100M Storage Switch Support		4	
HPE Technical Installation Startup Service			
HPE Nimble Storage dHCI Startup SVC		2	
HPE Startup Compute Additional 1 Day SVC		2	
HPE Nimble Storage 4 Year Foundation Care 4 Hour Onsite Exchange Support			
HPE NS 6x10GbE 2p Adptr Supp		2	
HPE NS AF40 All Flash Base Array Supp		2	
HPE NS AF40/60/80 23TB Flash Upgr Supp		2	
HPE NS AF40/60/80 46TB Flash Supp		2	

dHCI

Description	Price	Qty	Ext. Price
Subtotal:			\$538,898.64

per COSTARS contract # HW 003-085 & SW #006-004

63069-01

HP Refresh dHCI Option

Prepared by:

Allentown

Ashley Miller
 amiller@integra1.net
 484-223-3480 x1115

Joe Strubeck
 jstrubeck@integra1.net
 570-714-5005 x5203

Prepared for:

East Stroudsburg Area School District

Accounts Payable
 East Stroudsburg, PA 18301
 Brian Borosh
 (570) 424-8060
 brian-borosh@esasd.net

Quote Information:

Quote #: 022395

Version: 5
 Delivery Date: 01/21/2020
 Expiration Date: 01/31/2020

Quote Summary

Description	Amount
dHCI	\$538,898.64
Total:	\$538,898.64

Payment Options

Description	Payments	Interval	Amount
Lease Options			
3 Year Estimate	36	Monthly	\$14,975.66
4 Year Estimate	48	Monthly	\$11,232.03

Summary of Selected Payment Options

Description	Amount
Lease Options: 3 Year Estimate	
Selected Payment	\$14,975.66
Total of Payments	\$539,123.76

Pricing subject to change without advanced notice from the manufacturer. Leasing rates are subject to final configuration, pricing, and credit approval. Restock fees will apply for any items returned. Returns must be made within 21 days of receipt of items unopened. Shipping fees not included. The information provided to you in this communication is regarded by integraONE to be Confidential and Proprietary Information. This includes the description of the materials/products for sale, the prices quoted, and any description of consulting services to be performed by integraONE. This information shall not be disclosed or made available to any party unrelated to this agreement without our express written consent. You must also exercise reasonable care to protect this information from the unauthorized disclosure by others.

Ship to Address:

Additional Information:

Allentown

East Stroudsburg Area School District

Signature: Ashley Miller

Name: Ashley Miller

Title: Account Manager

Date: 01/21/2020

Signature: _____

Name: Brian Borosh

Date: _____

COMPUTER LEASE TABULATION

3/4/2020

HP/Lenovo \$ 538,898.64

VENDOR	FMV LEASE ANNUAL PMT	FMV LEASE INTEREST RATE
HPE Financial Services	\$ 127,525.00	-3.540%
Insight Financial Services	\$ 128,225.54	-3.200%
First American	\$ 129,465.01	-2.5920%
American Capital	\$ 130,106.99	-2.2766%
Vantage Financial, LLC	\$ 131,580.00	-1.550%
TEQ lease	\$ 138,011.94	4.5000%
M&T Bank	No Bid	
Trinity3 Financial Services	No Bid	
TD Equipment Finance	No Bid	
ESSA Bank	No Bid	

V. Items for Discussion

e. MCTI Excess Funds- Discussion

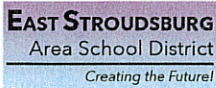

Thomas McIntyre <thomas-mcintyre@esasd.net>

Fwd: HP LaserJet 4345 PDF Scan

2 messages

Diane Serfass <dserfass@monroecti.org> Tue, Mar 3, 2020 at 10:29 AM
To: Cosmas Curry <c Curry@sburg.org>, Mike Sokoloski <msokoloski@sburg.org>, brennan.charlene@pvbears.org, "Famularo, Susan" <famularo.susan@pvbears.org>, william-riker@esasd.net, Thomas McIntyre <thomas-mcintyre@esasd.net>, Elizabeth Robison <erobison@pmsd.org>, Joseph Colozza <jcolozza@pmsd.org>
Cc: Dennis Virga <dvirga@monroecti.org>

Good morning everyone,

Please include at your next meeting, a motion to approve MCTI to retain the 1819 excess revenue in the amount of \$894,328 as a result of the financial audit .

Your individual amounts are as follows: (see attached page from the 18-19 audit)

East Stroudsburg, \$199,467
Stroudsburg \$168,027
Pleasant Valley \$240,755
Pocono Mountain \$286,079

If you need anything else, feel free to contact me. Thanks again for all your support to MCTI!

Diane M. Serfass, PCSBA
Monroe Career & Technical Institute
194 Laurel Lake Road
Bartonsville, PA 18321
570-629-2001 x1109
dserfass@monroecti.org

----- Forwarded message -----

From: **BusinessOffice** <businessoffice@monroecti.org>
Date: Tue, Mar 3, 2020 at 10:06 AM
Subject: HP LaserJet 4345 PDF Scan
To: **DSERFASS@MONROECTI.ORG** <DSERFASS@monroecti.org>

Please open the attached document. This document was digitally sent to you using an HP Digital Sending device.

This email and any files transmitted with it are confidential and intended solely for the use of the individual or entity to whom they are addressed. If you have received it by mistake, please let us know by e-mail reply and delete it from your system. Please note that any views or opinions presented in this email are solely those of the author and do not necessarily represent those of Monroe Career and Technical Institute (MCTI). Finally, the recipient should check this email and any attachments for the presence of viruses. MCTI accepts no liability for any damage caused by any virus transmitted by this email.

Monroe Career and Technical Institute, 194 Laurel Lake Road, Bartonsville, PA, www.monroecti.org

[Untitled]_20200303142111.pdf
296K

thomas-mcintyre@esasd.net <thomas-mcintyre@esasd.net>
To: dserfass@monroecti.org, dserfass@monroecti.org

Wed, Mar 4, 2020 at 8:04 AM

Your message

To: dserfass@monroecti.org
Subject: Fwd: HP LaserJet 4345 PDF Scan
Sent: 3/3/20, 10:29:45 AM EST

was read on 3/4/20, 8:04:49 AM EST

MONROE CAREER AND TECHNICAL INSTITUTE

NOTES TO FINANCIAL STATEMENTS

June 30, 2019

	1% Decrease <u>6.25%</u>	Current Discount Rate <u>7.25%</u>	1% Increase <u>8.25%</u>
MCTI's proportionate share of the net pension liability	<u>\$19,220,338</u>	<u>\$15,505,604</u>	<u>\$12,364,688</u>

Pension Plan Fiduciary Net Position

Detailed information about the PSERS' fiduciary net position is available in PSERS Comprehensive Annual Financial Report which can be found on the system's website at www.psers.state.pa.us.

(9) DUE FROM/TO MEMBER SCHOOL DISTRICTS

Member district contributions are determined annually and are based upon budgeted operating revenues and expenditures which are allocated based upon projected average daily membership. Any deficiency or excess of contributions are either billed or credited to each member district at year end. The amount due to member districts at June 30, 2019 was calculated as follows:

	<u>Pocono Mountain</u>	<u>East Stroudsburg</u>	<u>Pleasant Valley</u>	<u>Stroudsburg Area</u>	<u>Total</u>
Calculated % of budget	31.940%	22.350%	26.900%	18.810%	100.00%
Net operating expenses to be funded	\$ 2,378,389	\$ 1,664,277	\$ 2,003,089	\$ 1,400,673	\$ 7,446,428
Contributions received during 2019	<u>(2,664,468)</u>	<u>(1,863,744)</u>	<u>(2,243,844)</u>	<u>(1,568,700)</u>	<u>(8,340,756)</u>
Due to member districts at June 30, 2019	<u>\$ (286,079)</u>	<u>\$ (199,467)</u>	<u>\$ (240,755)</u>	<u>\$ (168,027)</u>	<u>\$ (894,328)</u>

The land and buildings and improvements owned by the Authority are operated by the MCTI under a long-term lease rental agreement. Pursuant to the lease rental agreement, each member district has pledged its full faith, credit and taxing power to pay for its proportionate share of debt service obligations and administrative fees incurred by the Authority to acquire, hold, construct, improve, maintain, own or lease, in the capacity of lessor or lessee, buildings and facilities for the benefit of the MCTI. The prior lease rental agreement expired November 2016.

(10) OPERATING LEASES

MCTI leases computer and copier equipment under non-cancelable operating leases expiring at various dates through June 2021. Rent expense for all operating leases for 2018-2019 was \$189,026.

Future minimum lease payments under these leases are as follows:

<u>Year ending June 30,</u>	
2020	\$129,567
2021	<u>54,260</u>
	<u>\$183,827</u>

(11) CONTINGENCIES AND COMMITMENTS

Government Grants and Awards

MCTI receives federal, state and local funding under a number of programs. Payments made by these sources under contractual agreements are provisional and subject to redetermination based on filing of reports and audits of those reports. Final settlements due from or to these sources are recorded in the year in which the related services are performed. Any adjustments resulting from subsequent examinations are recognized in the year in which the results of such examinations become known. MCTI officials do not expect any significant adjustments as a result of these examinations.

V. Items for Discussion

f. Hamilton & Musser, PC – Forensic Audit Invoice - \$19,675.00



HAMILTON & MUSSER, PC

Certified Public Accountants • Consultants to Management

176 Cumberland Parkway
 Mechanicsburg, PA 17055
 (717) 697-3888

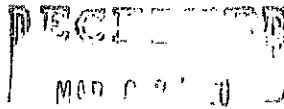

East Stroudsburg Area SD
 50 Vine Street
 P.O. Box 298
 East Stroudsburg, PA 18301

B: _____

INVOICE NO: 1163729-IN
 DATE: 1/31/2020
 CLIENT CODE: 00-ESASD
 INVOICE TOTAL: \$ 19,675.00
 BALANCE DUE: \$ 19,675.00
 TERMS: Due upon receipt
 Page 1 of 1

Please detach the remittance slip above and return with your payment.

For Professional Services Rendered:	Amount
Agreed-Upon Procedures Progress Billing for Forensic Work - Phase II	\$19,675.00

Hamilton & Musser, PC		CLIENT CODE: 00-ESASD		INVOICE TOTAL: \$19,675.00	
INVOICE NO: 1163729-IN		DATE: 1/31/2020		BALANCE DUE: \$19,675.00	
CURRENT	30 DAYS	60 DAYS	90 DAYS	120 DAYS	BALANCE DUE
\$ 19,675.00	\$ 0.00	\$ 0.00	\$ 0.00	\$ 0.00	\$ 19,675.00

V. Items for Discussion

g. Current Projects within the District

V. Items for Discussion

i. Classroom Furniture – Emotional Support Classrooms

Form 611

MUST BE COMPLETED FOR ANY PROCUREMENT OF A SERVICE OR ITEM OVER \$5,000.00

The respondent's email address (matthew-krauss@esasd.net) was recorded on submission of this form.

FORM **611**

EAST STROUDSBURG AREA SCHOOL DISTRICT
Procurement Form

Name Of Requester *

Matthew Krauss

Department *

Pupil Services

Building *

Administration

What service or item are you requesting? *

Classroom Furniture - Emotional Support Classrooms

Why are you requesting the service or item? *

To provide functional learning spaces for our emotional support classrooms. Plans include multiple learning zones and flexible seating.

Suggested Replacement: *

N/A

Please complete an independent Cost Analysis. (Pre-determine costs prior to contacting a vendor.)

Quotes obtained

Cost Estimate: If over \$5,000, were three (3) quotes obtained? If yes, Please list the vendor's information and quoted amount. *

Lakeshore Learning is a Costars vendor

What is the total cost of the purchase? *

\$92,096.80

Procurement Method: *

- Quote
- Request for Proposal (RFP)
- Bid
- Other: _____

Was this purchase budgeted? *

Yes ▼

Was this purchased through a PA State Contract or Approved Consortiums? If yes, select group.

- Yes
- Pennsylvania State Contract
- COSTARS
- Keystone Purchasing Network
- PEPPM National Contract Program (Technology Bidding and Purchasing)
- US Communities
- NO

If item was purchased through a Pa State Contract or approved Consortium, please include contract number.

Which Fund will be charged? *

10 ▼

What account will be charged? *

10-1231-610-891-10-211-310-000-9891, 10-1231-610-891-10-212-310-000-9891, 10-1231-610-891-10-216-310-000-9891

Selection of winning proposal, Was the lowest price selected? If not, please explain why and the process of selecting the vendor. *

Vendor was chosen due to their high quality products. Vendor created room renderings and was able to meet our needs for flexible seating and adaptive learning spaces.

Any additional information you would like to provide.

All quotes include delivery, unpacking, assembly and set-up in room.

This form was created inside of East Stroudsburg Area School District.



**QUOTE 92561**

Lakeshore Learning Materials
 2695 E. Dominguez Street Carson, CA 90895
 (310) 537-8600 (800) 421-5354
 FAX: (310) 900-2189
www.lakeshorelearning.com

Bill-to: 83721
 EAST STROUDSBURG AREA SCH DIST
 ACCOUNTS PAYABLE
 50 VINE ST
 E STROUDSBURG PA 18301-0298
 (570) 424-8500
Billto Email:

Ship-to: 133706
 BUSHKILL ELEMENTARY SCHOOL
 131 N SCHOOL DR
 DINGMANS FERRY PA 18328
Shipto Email:

Entry Date: 03/04/2020**Your Reference No.:** BUSHKILL K-2**Comment**

DELIVER 7-10 BUSINESS DAYS ARO
 PRICES GOOD FOR 90 DAYS

FOB DESTINATION:FREE SHIPPING
 DISCOUNT REFLECTED IN PRICES.

PLEASE REFERENCE QUOTE NUMBER
 92561 ON YOUR PURCHASE ORDER.

 CYNTHIA PEREZ - QUOTE AGENT

Line Item	Qty	Description	Price	Extended
1	LC787	6 FLX-SPC MOBL WDG STNT DSK-MAPL	\$265.05	\$1,590.30
		Which consists of:		
1A	LCT3024	6 TABLE, BOX, GUIDE FOR LC787	\$0.00	\$0.00
1B	LCL23343	6 3EA 23-34IN TABLE LEGS-CASTERS	\$0.00	\$0.00
2	LC231BU	6 FLEX-SPACE COMFY STOOL-BU	\$141.55	\$849.30
3	LC230	1 FLEX-SPACE 4-SHELF STORG-MAPLE	\$550.05	\$550.05
4	LC229	1 FLEX-SPACE 3-SHELF STORG-MAPLE	\$436.05	\$436.05
5	LC758	1 FLEX-SPACE 30X60 FLR TBL-MAPLE	\$312.55	\$312.55
		Which consists of:		
5A	LCT3060B	1 TABLE, BOX, GUIDE FOR LC758	\$0.00	\$0.00
5B	LCL1116	1 4EA - 11-16IN TABLE LEGS	\$0.00	\$0.00
6	LC405BU	5 FLEX-SPACE COMFY FLR SEAT-BU	\$56.99	\$284.95

7	LC230	1	FLEX-SPACE 4-SHELF STORG-MAPLE	\$550.05	\$550.05
8	LC679	1	FLX-SPC 48IN RND MOBL TBL-MAPL	\$474.05	\$474.05
Which consists of:					
8A	LCT48W	1	TABLE, BOX, GUIDE FOR LC679	\$0.00	\$0.00
8B	LCL23344	1	4EA 23-34IN TABLE LEGS-CASTERS	\$0.00	\$0.00
9	LC515BU	4	FLEX-SPACE 15.5IN CHAIR-BU	\$54.14	\$216.56
10	LC517BU	1	FLEX-SPACE 17.5IN CHAIR-BU	\$66.49	\$66.49
11	LC230	1	FLEX-SPACE 4-SHELF STORG-MAPLE	\$550.05	\$550.05
12	LC788	13	FLEX-SPC MOBL STDNT DESK-MAPLE	\$303.05	\$3,939.65
Which consists of:					
12A	LCT2620	13	TABLE, BOX, GUIDE FOR LC788	\$0.00	\$0.00
12B	LCL23344	13	4EA 23-34IN TABLE LEGS-CASTERS	\$0.00	\$0.00
13	LC515BU	8	FLEX-SPACE 15.5IN CHAIR-BU	\$54.14	\$433.12
14	LC764BU	5	FLX-SPC 14IN PREM WOB CHR-BU	\$75.99	\$379.95
15	LC813BU	1	FLX-SPC LNGE COUCH FOR 3-BU	\$474.05	\$474.05
16	LC812BU	1	FLEX-SPC LOUNGE-LRN CHAIR-BU	\$236.55	\$236.55
17	LC230	3	FLEX-SPACE 4-SHELF STORG-MAPLE	\$550.05	\$1,650.15
18	LC739	2	FLEX-SPAC MOBL TCHR DESK-MAPLE	\$854.05	\$1,708.10
Which consists of:					
18A	LCTM5724	2	TBLTOP ASSMBLY GUIDE FOR LC739	\$0.00	\$0.00
18B	LCM3112	2	MDSTY PNL-TBL LEG LC739, LC259	\$0.00	\$0.00
18C	LCC2326	2	CABINET,CASTERS - LC739, LC259	\$0.00	\$0.00
19	LC517BU	2	FLEX-SPACE 17.5IN CHAIR-BU	\$66.49	\$132.98
20	LC508	2	FLX-SPC 12-CUBBY MBL STR-MAPLE	\$1,234.05	\$2,468.10
21	TT729BB	48	NEON HEAVY-DUTY BIN - BRT BU	\$8.54	\$409.92
22	TT768BB	24	CONNECT-STORE BK BIN-BRT BU	\$5.69	\$136.56

Subtotal:	\$17,849.53
0.0% Tax:	\$0.00
Freight Amount:	\$0.00
Total:	\$17,849.53



QUOTE 92557

Lakeshore Learning Materials
 2695 E. Dominguez Street Carson, CA 90895
 (310) 537-8600 (800) 421-5354
 FAX: (310) 900-2189
www.lakeshorelearning.com

Bill-to: 83721
 EAST STROUDSBURG AREA SCH DIST
 ACCOUNTS PAYABLE
 50 VINE ST
 E STROUDSBURG PA 18301-0298
 (570) 424-8500
Billto Email:

Ship-to: 133706
 BUSHKILL ELEMENTARY SCHOOL
 131 N SCHOOL DR
 DINGMANS FERRY PA 18328
Shipto Email:

Entry Date: 03/04/2020

Your Reference No.: BUSHKILL 3-5

Comment

DELIVER 7-10 BUSINESS DAYS ARO
 PRICES GOOD FOR 90 DAYS

FOB DESTINATION:FREE SHIPPING
 DISCOUNT REFLECTED IN PRICES.

PLEASE REFERENCE QUOTE NUMBER
 92557 ON YOUR PURCHASE ORDER.

CYNTHIA PEREZ - QUOTE AGENT

Line Item	Qty	Description	Price	Extended
1	LC787	6 FLX-SPC MOBL WDG STNT DSK-MAPL	\$265.05	\$1,590.30
		Which consists of:		
1A	LCT3024	6 TABLE, BOX, GUIDE FOR LC787	\$0.00	\$0.00
1B	LCL23343	6 3EA 23-34IN TABLE LEGS-CASTERS	\$0.00	\$0.00
2	LC231BU	6 FLEX-SPACE COMFY STOOL-BU	\$141.55	\$849.30
3	LC230	1 FLEX-SPACE 4-SHELF STORG-MAPLE	\$550.05	\$550.05
4	LC229	1 FLEX-SPACE 3-SHELF STORG-MAPLE	\$436.05	\$436.05
5	LC759	1 FLX-SPACE 30X60 MOBL TBL-MAPLE	\$474.05	\$474.05
		Which consists of:		
5A	LCT3060W	1 TABLE, BOX, GUIDE FOR LC759	\$0.00	\$0.00
5B	LCL23344	1 4EA 23-34IN TABLE LEGS-CASTERS	\$0.00	\$0.00
6	LC765BU	5 FLX-SPC 15.5IN ERGO CHAIR-BU	\$117.80	\$589.00

7	LC230	1	FLEX-SPACE 4-SHELF STORG-MAPLE	\$550.05	\$550.05
8	LC679	1	FLX-SPC 48IN RND MOBL TBL-MAPL	\$474.05	\$474.05
Which consists of:					
8A	LCT48W	1	TABLE, BOX, GUIDE FOR LC679	\$0.00	\$0.00
8B	LCL23344	1	4EA 23-34IN TABLE LEGS-CASTERS	\$0.00	\$0.00
9	LC515BU	4	FLEX-SPACE 15.5IN CHAIR-BU	\$54.14	\$216.56
10	LC517BU	1	FLEX-SPACE 17.5IN CHAIR-BU	\$66.49	\$66.49
11	LC230	1	FLEX-SPACE 4-SHELF STORG-MAPLE	\$550.05	\$550.05
12	LC788	13	FLEX-SPC MOBL STDNT DESK-MAPLE	\$303.05	\$3,939.65
Which consists of:					
12A	LCT2620	13	TABLE, BOX, GUIDE FOR LC788	\$0.00	\$0.00
12B	LCL23344	13	4EA 23-34IN TABLE LEGS-CASTERS	\$0.00	\$0.00
13	LC515BU	4	FLEX-SPACE 15.5IN CHAIR-BU	\$54.14	\$216.56
14	LC517BU	4	FLEX-SPACE 17.5IN CHAIR-BU	\$66.49	\$265.96
15	LC766BU	2	FLX-SPC 16IN PREM WOB CHR-BU	\$85.49	\$170.98
16	LC768BU	3	FLX-SPC 18IN PREM WOB CHR-BU	\$94.99	\$284.97
17	LC813BU	1	FLX-SPC LNGE COUCH FOR 3-BU	\$474.05	\$474.05
18	LC230	3	FLEX-SPACE 4-SHELF STORG-MAPLE	\$550.05	\$1,650.15
19	LC739	2	FLEX-SPAC MOBL TCHR DESK-MAPLE	\$854.05	\$1,708.10
Which consists of:					
19A	LCTM5724	2	TBLTOP ASSMBLY GUIDE FOR LC739	\$0.00	\$0.00
19B	LCM3112	2	MDSTY PNL-TBL LEG LC739, LC259	\$0.00	\$0.00
19C	LCC2326	2	CABINET,CASTERS - LC739, LC259	\$0.00	\$0.00
20	LC517BU	2	FLEX-SPACE 17.5IN CHAIR-BU	\$66.49	\$132.98
21	LC508	2	FLX-SPC 12-CUBBY MBL STR-MAPLE	\$1,234.05	\$2,468.10
22	TT729BB	48	NEON HEAVY-DUTY BIN - BRT BU	\$8.54	\$409.92
23	TT768BB	24	CONNECT-STORE BK BIN-BRT BU	\$5.69	\$136.56

Subtotal:	\$18,203.93
0.0% Tax:	\$0.00
Freight Amount:	\$0.00
Total:	\$18,203.93

**QUOTE 92560**

Lakeshore Learning Materials
 2695 E. Dominguez Street Carson, CA 90895
 (310) 537-8600 (800) 421-5354
 FAX: (310) 900-2189
www.lakeshorelearning.com

Bill-to: 83721
 EAST STROUDSBURG AREA SCH DIST
 ACCOUNTS PAYABLE
 50 VINE ST
 E STROUDSBURG PA 18301-0298
 (570) 424-8500

Ship-to: 131488
 E STROUDSBURG ELEM SCHOOL
 2002 MILFORD RD
 E STROUDSBURG PA 18301-7800

Billto Email:**Shipto Email:****Entry Date:** 03/04/2020**Your Reference No.:** EAST STROUDSBURGH ELEM 3-5**Comment**

DELIVER 7-10 BUSINESS DAYS ARO
 PRICES GOOD FOR 90 DAYS

FOB DESTINATION:FREE SHIPPING
 DISCOUNT REFLECTED IN PRICES.

PLEASE REFERENCE QUOTE NUMBER
 92560 ON YOUR PURCHASE ORDER.

CYNTHIA PEREZ - QUOTE AGENT

Line Item	Qty	Description	Price	Extended
1	LC787	6 FLX-SPC MOBL WDG STNT DSK-MAPL	\$265.05	\$1,590.30
		Which consists of:		
1A	LCT3024	6 TABLE, BOX, GUIDE FOR LC787	\$0.00	\$0.00
1B	LCL23343	6 3EA 23-34IN TABLE LEGS-CASTERS	\$0.00	\$0.00
2	LC231BU	6 FLEX-SPACE COMFY STOOL-BU	\$141.55	\$849.30
3	LC230	1 FLEX-SPACE 4-SHELF STORG-MAPLE	\$550.05	\$550.05
4	LC229	1 FLEX-SPACE 3-SHELF STORG-MAPLE	\$436.05	\$436.05
5	LC759	1 FLX-SPACE 30X60 MOBL TBL-MAPLE	\$474.05	\$474.05
		Which consists of:		
5A	LCT3060W	1 TABLE, BOX, GUIDE FOR LC759	\$0.00	\$0.00
5B	LCL23344	1 4EA 23-34IN TABLE LEGS-CASTERS	\$0.00	\$0.00
6	LC765BU	5 FLX-SPC 15.5IN ERGO CHAIR-BU	\$117.80	\$589.00

7	LC230	1	FLEX-SPACE 4-SHELF STORG-MAPLE	\$550.05	\$550.05
8	LC679	1	FLX-SPC 48IN RND MOBL TBL-MAPL	\$474.05	\$474.05
Which consists of:					
8A	LCT48W	1	TABLE, BOX, GUIDE FOR LC679	\$0.00	\$0.00
8B	LCL23344	1	4EA 23-34IN TABLE LEGS-CASTERS	\$0.00	\$0.00
9	LC515BU	4	FLEX-SPACE 15.5IN CHAIR-BU	\$54.14	\$216.56
10	LC517BU	1	FLEX-SPACE 17.5IN CHAIR-BU	\$66.49	\$66.49
11	LC230	1	FLEX-SPACE 4-SHELF STORG-MAPLE	\$550.05	\$550.05
12	LC788	13	FLEX-SPC MOBL STDNT DESK-MAPLE	\$303.05	\$3,939.65

Which consists of:

12A	LCT2620	13	TABLE, BOX, GUIDE FOR LC788	\$0.00	\$0.00
12B	LCL23344	13	4EA 23-34IN TABLE LEGS-CASTERS	\$0.00	\$0.00
13	LC515BU	4	FLEX-SPACE 15.5IN CHAIR-BU	\$54.14	\$216.56
14	LC517BU	4	FLEX-SPACE 17.5IN CHAIR-BU	\$66.49	\$265.96
15	LC766BU	2	FLX-SPC 16IN PREM WOB CHR-BU	\$85.49	\$170.98
16	LC768BU	3	FLX-SPC 18IN PREM WOB CHR-BU	\$94.99	\$284.97
17	LC813BU	1	FLX-SPC LNGE COUCH FOR 3-BU	\$474.05	\$474.05
18	LC230	3	FLEX-SPACE 4-SHELF STORG-MAPLE	\$550.05	\$1,650.15
19	LC739	2	FLEX-SPAC MOBL TCHR DESK-MAPLE	\$854.05	\$1,708.10

Which consists of:

19A	LCTM5724	2	TBLTOP ASSMBLY GUIDE FOR LC739	\$0.00	\$0.00
19B	LCM3112	2	MDSTY PNL-TBL LEG LC739, LC259	\$0.00	\$0.00
19C	LCC2326	2	CABINET,CASTERS - LC739, LC259	\$0.00	\$0.00
20	LC517BU	2	FLEX-SPACE 17.5IN CHAIR-BU	\$66.49	\$132.98
21	LC508	2	FLX-SPC 12-CUBBY MBL STR-MAPLE	\$1,234.05	\$2,468.10
22	TT729BB	48	NEON HEAVY-DUTY BIN - BRT BU	\$8.54	\$409.92
23	TT768BB	24	CONNECT-STORE BK BIN-BRT BU	\$5.69	\$136.56

Subtotal:	\$18,203.93
0.0% Tax:	\$0.00
Freight Amount:	\$0.00
Total:	\$18,203.93

**QUOTE 92558**

Lakeshore Learning Materials
 2695 E. Dominguez Street Carson, CA 90895
 (310) 537-8600 (800) 421-5354
 FAX: (310) 900-2189
www.lakeshorelearning.com

Bill-to: 83721
 EAST STROUDSBURG AREA SCH DIST
 ACCOUNTS PAYABLE
 50 VINE ST
 E STROUDSBURG PA 18301-0298
 (570) 424-8500

Ship-to: 119414
 SMITHFIELD ELEMENTARY SCHOOL
 245 RIVER RD
 E STROUDSBURG PA 18301-7922

Billto Email:**Shipto Email:****Entry Date:** 03/04/2020**Your Reference No.:** SMITHFIELD 3-5**Comment**

DELIVER 7-10 BUSINESS DAYS ARO
 PRICES GOOD FOR 90 DAYS

FOB DESTINATION:FREE SHIPPING
 DISCOUNT REFLECTED IN PRICES.

PLEASE REFERENCE QUOTE NUMBER
 92558 ON YOUR PURCHASE ORDER.

CYNTHIA PEREZ - QUOTE AGENT

Line Item	Qty	Description	Price	Extended
1	LC787	6 FLX-SPC MOBL WDG STNT DSK-MAPL	\$265.05	\$1,590.30
		Which consists of:		
1A	LCT3024	6 TABLE, BOX, GUIDE FOR LC787	\$0.00	\$0.00
1B	LCL23343	6 3EA 23-34IN TABLE LEGS-CASTERS	\$0.00	\$0.00
2	LC231BU	6 FLEX-SPACE COMFY STOOL-BU	\$141.55	\$849.30
3	LC230	1 FLEX-SPACE 4-SHELF STORG-MAPLE	\$550.05	\$550.05
4	LC229	1 FLEX-SPACE 3-SHELF STORG-MAPLE	\$436.05	\$436.05
5	LC759	1 FLX-SPACE 30X60 MOBL TBL-MAPLE	\$474.05	\$474.05
		Which consists of:		
5A	LCT3060W	1 TABLE, BOX, GUIDE FOR LC759	\$0.00	\$0.00
5B	LCL23344	1 4EA 23-34IN TABLE LEGS-CASTERS	\$0.00	\$0.00
6	LC765BU	5 FLX-SPC 15.5IN ERGO CHAIR-BU	\$117.80	\$589.00

7	LC230	1	FLEX-SPACE 4-SHELF STORG-MAPLE	\$550.05	\$550.05
8	LC679	1	FLX-SPC 48IN RND MOBL TBL-MAPL	\$474.05	\$474.05
Which consists of:					
8A	LCT48W	1	TABLE, BOX, GUIDE FOR LC679	\$0.00	\$0.00
8B	LCL23344	1	4EA 23-34IN TABLE LEGS-CASTERS	\$0.00	\$0.00
9	LC515BU	4	FLEX-SPACE 15.5IN CHAIR-BU	\$54.14	\$216.56
10	LC517BU	1	FLEX-SPACE 17.5IN CHAIR-BU	\$66.49	\$66.49
11	LC230	1	FLEX-SPACE 4-SHELF STORG-MAPLE	\$550.05	\$550.05
12	LC788	13	FLEX-SPC MOBL STDNT DESK-MAPLE	\$303.05	\$3,939.65
Which consists of:					
12A	LCT2620	13	TABLE, BOX, GUIDE FOR LC788	\$0.00	\$0.00
12B	LCL23344	13	4EA 23-34IN TABLE LEGS-CASTERS	\$0.00	\$0.00
13	LC515BU	4	FLEX-SPACE 15.5IN CHAIR-BU	\$54.14	\$216.56
14	LC517BU	4	FLEX-SPACE 17.5IN CHAIR-BU	\$66.49	\$265.96
15	LC766BU	2	FLX-SPC 16IN PREM WOB CHR-BU	\$85.49	\$170.98
16	LC768BU	3	FLX-SPC 18IN PREM WOB CHR-BU	\$94.99	\$284.97
17	LC813BU	1	FLX-SPC LNGE COUCH FOR 3-BU	\$474.05	\$474.05
18	LC230	3	FLEX-SPACE 4-SHELF STORG-MAPLE	\$550.05	\$1,650.15
19	LC739	2	FLEX-SPAC MOBL TCHR DESK-MAPLE	\$854.05	\$1,708.10
Which consists of:					
19A	LCTM5724	2	TBLTOP ASSMBLY GUIDE FOR LC739	\$0.00	\$0.00
19B	LCM3112	2	MDSTY PNL-TBL LEG LC739, LC259	\$0.00	\$0.00
19C	LCC2326	2	CABINET,CASTERS - LC739, LC259	\$0.00	\$0.00
20	LC517BU	2	FLEX-SPACE 17.5IN CHAIR-BU	\$66.49	\$132.98
21	LC508	2	FLX-SPC 12-CUBBY MBL STR-MAPLE	\$1,234.05	\$2,468.10
22	TT729BB	48	NEON HEAVY-DUTY BIN - BRT BU	\$8.54	\$409.92
23	TT768BB	24	CONNECT-STORE BK BIN-BRT BU	\$5.69	\$136.56

Subtotal:	\$18,203.93
0.0% Tax:	\$0.00
Freight Amount:	\$0.00
Total:	\$18,203.93

COMPLETE CLASSROOM FOR
EAST STROUDSBURG AREA SCHOOL DISTRICT - EMOTIONAL SUPPORT ROOM

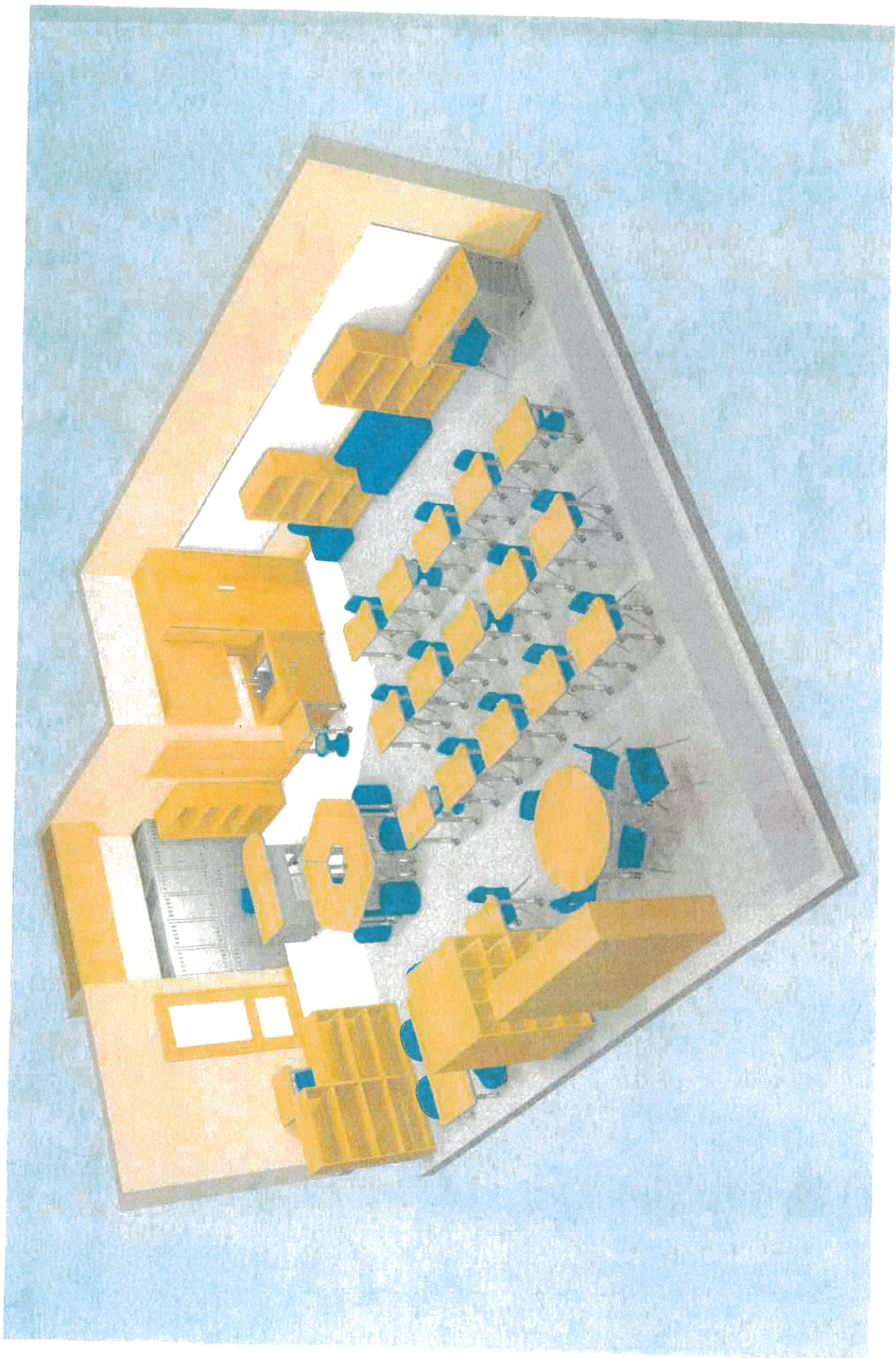

REPRESENTATION ONLY. ROOM DIMENSIONS OR MEASUREMENTS MAY VARY.

COMPLETE CLASSROOM® FOR
EAST STROUDSBURG AREA SCHOOL DISTRICT - EMOTIONAL SUPPORT ROOM

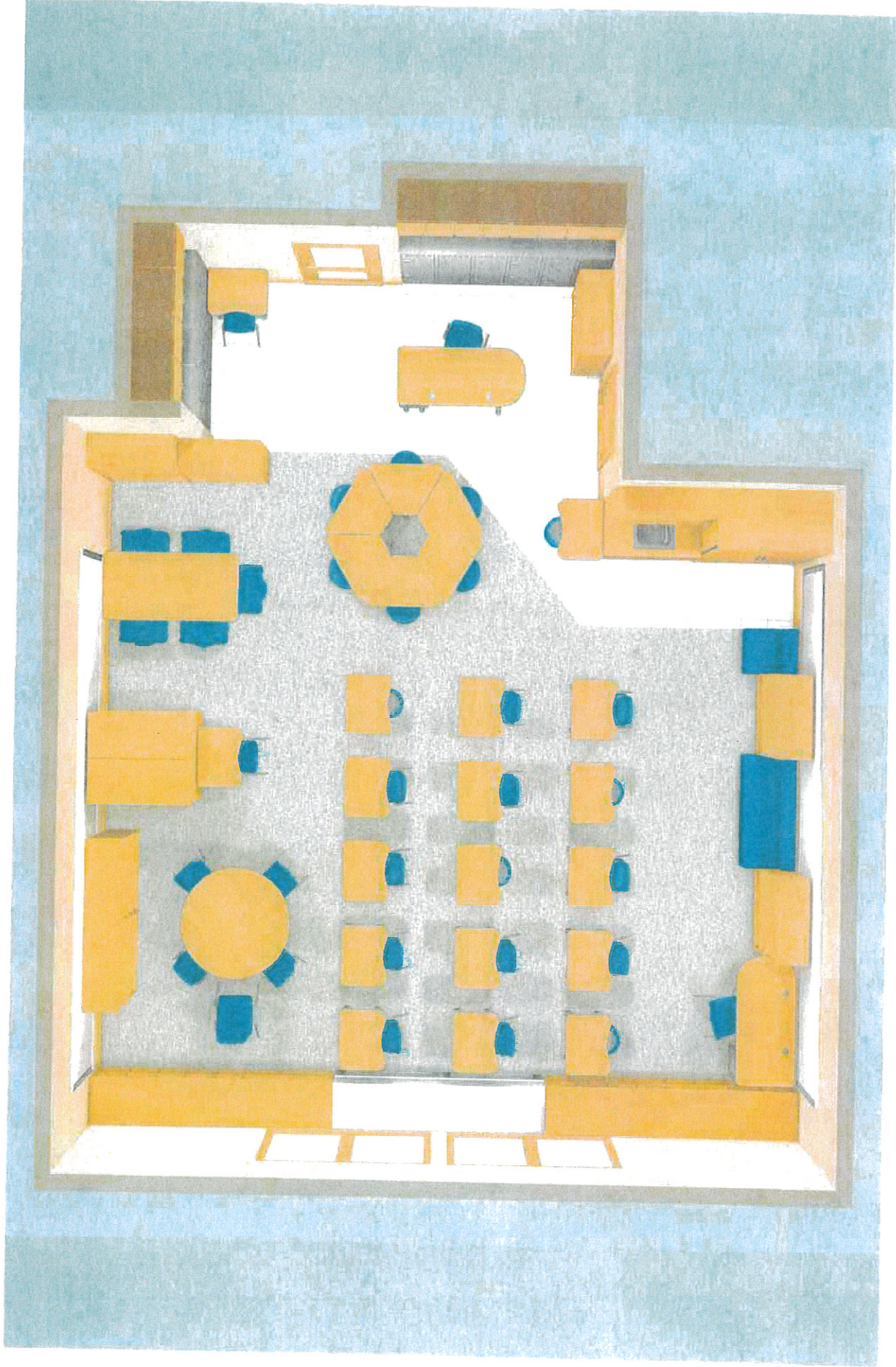

REPRESENTATION ONLY. ROOM DIMENSIONS OR MEASUREMENTS MAY VARY.

COMPLETE CLASSROOM® FOR
EAST STROUDSBURG AREA SCHOOL DISTRICT - EMOTIONAL SUPPORT ROOM

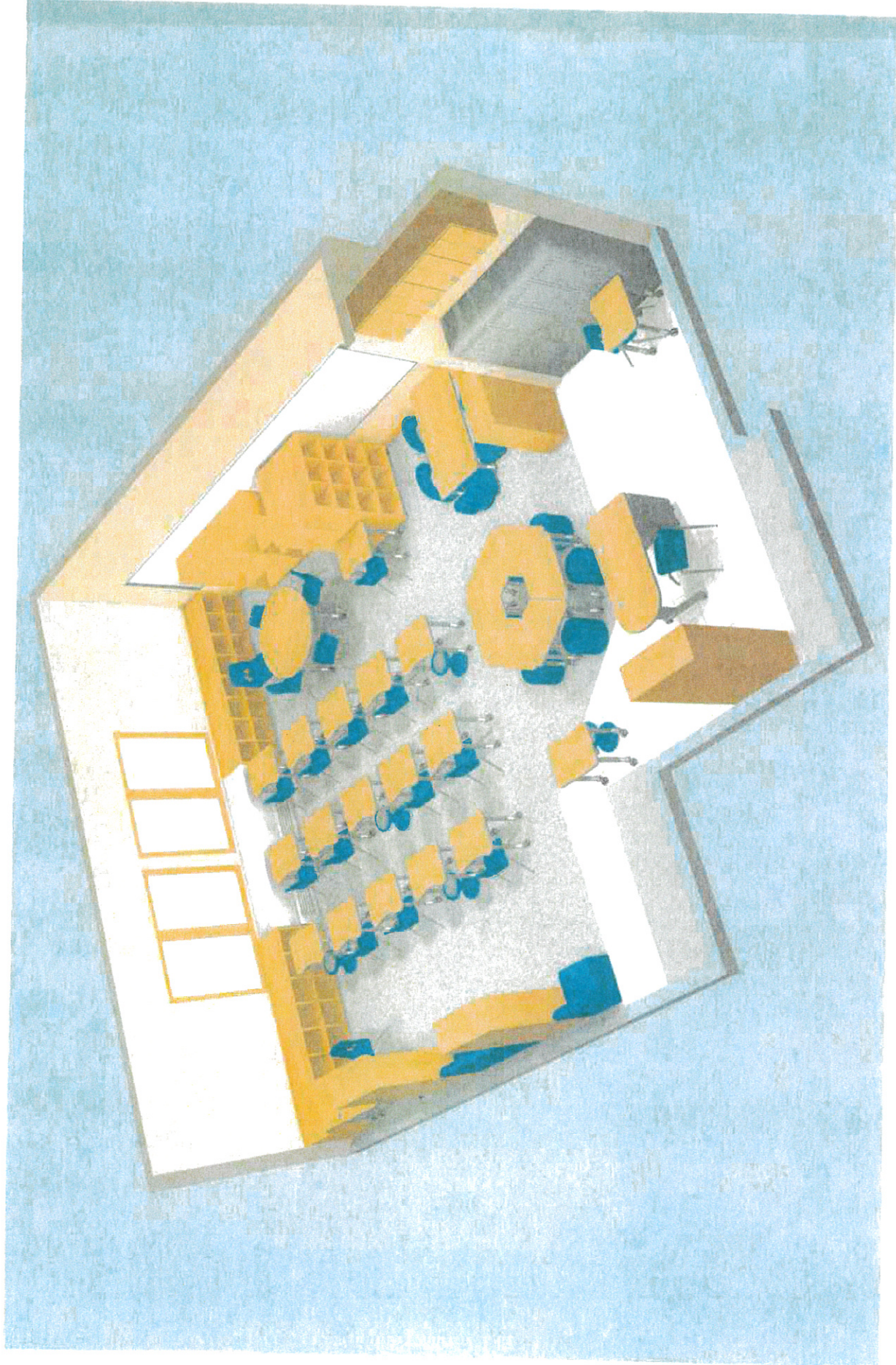

REPRESENTATION ONLY. ROOM DIMENSIONS OR MEASUREMENTS MAY VARY.



QUOTE 92562

Lakeshore Learning Materials
 2695 E. Dominguez Street Carson, CA 90895
 (310) 537-8600 (800) 421-5354
 FAX: (310) 900-2189
www.lakeshorelearning.com

Bill-to: 83721
 EAST STROUDSBURG AREA SCH DIST
 ACCOUNTS PAYABLE
 50 VINE ST
 E STROUDSBURG PA 18301-0298
 (570) 424-8500

Ship-to: 119414
 SMITHFIELD ELEMENTARY SCHOOL
 245 RIVER RD
 E STROUDSBURG PA 18301-7922

Billto Email:

Shipto Email:

Entry Date: 03/04/2020

Your Reference No.: SMITHFIELD K-2

Comment

DELIVER 7-10 BUSINESS DAYS ARO
 PRICES GOOD FOR 90 DAYS

FOB DESTINATION:FREE SHIPPING
 DISCOUNT REFLECTED IN PRICES.

PLEASE REFERENCE QUOTE NUMBER
 92562 ON YOUR PURCHASE ORDER.

CYNTHIA PEREZ - QUOTE AGENT

Line Item	Qty	Description	Price	Extended
1 LC787	6	FLX-SPC MOBL WDG STNT DSK-MAPL	\$265.05	\$1,590.30
Which consists of:				
1A LCT3024	6	TABLE, BOX, GUIDE FOR LC787	\$0.00	\$0.00
1B LCL23343	6	3EA 23-34IN TABLE LEGS-CASTERS	\$0.00	\$0.00
2 LC231BU	6	FLEX-SPACE COMFY STOOL-BU	\$141.55	\$849.30
3 LC230	1	FLEX-SPACE 4-SHELF STORG-MAPLE	\$550.05	\$550.05
4 LC229	1	FLEX-SPACE 3-SHELF STORG-MAPLE	\$436.05	\$436.05
5 LC758	1	FLEX-SPACE 30X60 FLR TBL-MAPLE	\$312.55	\$312.55
Which consists of:				
5A LCT3060B	1	TABLE, BOX, GUIDE FOR LC758	\$0.00	\$0.00
5B LCL1116	1	4EA - 11-16IN TABLE LEGS	\$0.00	\$0.00
6 LC405BU	5	FLEX-SPACE COMFY FLR SEAT-BU	\$56.99	\$284.95

7	LC230	1	FLEX-SPACE 4-SHELF STORG-MAPLE	\$550.05	\$550.05
8	LC679	1	FLX-SPC 48IN RND MOBL TBL-MAPL	\$474.05	\$474.05
Which consists of:					
8A	LCT48W	1	TABLE, BOX, GUIDE FOR LC679	\$0.00	\$0.00
8B	LCL23344	1	4EA 23-34IN TABLE LEGS-CASTERS	\$0.00	\$0.00
9	LC515BU	4	FLEX-SPACE 15.5IN CHAIR-BU	\$54.14	\$216.56
10	LC517BU	1	FLEX-SPACE 17.5IN CHAIR-BU	\$66.49	\$66.49
11	LC230	1	FLEX-SPACE 4-SHELF STORG-MAPLE	\$550.05	\$550.05
12	LC788	18	FLEX-SPC MOBL STDNT DESK-MAPLE	\$303.05	\$5,454.90
Which consists of:					
12A	LCT2620	18	TABLE, BOX, GUIDE FOR LC788	\$0.00	\$0.00
12B	LCL23344	18	4EA 23-34IN TABLE LEGS-CASTERS	\$0.00	\$0.00
13	LC515BU	13	FLEX-SPACE 15.5IN CHAIR-BU	\$54.14	\$703.82
14	LC764BU	5	FLX-SPC 14IN PREM WOB CHR-BU	\$75.99	\$379.95
15	LC813BU	1	FLX-SPC LNGE COUCH FOR 3-BU	\$474.05	\$474.05
16	LC812BU	1	FLEX-SPC LOUNGE-LRN CHAIR-BU	\$236.55	\$236.55
17	LC230	3	FLEX-SPACE 4-SHELF STORG-MAPLE	\$550.05	\$1,650.15
18	LC739	2	FLEX-SPAC MOBL TCHR DESK-MAPLE	\$854.05	\$1,708.10
Which consists of:					
18A	LCTM5724	2	TBLTOP ASSMBLY GUIDE FOR LC739	\$0.00	\$0.00
18B	LCM3112	2	MDSTY PNL-TBL LEG LC739, LC259	\$0.00	\$0.00
18C	LCC2326	2	CABINET,CASTERS - LC739, LC259	\$0.00	\$0.00
19	LC517BU	2	FLEX-SPACE 17.5IN CHAIR-BU	\$66.49	\$132.98
20	LC508	2	FLX-SPC 12-CUBBY MBL STR-MAPLE	\$1,234.05	\$2,468.10
21	TT729BB	48	NEON HEAVY-DUTY BIN - BRT BU	\$8.54	\$409.92
22	TT768BB	24	CONNECT-STORE BK BIN-BRT BU	\$5.69	\$136.56

Subtotal:	\$19,635.48
0.0% Tax:	\$0.00
Freight Amount:	\$0.00
Total:	\$19,635.48

COMPLETE CLASSROOM FOR
EAST STROUDSBURG AREA SCHOOL DISTRICT - EMOTIONAL SUPPORT ROOM

John H. Field K-2

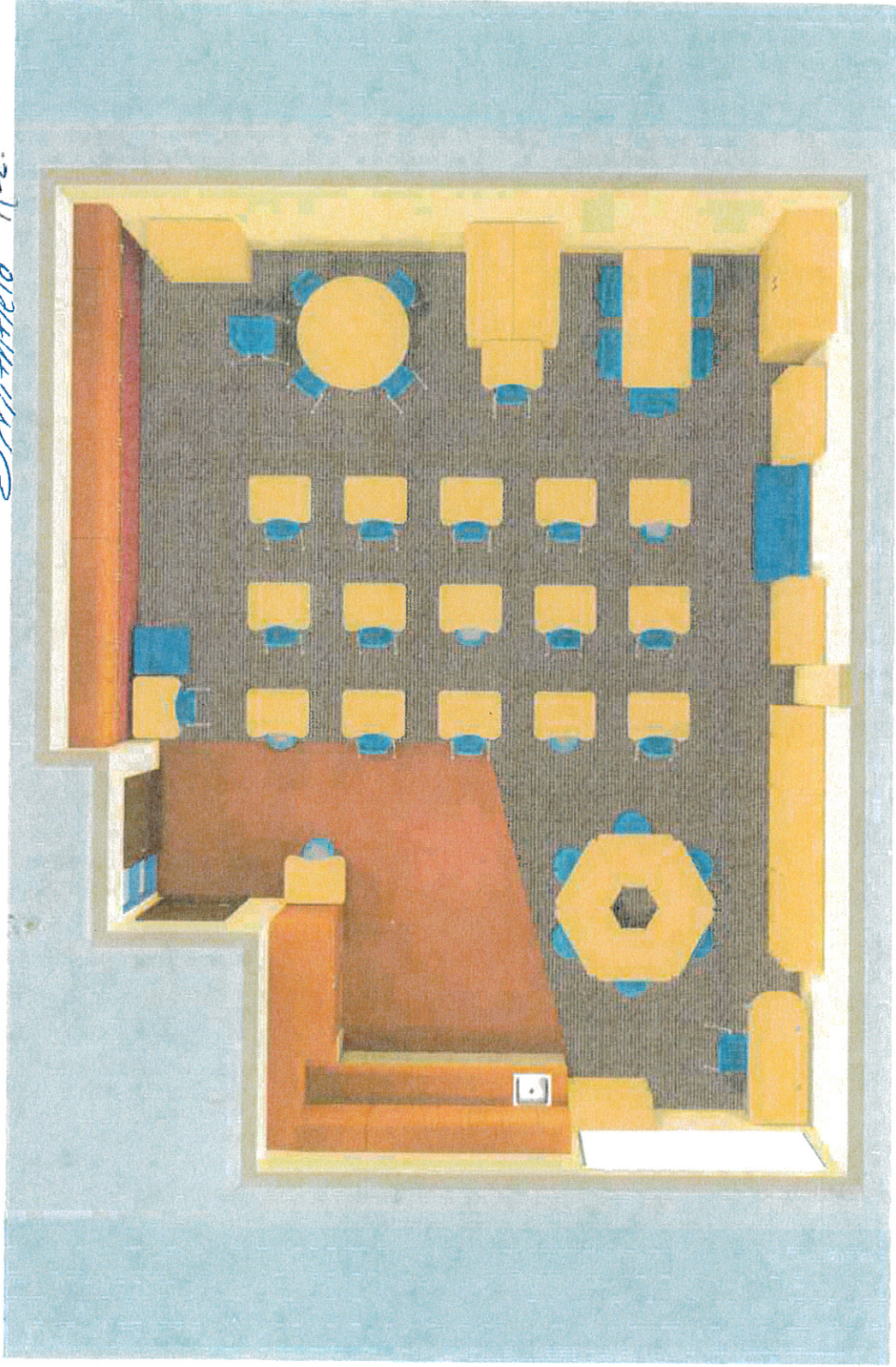

REPRESENTATION ONLY. ROOM DIMENSIONS OR MEASUREMENTS MAY VARY.

www.LakeshoreLearning.com/classroom



COMPLETE CLASSROOM FOR
EAST STROUDSBURG AREA SCHOOL DISTRICT - EMOTIONAL SUPPORT ROOM

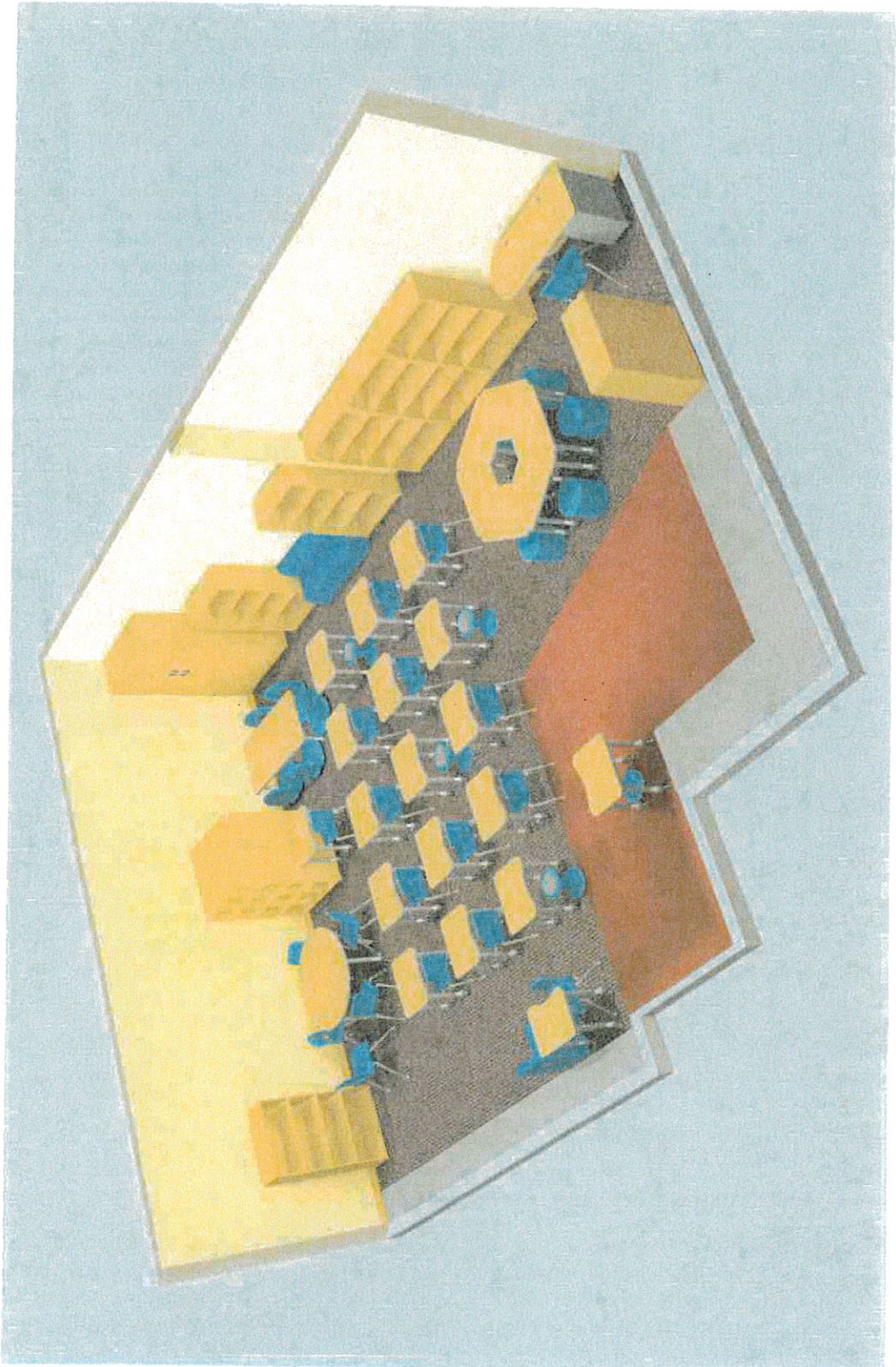

REPRESENTATION ONLY. ROOM DIMENSIONS OR MEASUREMENTS MAY VARY.

www.LakeshoreLearning.com/classroom

©2019 Lakeshore

Phone: 800-421-5354 3

COMPLETE CLASSROOM FOR
EAST STROUDSBURG AREA SCHOOL DISTRICT - EMOTIONAL SUPPORT ROOM

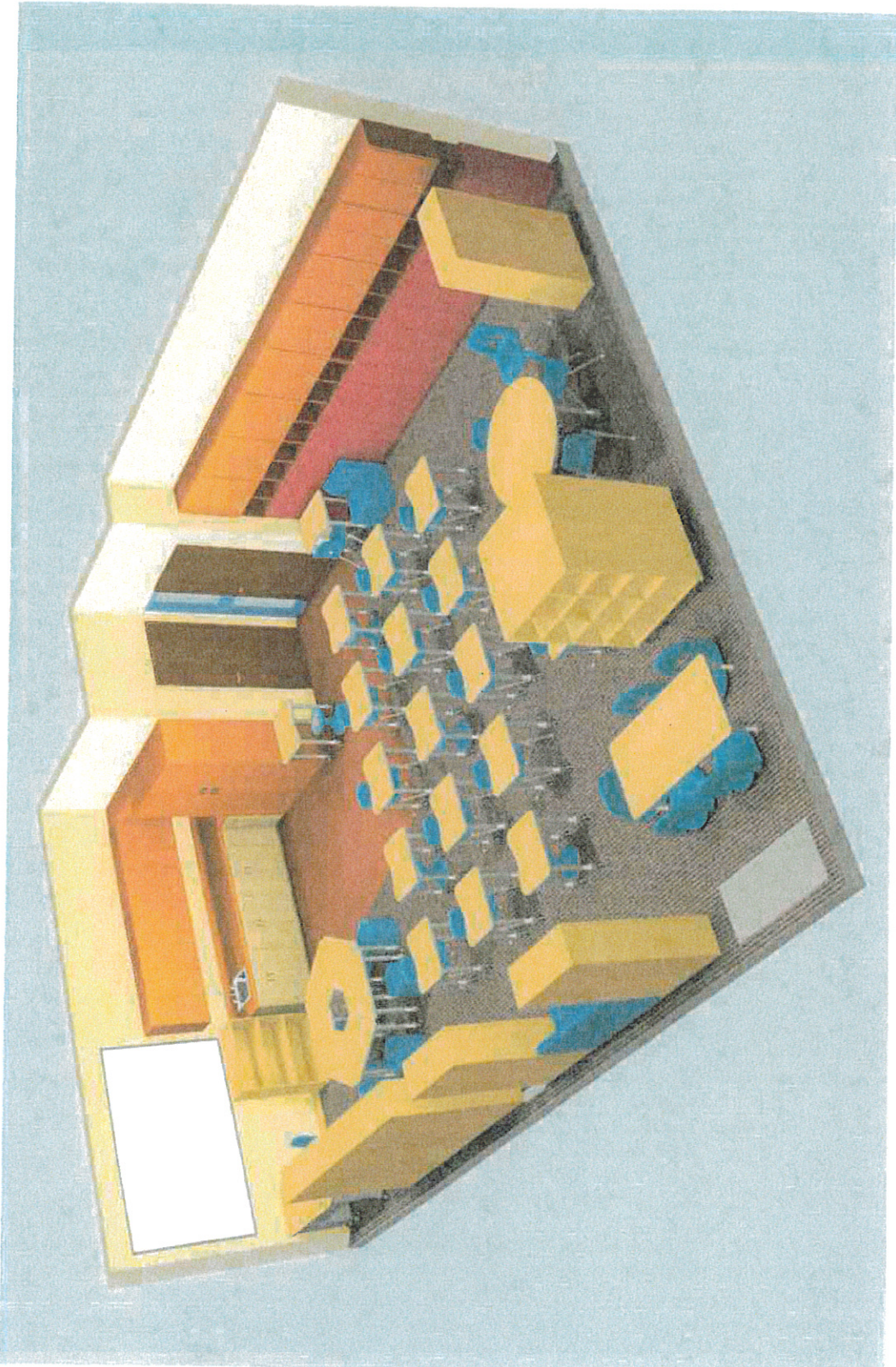

REPRESENTATION ONLY. ROOM DIMENSIONS OR MEASUREMENTS MAY VARY.

www.LakeshoreLearning.com/classroom

V. Items for Discussion

j. Payment in Lieu of Taxes – National Recreation Area, Pike County

APPLICATION FOR PAYMENT
PROPERTY ACQUIRED BY STATE
FOR WATER CONSERVATION OR FLOOD PREVENTION
(Section 604 of School Code)

SCHOOL DISTRICT	AUN	SCHOOL YEAR
East Stroudsburg Area SD	120452003	2019-2020

This application is for Payment in Lieu of Taxes on property in Pike County,
acquired by the state for the purpose of water conservation or flood prevention in the
National Recreation Area project.

School district (or component former district) from which property was acquired:
Lehman Township

Assessed valuation of property at time of acquisition: \$94,371.00

Tax rate for school purposes during school year for which application is made: 123.6600 mills

Amount due school district (assessed valuation x mills): \$11,669.92

SIGNATURES

District Superintendent: _____

President of School Board: _____

Secretary of School Board: _____