

ATTACHMENT VI. A.1

ESASD PA Systems				
School	Model	Install Date	Replacement Date	Proposed Replacement Date
JT Lambert Intermediate School	TCV	1992	Summer 2018 (June)	
Lehman Intermediate/High School North	TC2100	1997	Summer 2017 (Aug.)	
Middle Smithfield Elementary School	TC1100	1997		Summer 2019
Bushkill Elementary School	TC1100	1998		Summer 2019
Resica Elementary School	TC1100	2003		Summer 2021
East Stroudsburg Elementary School	TC2100	2006		Summer 2024
Smithfield Elementary School	TC2100	2007		Summer 2026
High School South	TCICS	2007		Summer 2027
JM Hill Elementary	ICS	2013		Summer 2031



**Integrated Security  
& Communications**

www.comsysinc.com

## PEPPM Proposal

To:	East Stroudsburg Area School District	Date:	11/26/2018
Address:	Business Office East Stroudsburg, PA 18301	From:	<b>Emily Schenkel</b>
Contact:	<b>Brian Borosh</b>	Phone:	<b>610-841-9632</b>
Phone:	<b>(570) 424-8500 1329</b>	Email:	eschenkel@comsysinc.com
Email:	<b>brian-borosh@esasd.net</b>	Proposal #:	C00Q9474
		Project:	ESASD Bushkill TCU

Dear Brian,

Thank you for the opportunity to provide you with a proposal for the Rauland TCU solution at Bushkill Elementary.

### 1. PROJECT SUMMARY

CSI will provide a Rauland TCU IP based solution for Bushkill Elementary School that will allow for the programming of: speaker zone announcements, school wide announcements and future district wide announcements (any TCU equipped sites). The solution will utilize the same software that is currently in place at High School North and JT Lambert Intermediate School.

### 2. OPERATIONAL SCOPE

The system provides a host of features and functions for making day-to-day paging announcements as well as emergency announcements and clock and time tone management. The system is capable of storing pre-recorded messages that can be activated in an emergency situation on a local or district wide (amongst buildings with TCU software) basis from any authorized and password protected computer. CSI will train the designated end user on the recording of messages. If the gateway solution is selected the school will have the ability to make in-room pages as well as pages to the corridor, exterior, gym and café zones. If the zone page option is selected the school will be able to make zone area pages to the corridors, exterior, gym, café and classroom zones.

The system will utilize existing speakers and cabling. (Proposal assumes all speakers and cabling is in good condition and working order. This can be repaired if required for an additional charge. ESASD will be notified of any issues before repairs are made.)

The system hardware from Rauland is warranted for a period of 5 years. This excludes any service issues that arise from the use of existing speaker circuit cabling and speakers. Please see below warranty section for more details.

CSI is the only designated Rauland dealer for North East Pennsylvania. CSI has been the only designated integrator for Rauland products in this area for over 25 years.

### 3. PROJECT SCOPE

Scope: TCU (Gateway) Option

1. CSI to decommission existing intercom equipment. CSI will label and disconnect existing cabling. Removal of equipment is ESASD's responsibility.
2. CSI will utilize existing cabinet.
3. CSI will furnish and install a TCU controller and (1) TCU Console.
4. CSI will furnish and install (3) gateways for "in-room" paging.
5. CSI to furnish and configure (4) Zone Page Modules and (1) Ashly amp for 4-zone paging.
  - a. The zones will be set up for the Corridors, Exterior, Gym, Cafe



6. CSI to re-terminate existing cabling to interface with TCU.
7. CSI to furnish and install a new master clock.
8. CSI to program and complete final connections at head end.
9. CSI to set up, adjust and test the solution.
10. CSI to train and demo solution to end user.
11. ESASD is responsible for server, and other network licenses needed to run TCU software. Owner responsible for CAT5 cabling to devices, between IDF's, and power at strobe locations.

OR

Scope: TCU Zone Page Option

1. CSI to decommission existing intercom equipment. CSI will label and disconnect existing cabling. Removal of equipment is ESASD's responsibility.
2. CSI will utilize existing cabinet.
3. CSI will furnish and install a TCU controller and (1) TCU Console.
4. CSI to furnish and install (5) ZPM's and (2) Ashly amp for 5-zone paging.
  - a. Zones will be set up for the Corridors, Exterior, Gym, Café, Classrooms
5. CSI to re-terminate existing cabling to interface with TCU.
6. CSI to furnish and install new master clock.
7. CSI to program and complete final connections at head end.
8. CSI to set up, adjust and test the solution.
9. CSI to train and demo solution to end user.
10. ESASD is responsible for server, and other network licenses needed to run TCU software. Owner responsible for CAT5 cabling to devices, between IDF's, and power at strobe locations.

Optional Desk Mic for either of the above solutions:

1. CSI to provide and install desktop mic.

**4. EQUIPMENT LIST**

Qty	Manuf.	Part No	Item	Price	Extended
			GATEWAY OPTION		
	PEPPM Products		PEPPM Products		
1	Rauland Borg Corporation	TCC2000	Telecenter Campus Controller	\$3,944.75	\$3,944.75
3	Rauland Borg Corporation	TCC2024	Telecenter Campus 24 Port Ip C	\$5,914.00	\$17,742.00
2	Rauland Borg Corporation	TCC2099	Universal Mounting Kit	\$57.35	\$114.70
4	Rauland Borg Corporation	TCC2022	Telecenter Campus Zone Module	\$492.90	\$1,971.60
1	Rauland Borg Corporation	TCC2033	Telecenter Campus Auxio Module	\$492.90	\$492.90



# Integrated Security & Communications

www.comsysinc.com

1	Rauland Borg Corporation	TCC2055	Telecenter Campus Prog Module	\$492.90	\$492.90
1	Rauland Borg Corporation	TCC2044	Telecenter Campus Ip Console	\$1,255.50	\$1,255.50
1	Rauland Borg Corporation	TCAMCS	Atomic To Master Clock Synch	\$923.80	\$923.80
1	Rauland Borg Corporation	TCAMCSRMK	Tcamcs Rack Mount Kit	\$122.45	\$122.45
5	Rauland Borg	2305CS	Stainless Stl Call-in Switch	\$20.15	\$100.75
			Total PEPPM Products		\$27,161.35
	Non PEPPM Products		Non PEPPM Products		
1	Ashly Audio, Inc	TRA-4075	Power Amplifier 4 x 75W @ 4 Ohms with Xfmr Isolated 25V, 70V, & 100V Outputs	\$1,509.15	\$1,509.15
6	Allen Tel	25-3-PC-10-GY	Allen Tel 25-3-PC-10-GY Plug In Connector Cable Patch Cord, 10-Foot Length, 90 Degree Male Plug And 90 Degree Female Connector	\$22.00	\$132.00
3	Siemon	M4-2W	Pre-Wired M4 Series Block, Two female 25-pair connectors	\$97.00	\$291.00
3	Siemon	MC4LH-9	Siemon Orange Block 66 Covers	\$3.00	\$9.00
6	Allen Tel	25-3-PP-15-GY-LYN	15' m/m cat3 25 pair cable	\$25.00	\$150.00
			Total Non-PEPPM Products		\$2,091.65
	PEPPM Labor		PEPPM Labor		
23		PPS3000	PEPPM Professional Services	\$150.00	\$3,450.00
75		PBSI000	PEPPM Installation Services	\$95.00	\$7,125.00
			Total PEPPM Labor		\$10,575.00
			TOTAL FOR GATEWAY SOLUTION OPTION		\$40,889.00
			ZONE PAGE OPTION		
	PEPPM Products		PEPPM Products		
1	Rauland Borg Corporation	TCC2000	Telecenter Campus Controller	\$3,944.75	\$3,944.75
3	Rauland Borg Corporation	TCC2099	Universal Mounting Kit	\$57.35	\$172.05
5	Rauland Borg Corporation	TCC2022	Telecenter Campus Zone Module	\$492.50	\$2,462.50
1	Rauland Borg Corporation	TCC2033	Telecenter Campus Auxio Module	\$492.50	\$492.50
1	Rauland Borg Corporation	TCC2055	Telecenter Campus Prog Module	\$492.00	\$492.00
1	Rauland Borg Corporation	TCC2044	Telecenter Campus Ip Console	\$1,255.50	\$1,255.50
1	Rauland Borg Corporation	TCAMCS	Atomic To Master Clock Synch	\$923.80	\$923.80
1	Rauland Borg Corporation	TCAMCSRMK	Tcamcs Rack Mount Kit	\$122.45	\$122.45
5	Rauland Borg	2305CS	Stainless Stl Call-in Switch	\$20.15	\$100.75
			Total PEPPM Products		\$9,966.30



Non PEPPM Products		Non PEPPM Products			
2	Ashly Audio, Inc	TRA-4075	Power Amplifier 4 x 75W @ 4 Ohms with Xfmr Isolated 25V, 70V, & 100V Outputs	\$1,509.10	\$3,018.20
6	Allen Tel	25-3-PC-10-GY	Allen Tel 25-3-PC-10-GY Plug In Connector Cable Patch Cord, 10-Foot Length, 90 Degree Male Plug And 90 Degree Female Connector	\$22.00	\$132.00
3	Siemon	M4-2W	Pre-Wired M4 Series Block, Two female 25-pair connectors	\$97.00	\$291.00
3	Siemon	MC4LH-9	Siemon Orange Block 66 Covers	\$3.00	\$9.00
6	Allen Tel	25-3-PP-15-GY-LYN	15' m/m cat3 25 pair cable	\$25.00	\$150.00
Total Non-PEPPM Products					\$3,600.20
PEPPM Labor		PEPPM Labor			
23		PPS3000	PEPPM Professional Services	\$150.00	\$3,450.00
75		PIBS1000	PEPPM Installation Services	\$95.00	\$7,125.00
Total PEPPM Products and Labor					\$10,575.00
TOTAL for ZONE PAGING OPTION					\$25,203.00
OPTIONAL DESKTOP MIC					
1	Rauland Borg	TCC2077	Telecenter Mic Input Module	\$938.00	\$938.00
1	Shure	CVG12-B/C	Cardioid-12" Dual-Section Gooseneck Condenser Microphone, Inline Preamp/ifier, Flange Mount, Black	\$124.00	\$124.00
Total for DESKTOP MIC					\$1,062.00

**Applicable Sales Tax will be charged**

**This product is not in stock.  
Please indicate if you require special shipping on the return order.**

**5. TRAINING**

Training is an important part of the success of a system implementation. A system will function only as well as the user understands all of its features and functions. Because it is not possible to learn all of the features and functions of the system in training sessions, CSI and the manufacturer has provided tools for you to access on your own time to learn at your own pace. Our training outline for this system includes the following;

- a. We will provide (2) hours of training on system operation and review maintenance requirements.

Additional and ongoing training is available for your system. Training can be customized to your needs and purchased hourly or as part of our Service Level Agreement, available for all systems we provide.

**6. DOCUMENTATION AND DELIVERABLES**

- a. We will provide product specifications in electronic format.
- b. Includes engineered system documentation for future referral, service and maintenance.

**7. PROJECT SCHEDULE**

- a. Typical project installation lead time is approximately 4-6 weeks from receipt of signed proposal / PO and mobilization payment. In the event there are any product backorders or unforeseen circumstances that could affect this lead time, you will be notified by the CSI project manager assigned to your project.



**8. WORK BY OTHERS**

ESASD is responsible for server, and other network licenses needed to run TCU software. Owner responsible for CAT5 cabling to devices, between IDF's, and power at strobe locations.

**9. WHAT IS NOT INCLUDED**

- a. Materials and services not specifically listed in the equipment list or project scope are not included.
- b. System and CAD drawings, submittals and programming documentation available upon request. Additional charges may apply.

**10. SYSTEM INVESTMENT**

Select	Description	Ext Price
<b>Please select the Gateway OR Zone Page Solution</b>		
<input type="checkbox"/>	Gateway TCU Solution	\$40,889.00
OR		
<input type="checkbox"/>	Zone Paging TCU Solution	\$25,203.00
The Desktop Microphone is an option to the solution selected above		
<input type="checkbox"/>	Desktop Microphone Option	\$1,062.00
<b>Total Cost with Selected Options</b>		<b>\$</b>

**11. PAYMENT TERMS**

Payment Schedule
<b>Mobilization</b>
<i>Invoice for Materials upon Delivery. Due upon receipt.</i>
<b>Installation &amp; Completion – Progressive Invoicing for Remaining Balance</b>
<i>Includes Engineering and Project Management, Physical Installation on Client Premise, Testing, Calibration, Demonstration and Training. Due upon receipt.</i>

**12. ORDERING AND ACCEPTANCE**

The person to whom this Proposal is addressed (the "Client") may accept this Proposal by signing at the space provided below and returning it to CSI along with an approved purchase order within thirty (30) days of the date of this Proposal. By doing so, the Client acknowledges that it has read and understands this Proposal and that Client is entering into a legally binding contract with CSI on the terms and conditions set forth in this Proposal, including the Standard Terms and Conditions set forth in the "Terms and Conditions" section below (which are an integral part of the contract). If the Client signs this Proposal and returns it to CSI more than thirty (30) days after the date of this Proposal, CSI reserves the right to reject the Client's acceptance by written notice to the Client. Each individual signing this Proposal on behalf of an entity represents that he or she is a duly authorized officer or other representative of such entity. This order will be processed upon receipt of payment in full or Mobilization amount and be invoiced as indicated in the "Payment Terms" section above. Past due accounts are subject to interest penalties. Work may be suspended on accounts that are not current. (See credit policy). Please note that the following must be included with your Purchase Order to qualify as a PEPPM purchase.

- All PEPPM orders should be emailed to [orders@peppm.org](mailto:orders@peppm.org).
- In the body of the purchase order, please include the following language: "As per PEPPM 2018"
- Address all orders to: Communication Systems Integrators, LLC 4670 Schantz Road, Allentown, PA 18104
- The PO MUST list CSI's Payment Terms
- The PO MUST be accompanied by a signed copy of CSI's Proposal



\_\_\_\_\_  
Client Signature

\_\_\_\_\_  
CSI Signature

\_\_\_\_\_  
Client Print Name

\_\_\_\_\_  
CSI Print Name

\_\_\_\_\_  
Date

\_\_\_\_\_  
Date

\_\_\_\_\_  
Purchase Order #

Tax Status:  Exempt (copy of current certificate required)

Non-Exempt

**Providing an Authorized Acceptance Signature indicates that you have read and understand the Terms & Conditions attached to this agreement. This document represents the entire agreement. No conversations or other forms of communication shall be considered part of this agreement.**

This proposal was prepared in good faith, exclusively for the individual(s) to whom it is addressed. It contains information that is privileged, confidential and exempt from disclosure under applicable law. The recommendations described herein are based on client consultations, site visits, engineering, and research, computer-aided designs and/or expertise earned through education, training and experience. It is considered an unfair business practice to use this information for competitive negotiations.

**13. PREVENTATIVE MAINTENANCE AND SUPPORT**

The system described in this proposal has been designed to provide you with many years of reliable service and an excellent return on your investment (ROI). However to uphold the warranties of the equipment and achieve maximum longevity, managed services and ROI, regularly scheduled maintenance is required. CSI provides managed services and scheduled maintenance programs for your system that will keep it running smooth and reduce the total cost of ownership.

**14. WARRANTY AND EXTENDED SERVICE**

CSI is proud to offer many of the best in class life safety, security and communications equipment manufacturers. These manufacturers have expressed warranties which guarantee certain rights under Pennsylvania law. Most products used in our installations have a full one-year warranty from the date of purchase. At our option, CSI will repair or replace defective products and product defects caused by improper installation by CSI within one year from the date of purchase. Product only sales are covered solely by the manufacturer's warranty. Products carrying a limited manufacturer's warranty will be facilitated by CSI on the customer's behalf. Products requiring repair will be assessed by the manufacturer and charges may apply to cover applicable non warranty repair costs. Electro-mechanical products such as motors, fuses, hard drives and lamps, unless otherwise specified by the manufacturer, carry a 90-day warranty from the date of purchase. Defects caused by misuse, mishandling, and unauthorized modification and repairs made by non CSI authorized personnel or acts of God are not covered by this warranty. Our proposal includes a pre-paid one year Software Support License when specified in the project scope above.

**15. TERMS AND CONDITIONS**

- a. This proposal does not include any material or services other than that stated in the project scope and equipment list above, permits, applicable sales tax, bonds, special shipping and services to repair, trouble shoot or correct problems related directly or indirectly to pre-existing site conditions, wiring or installation errors by others.
- b. System drawings and submittals are not included. If drawings or submittals are required, there will be an additional charge based on actual engineering and clerical time and materials. We will advise you at the time of placing your order what the turn-around time for this order will be.



- c. Our price will remain valid for 30 days.
- d. Payment terms are as specified in "payment terms", upon approved credit.
- e. CSI reserves the right to modify payment terms as stated or implied in this proposal, pursuant to results from our credit approval process.
- f. Product that is authorized to return for credit must be returned within 30 days from the invoice date in the original unopened cartons. Material that is not returned under these conditions is subject to inspection and may be rejected for credit by the manufacturer.
- g. Applicable sales taxes will be added to all invoices. Tax exemption certificates must be remitted with an executed proposal to be applicable.
- h. Any product ordered for the project and then returned at the discretion of the Client will be subject to a 25% restocking fee.
- i. Source code for all software developed within the scope of this offering remains the property of CSI. Licensing terms are available upon request.
- j. When integrating hardware and/or software with the client's existing network; demarcations will be established to identify clear points of responsibility. If an issue would arise that impacts system design and/or functionality, additional IT engineering will be charged at the current IT service rate.
- k. Data backup is the sole responsibility of the customer. CSI is not held responsible for any loss of data.
- l. Project schedule changes and delays outside of the control of CSI will be accommodated whenever possible. Costs incurred by CSI because of delays outside of CSI's control will be considered outside of scope and may be considered billable.
- m. The cost of any permits required by Authorities Having Jurisdiction, (AHJ), will be borne by the owner.
- n. These terms cannot be altered by verbal or implied communication. All variances from these terms must be requested in writing.
- o. This proposal was prepared in good faith, exclusively for the individual(s) to whom it is addressed. It contains information that is privileged, confidential and exempt from disclosure under applicable law.
- p. Any changes to the Scope of Work (SOW) requested by the Owner or AHJ will require the Client to submit a Change Order Request in writing.
- q. CSI best practice is to provide all of the equipment for a turn-key solution that supports predictable outcomes. Should the Owner prefer to provide equipment to be used in the proposed solution, CSI will not assume any liability or responsibility for the Owner furnished equipment's (OFE) reliability, operation or compatibility with CSI provided equipment and software. Project schedule changes and delays outside of the control of CSI due to the use of OFE will be accommodated whenever possible. Costs incurred by CSI to resolve any issues due to OFE compatibility will be considered outside of the scope and are billable.

## **16. INDEMNIFICATION**

To the fullest extent permitted by law, the owner shall indemnify and hold harmless the CSI, and agents and employees of any of them from and against claims, damages, losses and expenses, including but not limited to attorney's fees, arising out of or resulting from performance of the Work under this proposal, provided that any such claim, damage, loss or expense is attributable to bodily injury, sickness, disease or death, or to injury to or destruction of tangible property (other than the Work itself); but only to the extent caused by the negligent acts or omissions of CSI, anyone directly or indirectly employed by them or anyone for whose acts they may be liable, regardless of whether or not such claim, damage, loss or expense is caused in part by a party indemnified hereunder. Such obligation shall not be construed to negate, abridge, or otherwise reduce other rights or obligations of indemnity which would otherwise exist.





**Integrated Security  
& Communications**

www.comsysinc.com

## PEPPM Proposal

To: East Stroudsburg Area School District	Date: 12/18/2018
Address: Business Office	From: <b>Emily Schenkel</b>
East Stroudsburg, PA 18301	Phone: <b>610-841-9632</b>
Contact: <b>Brian Borosh</b>	Email: eschenkel@comsysinc.com
Phone: <b>(570) 424-8500 1329</b>	Proposal #: C00Q9473
Email: <b>brian-borosh@esasd.net</b>	Project: ESASD Middle Smithfield TCU

Dear Brian,

Thank you for the opportunity to provide you with a proposal for the Rauland TCU solution at Middle Smithfield Elementary School.

### 1. PROJECT SUMMARY

CSI will provide a Rauland TCU IP based solution for Middle Smithfield Elementary School that will allow for the programming of: speaker zone announcements, school wide announcements and future district wide announcements (any TCU equipped sites). The solution will utilize the same software that is currently in place at High School North and JT Lambert Intermediate School.

### 2. OPERATIONAL SCOPE

The system provides a host of features and functions for making day-to-day paging announcements as well as emergency announcements and clock and time tone management. The system is capable of storing pre-recorded messages that can be activated in an emergency situation on a local or district wide (amongst buildings with TCU software) basis from any authorized and password protected computer. CSI will train the designated end user on the recording of messages. If the gateway solution is selected the school will have the ability to make in-room pages as well as pages to the corridor, exterior, gym, aux gym and café zones. If the zone page option is selected the school will be able to make zone area pages to the corridors, exterior, gym, aux gym, café and classroom zones.

The system will utilize existing speakers and cabling. (Proposal assumes all speakers and cabling is in good condition and working order. This can be repaired if required for an additional charge. ESASD will be notified of any issues before repairs are made.)

The system hardware from Rauland is warranted for a period of 5 years. This excludes any service issues that arise from the use of existing speaker circuit cabling and speakers. Please see below warranty section for more details.

CSI is the only designated Rauland dealer for North East Pennsylvania. CSI has been the only designated integrator for Rauland products in this area for over 25 years.

### 3. PROJECT SCOPE

Scope: TCU (Gateway) Option

1. CSI to decommission existing intercom equipment. CSI will label and disconnect existing cabling. Removal of equipment is ESASD's responsibility.
2. CSI will furnish and install a TCU controller and (1) TCU Console.
3. CSI will furnish and install (3) gateways for "in-room" paging.
4. CSI to furnish and configure (5) Zone Page Modules and (1) Ashly amp for 5-zone paging.
  - a. The zones will be set up for the Corridors, Exterior, Gym, Aux Gym and Cafe



5. CSI to re-terminate existing cabling to interface with TCU.
6. CSI to program and complete final connections at head end.
7. CSI to set up, adjust and test the solution.
8. CSI to train and demo solution to end user.
9. ESASD is responsible for server, and other network licenses needed to run TCU software. Owner responsible for CAT5 cabling to devices, between IDF's, and power at strobe locations.

OR

Scope: TCU Zone Page Option

1. CSI to decommission existing intercom equipment. CSI will label and disconnect existing cabling. Removal of equipment is ESASD's responsibility.
2. CSI will furnish and install a TCU controller and (1) TCU Console.
3. CSI to furnish and install (6) Zone Page Modules and (2) Ashly amp for 6-zone paging.
  - a. Zones will be set up for the Corridors, Exterior, Gym, Aux Gym, Café, Classrooms
4. CSI to re-terminate existing cabling to interface with TCU.
5. CSI to program and complete final connections at head end.
6. CSI to set up, adjust and test the solution.
7. CSI to train and demo solution to end user.
8. ESASD is responsible for server, and other network licenses needed to run TCU software. Owner responsible for CAT5 cabling to devices, between IDF's, and power at strobe locations.

Optional Desk Mic for either of the above solutions:

1. CSI to provide and install desktop mic.

#### 4. EQUIPMENT LIST

Qty	Manuf.	Part No	Item	Price	Extended
			GATEWAY OPTION		
	PEPPM Products				
1	Rauland Borg	TCC2000	Telecenter Campus Controller	\$3,944.75	\$3,944.75
1	Rauland Borg	TCC2044	Telecenter Campus Ip Console	\$1,255.50	\$1,255.50
3	Rauland Borg	TCC2024	Telecenter Campus 24 Port Ip C	\$5,914.80	\$17,744.40
5	Rauland Borg	TCC2022	Telecenter Campus Zone Module	\$492.90	\$2,464.50
1	Rauland Borg	TCC2055	Telecenter Campus Prog Module	\$492.90	\$492.90
1	Rauland Borg	TCC2033	Telecenter Campus Auxio Module	\$492.90	\$492.90
3	Rauland Borg	TCC2099	Universal Mounting Kit	\$57.35	\$172.05
5	Rauland Borg	2305CS	Stainless Stl Call-in Switch	\$20.15	\$100.75
			Total PEPPM Products		\$26,667.75
	Non PEPPM Products		Non PEPPM Products		
2	Ashly Audio, Inc	TRA-4075	Power Amplifier 4 x 75W @ 4 Ohms with Xfmr Isolated 25V, 70V, & 100V Outputs	\$1,510.00	\$3,020.00



**Integrated Security  
& Communications**

www.comsysinc.com

6	Allen Tel	25-3-PC-10-GY	Allen Tel 25-3-PC-10-GY Plug In Connector Cable Patch Cord, 10-Foot Length, 90 Degree Male Plug And 90 Degree Female Connector	\$22.00	\$132.00
3	Siemon Company	M4-2W	Pre-Wired M4 Series Block, Two female 25-pair connectors	\$97.00	\$291.00
3	Siemon Company	MC4LH-9	Siemon Orange 66 block covers	\$3.25	\$9.75
6	Allen Tel	25-3-PP-15-GY-LYN	15' m/m cat3 25 pair cable	\$25.00	\$150.00
			Total Non PEPPM Products		\$3,602.75
16		PPS3000	PEPPM Professional Services	\$150.00	\$2,400.00
72		PIBS1000	PEPPM Installation Services	\$95.00	\$6,840.00
			Total PEPPM Labor		\$9,240.00
			TOTAL Gateway TCU Solution		\$40,572.00
			ZONE PAGE OPTION		
1	Rauland Borg	TCC2000	Telecenter Campus Controller	\$3,944.75	\$3,944.75
1	Rauland Borg	TCC2044	Telecenter Campus Ip Console	\$1,255.50	\$1,255.50
6	Rauland Borg	TCC2022	Telecenter Campus Zone Module	\$492.90	\$2,957.40
1	Rauland Borg	TCC2055	Telecenter Campus Prog Module	\$492.90	\$492.90
1	Rauland Borg	TCC2033	Telecenter Campus Auxio Module	\$492.90	\$492.90
3	Rauland Borg	TCC2099	Universal Mounting Kit	\$57.35	\$172.05
5	Rauland Borg	2305CS	Stainless Stl Call-in Switch	\$20.15	\$100.75
			Total PEPPM Products		\$9,416.25
	Non PEPPM Products		Non PEPPM Products		
2	Ashly Audio, Inc	TRA-4075	Power Amplifier 4 x 75W @ 4 Ohms with Xfmr Isolated 25V, 70V, & 100V Outputs	\$1,510.00	\$3,020.00
6	Allen Tel	25-3-PC-10-GY	Allen Tel 25-3-PC-10-GY Plug In Connector Cable Patch Cord, 10-Foot Length, 90 Degree Male Plug And 90 Degree Female Connector	\$22.00	\$132.00
3	Siemon Company	M4-2W	Pre-Wired M4 Series Block, Two female 25-pair connectors	\$97.00	\$291.00
3	Siemon Company	MC4LH-9	Siemon Orange 66 block covers	\$3.25	\$9.75
6	Allen Tel	25-3-PP-15-GY-LYN	15' m/m cat3 25 pair cable	\$25.00	\$150.00
			Total Non PEPPM Products		\$3,602.75
16		PPS3000	PEPPM Professional Services	\$150.00	\$2,400.00
72		PIBS1000	PEPPM Installation Services	\$95.00	\$6,840.00
			Total PEPPM Labor		\$9,240.00
			TOTAL Zone Page Solution		\$22,259.00
			OPTIONAL DESKTOP MIC		
1	Rauland Borg	TCC2077	Telecenter Mic Input Module	\$937.50	\$937.50
1	Shure	CVG12-B/C	Cardioid-12" Dual-Section Gooseneck Condenser Microphone, Inline Preamplifier, Flange Mount, Black	\$124.00	\$124.00
			Total for DESKTOP MIC		\$1,062.00

**Applicable Sales Tax will be charged**



This product is not in stock.  
Please indicate if you require special shipping on the return order.

**5. TRAINING**

Training is an important part of the success of a system implementation. A system will function only as well as the user understands all of its features and functions. Because it is not possible to learn all of the features and functions of the system in training sessions, CSI and the manufacturer has provided tools for you to access on your own time to learn at your own pace. Our training outline for this system includes the following;

- a. We will provide (2) hours of training on system operation and review maintenance requirements as follows;

Additional and ongoing training is available for your system. Training can be customized to your needs and purchased hourly or as part of our Service Level Agreement, available for all systems we provide.

**6. DOCUMENTATION AND DELIVERABLES**

- a. We will provide product specifications and equipment manufacturer's operation manuals in electronic format.
- b. Includes engineered system documentation for future referral, service and maintenance.

**7. PROJECT SCHEDULE**

- a. Typical project installation lead time is approximately 4-6 weeks from receipt of signed proposal / PO and mobilization payment. In the event there are any product backorders or unforeseen circumstances that could affect this lead time, you will be notified by the CSI project manager assigned to your project.

**8. WORK BY OTHERS**

ESASD is responsible for server, and other network licenses needed to run TCU software. Owner responsible for CAT5 cabling to devices, between IDF's, and power at strobe locations.

**9. WHAT IS NOT INCLUDED**

- a. Materials and services not specifically listed in the equipment list or project scope are not included.
- b. System and CAD drawings, submittals and programming documentation available upon request. Additional charges may apply.

**10. SYSTEM INVESTMENT**

Select	Description	Ext Price
	<b>Please select the Gateway OR Zone Page Solution</b>	
<input type="checkbox"/>	Gateway TCU Solution	\$40,572.00
	OR	
<input type="checkbox"/>	Zone Paging TCU Solution	\$22,259.00
	The Desktop Microphone is an option to the solution selected above	
<input type="checkbox"/>	Desktop Microphone Option	\$1,062.00
	<b>Total Cost with Selected Options</b>	

**11. PAYMENT TERMS**

**Payment Schedule**



<b>Mobilization - 50%</b>
<i>Includes Project Management, Engineering Review and Product Acquisition. Due upon receipt</i>
<b>Installation &amp; Completion - Progressive Invoicing for Remaining 50%</b>
<i>Includes Fabrication, Physical Installation on Client Premise, Programming, Testing, Calibration, Demonstration and Training. Due upon receipt.</i>

<b>Payment Schedule</b>
<b>Mobilization</b>
<i>Invoice for Materials upon Delivery. Due upon receipt.</i>
<b>Installation &amp; Completion - Progressive Invoicing for Remaining Balance</b>
<i>Includes Engineering and Project Management, Physical Installation on Client Premise, Testing, Calibration, Demonstration and Training. Due upon receipt.</i>

<b>Payment Schedule</b>
<b>Payment in Full</b>
<i>Invoice for Total Project Cost upon Execution of Agreement. Due upon receipt.</i>

**12. ORDERING AND ACCEPTANCE**

The person to whom this Proposal is addressed (the "Client") may accept this Proposal by signing at the space provided below and returning it to CSI along with an approved purchase order within thirty (30) days of the date of this Proposal. By doing so, the Client acknowledges that it has read and understands this Proposal and that Client is entering into a legally binding contract with CSI on the terms and conditions set forth in this Proposal, including the Standard Terms and Conditions set forth in the "Terms and Conditions" section below (which are an integral part of the contract). If the Client signs this Proposal and returns it to CSI more than thirty (30) days after the date of this Proposal, CSI reserves the right to reject the Client's acceptance by written notice to the Client. Each individual signing this Proposal on behalf of an entity represents that he or she is a duly authorized officer or other representative of such entity. This order will be processed upon receipt of payment in full or Mobilization amount and be invoiced as indicated in the "Payment Terms" section above. Past due accounts are subject to interest penalties. Work may be suspended on accounts that are not current. (See credit policy). Please note that the following must be included with your Purchase Order to qualify as a PEPPM purchase.

- All PEPPM orders should be emailed to [orders@peppm.org](mailto:orders@peppm.org).
- In the body of the purchase order, please include the following language: "As per PEPPM 2018"
- Address all orders to: Communication Systems Integrators, LLC 4670 Schantz Road, Allentown, PA 18104
- The PO MUST list CSI's Payment Terms
- The PO MUST be accompanied by a signed copy of CSI's Proposal

\_\_\_\_\_  
Client Signature

\_\_\_\_\_  
CSI Signature

\_\_\_\_\_  
Client Print Name

\_\_\_\_\_  
CSI Print Name



\_\_\_\_\_ Date

\_\_\_\_\_ Date

\_\_\_\_\_ Purchase Order #

Tax Status:  Exempt (copy of current certificate required)  Non-Exempt

**Providing an Authorized Acceptance Signature indicates that you have read and understand the Terms & Conditions attached to this agreement. This document represents the entire agreement. No conversations or other forms of communication shall be considered part of this agreement.**

This proposal was prepared in good faith, exclusively for the individual(s) to whom it is addressed. It contains information that is privileged, confidential and exempt from disclosure under applicable law. The recommendations described herein are based on client consultations, site visits, engineering, and research, computer-aided designs and/or expertise earned through education, training and experience. It is considered an unfair business practice to use this information for competitive negotiations.

### 13. PREVENTATIVE MAINTENANCE AND SUPPORT

The system described in this proposal has been designed to provide you with many years of reliable service and an excellent return on your investment (ROI). However to uphold the warranties of the equipment and achieve maximum longevity, managed services and ROI, regularly scheduled maintenance is required. CSI provides managed services and scheduled maintenance programs for your system that will keep it running smooth and reduce the total cost of ownership.

### 14. WARRANTY AND EXTENDED SERVICE

CSI is proud to offer many of the best in class life safety, security and communications equipment manufacturers. These manufacturers have expressed warranties which guarantee certain rights under Pennsylvania law. Most products used in our installations have a full one-year warranty from the date of purchase. At our option, CSI will repair or replace defective products and product defects caused by improper installation by CSI within one year from the date of purchase. Product only sales are covered solely by the manufacturer's warranty. Products carrying a limited manufacturer's warranty will be facilitated by CSI on the customer's behalf. Products requiring repair will be assessed by the manufacturer and charges may apply to cover applicable non warranty repair costs. Electro-mechanical products such as motors, fuses, hard drives and lamps, unless otherwise specified by the manufacturer, carry a 90-day warranty from the date of purchase. Defects caused by misuse, mishandling, and unauthorized modification and repairs made by non CSI authorized personnel or acts of God are not covered by this warranty. Our proposal includes a pre-paid one year Software Support License when specified in the project scope above.

### 15. TERMS AND CONDITIONS

- a. This proposal does not include any material or services other than that stated in the project scope and equipment list above, permits, applicable sales tax, bonds, special shipping and services to repair, trouble shoot or correct problems related directly or indirectly to pre-existing site conditions, wiring or installation errors by others.
- b. System drawings and submittals are not included. If drawings or submittals are required, there will be an additional charge based on actual engineering and clerical time and materials. We will advise you at the time of placing your order what the turn-around time for this order will be.
- c. Our price will remain valid for 30 days.
- d. Payment terms are as specified in "payment terms", upon approved credit.
- e. CSI reserves the right to modify payment terms as stated or implied in this proposal, pursuant to results from our credit approval process.
- f. Product that is authorized to return for credit must be returned within 30 days from the invoice date in the original unopened cartons. Material that is not returned under these conditions is subject to inspection and may be rejected for credit by the manufacturer.
- g. Applicable sales taxes will be added to all invoices. Tax exemption certificates must be remitted with an executed proposal to be applicable.
- h. Any product ordered for the project and then returned at the discretion of the Client will be subject to a 25% restocking fee.



- i. Source code for all software developed within the scope of this offering remains the property of CSI. Licensing terms are available upon request.
- j. When Integrating hardware and/or software with the client's existing network; demarcations will be established to identify clear points of responsibility. If an issue would arise that impacts system design and/or functionality, additional IT engineering will be charged at the current IT service rate.
- k. Data backup is the sole responsibility of the customer. CSI is not held responsible for any loss of data.
- l. Project schedule changes and delays outside of the control of CSI will be accommodated whenever possible. Costs incurred by CSI because of delays outside of CSI's control will be considered outside of scope and may be considered billable.
- m. The cost of any permits required by Authorities Having Jurisdiction, (AHJ), will be borne by the owner.
- n. These terms cannot be altered by verbal or implied communication. All variances from these terms must be requested in writing.
- o. This proposal was prepared in good faith, exclusively for the individual(s) to whom it is addressed. It contains information that is privileged, confidential and exempt from disclosure under applicable law.
- p. Any changes to the Scope of Work (SOW) requested by the Owner or AHJ will require the Client to submit a Change Order Request in writing.
- q. CSI best practice is to provide all of the equipment for a turn-key solution that supports predicable outcomes. Should the Owner prefer to provide equipment to be used in the proposed solution, CSI will not assume any liability or responsibility for the Owner furnished equipment's (OFE) reliability, operation or compatibility with CSI provided equipment and software. Project schedule changes and delays outside of the control of CSI due to the use of OFE will be accommodated whenever possible. Costs incurred by CSI to resolve any issues due to OFE compatibility will be considered outside of the scope and are billable.

## **16. INDEMNIFICATION**

To the fullest extent permitted by law, the owner shall indemnify and hold harmless the CSI, and agents and employees of any of them from and against claims, damages, losses and expenses, including but not limited to attorney's fees, arising out of or resulting from performance of the Work under this proposal, provided that any such claim, damage, loss or expense is attributable to bodily injury, sickness, disease or death, or to injury to or destruction of tangible property (other than the Work itself), but only to the extent caused by the negligent acts or omissions of CSI, anyone directly or indirectly employed by them or anyone for whose acts they may be liable, regardless of whether or not such claim, damage, loss or expense is caused in part by a party indemnified hereunder. Such obligation shall not be construed to negate, abridge, or otherwise reduce other rights or obligations of indemnity which would otherwise exist.

Allentown  
7248 Tilghman Street  
Suite 120  
Allentown, PA 18106  
1-800-582-6399  
www.integra1.net

ATTACHMENT VI.B.1

IntegraONE

Meraki Cameras

Quote # 017272 Version:1

December 19, 2018

Prepared for:  
East Stroudsburg Area School District

Prepared by:  
Ashley Miller



Hardware

Description		Price	Qty	Ext. Price
MV72-HW	Cisco Meraki Varifocal MV72 Outdoor HD Dome Camera With 256GB Storage - Network surveillance camera - dome - outdoor - vandal / weatherproof - color (Day&Night) - 4 MP - 1920 x 1080 - 1080p - vari-focal - wireless - Wi-Fi - GbE - H.264 - PoE	\$646.00	11	\$7,106.00
MA-MNT-MV-10	Cisco Meraki - Camera dome mounting arm - wall mountable	\$95.00	11	\$1,045.00
MV12W-HW	Cisco Meraki Wide Angle MV12 Mini Dome HD Camera - Network surveillance camera - dome - color (Day&Night) - 4 MP - 2688 x 1520 - 1080p - fixed focal - audio - Wi-Fi - GbE - H.264 - PoE	\$455.00	8	\$3,640.00
LIC-MV-10YR	Cisco Meraki Enterprise - Subscription license (10 years) + 10 Years Enterprise Support - 1 camera	\$684.00	19	\$12,996.00
<b>Subtotal:</b>				<b>\$24,787.00</b>

per COSTARS contract # HW 003-085

## Meraki Cameras

Prepared by:

**Allentown**

Ashley Miller  
484-223-3480 ext. 1115  
Fax 484-223-3427  
amiller@integra1.net

Prepared for:

**East Stroudsburg Area School District**

Accounts Payable  
East Stroudsburg, PA 18301  
Brian Borosh  
(570) 424-8060  
brian-borosh@esasd.net

Quote Information:

**Quote #: 017272**

Version: 1  
Delivery Date: 12/19/2018  
Expiration Date: 01/18/2019

### Quote Summary

Description	Amount
Hardware	\$24,787.00
<b>Total:</b>	<b>\$24,787.00</b>

Pricing subject to change without advanced notice from the manufacturer. Leasing rates are subject to final configuration, pricing, and credit approval.

Restock fees will apply for any items returned. Returns must be made within 21 days of receipt of items unopened. Shipping fees not included. The information provided to you in this communication is regarded by integraONE to be Confidential and Proprietary Information. This includes the description of the materials/products for sale, the prices quoted, and any description of consulting services to be performed by integraONE. This information shall not be disclosed or made available to any party unrelated to this agreement without our express written consent. You must also exercise reasonable care to protect this information from the unauthorized disclosure by others.

**Ship to Address:**

**Additional Information:**

**Allentown**

**East Stroudsburg Area School District**

Signature: \_\_\_\_\_

Signature: \_\_\_\_\_

Name: Ashley Miller

Name: Brian Borosh

Title: Account Manager

Date: \_\_\_\_\_

Date: 12/19/2018

ATTACHMENT VI, C. 1

THIRD DIMENSION SPECIALTIES

856 CAPOUSE AVENUE  
 SCRANTON, PA 18509  
 P.570-969-0623/F.570-347-6225

Estimate

Date	Estimate #
12/19/2018	3760

Name / Address
EAST STROUDSBURG AREA SCHOOL DIST. 50 VINE ST. EAST STROUDSBURG, PA. 18301 ATT. CURTIS BEAM

Description	Qty	Cost	Project
			Total
PROJECT: HS STADIUM REVISED ACCESSORIES 1 LOT OF SCRANTON PRODUCTS SOLID PLASTIC TOILET PARTITIONS 10 - STALLS, DELIVERED SANTANA SOLID PLASTIC TOILET PARTITIONS FLOOR MOUNTED OVERHEAD BRACED ALUM CONTINUOUS WALL BRACKET STAINLESS STEEL SHOES (3" HIGH) 8" ALUM HINGES ALUMINUM HEATSINC STANDARD MATERIALS AND HARDWARE THROUGHOUT PRICES VALID FOR ALL SANTANA COLORS 55" HIGH DOORS AND PANELS	10	534.43	5,344.30
		0.00	0.00
10 - AJ U840 TOILET PAPER DISPENSERS, 6 - AJ U590 NAPKIN DISPENSER, DELIVERED	16	46.13	738.08
NOTE: ADD FOR INSTALLATION \$1740.00 PRICE DOES NOT INCLUDE TEAROUT PRICE IS FOR ONE SHIPMENT ONLY PRICE SHOWN HAS NO SALES TAX 25 YR STANDARD WARRANTY		0.00	0.00
ALL PRICE ARE PER THE KEYSTONE PURCHASING CONTRACT #201105-10			
THANK YOU FOR THE OPPORTUNITY TO QUOTE ON YOUR PROJECT		<b>Subtotal</b>	\$6,082.38
		<b>Sales Tax (6.0%)</b>	\$0.00
		<b>Total</b>	\$6,082.38

# EAST STROUDSBURG AREA SCHOOL DISTRICT

Middle Smithfield Township  
Monroe County, Pennsylvania

AS BUILT DRAWINGS

WATER SUPPLY SYSTEM  
Contract No. 2 - General Construction  
Contract No. 3 - Elevated Water Storage Tank

VII. A. 1.

PREPARED FOR:  
East Stroudsburg Area School District  
North Courtland Street, P.O. Box 298  
East Stroudsburg, PA 18301

PREPARED BY:  
F. X. Browne, Inc.  
220 South Broad Street  
Lansdale, PA 19446



*F. X. Browne*

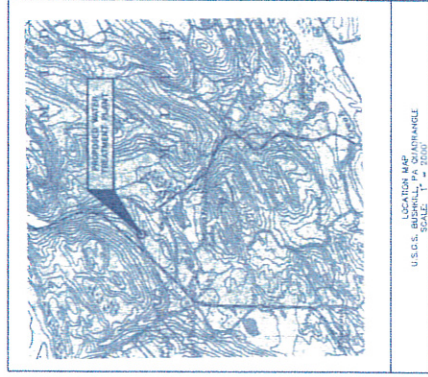



## INDEX

Sheet No.	Title
1.	General Plan
2.	Site Plan and Details
3.	Erosion and Sediment Control Plan - Detail and Notes
4.	Water Treatment Facility - Plan, Section and Details
5.	Elevated Water Storage Tank - Elevation and Details
6.	Electrical

CALL BEFORE YOU DIG!  
 1-800-4-A-DIG  
 1-800-426-4842  
 1-800-243-1774

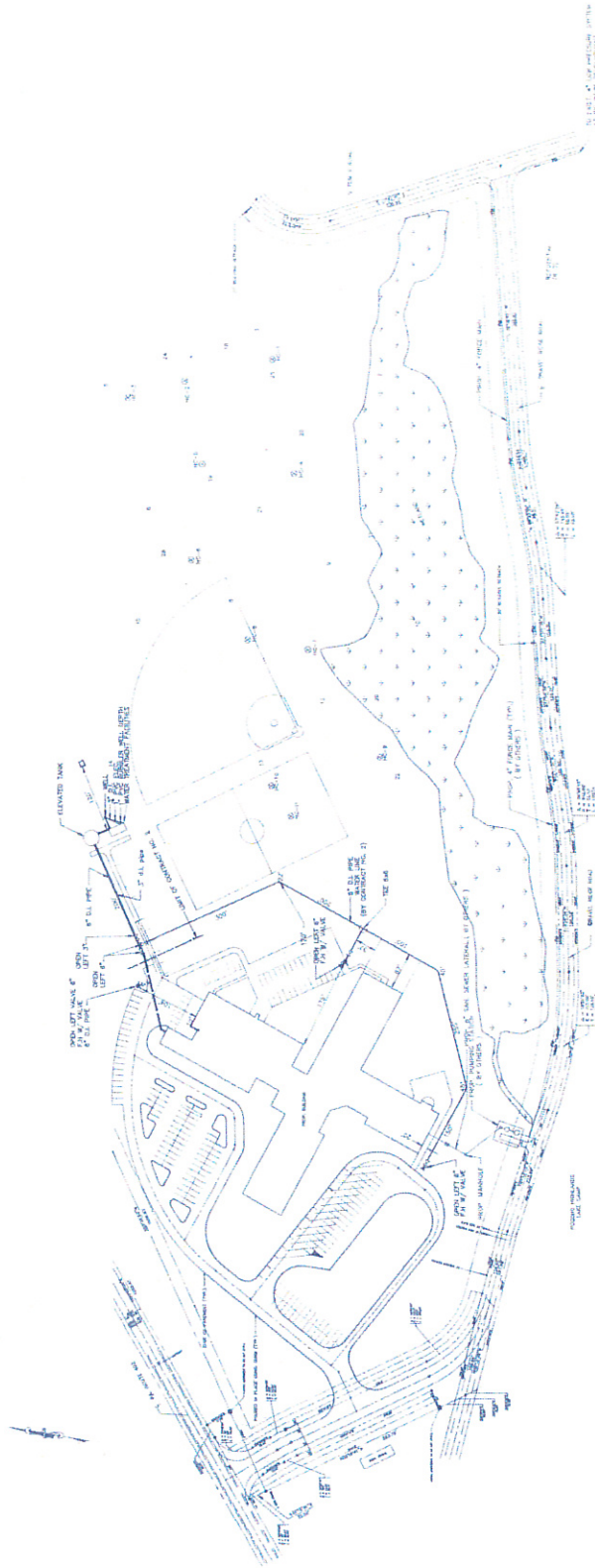
Water supply and distribution systems are critical to the health and safety of the community. The design and construction of these systems must be done in accordance with the Pennsylvania Department of Environmental Protection (PA DEP) regulations and standards. The design and construction of these systems must be done in accordance with the Pennsylvania Department of Environmental Protection (PA DEP) regulations and standards.



 <b>F. X. BROWNE, INC.</b> ENGINEERS • PLANNERS • SCIENTISTS LANCASTER, PA    MARSHALLS CREEK, PA    BURLINGTON, NJ		DESIGNED BY: JTS CHECKED BY: JTS DRAWN BY: MEN CREATED BY: MEN DATE: 1-25-83		<b>F. X. BROWNE</b> PROFESSIONAL ENGINEER PENNSYLVANIA LICENSE NO. 20717-E DATE:	<b>EAST STROUDSBURG AREA SCHOOL DISTRICT</b> MIDDLE SMITHFIELD TOWNSHIP WATER SUPPLY SYSTEM GENERAL PLAN	SCALE: 1" = 100' PROJECT NO. 1192-05 DRAWING NO. 100 SHEET NO. 1 CAD NAME: 1192BSP
--	--	--	---	---	---	--

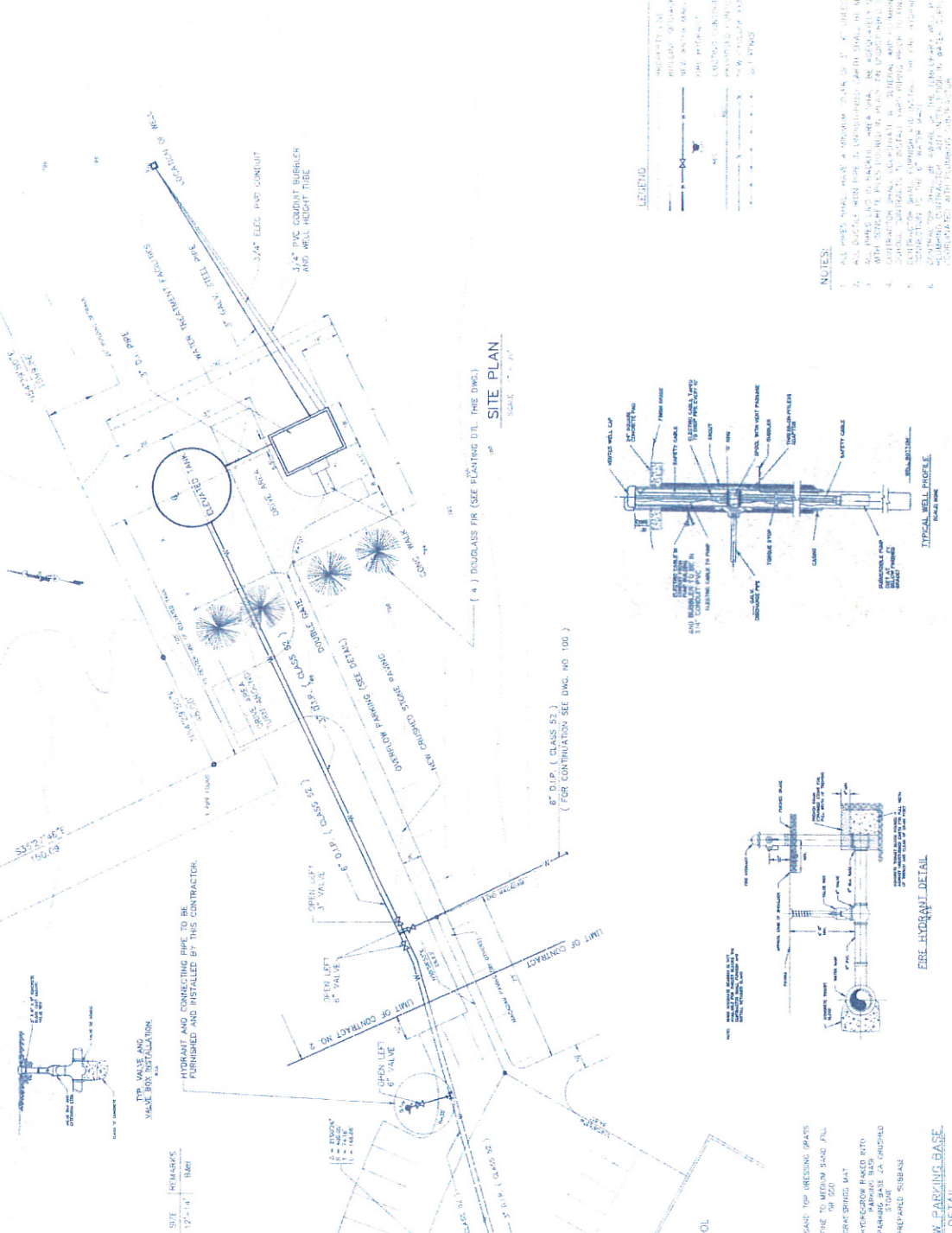

EAST STROUDSBURG AREA SCHOOL DISTRICT MOORE TOWNSHIP MOORE COUNTY, PA		SCALE AS NOTED PROJECT NO. PA 1192-02 DRAWING NO. 201 SHEET NO. 2 DATE MADE 11/20/05
WATER SUPPLY SYSTEM SITE PLAN AND DETAILS		DESIGNED BY: BTS CHECKED BY: MSN DRAWN BY: MSN DATE: 1-25-03
		F. X. BROWNE PROFESSIONAL ENGINEER PENNSYLVANIA LICENSE NO. 20717-E DATE:
F. X. BROWNE, INC. ENGINEERS • PLANNERS • SCIENTISTS MARSHALLS CREEK, PA • BURLINGTON, NJ		NO. DATE TIME REVISIONS

TYP. VALVE AND VALVE BOX INSTALLATION  
 HYDRANT AND CONNECTING PIPE TO BE FURNISHED AND INSTALLED BY THIS CONTRACTOR.

6" D.I.P. (CLASS 52)  
 (FOR CONTINUATION SEE DWG. NO. 100)

3/4" ELEC. PAD CONDUIT  
 2" PVC DENSITY FIBER OPTIC WELL RISER AND WELL HEAD RISE

LEGEND:  
 PROPERTY LINE  
 POLLUTION SOURCE  
 EXISTING CURB  
 EXISTING DRIVEWAY  
 EXISTING SIDEWALK  
 EXISTING DRIVEWAY  
 EXISTING SIDEWALK  
 EXISTING DRIVEWAY  
 EXISTING SIDEWALK

NOTES:  
 1. ALL PIPES SHALL HAVE A MINIMUM COVER OF 24" UNLESS OTHERWISE SPECIFIED.  
 2. ALL DUCTS SHALL HAVE A MINIMUM COVER OF 24" UNLESS OTHERWISE SPECIFIED.  
 3. ALL PIPES SHALL BE INSTALLED WITH A MINIMUM SLOPE OF 1/8" PER FOOT.  
 4. ALL PIPES SHALL BE INSTALLED WITH A MINIMUM SLOPE OF 1/8" PER FOOT.  
 5. ALL PIPES SHALL BE INSTALLED WITH A MINIMUM SLOPE OF 1/8" PER FOOT.  
 6. ALL PIPES SHALL BE INSTALLED WITH A MINIMUM SLOPE OF 1/8" PER FOOT.

TYPICAL WELL PROFILE  
 SCALE: 1/4" = 1'-0"

FIRE HYDRANT DETAIL  
 SCALE: 1/4" = 1'-0"

OVERHEAD PARKING BASE  
 DETAILS  
 SCALE: 1/4" = 1'-0"



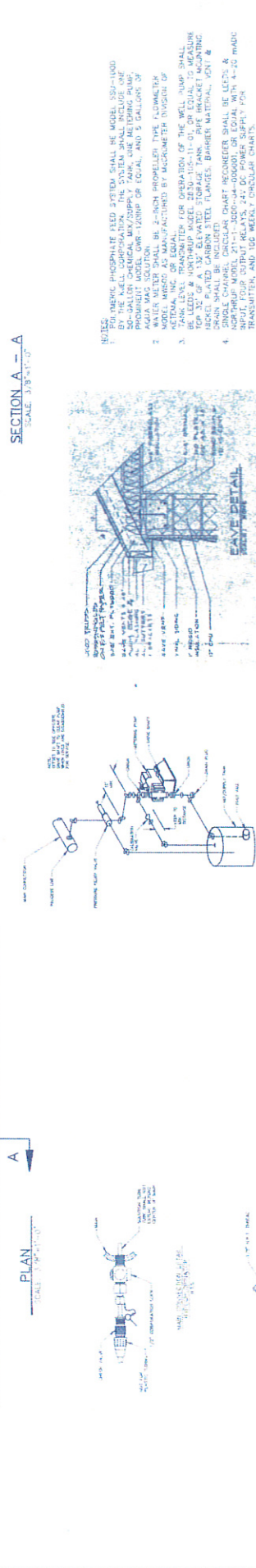
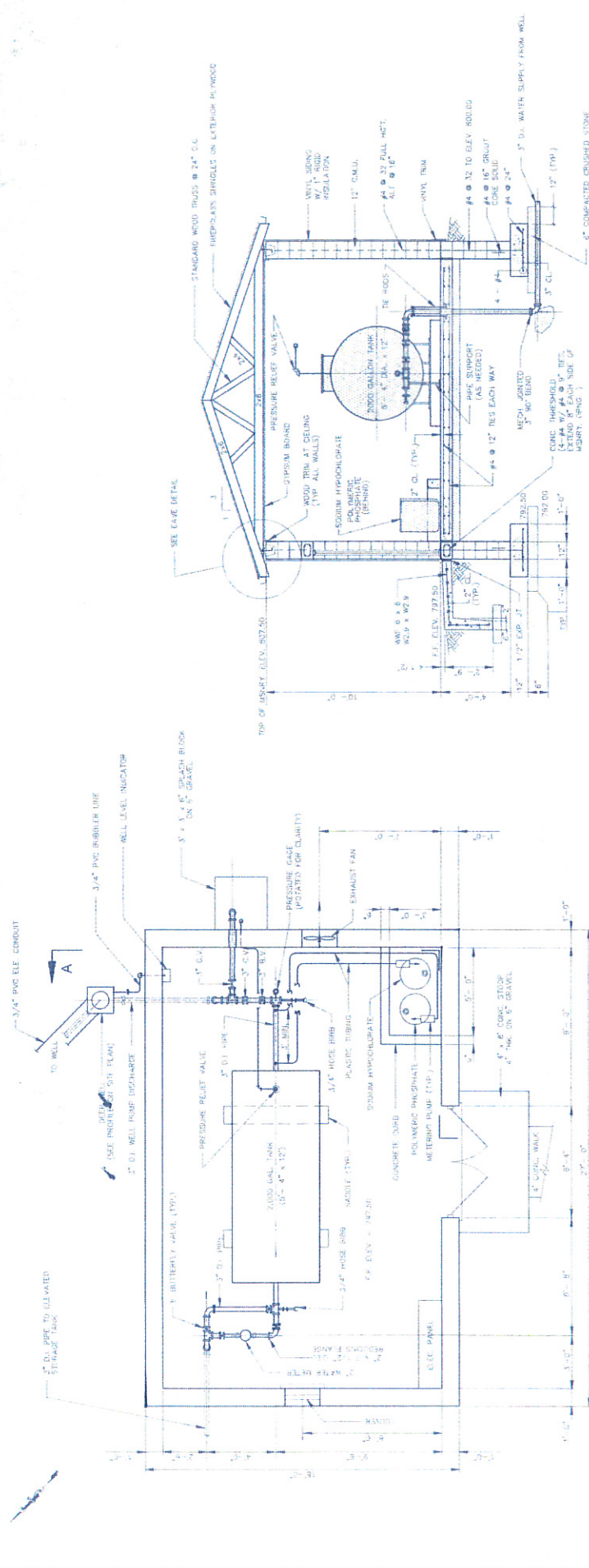

**NOTES:**

- FOR MERCURY PHOSPHATE FEED SYSTEM SHALL BE MODEL 552-1000 BY THE WELLS CORPORATION. THE SYSTEM SHALL INCLUDE ONE PROHIBIT MODEL ONE-120HP OR EQUAL, AND 5 GALLONS OF AQUA MATE SOLUTION.
- MODEL M8000 AS MANUFACTURED BY MCGRAW-HILL DIVISION OF WESTINGHOUSE.
- BE LEADS & WORTHUP MODEL 2030-105-11-01, OR EQUAL, TO MEASURE THE FLOW OF THE ELEVATED STORAGE TANK. THE METERING CRAN SHALL BE INCLUDED.
- WELLS CORPORATION SHALL PROVIDE THE NECESSARY ELECTRICAL CHART, FOUR SUPPLY RELAYS, 24 DC POWER SUPPLY FOR TRANSMITTER, AND THE WEEKLY CIRCULAR CHARTS.

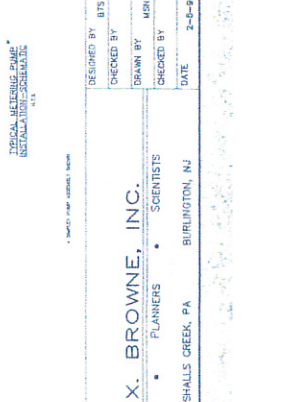

<b>EAST STROUDSBURG AREA SCHOOL DISTRICT</b> MOORE, SHIPLEY, TOWNSHIP HUNTERDOWNS, PA.		SCALE: AS NOTED PROJECT NO.: PA-1192-05 DRAWING NO.: 203
<b>WATER SUPPLY SYSTEM</b> WATER TREATMENT FACILITY PUMP AND SECTION		SHEET NO. 4 GRID MARK 1/4"=1'-0"
<b>F. X. BROWNE</b> PROFESSIONAL ENGINEER PENNSYLVANIA LICENSE NO. 20717-E DATE:		
DESIGNED BY: BTB CHECKED BY: MSH DRAWN BY: MSH CHECKED BY: MSH DATE: 2-6-93	<b>F. X. BROWNE, INC.</b> ENGINEERS • PLANNERS • SCIENTISTS MARSHALLS CREEK, PA.    BIRMLINGTON, NJ	
NO. _____ REVISIONS _____ DATE _____ ENGR. _____	<b>FXB</b> LANDDALE, PA.	



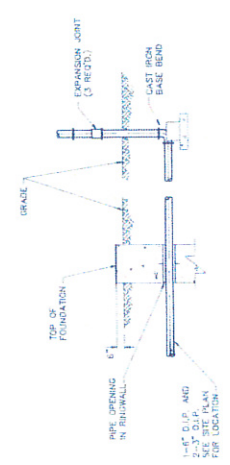
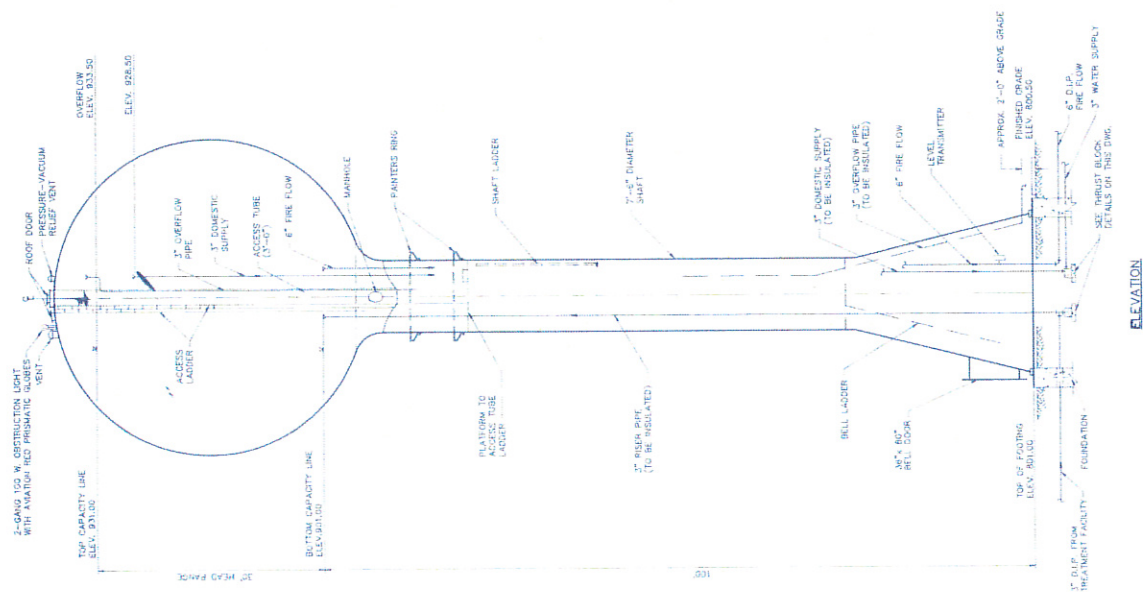

**GENERAL NOTES**

1. CHARACTER OF SUPPORT BELL AND DIMENSIONS OF FOUNDATION SHALL BE DETERMINED BY THE TANK CONTRACTOR BASED UPON THE SOIL BEARING SPECIFIED AND THE RECOMMENDATIONS IN THE SOIL REPORT.
2. WHEN LADDER HEIGHT REQUIRES A LADDER SAFETY DEVICE MEETING OSHA STANDARDS SHALL BE PROVIDED.
3. OPENING IN ORIGINAL SHALL HAVE INSIDE DIMENSIONS FOR FINISHED PIPE DO NOT GREAT OR CALIBER AROUND PIPE.
4. SEE SPECIFICATIONS FOR OPTIONAL AND ALTERNATE ITEMS.

**BURIED THRUST BLOCK DETAIL**  
N.T.S.

NO.	REVISIONS	DATE	ENR	LANSDALE, PA		MARSHALLS CREEK, PA		BURLINGTON, NJ		DESIGNED BY K.M.S.	DRAWN BY K.M.S.	CHECKED BY K.M.S.	DATE 2-4-83		<b>F. X. BROWNE</b> PROFESSIONAL ENGINEER PENNSYLVANIA LICENSE NO. 20717-E DATE:	<b>EAST STROUDSBURG AREA SCHOOL DISTRICT</b> MIDDLE STROUDSBURG TWP. MONROE COUNTY, PA.	SCALE PROJECT NO. 193-05 DRAWING NO. SHEET NO. 5 CAD NAME 193002
				<b>F. X. BROWNE, INC.</b> ENGINEERS • PLANNERS • SCIENTISTS			<b>WATER SUPPLY SYSTEM</b> ELEVATED WATER STORAGE TANK ELEVATION AND DETAILS										

- CONCRETE FINISHING NOTES**
1. ALL NECESSARY WIRE, FITTINGS, CONDUIT BETWEEN ALL WALLS TO BE INSTALLED AT END OF WALL.
  2. WALLS, ARCHWAYS, ANGLES, CORNERS TO BE FINISHED WITH 1/2" GYP BOARD.
  3. TRANSFORMER PANEL TO BE INSTALLED AT END OF WALL.
  4. TRANSFORMER PANEL TO BE INSTALLED AT END OF WALL.
  5. TRANSFORMER PANEL TO BE INSTALLED AT END OF WALL.

- GENERAL NOTES**
1. ALL NECESSARY WIRE, FITTINGS, CONDUIT BETWEEN ALL WALLS TO BE INSTALLED AT END OF WALL.
  2. WALLS, ARCHWAYS, ANGLES, CORNERS TO BE FINISHED WITH 1/2" GYP BOARD.
  3. TRANSFORMER PANEL TO BE INSTALLED AT END OF WALL.
  4. TRANSFORMER PANEL TO BE INSTALLED AT END OF WALL.
  5. TRANSFORMER PANEL TO BE INSTALLED AT END OF WALL.

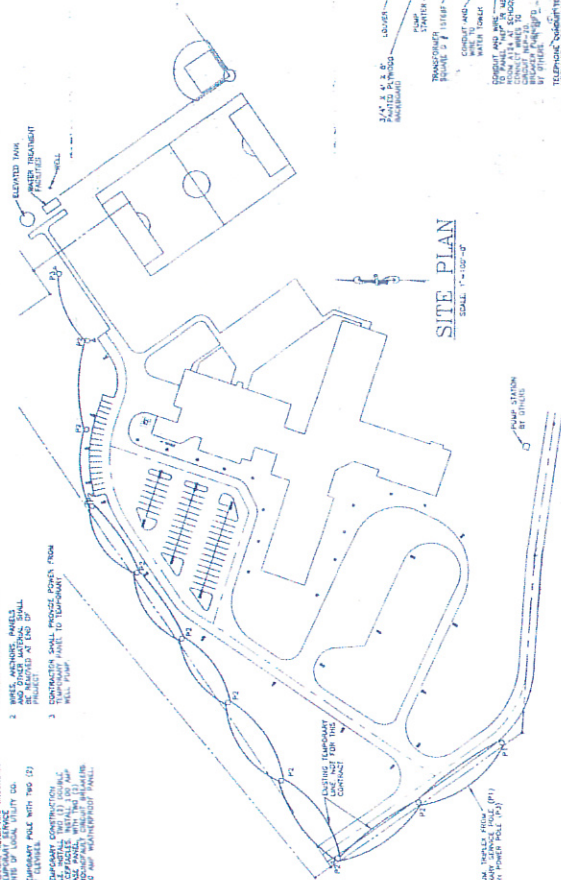

**SITE PLAN**  
SCALE 1/4" = 10'-0"

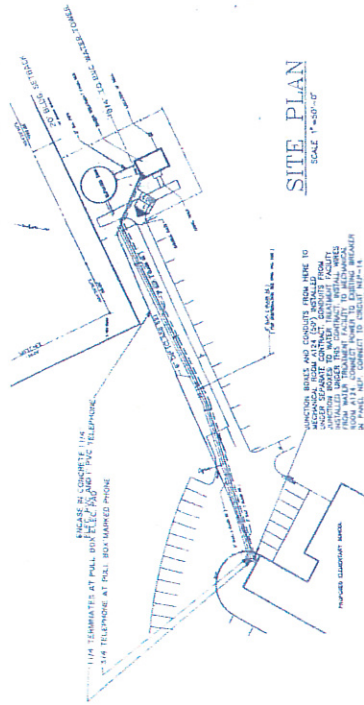

**SITE PLAN**  
SCALE 1/4" = 10'-0"

- SYMBOL LIST**
- 1 SINGLE POLE SWITCH
  - 0 DOUBLE POLE SWITCH
  - WATERPROOF
  - ANCHOR BOLT
  - TRANSFORMER
  - INDUSTRIAL
  - PANEL

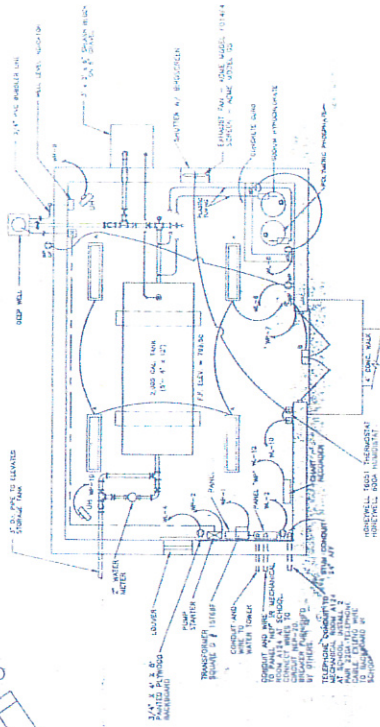

**ELECTRICAL PLAN**  
SCALE 1/4" = 10'-0"

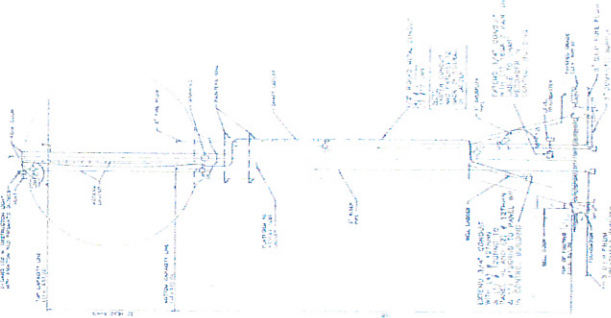

**ELEVATION**  
SCALE 1/4" = 10'-0"

**PANEL SCHEDULE**

NO.	DESCRIPTION	AMPS	VOLTS	PHASES	WIRING
1	MAIN SERVICE	100	240	3	W
2	TRANSFORMER	100	240	3	W
3	CONTROL	10	240	3	W
4	...	...	...	...	...

**PULL IN PER PLAN**

NO.	DESCRIPTION	AMPS	VOLTS	PHASES	WIRING
1	...	...	...	...	...
2	...	...	...	...	...
3	...	...	...	...	...

**LIGHTING FIXTURE SCHEDULE**

NO.	DESCRIPTION	AMPS	VOLTS	PHASES	WIRING
1	...	...	...	...	...
2	...	...	...	...	...

**STRUNK-ALBERT ENGINEERING**  
MECHANICAL-ELECTRICAL-PLUMBING ENGINEERS  
117-42-1-2025  
117-42-1-2025

**EAST STROUDSBURG AREA SCHOOL DISTRICT**  
VIOLETT CAMPBELL, PRINCIPAL  
117-42-1-2025

**F. X. BROWNE**  
PROFESSIONAL ENGINEER  
PENNSYLVANIA LICENSE NO. 20717-E  
DATE: 11-25-93

**DESIGNED BY** RGA  
**CHECKED BY** DBS  
**DRAWN BY** BAG  
**DATE** 11-25-93

**F. X. BROWNE, INC.**  
ENGINEERS • PLANNERS • SCIENTISTS  
LANSDALE, PA MARSHALLS CREEK, PA BURLINGTON, NJ

NO.	REVISIONS	DATE	ENR

# WELL DRILLING PERMIT APPLICATION

TAX ASSESSMENT NUMBER 09732400829799/9/10/11/86-1

PERMIT NUMBER 92

APPLICATION IS HEREBY MADE FOR A WELL DRILLING PERMIT IN ACCORDANCE WITH "ORDINANCE NO. "FIFTY FIVE" OF MIDDLE SMITHFIELD TOWNSHIP, AS AMENDED

TYPE OF WELL PROPOSED: \_\_\_\_\_ INDIVIDUAL ON-SITE  COMMUNITY SUPPLY \_\_\_\_\_ CENTRAL SUPPLY

WELL LOCATION Rt 402/GRAVEL RIDGE SCHOOL SITE

TYPE OF SEWAGE DISPOSAL:  CENTRAL \_\_\_\_\_ ON-SITE (copy of approved permit application required)

### NOTES:

The well must be located a minimum distance of one-hundred (100) feet from any existing or proposed subsurface sewage disposal system.

An accurately scaled and dimensioned site plan of the property showing all proposed and existing wells and subsurface sewage disposal systems on the subject property and/or within one-hundred (100) feet of the said property boundaries.

### CONDITIONS OF APPROVAL:

The driller must submit, upon completion of the well, a drill log of the said well to the Township.

All plans, information and data submitted supporting this application shall become a part of the records of Middle Smithfield Township and cannot be returned except as the ordinance provides.

This permit will become null and void if drilling is not commenced within twelve (12) months of the date of issuance and does not release the driller and/or the landowner from the responsibility of obtaining any and all additional permits as may be required by other applicable ordinances and/or regulations of any local, state or federal agencies.

By accepting this permit the Applicant does accept all of the above conditions and agrees to fully comply therewith and further agrees that failure to comply with the said conditions will result in an immediate and complete nullification and voidance of the said permit as issued with no further action by Middle Smithfield Township or any official thereof.

Date \_\_\_\_\_

E. Stroudsburg Area School District  
By: [Signature]  
(signature of landowner or authorized representative)

NAME OF LANDOWNER EAST STROUDSBURG AREA SCHOOL DISTRICT TELEPHONE 424-8500

ADDRESS P.O. Box 298, East Stroudsburg, Pa 18301

NAME OF DRILLER KNIGHT WELL DRILLING, INC. TELEPHONE 842-8192

ADDRESS P.O. Box 642, Gouldsboro, PA 18424

(below this line for Township use only)

DATE OF SUBMITTAL 12/22/92

SPECIAL CONDITIONS

WELL DRILLING PERMIT  GRANTED \_\_\_\_\_ DENIED

DATE OF ISSUANCE 12/22/92

FEE 15.00 Check No. 1901

Temp Fee WAIVED 10.00

[Signature]  
(PERMIT OFFICER)

# JACUZZI®

E-1467

## 4" and 6" SandHandler Submersible Pumps Owner's Manual

### INSPECT THE EQUIPMENT

Examine the pump when it is received to be sure there has been no damage in shipping. Should any be evident, report it immediately to the Jacuzzi dealer from whom the pump was purchased. Please check the pump package to see that it includes pump, motor, and motor leads (if your pump purchase includes a motor). Bronze units will include a discharge check valve. Thermoplastic units have a poppet built into the discharge head, so a check valve is not necessary at the pump. Cast iron units do not include a check valve. Three-wire, single-phase pumps should include a control box which has to be purchased separately and matched to the pump motor. Example: Franklin Control Box for Franklin motors. Make certain that your available voltage corresponds to that of your motor.

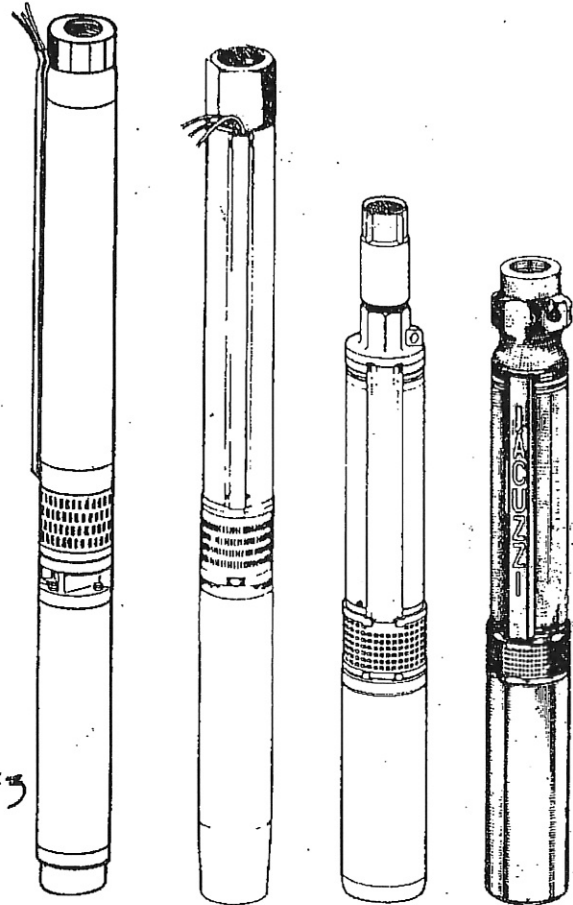

### INSTALLATION RECORD

It is a good idea to keep an accurate record of your installation. Be sure to record the data below:

Purchased from \_\_\_\_\_

Date of Installation 7-15

Pump Model No.\* BS418-8

Pump Date Code\* 9255-2710 6-4-93

Well Inside Dia. (in/mm) 8"

Depth of Well (ft/m) \_\_\_\_\_

Depth of Water (ft/m) \_\_\_\_\_

Pump Setting (ft/m) 290'

Drop Pipe Size \_\_\_\_\_

Wire Size (From pump to control box) \_\_\_\_\_

Wire Size (Control box to power source) \_\_\_\_\_

Horizontal Offset (Between well and houaw) \_\_\_\_\_

\*Make of Motor - Amps 10 HP 2 Volts 230 Ph 1

Make of Control Box - HP \_\_\_\_\_ Volts \_\_\_\_\_

Power Supply - Volts \_\_\_\_\_ Ph \_\_\_\_\_ HZ \_\_\_\_\_

Pressure Switch (PSI) Cutin \_\_\_\_\_ Cutout \_\_\_\_\_

\*This information is on your pump or motor tag. It will help us identify your pump in case of later inquiries.