

Vicki Everitt

From: Sharon Hendershot <sharonatpast@gmail.com>
Sent: Friday, December 04, 2015 9:25 PM
To: Vicki Everitt
Subject: Winding Brook Charter School
Attachments: CopyofBusinessFormalLetterTemplate.odt

Winding Brook Waldorf-Methods Charter School
PO Box 334
Sciota, PA 18354

December , 2015

Dear Members of the East Stroudsburg School Board,

In moving forward with the process of obtaining a charter for Winding Brook Charter School, we have identified a suitable location that meets our needs. The location, Fernwood Resort, located on Rt 209 in Bushkill, formerly operated as a hotel and conference center. In the main building, there are 65,000 square feet of space usable for classroom and school activity space. Currently, there are 10 spaces equalling approximately 15,000 square feet already set with desks, overhead projectors and white boards.

Our board has toured the property in its entirety, and has a final meeting with the Bushkill Group to discuss our lease purchase on Monday, December 7, 2015. We firmly believe we will be able to finalize the financial terms and be able to prepare the space, which already lends itself to our purposes as it stands, in order to welcome our first students for the 2016-2017 school year.

I thank you in advance for your consideration and look forward to working with the school district to bring forth this valuable partnership.

Sincerely,

Sharon Hendershot
Founding Member
Winding Brook Waldorf-Methods Charter School

Vicki Everitt

From: Sharon Hendershot <sharonatpast@gmail.com>
Sent: Friday, December 04, 2015 9:31 PM
To: Vicki Everitt
Subject: Winding Brook Charter School
Attachments: HARA topo MCPC July 2015.pdf; hotel meeting space floor plan.pdf; plot plan June 2015 Rt 209 Property.pdf

Below is the attached property information that I would like to add

Thank you
Sharon Hendershot



WBCS 000506

Floorplans & Capacities

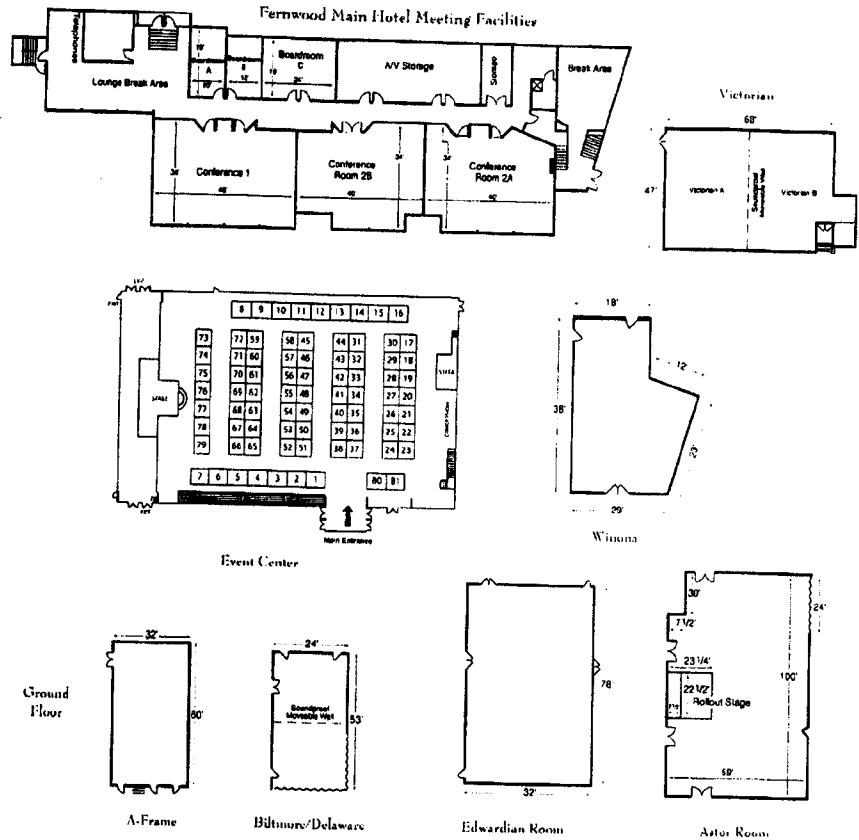

Room Name	Area (sq ft)	Width (ft)	Depth (ft)	Capacity (Theater)	Capacity (Classroom)	Capacity (U-shape)	
Boardroom A	190	8'	20'	N/A	N/A	10	
Boardroom B	216	8'	20'	N/A	N/A	10	
Boardroom C	432	8'	30'	N/A	N/A	20	
Conference 1	1,632	12'	135'			65	
Conference 2	2,720	12'	227'			72	
Conference 2A	1,360	12'	113'			36	
Conference 2B	1,360	12'	113'			36	
Victorian	3,175	10'	317'			180	
Victorian A	1,582	10'	158'			90	
Victorian B	1,582	10'	158'			90	
Event Center	18,000	40'	450'	1800	800	2,200	800
Winona	906	10'	90'	50	40	60	35
A-Frame	2,000	36'	55'	175	150	200	100
Biltmore Room	1,300	10'	130'	125	80	150	60
Delaware	552	10'	55'	50	30	40	30
Edwardian Room	4,175	8'6"	491'	250	200	275	180
Edwardian A	2,612	8'6"	305'	150	100	175	75
Edwardian B	687	8'6"	80'	35	30	N/A	25
Edwardian C	687	8'6"	80'	35	30	N/A	25
Astor Room	7,750	25'	310'	900	550	1,000	400

**Dedicated
Conference
Space**



Drawing not to scale.

TOTAL COMBINED AGREAGE
Approx. 44.173 Acres
(All three parcels)

