

Dispatch Order #: _____

Please Check One:
 Regular Day Trip
 Extended Day Trip
 Overnight Trip

REC
 JAN 03 2012

EAST STROUDSBURG AREA SCHOOL DISTRICT

FIELD TRIP REQUEST FORM

The top section of this form is to be completed by the staff member seeking permission to make the trip. It should be submitted to the building principal for approval at least thirty (30) days prior to the desired day trip date or sixty (60) days prior to an overnight trip. Buses and trips will be approved on a first-come, first-served basis. All field trips made during regular school days should be scheduled between 8:30 A.M. and 1:45 P.M. Drivers will be assigned by the Transportation Office. Do not request specific drivers.

SCHOOL South High School GROUP FBLA REQUESTOR Palmour, Amy
 DESTINATION Hershey PA - ABC GRADE(S)/LEVEL(S) 9-12
 DIRECTIONS TO DESTINATION OBTAINED (Please check) YES NO
 DATE 4/15 - 4/18 PLACE OF DEPARTURE (Be Specific) front of high school
 NUMBER OF STUDENTS MAKING TRIP 45 NUMBER OF SCHOOL BUSES NEEDED 2
 BUS ARRIVAL TIME (For pre-departure preparation) 10:30 a.m. - 4/15
 BUS DEPARTURE TIME (After all pre-trip preparation is complete) 10:45 a.m. - 11:00 a.m. - 4/15
 RETURN TIME (When bus(es) arrive back at school for other duties) pickup time @ hotel - 10:30 - 4/18
 PURPOSE OF TRIP (Include relationship to present curriculum area being covered) State Leadership Conference - Competition

NUMBER OF CHAPERONES REQUIRED (See Board Policy No. 121) _____ *
 * List must be submitted to the building principal at least two (2) weeks prior to the date of the trip.
 PROJECTED COST OF TRIP:
 # of Substitutes 4 X # of Days 3 = \$ 960 - covered by district
 Transportation Costs (as is applicable) \$1300 ← covered by district
 Admission/Registration Fees \$ ← covered by district
 Miscellaneous (Please list) \$375 ← covered by student
 Grand Total \$ _____ @ club

PROCEDURAL PLAN/RAIN DATE IN CASE OF POSTPONEMENT/CANCELLATION: _____

SIGNATURE -- Staff Member Making Request [Signature] DATE _____
 SIGNATURE/APPROVAL -- Building Principal [Signature] DATE 12/21/11
 SIGNATURE/APPROVAL -- Director of Athletics and Activities* _____ DATE _____
 * As is applicable

BUS AVAILABILITY -- Transportation Office _____ DATE _____
 SIGNATURE -- Asst. Supt./Curriculum & Instruction [Signature] DATE 1/3/12
 SIGNATURE -- Superintendent [Signature] DATE 1-4-12

Please Check One:
 Regular Day Trip
 Extended Day Trip
 Overnight Trip

Board

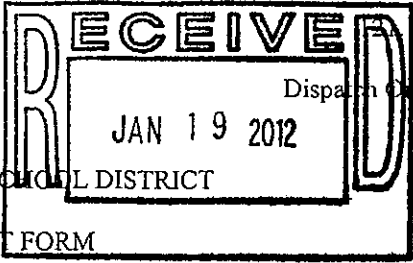

ATTACHMENT A

EAST STROUDSBURG AREA SCHOOL DISTRICT
 FIELD TRIP REQUEST FORM

The top section of this form is to be completed by the staff member seeking permission to make the trip. It should be submitted to the building principal for approval at least thirty (30) days prior to the desired day trip date or sixty (60) days prior to an overnight trip. Buses and trips will be approved on a first-come, first-served basis. All field trips made during regular school days should be scheduled between 8:30 A.M. and 1:45 P.M. Drivers will be assigned by the Transportation Office. Do not request specific drivers.

SCHOOL High School South GROUP Key Club REQUESTOR SANKER
 DESTINATION Key Club Convention - State College GRADE(S)/LEVEL(S) 9-12
 DIRECTIONS TO DESTINATION OBTAINED (Please check) YES NO
 DATE 3/16/2012 - 3/18/2012 PLACE OF DEPARTURE (Be Specific) H.S. South Main Lobby
 NUMBER OF STUDENTS MAKING TRIP up to 20 NUMBER OF SCHOOL BUSES NEEDED 1
 BUS ARRIVAL TIME (For pre-departure preparation) 8:00 AM

BUS DEPARTURE TIME (After all pre-trip preparation is complete) 8:15 - 8:30 AM
 RETURN TIME (When bus(es) arrive back at school for other duties) 4 - 4:30 PM

PURPOSE OF TRIP (Include relationship to present curriculum area being covered) CHARACTER & LEADERSHIP
EDUCATION; CLUB COMPETITIONS IN VIDEO, SCRAPBOOK, POSTER, SINGLE SERVICE, CLUB
EXCELLENCE, ETC.; ELECT DISTRICT LEADERSHIP; LEARN MORE ABOUT K.C. & SERVICE

NUMBER OF CHAPERONES REQUIRED (See Board Policy No. 121) 2 *
 * List must be submitted to the building principal at least two (2) weeks prior to the date of the trip.

PROJECTED COST OF TRIP:
 # of Substitutes 1 X # of Days 1 = \$ 80
 Transportation Costs (as is applicable) \$ 650
 Admission/Registration Fees \$ 235/student - PAID BY student club & KIMANU
 Miscellaneous (Please list) lunch on \$ -
students \$ -
 Grand Total \$ 730 + district

PROCEDURAL PLAN/RAIN DATE IN CASE OF POSTPONEMENT/CANCELLATION: None

SIGNATURE -- Staff Member Making Request Donald R. Sanker DATE 1/13/2012
 SIGNATURE/APPROVAL -- Building Principal [Signature] DATE 1/13/12
 SIGNATURE/APPROVAL -- Director of Athletics and Activities* _____ DATE _____
 * As is applicable
 BUS AVAILABILITY -- Transportation Office _____ DATE _____
 SIGNATURE -- Asst. Supt./Curriculum & Instruction [Signature] DATE 1/19/12
 SIGNATURE -- Superintendent _____ DATE _____

Please Check One:
 Regular Day Trip
 Extended Day Trip
 Overnight Trip

✓ **RECEIVED**
JAN 18 2012

121. ATTACHMENT A

Dispatch Order #:
RECEIVED
JAN 13 2012

01-11-12 P05:59 PCW BY: _____
 EAST STROUDSBURG AREA SCHOOL DISTRICT

FIELD TRIP REQUEST FORM

BY: _____

The top section of this form is to be completed by the staff member seeking permission to make the trip. It should be submitted to the building principal for approval at least thirty (30) days prior to the desired day trip date or sixty (60) days prior to an overnight trip. Buses and trips will be approved on a first-come, first-served basis. All field trips made during regular school days should be scheduled between 8:30 A.M. and 1:45 P.M. Drivers will be assigned by the Transportation Office. **Do not request specific drivers.**

SCHOOL Lehman Intermediate GROUP 6 Blue Team REQUESTOR Lisa Vitulli

DESTINATION PEEC GRADE(S)/LEVEL(S) 6 grade

DIRECTIONS TO DESTINATION OBTAINED (Please check) YES NO BLUE

DATE April 12-13 PLACE OF DEPARTURE (Be Specific) Lehman Intermediate Bus Area

NUMBER OF STUDENTS MAKING TRIP 95 NUMBER OF SCHOOL BUSES NEEDED 2

BUS ARRIVAL TIME (For pre-departure preparation) 8:25 am - April 12

BUS DEPARTURE TIME (After all pre-trip preparation is complete) 8:40 am - April 12

RETURN TIME (When bus(es) arrive back at school for other duties) 1:45 pm - April 13

PURPOSE OF TRIP (Include relationship to present curriculum area being covered) Students will use the six basic science process skills while learning about the natural world. They will also develop team building skills

NUMBER OF CHAPERONES REQUIRED (See Board Policy No. 121) 9 *

* List must be submitted to the building principal at least two (2) weeks prior to the date of the trip.

PROJECTED COST OF TRIP:
 # of Substitutes 1 X # of Days 2 = \$ 160⁰⁰
 Transportation Costs (as is applicable) \$ _____
 Admission/Registration Fees \$ 0 paid for by grant
 Miscellaneous (Please list) \$ _____
 Grand Total \$ _____

PROCEDURAL PLAN/RAIN DATE IN CASE OF POSTPONEMENT/CANCELLATION: _____

Rain or Shine

SIGNATURE -- Staff Member Making Request Lisa Vitulli DATE Jan 11, 2012

SIGNATURE/APPROVAL -- Building Principal [Signature] DATE 1/11/12

SIGNATURE/APPROVAL -- Director of Athletics and Activities* _____ DATE _____
 * As is applicable

BUS AVAILABILITY -- Transportation Office _____ DATE _____

SIGNATURE -- Asst. Supt./Curriculum & Instruction [Signature] DATE 1/19/12

SIGNATURE -- Superintendent _____ DATE _____

RECEIVED
JAN 18 2012

Please Check One:
 Regular Day Trip
 Extended Day Trip
 Overnight Trip

Board

To: Judy BY: ESS Transportation Dispatch Order #: _____

EAST STROUDSBURG AREA SCHOOL DISTRICT

1 of 6

Pop # - 420-2626 FIELD TRIP REQUEST FORM

The top section of this form is to be completed by the staff member seeking permission to make the trip. It should be submitted to the building principal for approval at least thirty (30) days prior to the desired day trip date or sixty (60) days prior to an overnight trip. Buses and trips will be approved on a first-come, first-served basis. All field trips made during regular school days should be scheduled between 8:30 A.M. and 1:45 P.M. Drivers will be assigned by the Transportation Office. Do not request specific drivers.

SCHOOL MCTI GROUP COSMETOLOGY REQUESTOR JUDY DELP
DERMAL INSTITUTE
DESTINATION 234 MALL RD STE 100 KING OF PRUSSIA PA GRADE(S)/LEVEL(S) ALL

DIRECTIONS TO DESTINATION OBTAINED (Please check) YES NO
WEDNESDAY

DATE MAY 16, 2012 PLACE OF DEPARTURE (Be Specific) MCTI

NUMBER OF STUDENTS MAKING TRIP 48 NUMBER OF SCHOOL BUSES NEEDED 1

BUS ARRIVAL TIME (For pre-departure preparation) 6:50 AM

BUS DEPARTURE TIME (After all pre-trip preparation is complete) 7:00 AM

RETURN TIME (When bus(es) arrive back at school for other duties) 7:30 PM

PURPOSE OF TRIP (Include relationship to present curriculum area being covered) STUDENT DAY @ DERMAL INST. VARIOUS CLASSES, SKILLS TRAINING, INTERACTIVE SKILLS + TREATMENTS.

NUMBER OF CHAPERONES REQUIRED (See Board Policy No. 121) 5 *

* List must be submitted to the building principal at least two (2) weeks prior to the date of the trip.

PROJECTED COST OF TRIP:	# of Substitutes _____ X # of Days _____ = \$ _____
	Transportation Costs (as is applicable) \$ <u>325.00</u>
	Admission/Registration Fees \$ _____
	Miscellaneous (Please list) _____ \$ _____
	Grand Total \$ <u>325.00</u>

Invoice MCTI

PROCEDURAL PLAN/RAIN DATE IN CASE OF POSTPONEMENT/CANCELLATION: _____

SIGNATURE -- Staff Member Making Request Judy Delp DATE 1/11/12

SIGNATURE/APPROVAL -- Building Principal [Signature] DATE 1/12/12

SIGNATURE/APPROVAL -- Director of Athletics and Activities* _____ DATE _____

* As is applicable

BUS AVAILABILITY -- Transportation Office _____ DATE _____

SIGNATURE -- Asst. Supt./Curriculum & Instruction [Signature] DATE 1/19/12

SIGNATURE -- Superintendent _____ DATE _____

Dispatch Order #: _____

Please Check One:
<input checked="" type="checkbox"/> Regular Day Trip
<input type="checkbox"/> Extended Day Trip
<input type="checkbox"/> Overnight Trip

EAST STROUDSBURG AREA SCHOOL DISTRICT

FIELD TRIP REQUEST FORM

The top section of this form is to be completed by the staff member seeking permission to make the trip. It should be submitted to the building principal for approval at least thirty (30) days prior to the desired day trip date or sixty (60) days prior to an overnight trip. Buses and trips will be approved on a first-come, first-served basis. All field trips made during regular school days should be scheduled between 8:30 A.M. and 1:45 P.M. Drivers will be assigned by the Transportation Office. Do not request specific drivers.

SCHOOL South HS GROUP UN Aspire South REQUESTOR Michael Healey

DESTINATION United Nations Headquarters, NYC GRADE(S)/LEVEL(S) 9-12

DIRECTIONS TO DESTINATION OBTAINED (Please check) YES NO

DATE 2-28 PLACE OF DEPARTURE (Be Specific) Front of South HS

NUMBER OF STUDENTS MAKING TRIP 13 + 5 chaperones NUMBER OF SCHOOL BUSES NEEDED 1

BUS ARRIVAL TIME (For pre-departure preparation) 8:30 AM

BUS DEPARTURE TIME (After all pre-trip preparation is complete) 9:00 AM

RETURN TIME (When bus(es) arrive back at school for other duties) 8:00 PM

PURPOSE OF TRIP (Include relationship to present curriculum area being covered) UN ASpire South has been chosen to be Keynote panelists And only high school group selected as part of the 56th Commission on the Status of Women.

NUMBER OF CHAPERONES REQUIRED (See Board Policy No. 121) _____ * PBS is also

* List must be submitted to the building principal at least two (2) weeks prior to the date of the trip.

PROJECTED COST OF TRIP:	# of Substitutes <u>1</u> X # of Days <u>1</u> =	\$ <u>80</u>
	Transportation Costs (as is applicable)	\$ <u>350.00</u>
	Admission/Registration Fees	\$ _____
	Miscellaneous (Please list)	\$ _____
	Grand Total	\$ <u>430.00</u>

Filming our presenta. At UN Headquarters For HALF the Sky Documentary

PROCEDURAL PLAN/RAIN DATE IN CASE OF POSTPONEMENT/CANCELLATION: _____

SIGNATURE -- Staff Member Making Request Michael Healey DATE 1-17-12

SIGNATURE/APPROVAL -- Building Principal [Signature] DATE 1.17.12

SIGNATURE/APPROVAL -- Director of Athletics and Activities* _____ DATE _____
* As is applicable

BUS AVAILABILITY -- Transportation Office _____ DATE _____

SIGNATURE -- Asst. Supt./Curriculum & Instruction [Signature] DATE 1/20/12

SIGNATURE -- Superintendent _____ DATE _____

Dispatch Order #: _____

Please Check One:	
<input type="checkbox"/> Regular Day Trip	<i>g</i>
<input checked="" type="checkbox"/> Extended Day Trip	
<input type="checkbox"/> Overnight Trip	



EAST STROUDSBURG AREA SCHOOL DISTRICT

FIELD TRIP REQUEST FORM

The top section of this form is to be completed by the staff member seeking permission to make the trip. It should be submitted to the building principal for approval at least thirty (30) days prior to the desired day trip date or sixty (60) days prior to an overnight trip. Buses and trips will be approved on a first-come, first-served basis. All field trips made during regular school days should be scheduled between 8:30 A.M. and 1:45 P.M. Drivers will be assigned by the Transportation Office. Do not request specific drivers.

SCHOOL H.S. South GROUP Region Chorus REQUESTOR David Lantz ← LINDA Schaller

DESTINATION H.S. North Waynesboro H.S. GRADE(S)/LEVEL(S) 9-12

DIRECTIONS TO DESTINATION OBTAINED (Please check) YES NO

DATE March 8, 2012 PLACE OF DEPARTURE (Be Specific) H.S. South Aud.

NUMBER OF STUDENTS MAKING TRIP 7 NUMBER OF SCHOOL BUSES NEEDED 1

BUS ARRIVAL TIME (For pre-departure preparation) 5:15am

BUS DEPARTURE TIME (After all pre-trip preparation is complete) 5:30 am

RETURN TIME (When bus(es) arrive back at school for other duties) 1:30 pm

PURPOSE OF TRIP (Include relationship to present curriculum area being covered) Region II Chorus Festival

NUMBER OF CHAPERONES REQUIRED (See Board Policy No. 121) 1 *

* List must be submitted to the building principal at least two (2) weeks prior to the date of the trip.

PROJECTED COST OF TRIP:	# of Substitutes <u>2</u> X # of Days <u>1</u> = \$	<u>175.00</u>
	Transportation Costs (as is applicable)	\$
	Admission/Registration Fees	\$
	Miscellaneous (Please list)	\$
	Grand Total	\$

Dave Lantz transportation account ←

PROCEDURAL PLAN/RAIN DATE IN CASE OF POSTPONEMENT/CANCELLATION: _____

SIGNATURE -- Staff Member Making Request Linda Schaller DATE 1-12-12

SIGNATURE/APPROVAL -- Building Principal [Signature] DATE 1-13-12

SIGNATURE/APPROVAL -- Director of Athletics and Activities* _____ DATE _____
* As is applicable

BUS AVAILABILITY -- Transportation Office _____ DATE _____

SIGNATURE -- Asst. Supt./Curriculum & Instruction [Signature] DATE 1/19/12

SIGNATURE -- Superintendent _____ DATE _____

East Stroudsburg Area School District 2012-2013 School Calendar

July 2012

S	M	T	W	T	F	S
1	2	3	4	5	6	7
8	9	10	11	12	13	14
15	16	17	18	19	20	21
22	23	24	25	26	27	28
29	30	31				

4 - Independence Day Holiday* (District Closed)

January 2013

S	M	T	W	T	F	S
		1	2	3	4	5
6	7	8	9	10	11	12
13	14	15	16	17	18	19
20	21	22	23	24	25	26
27	28	29	30	31		

1 - New Year's Holiday* (District closed)
21 - Martin Luther King Jr. Day (District closed)
22 - Teacher in-service (No students 9-12)
31 - Parent/teacher conferences (No students 6-8)

August 2012

S	M	T	W	T	F	S
			1	2	3	4
5	6	7	8	9	10	11
12	13	14	15	16	17	18
19	20	21	22	23	24	25
26	27	28	29	30	31	

20 - New Teacher Induction
21 - New Teacher Induction
22 - District-wide teacher in-service
23 - District-wide teacher in-service
27 - First Day of School
31 - Labor Day Holiday (Offices closed)

February 2013

S	M	T	W	T	F	S
					1	2
3	4	5	6	7	8	9
10	11	12	13	14	15	16
17	18	19	20	21	22	23
24	25	26	27	28		

1 - Parent/teacher conferences (No students K-8)
18 - Presidents' Day Holiday (District closed)

September 2012

S	M	T	W	T	F	S
						1
2	3	4	5	6	7	8
9	10	11	12	13	14	15
16	17	18	19	20	21	22
23	24	25	26	27	28	29
30						

3 - Labor Day Holiday (District closed)

March 2013

S	M	T	W	T	F	S
					1	2
3	4	5	6	7	8	9
10	11	12	13	14	15	16
17	18	19	20	21	22	23
24	25	26	27	28	29	30
31						

7 - Parent/teacher conferences (No students 9-12)
8 - Staff development (No students K-12)
28 - Spring Recess (Offices closed)
29 - Good Friday (District closed)

October 2012

S	M	T	W	T	F	S
	1	2	3	4	5	6
7	8	9	10	11	12	13
14	15	16	17	18	19	20
21	22	23	24	25	26	27
28	29	30	31			

8 - Staff development (No students)
9 - Parent/teacher conferences (No students 9-12)
19 - Staff development (No students 6-8)

April 2013

S	M	T	W	T	F	S
	1	2	3	4	5	6
7	8	9	10	11	12	13
14	15	16	17	18	19	20
21	22	23	24	25	26	27
28	29	30				

1 - Spring Recess (Offices closed)

November 2012

S	M	T	W	T	F	S
				1	2	3
4	5	6	7	8	9	10
11	12	13	14	15	16	17
18	19	20	21	22	23	24
25	26	27	28	29	30	

20 - Staff development (No students K-8)
21 - Staff development (No students K-8)
22 - Thanksgiving Holiday (District closed)
23 - "Friday After Thanksgiving" Holiday (District closed)
26 - "Monday After Thanksgiving" Holiday (District closed)

May 2013

S	M	T	W	T	F	S
			1	2	3	4
5	6	7	8	9	10	11
12	13	14	15	16	17	18
19	20	21	22	23	24	25
26	27	28	29	30	31	

20 - Teacher in-service (No students K-8)
24 - Half Day (9-12)
27 - Memorial Day Holiday (District closed)
28 - Half Day (K-12)
29 - Half Day (K-8)
30 - Tentative Last Day of School (Half Day, K-12)
31 - Teacher in-service

December 2012

S	M	T	W	T	F	S
						1
2	3	4	5	6	7	8
9	10	11	12	13	14	15
16	17	18	19	20	21	22
23	24	25	26	27	28	29
30	31					

24 - "Last Regular Workday Before Christmas" Holiday (District closed)
25 - Christmas Holiday* (District closed)
26 - Winter Recess (Offices closed)
27 - Winter Recess (Offices closed)
28 - Winter Recess (Offices closed)
31 - New Year's Eve Holiday* (District closed)

June 2013

S	M	T	W	T	F	S
						1
2	3	4	5	6	7	8
9	10	11	12	13	14	15
16	17	18	19	20	21	22
23	24	25	26	27	28	29
30						

Legend

	Late start		Early dismissal(s)		School(s) closed		First Day of School (Current)		Last Day of School (Current)
	Emergency closing		Contract Holiday		First Day of School (Original)		Last Day of School (Original)		

* - These holidays observed on Friday or Monday in accordance with 5 U.S.C. 6103. All ten (10) holidays designated in accordance with 24 PS 15-1502. Approved by the Board of Education: January 23, 2012.

EAST STROUDSBURG AREA SCHOOL DISTRICT

REQUEST TO ESTABLISH A STUDENT ACTIVITY

1. NAME OF ORGANIZATION: Reach Hei Club
2. PURPOSE OR OBJECTIVE: (Briefly describe why this organization is being formed.)
To educate students persuing health careers and raise student awareness about current healthcare issues. To enable students to gain crucial leadership skills and engage in the promotion of health and related career information among peers.
3. BENEFIT: (Briefly describe how the students/district will benefit from the establishment of this organization.)
Students will be provided with service learning opportunities related to healthcare and will establish networking connections with professionals and organizations in the area. The primary goal of this club is to motivate and give opportunities to students interested in the allied health care field so that they can establish a solid goal for future education and professions.
4. LEADERSHIP: (Briefly describe how this activity will be organized, how it will be run and whether the officers will be elected or appointed.) The most senior Reach Hei program participants will serve as leaders in the club. Officers will be elected by majority vote among group members in September of each year. The Club positions of President, Vice President, Secretary, Treasurer and Publicity Officer will be filled. The officers will serve their position for a full academic year and may run for re-election each September. The officers must hold a 3.0 GPA and attendance of 75% of required meetings. Removal of an officer will be done in accordance to the Club Constitution. Meetings will be held twice a week until the Pennsylvania Junior Academy of Science competition takes place in March, and then meetings will resume at twice a month until June. Any member of the Reach Hei program that is required to participate in the PJAS competition must attend meetings once a week to prepare for the competition until the project is complete.
5. FUND RAISING:
 - a. Will this organization raise funds? Yes No
 - b. If "yes", briefly describe typical fund-raising activities and who will be involved.
Fundraising will be student based activities as approved by administration. Most fundraising will go towards provided donations to the semester of service organizations chosen to support. Ideas include:
-Faculty vs. Staff basketball game after season
-Ribbon of the Month sales
-Penny Wars (each class tries to fill a jar with pennies; dollar bills subtract 100 pennies, the winning class will split the earnings with the Reach Hei club)
-Healthy Snack Stands-during Spring athletic events
-Tailgating/BBO sponsor before Spring athletic events
6. USE OF FUNDS: (Briefly describe how these funds will be used to benefit the students or the district.)
Funds will be used to aid students in transportation to/from service projects and PJAS competitions as well as provide materials for future PJAS competition projects. Fundraising will also be included in buying materials needed to help support semester of service projects and donations to the semester of service organization(s) chosen.
7. FINANCIAL DEPENDENCE:
 - a. Will this organization require any financial assistance or facilities and equipment to be provided by the General Fund? Yes No
 - b. If "yes", briefly describe the assistance needed and whether it is a continuing, year-to-year need.
A meeting place will be required by the club along with the fiscal responsibilities of running that facility. Additional financial assistance or equipment may be requested with further club development.

8. FINANCIAL RESPONSIBILITY: (Briefly describe who will be responsible for these funds and how fund-raising, expenditure and/or transfer decisions will be made)

The Reach Hei Club advisor, currently Mrs. Tscheschlog will be the primary holder of responsibility for the club. In addition, the Reach Hei Club Treasurer will be assisting the advisor in responsibilities and making decisions on expenditure/transfer of moneys.

Date Submitted: 1/6/12

Submitted by: Helene Tscheschlog

Signature: _____

Principal: _____

Helene Tscheschlog
1/8/12

EAST STROUDSBURG AREA SCHOOL DISTRICT

REQUEST TO ESTABLISH A SPECIAL ACTIVITY

1. NAME OF ORGANIZATION: Trade + Field
2. PURPOSE OR OBJECTIVE: (Briefly describe why this organization is being formed.)
to deposit concession stand
3. BENEFIT: (Briefly describe how the students/district will benefit from the establishment of this organization.)

4. LEADERSHIP: (Briefly describe how this activity will be organized, how it will be run and whether the officers will be elected or appointed.) Co-ordinator,
5. FUND RAISING:
 - a. Will this organization raise funds? Yes No
 - b. If "yes", briefly describe typical fund-raising activities and who will be involved.

6. USE OF FUNDS: (Briefly describe how these funds will be used to benefit the students or the district.)
for trade supplies
7. FINANCIAL DEPENDENCE:
 - a. Will this organization require any financial assistance or facilities and equipment to be provided by the General Fund? Yes No
 - b. If "yes", briefly describe the assistance needed and whether it is a continuing, year-to-year need.

8. FINANCIAL RESPONSIBILITY: (Briefly describe who will be responsible for these funds and how fund-raising, expenditure and/or transfer decisions will be made) Cummins

Date Submitted: 1/11/12

Submitted by: _____

Signature: ~~_____~~ (Christine Molteni)

Principal: ~~_____~~ Michael Calix

EAST STROUDSBURG AREA SCHOOL DISTRICT

REQUEST TO ESTABLISH A SPECIAL ACTIVITY

1. NAME OF ORGANIZATION: Lehman Cooking Club
2. PURPOSE OR OBJECTIVE: (Briefly describe why this organization is being formed.)
The cooking club will teach student healthy cooking skills beyond what is covered in the classrooms.
3. BENEFIT: (Briefly describe how the students/district will benefit from the establishment of this organization.)
Students who are interested in culinary careers are able to hone the basic skills they will need before attending MCTI as well as students who wish to participate more in the cooking process at home will be better prepared.
4. LEADERSHIP: (Briefly describe how this activity will be organized, how it will be run and whether the officers will be elected or appointed.) There are no officers in this club. It runs for 3-eight week sessions to allow as many students to participate as possible. Each session has a maximum of 20 students.
5. FUND RAISING:
 - a. Will this organization raise funds? Yes No
 - b. If "yes", briefly describe typical fund-raising activities and who will be involved.
Food competitions and recipe contests
6. USE OF FUNDS: (Briefly describe how these funds will be used to benefit the students or the district.)
Funds will be used to buy supplies and cooking tools to allow for more elaborate recipes
7. FINANCIAL DEPENDENCE:
 - a. Will this organization require any financial assistance or facilities and equipment to be provided by the General Fund? Yes No
 - b. If "yes", briefly describe the assistance needed and whether it is a continuing, year-to-year need.
No assistance is required, but we will need to use the cooking room at Lemman Intermediate
8. FINANCIAL RESPONSIBILITY: (Briefly describe who will be responsible for these funds and how fund-raising, expenditure and/or transfer decisions will be made)
Mrs. Nicoletta will be responsible for all funds and expenditures on an as needed basis for materials and supplies.

Date Submitted: 1/17/12

Submitted by: Anna Nicoletta

Signature: _____

Principal: _____

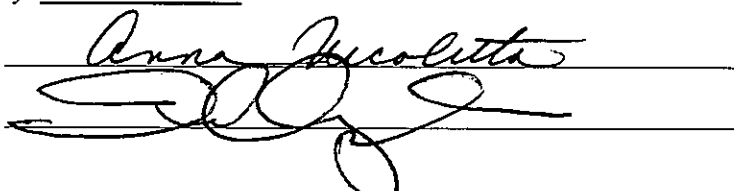

KIRK, SUMMA & CO., LLP

CERTIFIED PUBLIC ACCOUNTANTS

P.O. BOX 307
ONE DANSBURY SQUARE
EAST STROUDSBURG, PENNSYLVANIA 18301
570-421-0753
FAX # 570-421-3615

OTHER OFFICES

ALLENTOWN, PA
610-770-9889

BRODHEADSVILLE, PA
570-992-5876

DALE E. KIRK, C.P.A.
KEVIN D. SUMMA, C.P.A.

January 18, 2012

East Stroudsburg Area School District
50 Vine Street
East Stroudsburg, PA 18301

We are pleased to confirm our understanding of the services we are to provide East Stroudsburg Area School District for the years ended June 30, 2012, 2013 and 2014. We will audit the financial statements of the governmental activities, the business-type activities, each major fund, and the aggregate remaining fund information, which collectively comprise the basic financial statements, of East Stroudsburg Area School District as of and for the years ended June 30, 2012, 2013 and 2014. Accounting standards generally accepted in the United States provide for certain required supplementary information (RSI), such as management's discussion and analysis (MD&A), to supplement East Stroudsburg Area School District's basic financial statements. Such information, although not a part of the basic financial statements, is required by the Governmental Accounting Standards Board who considers it to be an essential part of financial reporting for placing the basic financial statements in an appropriate operational, economic, or historical context. As part of our engagement, we will apply certain limited procedures to East Stroudsburg Area School District's RSI in accordance with auditing standards generally accepted in the United States of America. These limited procedures will consist principally of inquiries of management regarding the methods of preparing the information and comparing the information for consistency with management's responses to our inquiries, the basic financial statements, and other knowledge we obtained during our audit of the basic financial statements. We will not express an opinion or provide any assurance on the information because the limited procedures do not provide us with sufficient evidence to express an opinion or provide any assurance. The following RSI is required by generally accepted accounting principles and will be subjected to certain limited procedures, but will not be audited:

1. Management's discussion and analysis.
2. Statement of Revenues, Expenditures, and Changes in Fund Balance-Budget and Actual-General Fund

We have also been engaged to report on supplementary information other than RSI that accompanies East Stroudsburg Area School District's financial statements. We will subject the following supplementary information to the auditing procedures applied in our audit of the financial statements as a whole and will provide an opinion on it in relation to the financial statements and certain additional procedures, including comparing and reconciling such information directly to the underlying accounting and other records used to prepare the financial statements or to the financial statements themselves, and other additional procedures in accordance with auditing standards generally accepted in the United States of America and will provide an opinion on it in relation to the financial statements as a whole:

1. Schedule of expenditures of federal awards.

Audit Objectives

The objective of our audit is the expression of opinions as to whether your basic financial statements are fairly presented, in all material respects, in conformity with U.S. generally accepted accounting principles and to report on the fairness of the supplementary information referred to in the second paragraph when considered in relation to the basic financial statements taken as whole. The objective also includes reporting on –

- Internal control related to the financial statements and compliance with laws, regulations, and the provisions of contracts or grant agreements, noncompliance with which could have a material effect on the financial statements in accordance with *Government Auditing Standards*.
- Internal control related to major programs and an opinion (or disclaimer of opinion) on compliance with laws, regulations, and the provisions of contracts or grant agreements that could have a direct and material effect on each major program in accordance with the Single Audit Act Amendments of 1996 and OMB Circular A-133, *Audits of States, Local Governments, and Non-Profit Organizations*.

The reports on internal control and compliance will each include a statement that the report is intended solely for the information and use of management, the body or individuals charged with governance, other within the entity specific legislative or regulatory bodies, federal awarding agencies, and if applicable, pass-through entities and is not intended to be and should not be used by anyone other than these specified parties.

Our audit will be conducted in accordance with auditing standards generally accepted in the United States of America; the standards for financial audits contained in *Government Auditing Standards*, issued by the Comptroller General of the United States; the Single Audit Act Amendments of 1996; and the provisions of OMB Circular A-133, and will include tests of accounting records, a determination of major program(s) in accordance with OMB Circular A-133, and other procedures we consider necessary to enable us to express such opinions and to render the required reports. If our opinions on the financial statements or the Single Audit compliance opinions are other than unqualified, we will fully discuss the reasons with you in advance. If, for any reason, we are unable to complete the audit or are unable to form or have not formed opinions, we may decline to express opinions or to issue a report as a result of this engagement.

Management Responsibilities

Management is responsible for the basic financial statements and all accompanying information as well as all representations contained therein. Management is also responsible for identifying government award programs and understanding and complying with the compliance requirements preparation of the schedule of expenditures of federal awards in accordance with the requirements of OMB Circular A-133. As part of the audit, we will assist with preparation of your financial statements, schedule of expenditures of federal awards, and related notes. You are responsible for making all management decisions and performing all management functions relating to the financial statements, schedule of expenditures of federal awards, and related notes and for accepting full responsibility for such decisions. You will be required to acknowledge in the management representation letter our assistance with preparation of the financial statements and the schedule of expenditures of federal awards and that you have reviewed and approved the financial statements, schedule of expenditures of federal awards and related notes prior to their issuance and have accepted responsibility for them. Further, you are required to designate an individual with suitable skill, knowledge, or experience to oversee any nonaudit services we provide and for evaluating the adequacy and results of those services and accepting responsibility for them.

Management is responsible for establishing and maintaining effective internal controls, including internal controls over compliance, and for evaluating and monitoring ongoing activities, to help ensure that appropriate goals and objectives are met and that there is reasonable assurance that government programs are administered in compliance with compliance requirements. You are also responsible for the selection and application of accounting principles; for the fair presentation in the financial statements of the respective financial position of the governmental activities, the business-type activities, each major fund, and the aggregate remaining fund information of the East Stroudsburg Area School District and the respective changes in financial position and, where applicable, cash flows in conformity with U.S. generally accepted accounting principles; and for compliance with applicable laws and regulations and the provisions of contracts and grant agreements.

Management is also responsible for making all financial records and related information available to us and for ensuring that management and financial information is reliable and properly recorded. Your responsibilities also include, including identifying significant vendor relationships in which the vendor has responsibility for program compliance and for the accuracy and completeness of that information. Your responsibilities include adjusting the financial statements to correct material misstatements and confirming to us in the representation letter that the effects of any uncorrected misstatements aggregated by us during the current engagement and pertaining to the latest period presented are immaterial, both individually and in the aggregate, to the financial statements taken as a whole.

You are responsible for the design and implementation of programs and controls to prevent and detect fraud, and for informing us about all known or suspected fraud or illegal acts affecting the government involving (1) management, (2) employees who have significant roles in internal control, and (3) others where the fraud or illegal acts could have a material effect on the financial statements. Your responsibilities include informing us of your knowledge of any allegations of fraud or suspected fraud affecting the government received in communications from employees, former employees, grantors, regulators, or others.

In addition, you are responsible for identifying and ensuring that the entity complies with applicable laws, regulations, contracts, agreements, and grants. Additionally, as required by OMB Circular A-133, it is management's responsibility to follow up and take corrective action on reported audit findings and to prepare a summary schedule of prior audit findings and a corrective action plan. The summary schedule of prior audit findings should be available for our review on June 30, 2012, if applicable. You are responsible for the preparation of the supplementary information in conformity with U.S. generally accepted accounting principles. You agree to include our report on the supplementary information in any document that contains and indicates that we have reported on the supplementary information. You also agree to present the supplementary information with the audited financial statements OR make the audited financial statements readily available to users of the supplementary information no later than the date the supplementary information is issued with our report thereon.

Management is responsible for establishing and maintaining a process for tracking the status of audit findings and recommendations. Management is also responsible for identifying for us previous financial audits, attestation engagements, performance audits, or other studies related to the objectives discussed in the Audit Objectives section of this letter. This responsibility includes relaying to us corrective actions taken to address significant findings and recommendations resulting from those audits, attestation engagements, performance audits, or studies. You are also responsible for providing management's views on our current findings, conclusions, and recommendations, as well as your planned corrective actions, for the report, and for the timing and format for providing that information.

Audit Procedures – General

An audit includes examining, on a test basis, evidence supporting the amounts and disclosures in the financial statements; therefore, our audit will involve judgment about the number of transactions to be examined and the areas to be tested. We will plan and perform the audit to obtain reasonable rather than absolute assurance about whether the financial statements are free of material misstatement, whether from (1) errors, (2) fraudulent financial reporting, (3) misappropriation of assets, or (4) violations of laws or governmental regulations that are attributable to the entity or to acts by management or employees acting on behalf of the entity. Because the determination of abuse is subjective, *Government Auditing Standards* do not expect auditors to provide reasonable assurance of detecting abuse.

Because an audit is designed to provide reasonable, but not absolute assurance and because we will not perform a detailed examination of all transactions, there is a risk that material misstatements or noncompliance may exist and not be detected by us. In addition, an audit is not designed to detect immaterial misstatements or violations of laws or governmental regulations that do not have a direct and material effect on the financial statements or major programs. However, we will inform you of any material errors and any fraudulent financial reporting or misappropriation of assets that come to our attention. We will also inform you of any violations of laws or governmental regulations that come to our attention, unless clearly inconsequential and of any material abuse that comes to our attention. We will include such matters in the reports required for a Single Audit. Our responsibility as auditors is limited to the period covered by our audit and does not extend to any later periods for which we are not engaged as auditors.

Our procedures will include tests of documentary evidence supporting the transactions recorded in the accounts, and may include tests of the physical existence of inventories, and direct confirmation of receivables and certain other assets and liabilities by correspondence with selected individuals, funding sources, creditors, and financial institutions. We will request written representations from your attorneys as part of the engagement, and they may bill you for responding to this inquiry. At the conclusion of our audit, we will require certain written representations from you about the financial statements and related matters.

Audit Procedures – Internal Controls

Our audit will include obtaining an understanding of the entity and its environment, including internal control, sufficient to assess the risks of material misstatement of the financial statements and to design the nature, timing, and extent of further audit procedures. Tests of controls may be performed to test the effectiveness of certain controls that we consider relevant to preventing and detecting errors and fraud that are material to the financial statements and to preventing and detecting misstatements resulting from illegal acts and other noncompliance matters that have a direct and material effect on the financial statements. Our tests, if performed, will be less in scope than would be necessary to render an opinion on internal control and, accordingly, no opinion will be expressed in our report on internal control issued pursuant to *Government Auditing Standards*.

As required by OMB Circular A-133, we will perform tests of controls over compliance to evaluate the effectiveness of the design and operation of controls that we consider relevant to preventing or detecting material noncompliance with compliance requirements applicable to each major federal award program. However, our tests will be less in scope than would be necessary to render an opinion on those controls and, accordingly, no opinion will be expressed in our report on internal control issued pursuant to OMB Circular A-133.

An audit is not designed to provide assurance on internal control or to identify significant deficiencies. However, during the audit, we will communicate to management and those charged with governance internal control related matters that are required to be communicated under AICPA professional standards, *Government Auditing Standards* and OMB Circular A-133.

Audit Procedures - Compliance

As part of obtaining reasonable assurance about whether the financial statements are free of material misstatement, we will perform tests of East Stroudsburg Area School District's compliance with applicable laws and regulations and the provisions of contracts and agreements, including grant agreements. However, the objective of those procedures will not be to provide an opinion on overall compliance and we will not express such an opinion in our report on compliance issued pursuant to *Government Auditing Standards*.

OMB Circular A-133 requires that we also plan and perform the audit to obtain reasonable assurance about whether the auditee has complied with applicable laws and regulations and the provisions of contracts and grant agreements applicable to major programs. Our procedures will consist of tests of transactions and other applicable procedures described in the *OMB Circular A-133 Compliance Supplement* and related agenda for the types of compliance requirements that could have a direct and material effect on each of East Stroudsburg Area School District's major programs. The purpose of those procedures will be to express an opinion of East Stroudsburg Area School District's compliance with requirements applicable to each of its major programs in our report on compliance issued pursuant to OMB Circular A-133.

Engagement Administration, Fees, and Other

We understand that your employees will prepare all cash, accounts receivable, or other confirmations we request and will locate any documents selected by us for testing.

At the conclusion of the engagement, we will complete the appropriate sections of and sign the Data Collection Form that summarizes our audit findings. It is management's responsibility to submit the reporting package (including financial statements, schedule of expenditures of federal awards, summary schedule of prior audit findings, auditors' reports, and corrective action plan) along with the Data Collection Form to the federal audit clearinghouse. We will coordinate with you the electronic submission and certification. If applicable, we will provide copies of our report for you to include with the reporting package you will submit to pass-through entities. The Data Collection Form and the reporting package must be submitted within the earlier of 30 days after receipt of the auditors' reports or nine months after the end of the audit period, unless a longer period is agreed to in advance by the cognizant or oversight agency for audits.

The audit documentation for this engagement is the property of Kirk, Summa & Co., LLP and constitutes confidential information. However, pursuant to authority given by law or regulation, we may be requested to make certain audit documentation available to the Department of Education or its designee, a federal agency providing direct or indirect funding, or the U.S. Government Accountability Office for purposes of quality review of the audit, to resolve audit findings, or to carry out oversight responsibilities. We will notify you of any such request. If requested, access to such audit documentation will be provided under the supervision of Kirk, Summa & Co., LLP personnel. Furthermore, upon request, we may provide copies of selected audit documentation to the aforementioned parties. These parties may intend, or decide to distribute the copies or information contained therein to others, including other governmental agencies.

The audit documentation for this engagement will be retained for a minimum of five years after the report release or for any additional period requested by the Pennsylvania Department of Education. If we are aware that federal awarding agency, pass-through entity, or auditee is contesting an audit finding, we will contact the party(ies) contesting the audit finding for guidance prior to destroying the audit documentation.

60

KIRK, SUMMA & CO., LLP

CERTIFIED PUBLIC ACCOUNTANTS

We expect to begin our audit in June of each year and to issue our reports no later than October 31st of each year if all records are available timely. Dale E. Kirk is the engagement partner and is responsible for supervising the engagement and signing the report. Our fee for these services will be at our standard hourly rates except that we agree that our gross fee, including expenses, will not exceed \$39,000 for each year. Our standard hourly rates vary according to the degree of responsibility involved and the experience level of the personnel assigned to your audit. Our invoices for these fees will be rendered each month as work progresses and are payable on presentation. In accordance with our firm policies, work may be suspended if your account becomes 60 days or more overdue and may not be resumed until your account is paid in full. If we elect to terminate our services for nonpayment, our engagement will be deemed to have been completed upon written notification of termination, even if we have not completed our report(s). You will be obligated to compensate us for all time expended and to reimburse us for all out-of-pocket costs through the date of termination. The above fee is based on anticipated cooperation from your personnel and the assumption that unexpected circumstances will not be encountered during the audit. If significant additional time is necessary, we will discuss it with you and arrive at a new fee estimate before we incur the additional costs. Time for accounting services, if needed and assistance with the AFR will be billed separately at standard hourly billing rates which are between \$60 and \$100 per hour.

Government Auditing Standards require that we provide you with a copy of our most recent external peer review report and any letter of comment, and any subsequent peer review reports and letters of comment received during the period of the contract. Our 2009 peer review accompanies this letter.

We appreciate the opportunity to be of service to East Stroudsburg Area School District and believe this letter accurately summarizes the significant terms of our engagement. If you have any questions, please let us know. If you agree with the terms of our engagement as described in this letter, please sign the enclosed copy and return it to us.

Very truly yours,

Kirk, Summa, & Co., LLP

RESPONSE:

This letter correctly sets forth the understanding of East Stroudsburg Area School District.

By: _____

Title: _____

Date _____

KIRK, SUMMA & CO., LLP

CERTIFIED PUBLIC ACCOUNTANTS

NOTICE

You have been sued in court. If you wish to defend against the claims set forth in the following pages, you must take action by the return date set forth on the Petition For Rule To Show Cause, by entering a written appearance personally or by attorney and filing in writing with the court your defense or objections to the claims set forth against you. You are warned that if you fail to do so the case may proceed without you and a judgment may be entered against you by the court without further notice to you for any money claimed in the complaint or for any claim or relief requested by the Plaintiff. You may lose money or property or other rights important to you.

YOU SHOULD TAKE THIS PAPER TO YOUR LAWYER AT ONCE. IF YOU DO NOT HAVE A LAWYER OR CANNOT AFFORD ONE, GO TO OR TELEPHONE THE OFFICE SET FORTH BELOW TO FIND OUT WHERE YOU CAN GET LEGAL HELP.

PIKE COUNTY COMMISSIONERS OFFICE
PIKE COUNTY ADMINISTRATION BUILDING
506 BROAD STREET
MILFORD, PENNSYLVANIA 18337
(570) 296-3407

HERIFF'S OFFICE
21 DEC 27 AM 10 21
PIKE COUNTY, PA

NOTICE OF RULE FOR JUDICIAL SALE

IN RE: JUDICIAL SALE OF 2012 UNDER THE
REAL ESTATE TAX SALE LAW OF 1947

IN THE COURT OF COMMON PLEAS
OF PIKE COUNTY, PENNSYLVANIA
NO. 1938-2011, CIVIL

SALE NO.(S) 12-203 THRU 12-350

TO: EAST STROUDSBURG AREA SCHOOL DISTRICT

You are hereby notified on the 22ND DAY OF NOVEMBER, 2011, a rule was entered against you to the above number to show cause why the within described premises should not be sold free and clear of all claims, liens, mortgages and ground rents, pursuant to the terms of the Act of July 7, 1947, P.L. 1368, No. 542 as amended.

You are required to file an answer or otherwise plead to this rule on or before the return day of the rule, otherwise further order will be made in the matter.

BY: S/DENISE FISZPATRICK

Prothonotary/Deputy

IN THE COURT OF COMMON PLEAS OF PIKE COUNTY
SIXTIETH JUDICIAL DISTRICT
COMMONWEALTH OF PENNSYLVANIA

PIKE COUNTY TAX CLAIM BUREAU, :
Petitioner : :

v. : :

THE INTERNAL REVENUE SERVICE AND :
THE OWNERS, LIENHOLDERS AND :
OTHER PARTIES IN INTEREST AS :
SET FORTH ON THE ATTACHED LIEN :
SHEETS, :

No. 193 CIVIL-2011

Respondents

RULE

AND NOW, THIS 22nd Day of November, 2011, upon consideration of the Petition of the Pike County Tax Claim Bureau, it is hereby ORDERED that:

- 1) A rule is issued upon all owners, lien holders and other interested parties identified in Exhibit "A" of said Petition to show cause as to why the properties set forth and described in said Exhibit "A" should not be sold free and clear of their respective claims, liens, mortgages and ground rents.
- 2) This Rule is returnable for Answer only in twenty (20) days from the date this Rule is served upon Respondents.
- 3) If no answer is filed by the specified date, the Rule may be made absolute Upon motion Of counsel.
- 4) If an Answer is filed, either party may petition for a Hearing or Argument, as appropriate, to be held at the Pike County Courthouse, Milford, Pennsylvania.
- 5) The Petitioner is hereby ORDERED to service a copy of this Rule and Petition upon the Aforesaid Respondents and file proof of service thereof.

(By the Court)



[Signature]
Honorable Joseph F. Kameen
President Judge

SUPERIOR COURT
PIKE COUNTY

2011 NOV 23 AM 9:53

OFFICE OF
PROSECUTOR
CLERK

cc: Stacey Beecher, Esquire, Cynthia A. Gehris, Director
Pike County Tax Claim Bureau, Court Adm.



 IN THE COURT OF COMMON PLEAS OF PIKE COUNTY
 SIXTIETH JUDICIAL DISTRICT
 COMMONWEALTH OF PENNSYLVANIA

PIKE COUNTY TAX CLAIM BUREAU, :

Petitioner :

v. :

THE INTERNAL REVENUE SERVICE AND :
 OWNERS, LIENHOLDERS AND :
 OTHER PARTIES IN INTEREST AS :
 SET FORTH IN THE ATTACHED LIEN :
 SHEETS, :

No. 1133 -CIVIL-2011

Atty Id #56400

Respondents :

.....

PETITION FOR RULE UPON ALL INTERESTED PARTIES TO
SHOW CAUSE AS TO WHY PROPERTY SHOULD NOT BE SOLD
FREE AND CLEAR OF ALL ENCUMBRANCES

AND NOW, comes the Petitioner herein, THE PIKE COUNTY TAX CLAIM BUREAU, by and through its Solicitor, Stacey Beecher, Esquire, and files a Petition for a Rule upon all interested parties to show cause as to why the properties set forth in Exhibit "A" should not be sold free and clear of all encumbrances, averring the following in support thereof:

1. On September 21, 2011 and October 3, 2011, the Petitioner caused to be exposed to public upset tax sale certain properties situated in the Townships of Blooming Grove, Delaware, Dingman, Greene, Lackawaxon, Lehman, Milford, Palmyra, Porter and Shohola, and, Pike County, Pennsylvania; as more particularly described in Exhibit "A," which is attached hereto and made a part hereof.

2. Neither the owner(s), his, her or their heirs, assigns or legal representatives or its successors or assigns, or other interested parties, have redeemed the said properties described in Exhibit "A."

OFFICE OF
 COUNTY CLERK
 PIKE COUNTY
 PA
 2011
 SEP 21 13

3. Before exposing the said properties to public upset tax sale, the Petitioner fixed an upset price in accordance with the Real Estate Tax Sale Law, 72 P.S. § 5860.101, *et seq.*, as amended; and, the Petitioner was unable to obtain bids on said properties that were sufficient to pay said upset price in full.

4. Attached hereto as Exhibit "A" are the searches showing the state of the record and ownership of the properties and all tax and municipal claims, liens, mortgages and ground rents against said properties.

5. The judicial tax sale requested herein shall be made subject to the deed restrictions, covenants and reservations in the chain of title for each property.

WHEREFORE, the Petitioner respectfully requests that this Honorable Court issue a Rule upon all parties shown to have an interest in the properties set forth in Exhibit "A" to show cause as to why a decree should not be entered that the said properties be sold free and clear of their respective claims, liens, mortgages and ground rents, pursuant to the provisions of Section 5860.610 of the Real Estate Tax Sale Law, 72 P.S. § 5860.101, *et seq.*, as amended.

Respectfully submitted,
Pike County Tax Claim Bureau

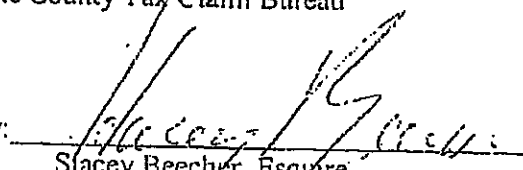
By: 
Stacey Beecher, Esquire
For the Pike County Tax Claim Bureau
Attorney I.D. No. 56400
Pike County Administration Building
506 Broad Street
Milford, Pennsylvania 18337
(570) 296-7613

AGREEMENT AND RELEASE OF CLAIMS

I. PARTIES TO AGREEMENT

This Settlement Agreement and Release of Claims (the "Agreement") is made by and among the following parties:

1. Portnoff Law Associates, Ltd. ("Portnoff").
2. East Stroudsburg Area School District ("ESASD").

II. RECITALS

The following recitals are expressly incorporated into the terms of this Agreement.

WHEREAS, Portnoff and ESASD are currently among the parties to an action pending in the Court of Common Pleas of Monroe County captioned *Pleasant Valley School District, et al. v. Portnoff Law Associates, Ltd.*, Monroe County Ct. of Common Pleas, No. 10016 CIVIL 2010 (hereinafter, the "Action").

WHEREAS, in the Action, ESASD asserts that Portnoff is liable to ESASD for certain losses it incurred in prosecuting, negotiating and/or settling claims against Pike County, Monroe County, and the Pike and Monroe Counties Tax Claim Bureaus (the "Tax Claim Bureaus") with respect to commissions on delinquent taxes Portnoff had previously collected for ESASD and for which no returns had been filed with the Tax Claim Bureaus.

WHEREAS, Portnoff denies all liability on the claims asserted in the Action by ESASD.

WHEREAS, the parties to this agreement mutually desire to avoid further disputes, minimize litigation costs, and avoid further distraction of the parties and their respective management and have therefore agreed to enter into this Agreement as outlined below.

III. CONSIDERATION

1. Settlement Payment: In consideration of the release set forth below and the dismissal of ESASD's claims in the Action with prejudice and without costs or fees, Portnoff will pay \$50,000.00 to The Education Foundation of East Stroudsburg and \$50,000.00 to The East Stroudsburg Halls and Walls of Fame Foundation on or before December 30, 2011 provided that this Agreement is duly executed, and approved by ESASD in accordance with applicable law, on or before December 30, 2011.

2. Other Adequate Consideration: The parties agree that, in addition to the payment provided for in Section III (1) above, there is adequate consideration for ESASD's release of Portnoff including among other things: (a) the parties agree to resolve ESASD's claims in the Action allowing the parties to avoid further expense, uncertainty and delays associated with ongoing litigation; (b) Portnoff agrees to waive any claim to receive any further fees and costs from ESASD, over and above fees and costs paid or reimbursed to Portnoff prior to the date of this Agreement, in relation to any services previously performed by Portnoff to collect taxes from delinquent ESASD taxpayers in Monroe and Pike Counties including, but not limited to, a waiver and assignment to ESASD of any interest Portnoff might otherwise claim in any past or future recovery by ESASD of ESASD's legal fees and costs from such taxpayers under the Municipal Claims and Tax Liens Act ("MCTLA"), 53 P.S. §§ 7101-7505 or otherwise and assigns all of its claims to these fees and costs to ESASD; and (c) Portnoff agrees that ESASD shall retain any and all fees and costs heretofore remitted to ESASD, by the Tax Claim Bureaus or otherwise, designated as fees and costs payable to Portnoff; and (d) the parties agree that they are executing this Agreement intending to be legally bound and, therefore, separate consideration is not required under Pennsylvania law including, but not limited to, 33 P.S. § 6.

IV. RELEASE

1. Release: In consideration for the mutual agreements provided for in this Agreement, ESASD and Portnoff, on their own behalf, for their predecessors, successors, assigns, affiliates, past, present and future agents, representatives, employees, officers, directors, attorneys, board members, officials, and personal or legal representatives and anyone claiming through or under them (hereinafter, for purposes of this paragraph, the "Releasers") hereby release, remise, and forever discharge each other and their predecessors, successors, assigns, parents, holding companies, subsidiaries, affiliates, divisions, past, present and future agents, representatives, employees, officers, directors, attorneys, shareholders, heirs, executors, personal or legal representatives, insurers, re-insurers, and independent contractors of and from any and all manner of action or actions and cause or causes of action, suits, debts, claims, sums of money, accounts, costs, expenses, counterclaims, set-offs, contributions, whatsoever in law or equity of whatever kind or nature without exception whether foreseen or unforeseen, matured or unmatured, known or unknown, accrued or not accrued, direct or indirect, which they alone or in combination with others have had or have, or can, shall or may hereafter have against each other or any of them for or by reason of any cause, matter or thing whatsoever, from the beginning of the world to the present. ESASD and Portnoff agree and acknowledge that this release includes, but is not limited to, any claim raised or asserted, or that could have been raised or asserted, against each other in the Action or in any separate proceedings (including any arbitration proceedings) based on any of the facts, events, transactions, occurrences or omissions giving rise to any claims asserted in the Action.

2. Complete Bar: The parties may plead and/or offer into evidence this Agreement as a complete bar to any action or suit before any court, administrative body or arbitration panel or association with respect to any claim released herein.

V. MISCELLANEOUS PROVISIONS

1. No Admission of Liability: The parties understand and agree that no party to this Agreement admits liability with respect to any claim related to or arising out the Action or the Counterclaim.

2. Enforcement: Any party shall have the right specifically to enforce this Agreement, except for provisions which subsequently may be held invalid or unenforceable, and/or obtain money damages for its breach.

3. Acknowledgments: The parties represent that they have carefully read and fully understand all the provisions of this Agreement, that they are entering into this Agreement voluntarily, and that they have consulted with their respective attorneys before executing it.

4. Full Knowledge: The parties further warrant, represent and agree that in executing this Agreement, they do so with full knowledge of any and all rights which they may have with respect to all matters set forth above.

5. No Reliance: The parties further state that they are not relying and have not relied on any representation or statement made by any other party to this Agreement with respect to the facts involved in said controversies or with regard to the parties' respective rights or asserted rights. The parties hereby assume the risk of all mistakes of fact with regard to said controversies and with regard to all facts which are now unknown to the parties relating thereto

6. No Assignment of Released Claims: ESASD and Portnoff further warrant and represent to each other that no other person or entity has any interest in the claims released

herein and that ESASD and Portnoff have not assigned or transferred nor purported to assign or transfer to any person or entity all or any portion of the claims released herein.

7. Successors and Assigns: The parties are bound by this Agreement and those who succeed to their respective rights and responsibilities, such as their heirs, personal or legal representatives, successors and assigns are also bound and this Agreement also inures to their benefit.

8. Dismissal of Claims: ESASD agrees that, upon Portnoff's payment of \$50,000.00 to The Education Foundation of East Stroudsburg and \$50,000.00 to The East Stroudsburg Halls and Walls of Fame Foundation (pursuant to paragraph III (1) above), ESASD will file all appropriate papers to have its claims in the Action dismissed with prejudice and without costs or fees. Upon dismissal of ESASD's claims in the Action, Portnoff will file all appropriate papers to have its claims dismissed with prejudice and without costs in the matters of (a) *Portnoff Law Associates, Ltd. v. East Stroudsburg Area School District and Pleasant Valley School District*, Monroe County Ct. of Common Pleas, No. 01233 CIVIL 2011; and (b) *Portnoff Law Associates, Ltd. v. East Stroudsburg Area School District*, Pike County Ct. of Common Pleas, No. 306-2011-Civil.

9. Non-disparagement: ESASD, for and through the Board of Education and the administration of ESASD, agrees that it will not disparage Portnoff by, for example, making negative or critical remarks about Portnoff in public and/or to third parties including, but not limited to, comments about Portnoff's professional services, integrity, ethics or business practices.

10. Confidentiality: Although the parties acknowledge that this Agreement is not confidential, ESASD agrees not to make any press releases regarding the settlement and in

the event that any press inquiries are received, ESASD agrees to limit its comments to the following statement (or a statement in substantially similar form): "On behalf of East Stroudsburg Area School District I am pleased to confirm that the School District's claims against Portnoff in the action, which were disputed claims, have been voluntarily settled by the parties to avoid further expense, delay and uncertainty of litigation and without any admission of liability by any party."

11. Controlling Law: This Agreement shall be construed in accordance with the laws of the Commonwealth of Pennsylvania.

12. Counterparts: This Agreement may be executed in any number of counterparts, each of which shall be deemed to be an original with respect to any party whose signature appears thereon and all of which shall together constitute one and the same instrument.

13. Warranty of Authority: Each person executing this Agreement on behalf of a party hereto warrants and represents that he or she is duly authorized to execute this Agreement on behalf of such party and, in the case of ESASD, that all necessary official actions have been taken by ESASD to approve the settlement set forth in this Agreement in accordance with applicable law.

14. Time Of The Essence: The parties acknowledge and agree that time is of the essence and, therefore, Portnoff shall have no obligation to pay the settlement amount referenced in Section III (1) above unless this Agreement is duly executed, and approved by ESASD in accordance with applicable law, on or before December 30, 2011.

15. Severability: The terms of this Agreement are separate and independent and should any of them be declared invalid or unenforceable by any court or other tribunal, the remaining provisions and terms of this Agreement shall remain in full force and effect.

16. Entire Agreement: This Agreement sets forth the entire agreement of the parties, supersedes and extinguishes any and all prior statements, agreements, representations or understandings by or among the parties to this Agreement, and may not be modified nor amended except in writing, executed by all of the parties.

IN WITNESS WHEREOF, expressly intending to be legally bound hereby, the parties have executed this Agreement on the dates indicated below.

EAST STROUDSBURG AREA SCHOOL DISTRICT

Date:



By: William Searfoss
School Board President
East Stroudsburg Area School District

Date:

Witness:



Sharon Laverdure
Superintendent of Schools
East Stroudsburg Area School District

PORTNOFF LAW ASSOCIATES, LTD.

Date:

By: Michelle R. Portnoff

Date: _____

Date:

Witness:



TRAFFIC PLANNING AND DESIGN, INC.

812 W. HAMILTON STREET, STE 402
ALLENTOWN, PA 18101

PHONE: 610.625.4242
FAX: 610.625.4250

TPD@TRAFFICPD.COM
WWW.TRAFFICPD.COM

PA Society of Professional Engineers
Professional Development Award Winner

A Best Civil Engineering Firm
To Work For In The US

December 19, 2011

Mrs. Sharon Laverdure
East Stroudsburg School District
50 Vine Street
East Stroudsburg, PA 18301

Via Certified Mail

Re: **PennDOT Highway Occupancy Permit Application # 327622**
Relocated Franklin Hill Road
Smithfield Township, Monroe County, PA
TPD# DHUY.A.00003

Dear Mrs. Laverdure:

I am writing you on behalf of Smithfield Township as a consulting engineer representing them. We appreciate you taking the time to review this letter concerning the above referenced project. In conjunction with a proposed medical facility along Route 447 in Smithfield Township, Franklin Hill Road is being relocated to intersect Route 447 opposite the Terra Green Drive (School Access). In conjunction with the above noted project, roadway improvements are to be made along Route 447. Specifically, relative to your property, Route 447 is being restriped to add an exclusive left turning lane along Route 447 at its proposed intersection with Franklin Hill Road. Copies of the plan depicting this improvement are included with this letter.

In a recent review letter from PennDOT, we were asked to acquire permission from you for the left-turn lane being painted in front of your property along Route 447 in Smithfield Township. It should be noted that this improvement requires no property from your parcel. All work will be completed within existing PennDOT right-of-way along your frontage. Included is the PennDOT form that the Department requires to be completed. The areas requiring your signature are highlighted. Additionally, on the bottom of the second page notarization is required in the box on the left hand side of the page. We will gladly reimburse you for any notarization fees.

The enclosed plans show the road improvements and in particular the fact that the current offset Route 447 & Franklin Hill Road intersection will be significantly improved for safety and traffic flow by aligning it with the existing school access signalized intersection. Please complete that attached form and return to my attention.

Mrs. Sharon Laverdure
December 19, 2011
Page 2

Should you have any questions or comments, please do not hesitate to contact me. Thank you again for your time and consideration.

Respectfully submitted,



A handwritten signature in black ink, appearing to read 'R. Hoffman', written over a white background.

Robert L. Hoffman, P.E., PTOE
Senior Project Manager

cc: Melissa Maupin, PennDOT District 5-0 Permits Manager
Stephen Carey, Smithfield Township
Jacqueline Ocker, Smithfield Township
M. Arif Fazil, D'Huy Engineering, Inc.
Terry DeGroot, Terraform Engineering, LLC



**AGREEMENT OF RELEASE
(Consequential Damages Free Release)
Interference with Access (Section 441.8(d)(j)(m) & (n))**

County	MONROE COUNTY
Municipality	SMITHFIELD TOWNSHIP
SR-Segment-Offset	SR 0447 - SEG. 0040 - OFFSET 01FLW - 0892
Application/Permit No.	327622
Applicant/Permittee	SMITHFIELD TOWNSHIP 1155 RED FOX ROAD EAST STROUBSBURG, PA 18301

THIS INDENTURE, made this _____ day of _____, 20____,
by EAST STROUBSBURG AREA SCHOOL DISTRICT

owner(s) of property affected by the construction or improvement of the above mentioned State Route (SR) pursuant to the above referenced application/permit, their heirs, executors, administrators, successors and/or assigns, hereinafter, whether singular or plural, called the OWNER, which property is described on Exhibit A, title to which is evidenced by a deed dated _____, and recorded in the Office of the Recorder of Deeds of _____ County in Deed Book _____, Page _____, and the Commonwealth of Pennsylvania, Department of Transportation, hereinafter, whether singular or plural, called the COMMONWEALTH,

WITNESSETH:

In consideration of the benefits accruing to the above OWNER as a result of the aforesaid construction, the OWNER does hereby remise, release, quitclaim and forever discharge the COMMONWEALTH its agents, employees and representatives of and from all suits, damages, claims and demands of any type arising against it as a result of granting of the permit to permittee including any claim which the OWNER might otherwise have been entitled to assert under the provisions of the Eminent Domain Code, Act of June 22, 1964, P.L. 84 as amended (26 P.S. 1-101 et. seq. as amended), for or on account of any injury, destruction or interference with access to the aforesaid property of the OWNER through or by reason of the aforesaid construction or improvement under the above referenced application/permit.

IN WITNESS WHEREOF the OWNER has executed or caused to be executed these presents, intending to be legally bound thereby and intending said presents to be recorded in the proper Office of Recorder of Deeds.

Witness _____ (SEAL)

Witness _____ (SEAL)

Witness _____ (SEAL)

Witness _____ (SEAL)

I attest to the signature of the officer who has executed this indenture and certify that execution hereof has been duly authorized, by the

_____ of _____
BD. OF DIRS., MAJORITY VOTE OF ASSOC., ETC. CORPORATION, ASSOCIATION, CLUB, ETC.

_____ BY _____
Secretary President

(SEAL)

INDIVIDUAL(S), ASSOCIATION, CLUB, etc.

CORPORATION

COMMONWEALTH OF PENNSYLVANIA :
COUNTY OF :SS:
On _____, before me, the undersigned officer, personally appeared

Known to me (or satisfactorily proven) to be the person(s) whose name(s) _____ subscribed to the within instrument, and acknowledge that _____ executed the same.

IN WITNESS WHEREOF, I have hereunto set my hand and official seal.

(SEAL)

COMMONWEALTH OF PENNSYLVANIA :
COUNTY OF :SS:
On _____, before me, the undersigned officer, personally appeared

Who acknowledged himself/herself to be the _____ of _____ a corporation, and that he/she as such officer, being authorized to do so, executed the foregoing instrument on behalf of the said corporation.

IN WITNESS WHEREOF, I have hereunto set my hand and official seal.

(SEAL)

COMMONWEALTH OF PENNSYLVANIA :
COUNTY OF :
Recorded in the Office of the Recorder of Deeds in and For the aforesaid County in Deed Book Page _____
Witness my hand and seal of office on _____

Recorder of Deeds

I certify that, upon recording, the within instrument should be mailed to:

Agent for the Commonwealth of Pennsylvania
Department of Transportation

DISTRICT	COUNTY	ROUTE	SECTION	SHEET
5-0	0441	0441	15	15 OF 15
SHEET NO.		DATE		BY
5-0		10/15/15		WJ
REVISIONS				
1. REVISED TO REFLECT LATEST FIELD DATA				
2. REVISED TO REFLECT LATEST FIELD DATA				
3. REVISED TO REFLECT LATEST FIELD DATA				
4. REVISED TO REFLECT LATEST FIELD DATA				
5. REVISED TO REFLECT LATEST FIELD DATA				

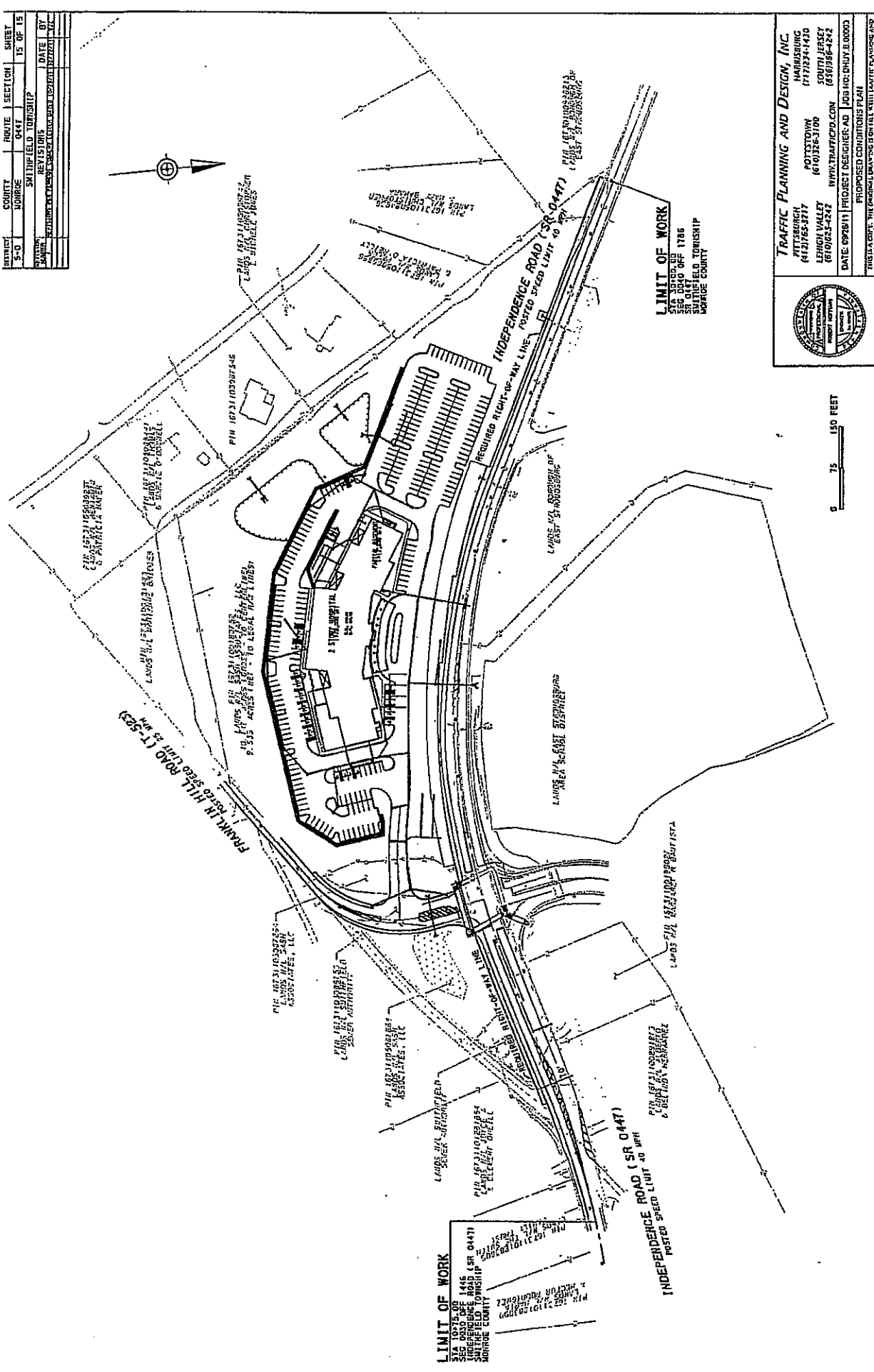
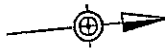

LIMIT OF WORK
 STA 10+75.00 TO STA 14+16.00
 SEC 0840 OF T186
 SURVEYED AND PLATTED
 IN 1978
 INDEPENDENCE ROAD (SR 0441)
 MARIAGE COUNTY

LIMIT OF WORK
 STA 10+75.00 TO STA 14+16.00
 SEC 0840 OF T186
 SURVEYED AND PLATTED
 IN 1978
 INDEPENDENCE ROAD (SR 0441)
 MARIAGE COUNTY

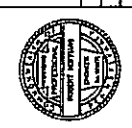

TRAFFIC PLANNING AND DESIGN, INC.
 HARRISBURG
 (412) 765-2717
 POTTSTOWN
 (410) 326-3100
 SOUTH JERSEY
 (610) 653-4242
 WWW.TRAFFICPD.COM (610) 956-4242
 DATE: 08/20/15 PROJECT DESIGNER: AD JOB NO: DRU15.0000
 PROPOSED CONDITIONS PLAN
 THIS PLAN AND ALL INFORMATION CONTAINED HEREIN IS FOR THE USE OF THE CLIENT ONLY AND IS NOT TO BE REPRODUCED OR TRANSMITTED IN ANY FORM OR BY ANY MEANS, ELECTRONIC OR MECHANICAL, INCLUDING PHOTOCOPYING, RECORDING, OR BY ANY INFORMATION STORAGE AND RETRIEVAL SYSTEM.

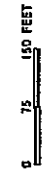

DATE	REVISIONS	DATE	BY
12/01/19			

COUNTY: MONTGOMERY ROUTE: 0447 SECTION: SHEET: 12 OF 19



LEGEND

- - - EXISTING SIGN
- - - PROPOSED SIGN
- 4" x 8" SOLID WHITE LINE
- 4" x 8" SOLID YELLOW LINE
- 4" x 8" SOLID YELLOW LINE
- 4" x 8" SOLID YELLOW LINE
- 4" x 8" SOLID YELLOW LINE
- 4" x 8" SOLID YELLOW LINE
- 4" x 8" SOLID YELLOW LINE
- 4" x 8" SOLID YELLOW LINE
- 4" x 8" SOLID YELLOW LINE
- 4" x 8" SOLID YELLOW LINE
- 4" x 8" SOLID YELLOW LINE
- 4" x 8" SOLID YELLOW LINE
- 4" x 8" SOLID YELLOW LINE
- 4" x 8" SOLID YELLOW LINE
- 4" x 8" SOLID YELLOW LINE
- 4" x 8" SOLID YELLOW LINE
- 4" x 8" SOLID YELLOW LINE
- 4" x 8" SOLID YELLOW LINE
- 4" x 8" SOLID YELLOW LINE

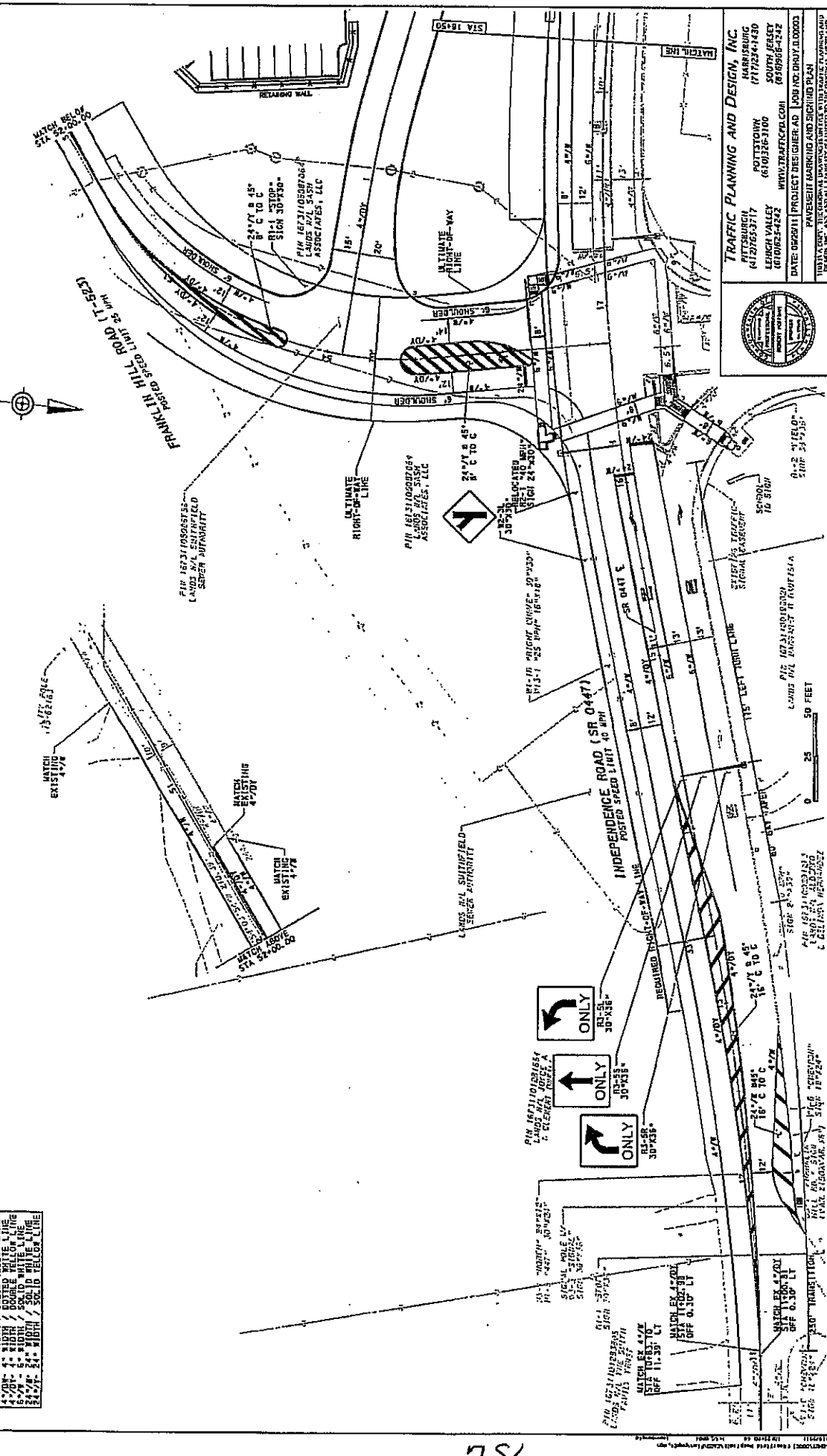

TRAFFIC PLANNING AND DESIGN, INC.
 HARRISBURG (717) 224-1430
 POTTSVILLE (610) 836-3100
 SOUTH JESSEY (610) 623-4242
 WWW.TRAFFICPLAN.COM (610) 836-4242
 DATE: 06/20/11 PROJECT ENGINEER: ADI JOHN AND BRADY BLOTT
 PREPARED BY: BRADY BLOTT
 CHECKED BY: ADI
 TITLE: IMPROVEMENT MARKING AND SIGNING PLAN
 DRAWING NO.: TYPICAL MARKING PLAN
 DRAWING DATE: 06/20/11



January 3, 2012

C. Grainger Bowman
D 717.231.5817
F 717.231.4501
grainger.bowman@klgates.com

East Stroudsburg Area School District
c/o Michael W. Winfield, Esquire
Rhoads & Sinon LLP
P.O. Box 1146
Harrisburg, PA 17108-1146

Rado Enterprises, Inc.
c/o Ciara Young, Esquire
Woolford Law PC
Wheatland Place
941 Wheatland Avenue, Suite 402
Lancaster, PA 17603

Re: Confirmation of Engagement as Impartial Mediator

Dear Counsel:

You have asked me, a lawyer with K&L Gates LLP ("K&L Gates" or the "Firm"), to serve as an impartial mediator in the matter of Rado Enterprises, Inc. v. East Stroudsburg Area School District (the "Dispute").

It is the Firm's practice to confirm in writing the identity of the persons or entities for whom we perform services, the nature of the services to be provided and our billing and payment arrangements with respect to our legal services.

I understand that I am being engaged by each of Rado Enterprises, Inc. and East Stroudsburg Area School District solely to act as an impartial mediator in the Dispute. K&L Gates' conflicts database shows that we do not currently represent Rado Enterprises, Inc. or East Stroudsburg Area School District in any matter nor do we currently represent clients that are adverse to Rado Enterprises, Inc. or East Stroudsburg Area School District. K&L Gates' conflicts database further shows that we have never represented Rado Enterprises, Inc. or East Stroudsburg Area School District nor have we represented clients that were adverse to Rado Enterprises, Inc. or East Stroudsburg Area

K&L | GATES

East Stroudsburg Area School District
Rado Enterprises, Inc.
January 3, 2012
Page 2

School District. I have not personally ever represented Rado Enterprises, Inc. or East Stroudsburg Area School District nor have I personally represented clients in matters where they are or were adverse to Rado Enterprises, Inc. or East Stroudsburg Area School District.

I understand that each of you has considered the foregoing matters prior to agreeing to my service as an impartial mediator in connection with the Dispute. I further understand that each of you has independently reviewed your prior contacts with the Firm and have concluded that you wish me to serve as an impartial mediator.

It is specifically understood and agreed that my services will be limited to service as an impartial mediator and that I will not be engaged to provide legal advice or representation to Rado Enterprises, Inc. or East Stroudsburg Area School District or their respective counsel of record in the Dispute and, therefore, no lawyer-client relationship is being formed with either Rado Enterprises, Inc. or East Stroudsburg Area School District or their counsel as a result of this engagement. Accordingly, my engagement as an impartial mediator of the Dispute will in no way preclude the Firm from representing clients that are taking positions adverse to Rado Enterprises, Inc. or East Stroudsburg Area School District, their counsel, or other of their counsel's clients. Finally, my engagement as an impartial mediator will in no way preclude the Firm from representing clients on whose behalf the Firm may advocate positions inconsistent with the positions that I may take in the course of mediating the Dispute.

Our statements for professional services will be substantially based upon the time spent by me. My hourly rate is \$500.

You will also be billed for disbursements and other charges relating to this engagement. With respect to incidental expenses (such as travel expenses and long-distance telephone calls), you will be billed at our invoiced cost. With respect to internally-generated charges (such as photocopying and facsimile transmissions), you will be billed in accordance with our standard expense schedule in effect when the charge is incurred. Our current schedule is attached to this letter.

Any original documents and property you provide to me in the course of the mediation will be returned to you upon conclusion of the mediation and upon our receipt of payment for outstanding expenses. Otherwise, all mediation materials will be destroyed not later than one year from the conclusion of the mediation.

If the foregoing is not in accordance with your understanding of our engagement in any respect, please contact me so that we may address your concerns promptly. If the

K&L | GATES

East Stroudsburg Area School District
Rado Enterprises, Inc.
January 3, 2012
Page 3

foregoing accurately sets forth your understanding of our engagement, please confirm by executing this letter in the space indicated below and returning an original to me. I look forward to my role as an impartial mediator in the Dispute.

Very truly yours,

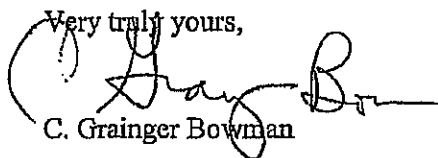

C. Grainger Bowman

Attachment

East Stroudsburg Area School District

By: _____
Title: _____

Rado Enterprises, Inc.

By: _____
Title: _____

K&L GATES LLP

SCHEDULE OF STANDARD CHARGES

2011

<u>DESCRIPTION OF CHARGE:</u>	<u>STANDARD CHARGE</u>	<u>UNIT BASIS</u>
Photocopying/Image Printing	\$0.20	Each copy
Color Copying/Printing	\$1.00	Each copy
Facsimile	\$0.75	Each outgoing transmitted page, plus cost of telephone line usage
CD Burning	\$25.00	Per CD

Legal Research: The Firm pays for Lexis and Westlaw under monthly fixed fee contracts. The actual, monthly fixed fee is allocated to all users of the database each month, and client charges for such usage are directly proportional to the actual research conducted on their behalf.

Long Distance Telephone Calls: The charge for long distance calls is based on the actual time length of the call placed at rates that reasonably approximate our costs.

Secretarial Overtime: As required by client specific circumstances, secretarial overtime will be charged at the Firm's average hourly rate for secretarial overtime.

The following are examples of items that will be charged at their out-of-pocket cost to K&L Gates:

Courier (Federal Express, UPS, etc)

Business Meals

Off-site Storage Retrieval

EAST STROUDSBURG AREA SCHOOL DISTRICT

East Stroudsburg, Pennsylvania 18301

PAYMENTS TO BE MADE THRU THE Bond Issue 2008

The following payments for construction and related costs associated with the Bond Funds have been approved as authorized for payment as of:
January 23, 2012

Requisition #	Vendor/Address	Description		Amount
2008-335 V# 1369	Architectural Studio 732 Turner Street Allentown, PA 18102	HSS 30-4200-450-080-07-31 Proj# 27-00 R Invoice# 12-03	\$ 850.00	
		MSE 30-4200-450-080-05-14 Proj# 13-06 Invoice# 12-04	\$ 1,516.33	\$ 2,366.33
2008-336 V# 2138	BMC Desks ETC. 320 East Gibson Street Scranton, PA 18509	HSS 30-4500-610-080-08-31 PO# CP120001 Invoice# 63031	\$ 30,921.00	\$ 30,921.00
2008-337 V# 12802	Rhoads & Sinon LLP One South Market Square P.O. Box 1146 Harrisburg, PA 17108-1146	HSS 30-4500-720-080-16-31 Rado Enterprises Inc. Invoice# 330454	\$ 1,476.20	\$ 1,476.20
TOTAL:				\$ 34,763.53

EAST STROUDSBURG AREA SCHOOL DISTRICT

East Stroudsburg, Pennsylvania 18301

PAYMENTS TO BE MADE THRU THE QZAB (2011D) Issue

The following payments for construction and related costs associated with the Bond Funds have been approved as authorized for payment as of:

January 23, 2012

Requisition #	Vendor/Address	Description		Amount
QZAB-4 V# 14731	Strunk-Albert Engineering RD 5 Box5198, Route 209 (Seven Bridge Rd.) East Stroudsburg, PA 18301	JMH 30-4200-450-002-06-11 Job# 100-10 Invoice# 3329	\$ 5,000.00	\$ 5,000.00
		TOTAL:		\$ 5,000.00

EAST STROUDSBURG AREA SCHOOL DISTRICT

East Stroudsburg, Pennsylvania 18301

PAYMENTS TO BE MADE THRU THE Bond Issue 2012A

The following payments for construction and related costs associated with the Bond Funds have been approved as authorized for payment as of:
January 23, 2012

Requisition #	Vendor/Address	Description		Amount
2012A-2 V# 14731	Strunk-Albert Engineering RD 5 Box5198, Route 209 (Seven Bridge Rd.) East Stroudsburg, PA 18301	JMH Expanded 30-4200-450-003-06-11 Job# 100-10-A Invoice# 3328	\$ 20,500.00	\$ 20,500.00
		TOTAL:		\$ 20,500.00

APPLICATION FOR USE OF SCHOOL FACILITIES

Name of Organization Babe Ruth Mustangs Today's Date 1/2/12

Non-Profit? yes no Will an admission fee be charged? yes no Are you requesting a waiver of facilities fees? yes no
If yes, amount \$ _____ If yes, attach a letter of justification addressed to the Board of Education. This does not include a waiver of fees for scheduled district personnel.

Specific purpose of use: Hitting

Name of School Requested High school South

DAY(S) from — DATE(S) — to	from — HOURS — to	DESCRIPTION (meeting, practice, game, rehearsal, performance,...)
<u>Monday's in January 30</u> <u>and February</u> <u>and March 24th</u> <u>2012</u>	<u>6 to 8 pm</u>	<u>hitting</u>

Facility Required: Auditorium Cafeteria Gymnasium Aux. Kitchen/Serving
 All-Purpose Room Stadium Kitchen/Preparation
 Swimming Pool (requires proof of certified lifeguard) Stage Fields (specify) _____
 Classrooms # _____ Other (specify) _____

Equipment Required: (*must be operated/attended by school personnel)
 Kitchen Equipment* Sound System Record Player/Stereo Equip. Piano
 Stage Lighting* Motion Picture Projector Overhead Projector/Screen Folding Stands
 Scoreboard* Athletic Equipment Other (specify) _____

The District has the right to assign additional security and other personnel as needed. Your organization will be subject to fees for these services. Your organization must provide a Certificate of Insurance listing the ESASD as co-insured as follows:

\$ _____ Bodily Injury Liability (\$500,000 minimum) \$ on file Property Damage Liability (each occurrence) (\$500,000 minimum)

List at least one, but preferably two, responsible officials of your organization who will be present at the time facilities requested are being used, and who will accept full responsibility for adherence to School District regulations by all persons in attendance.

Name Tony Croce Address _____ Phone 730-9263
Name _____ Address _____ Phone _____

I certify that I have read, understand, and agree to adhere to Policy #707 of the East Stroudsburg Area School District concerning Use of School Facilities. Further, my organization forever releases the East Stroudsburg Area School District, the East Stroudsburg School Authority, their directors, agents, employees and servants from all claims, actions, and charges whatsoever arising out of the event(s) conducted on the above-mentioned date(s) for which this application is submitted. My organization will defend all actions, suits, complaints, or legal proceedings of any kind brought against the Board of Education and any of its agents, servants or employees and further will hold harmless and indemnify the said School Directors, School District, and School Authority from any expenses and judgments or decrees recovered against them as a result of said use of these facilities.

Signature — Responsible Organization Official (attached) Phone (day) 730-9263 (eve.) _____

Billing Address _____

APPROVALS: Principal [Signature] Date 1/1
 Business Administrator [Signature] Date 1/6/12
 copy to: stage manager athletic director cafeteria manager head custodian librarian a/v coordinator other Date 1/1

For office use only:	FACILITIES USE INVOICE	Charges:
Facilities/Equipment used: <u>Class - no fees</u>		\$ _____
		\$ _____
Personnel Employed: _____		\$ _____ <u>rec</u>
(attach time sheets)		\$ _____ <u>1/3/12</u>
		\$ _____
Other (specify): <u>86</u>		\$ _____
		\$ _____

APPLICATION FOR USE OF SCHOOL FACILITIES

Name of Organization East Stroudsburg Little League Today's Date 1 / 19 / 12

Non-Profit? Will an admission fee be charged? Are you requesting a waiver of facilities fees? Yes No

Specific purpose of use: Softball practices Name of School Requested JTL

Table with columns: DAY(S) from DATE(S) to, HOURS from to, DESCRIPTION (meeting, practice, game, rehearsal, performance...)

Facility Required: Auditorium, Stadium, Cafeteria, Kitchen/Preparation, Gymnasium, Kitchen/Serving, Swimming Pool, Stage, Fields, Other

Equipment Required: (*must be operated/attended by school personnel) Kitchen Equipment, Sound System, Record Player, Piano, Stage Lighting, Motion Picture Projector, Overhead Projector, Folding Stands, Scoreboard, Athletic Equipment, Other

The District has the right to assign additional security and other personnel as needed. Your organization will be subject to fees for these services.

\$ Bodily Injury Liability \$ Property Damage Liability (each occurrence) (\$500,000 minimum) on file

List at least one, but preferably two, responsible officials of your organization who will be present at the time facilities requested are being used...

Name Steve Zall Address 602 E Broad Street E.S. Phone 424-3257 Name Anne Power Address 301 Remington Road E.S. Phone 476-0346

I certify that I have read, understand, and agree to adhere to Policy #707 of the East Stroudsburg Area School District concerning Use of School Facilities. Further, my organization forever releases the East Stroudsburg Area School District, the East Stroudsburg School Authority, their directors, agents, employees and servants from all claims, actions, and charges whatsoever arising out of the event(s) conducted on the above-mentioned date(s) for which this application is submitted.

Signature Responsible Organization Official Phone (day) 807 3466 (eve.) 476 0954 Billing Address PO Box 163, Marshall's Creek, PA 18335

APPROVALS: Principal John Burn Date 1 / 20 / 12 Business Administrator Sheddman Date 1 / 20 / 12 copy to: [] stage manager [] athletic director [] cafeteria manager [] head custodian [] librarian [] a/v coordinator [] other Date 1 / 1

For office use only: FACILITIES USE INVOICE Table with columns: Facilities/Equipment used, Personnel Employed, Other (specify), Charges: \$

12-8-11

APPLICATION FOR USE OF SCHOOL FACILITIES

Name of Organization East Stroudsburg Little League Today's Date 11/22/11

Non-Profit? yes no Will an admission fee be charged? yes no Are you requesting a waiver of facilities fees? yes no

Specific purpose of use: Parent Meeting

Name of School Requested JTL

DAY(S) from — DATE(S) — to from — HOURS — to DESCRIPTION (meeting, practice, game, rehearsal, performance,...)

~~Thursday Feb 16th 6PM 8PM Meeting NOT AVAILABLE~~

~~Thursday Feb 23rd 6PM 8PM Meeting~~

Facility Required: Auditorium Cafeteria Stadium Kitchen/Preparation Gymnasium Swimming Pool (requires proof of certified lifeguard) Stage Fields (specify) Kitchen/Serving Classrooms # Other (specify)

Equipment Required: (*must be operated/attended by school personnel) Kitchen Equipment* Sound System Record Player/Stereo Equip. Piano Stage Lighting* Motion Picture Projector Overhead Projector/Screen Folding Stands Scoreboard* Athletic Equipment Other (specify)

The District has the right to assign additional security and other personnel as needed. Your organization will be subject to fees for these services. Your organization must provide a Certificate of Insurance listing the ESASD as co-insured as follows:

\$ _____ Bodily Injury Liability (\$500,000 minimum) \$ _____ Property Damage Liability (each occurrence) (\$500,000 minimum)

List at least one, but preferably two, responsible officials of your organization who will be present at the time facilities requested are being used, and who will accept full responsibility for adherence to School District regulations by all persons in attendance.

Name Sig Mackowski Address RR1 Box 1285B, Henryville, PA Phone 242 4204
Name M. J. Caputo Address 38 Lions Ave, Eastburg 18301 Phone 242 3337

I certify that I have read, understand, and agree to adhere to Policy #707 of the East Stroudsburg Area School District concerning Use of School Facilities. Further, my organization forever releases the East Stroudsburg Area School District, the East Stroudsburg School Authority, their directors, agents, employees and servants from all claims, actions, and charges whatsoever arising out of the event(s) conducted on the above-mentioned date(s) for which this application is submitted. My organization will defend all actions, suits, complaints, or legal proceedings of any kind brought against the Board of Education and any of its agents, servants or employees and further will hold harmless and indemnify the said School Directors, School District, and School Authority from any expenses and judgments or decrees recovered against them as a result of said use of these facilities.

Signature [Signature] Phone (day) 807 3466
Responsible Organization Official (eve.) 476 0954
Billing Address PO Box 163, Marshalls Creek, PA 18335

APPROVALS: Principal [Signature] Date 12/12/11
Business Administrator [Signature] Date 1/17/12

copy to: stage manager athletic director cafeteria manager head custodian librarian a/v coordinator other Date / /

For office use only: FACILITIES USE INVOICE

Facilities/Equipment used: <u>Class 1 - no fees</u>	Charges: \$ _____
Personnel Employed: _____	Charges: \$ _____
Other (specify): <u>88</u>	Charges: \$ _____

2012

APPLICATION FOR USE OF SCHOOL FACILITIES

Name of Organization East Stroudsburg Little League Today's Date 12/5/11

Non-Profit? yes no Will an admission fee be charged? yes no Are you requesting a waiver of facilities fees? yes no If yes, attach a letter of justification addressed to the Board of Education. This does not include a waiver of fees for scheduled district personnel.

Specific purpose of use: Practices + games
Name of School Requested JTL

DAY(S) from DATE(S) to HOURS from to DESCRIPTION (meeting, practice, game, rehearsal, performance,...)
Monday, March 12th to June 30th Monday - Friday 6pm - 8:30pm Cannot use fields 7 days per week practices + games w/week
Saturday Saturday + Sunday 9 AM - 8 PM Baseball + Softball see attached calendar

Facility Required: Field Classrooms # all groups Baseball + Softball
 All-Purpose Room Auditorium Cafeteria Gymnasium
 Swimming Pool (requires proof of certified lifeguard) Stadium Kitchen/Preparation Kitchen/Serving
 Stage Lighting* Motion Picture Projector Fields (specify) Baseball + Softball
 Scoreboard* Athletic Equipment Other (specify) approval based on attached calendar

Equipment Required: (*must be operated/attended by school personnel)
 Kitchen Equipment* Sound System Record Player/Stereo Equip. Folding Stands
 Stage Lighting* Motion Picture Projector Overhead Projector/Screen Tables and/or Chairs
 Scoreboard* Athletic Equipment Other (specify)

The District has the right to assign additional security and other personnel as needed. Your organization will be subject to fees for these services. Your organization must provide a Certificate of Insurance listing the ESASD as co-insured as follows:

\$ _____ Bodily Injury Liability (\$500,000 minimum) \$ _____ Property Damage Liability (each occurrence) (\$500,000 minimum)

List at least one, but preferably two, responsible officials of your organization who will be present at the time facilities requested are being used, and who will accept full responsibility for adherence to School District regulations by all persons in attendance.

Name Anne Power Address 29 Smithfield Vlg, Eastburg 18301 Phone 9176473150
Name Mike Caputo Address Valhalla Dr Eastburg 18301 Phone 2426552

I certify that I have read, understand, and agree to adhere to Policy #707 of the East Stroudsburg Area School District concerning Use of School Facilities. Further, my organization forever releases the East Stroudsburg Area School District, the East Stroudsburg School Authority, their directors, agents, employees and servants from all claims, actions, and charges whatsoever arising out of the event(s) conducted on the above-mentioned date(s) for which this application is submitted. My organization will defend all actions, suits, complaints, or legal proceedings of any kind brought against the Board of Education and any of its agents, servants or employees and further will hold harmless and indemnify the said School Directors, School District, and School Authority from any expenses and judgments or decrees recovered against them as a result of said use of these facilities.

Signature [Signature] Responsible Organization Official Phone (day) 8073466 (eve.) 4760954
Billing Address PO Box 163, Marshalls Creek, PA 18335

APPROVALS: Principal [Signature] - with changes noted above for weekend Date 1/1/12
Business Administrator [Signature] Date 1/5/12
copy to: stage manager athletic director cafeteria manager head custodian librarian a/v coordinator other Date 1/1/12

For office use only: FACILITIES USE INVOICE
Facilities/Equipment used: Class # - no fees Charges: \$ _____
Personnel Employed: _____ Charges: \$ _____
Other (specify): 89 Charges: \$ _____

APPLICATION FOR USE OF SCHOOL FACILITIES

Name of Organization East Stroudsburg North Little League Today's Date 12/5/12

Non-Profit? yes no Will an admission fee be charged? yes no Are you requesting a waiver of facilities fees? yes no If yes, attach a letter of justification addressed to the Board of Education. This does not include a waiver of fees for scheduled district personnel.

Specific purpose of use: Girls Softball Practice

Name of School Requested Middle Smithfield Elementary

Table with columns: DAY(S) from DATE(S) to, HOURS from to, DESCRIPTION (meeting, practice, game, rehearsal, performance,...). Includes handwritten entries: Monday 9 Tuesdays, Active March 5th thru April, 6pm to 8pm, Softball Practice.

Facility Required: Auditorium, Cafeteria, Gymnasium, All-Purpose Room, Stadium, Kitchen/Preparation, Kitchen/Serving, Swimming Pool, Stage, Fields, proof of certified lifeguard, Classrooms #, Other.

Equipment Required: (*must be operated/attended by school personnel) Kitchen Equipment*, Sound System, Record Player/Stereo Equip., Piano, Stage Lighting*, Motion Picture Projector, Overhead Projector/Screen, Folding Stands, Scoreboard*, Athletic Equipment, Other (specify) NONE, Tables and/or Chairs.

The District has the right to assign additional security and other personnel as needed. Your organization will be subject to fees for these services. Your organization must provide a Certificate of Insurance listing the ESASD as co-insured as follows:

\$ Bodily Injury Liability (\$500,000 minimum) \$ Property Damage Liability (each occurrence) (\$500,000 minimum)

List at least one, but preferably two, responsible officials of your organization who will be present at the time facilities requested are being used, and who will accept full responsibility for adherence to School District regulations by all persons in attendance.

Name Donald Acker Address 3 Northpark Est E Stroudsburg Phone 570-242-0421
Name Mike Barbera Address 1330 Resier Falls Rd Phone

I certify that I have read, understand, and agree to adhere to Policy #707 of the East Stroudsburg Area School District concerning Use of School Facilities. Further, my organization forever releases the East Stroudsburg Area School District, the East Stroudsburg School Authority, their directors, agents, employees and servants from all claims, actions, and charges whatsoever arising out of the event(s) conducted on the above-mentioned date(s) for which this application is submitted.

Signature Donald Acker Responsible Organization Official Phone (day) 570-242-0421 (eve.) SAME AS ABOVE

Billing Address 3 Northpark Est East Stroudsburg P.A. 18302

APPROVALS: Principal David W. Baker Date 1/4/12
Business-Administrator She [unclear] Date 1/5/12
copy to: stage manager athletic director cafeteria manager head custodian librarian a/v coordinator other Date 1/1

For office use only: FACILITIES USE INVOICE. Table with columns: Facilities/Equipment used, Personnel Employed, Other (specify), Charges: \$.

----- B A T C H I N F O R M A T I O N -----
 Batch number: 21664 Date of Batch: 1/03/2012 Batch Totals Debit Credit
 User ID: KJK Re-entry date: 29,503.53 29,503.53
 Re-entry User ID: Closing date: 12/31/2011

DK Budget Transf. for 12/31/11 by Obj.
 December 31, 2011

Date	Refer -ence	Account number	Account title	Description	Amount	Refer -ence
12/31/2011	INTTR	10-2310-530-000-00-00-01	BOARD SERVICE, POSTAGE	TO 610	135.00CR	
12/31/2011	INTTR	10-2310-610-000-00-00-01	BOARD SERVICE SUPPLIES	FROM 530	135.00	
12/31/2011	INTTR	10-2390-300-000-00-00-05	AUTHORITY EXP., PAYING AGENT	TO 300-002	539.42CR	
12/31/2011	INTTR	10-2390-300-002-00-00-05	INVESTMENT MANAGEMENT FEES	FROM 300	539.42	
12/31/2011	INTTR	10-2500-300-000-00-00-05	BUSINESS OFFICE, PROF. CONTR. SVC	TO 550	600.00CR	
12/31/2011	INTTR	10-2500-550-000-00-00-05	BUSINESS OFFICE, PRINTING	FROM 300	600.00	
12/31/2011	INTTR	10-2500-300-000-00-00-05	BUSINESS OFFICE, PROF. CONTR. SVC	TO 400	2,771.50CR	
12/31/2011	INTTR	10-2500-400-000-00-00-05	BUSINESS OFFICE, PROPERTY SVC.	FROM 300	2,771.50	
12/31/2011	INTTR	10-2840-618-000-00-00-06	ITEC, TECH SUPPLIES	TO 758	1,200.00CR	
12/31/2011	INTTR	10-2840-758-000-00-00-06	ITEC, NEW TECH EQUIPMENT	FROM 618	1,200.00	
12/31/2011	INTTR	10-2840-650-000-00-00-06	ITEC, TECH BOOKS & PERIODICALS	TO 758	1,399.95CR	
12/31/2011	INTTR	10-2840-758-000-00-00-06	ITEC, NEW TECH EQUIPMENT	FROM 650	399.95	
12/31/2011	INTTR	10-2840-438-000-00-00-06	ITEC, MAINTAIN/UPGRADE INFOSYS	TO 618	116.00	
12/31/2011	INTTR	10-2840-618-000-00-00-06	ITEC, TECH SUPPLIES	FROM 438	116.00	
12/31/2011	INTTR	10-2840-650-000-00-00-06	ITEC, TECH BOOKS & PERIODICALS	TO 618	544.36CR	
12/31/2011	INTTR	10-2840-618-000-00-00-06	ITEC, TECH SUPPLIES	FROM 650	544.36	
12/31/2011	INTTR	10-2380-610-000-10-11-11	JMH, PRIN., GENERAL SUPPLIES	TO 810	220.00CR	
12/31/2011	INTTR	10-2380-810-000-10-11-11	JMH, PRIN., DUES & FEES	FROM 610	220.00	
12/31/2011	INTTR	10-2360-750-000-00-00-21	SPECIAL PROJECTS, NEW EQUIPMENT	TO 610	3,000.00CR	
12/31/2011	INTTR	10-2360-610-000-00-00-21	SPECIAL PROJECTS, GEN. SUPPLIES	FROM 750	3,000.00	
12/31/2011	INTTR	10-2360-760-000-00-00-21	SPECIAL PROJECTS, REPL. EQUIPMNT	TO 610	7,750.00CR	
12/31/2011	INTTR	10-2360-610-000-00-00-21	SPECIAL PROJECTS, GEN. SUPPLIES	FROM 760	7,750.00	
12/31/2011	INTTR	10-2250-442-000-30-51-42	LIBRARY, EHN RENTAL EQUIPMENT	TO 650	500.00CR	
12/31/2011	INTTR	10-2250-650-000-30-51-42	LIBRARY, EHN SOFTWARE/VIDEOS	FROM 442	500.00	
12/31/2011	INTTR	10-2250-442-000-30-51-42	LIBRARY, EHN RENTAL EQUIPMENT	TO 768	1,430.00CR	
12/31/2011	INTTR	10-2250-768-000-30-51-42	LIBRARY, EHN RENTAL EQUIP.	FROM 442	1,430.00	
12/31/2011	INTTR	10-2250-442-000-30-51-42	LIBRARY, EHN BOOKS/PERIODICALS	TO 640	1,590.00CR	
12/31/2011	INTTR	10-2250-640-000-30-51-42	LIBRARY, EHN BOOKS/PERIODICALS	FROM 442	590.00	
12/31/2011	INTTR	10-1100-400-000-30-32-44	MUSIC, INSTR. JTL, PROP. SERVICE	TO 610	1,000.00CR	
12/31/2011	INTTR	10-1100-610-000-30-32-44	MUSIC, INSTR. JTL, SUPPLIES	FROM 400	1,000.00	
12/31/2011	INTTR	10-1100-750-000-30-31-45	MUSIC, VOCAL, EHS, SUPPLIES	TO 610	1,300.00CR	
12/31/2011	INTTR	10-1100-610-000-30-31-45	MUSIC, VOCAL, EHS, SUPPLIES	FROM 750	300.00	
12/31/2011	INTTR	10-1100-759-000-30-52-52	LIS, INSTR. NEW TECH EQUIP>\$2500	TO 650	900.00CR	
12/31/2011	INTTR	10-1100-650-000-30-52-47	READING, LIS, INST. TECH SUPPLIES	FROM 759	900.00	
12/31/2011	INTTR	10-3200-610-000-30-52-61	GEN. ATHL., LIS, SUPPLIES	TO 810	273.00CR	

DK Budget Transf for 12/31/11 by Obj.
December 31, 2011

(continued)

Date	Refer- -ence	Account number	Account title	Description	Amount	Refer- -ence
12/31/2011	INTTR	10-3200-810-000-30-52-78	ATHL. TRAINER, LIS, DUES & FEES	FROM 610	273.00	
12/31/2011	INTTR	10-2660-750-000-30-31-91	SECURITY, EHS, NEW EQUIPMENT	TO 610	3,000.00CR	
12/31/2011	INTTR	10-2660-610-000-30-31-91	SECURITY, EHS, SUPPLIES	FROM 750	3,000.00	
12/31/2011	INTTR	10-2660-750-000-30-51-91	SECURITY, EHN, NEW EQUIPMENT	TO 610	3,000.00CR	
12/31/2011	INTTR	10-2660-610-000-30-51-91	SECURITY, EHN, SUPPLIES	FROM 750	3,000.00	
12/31/2011	INTTR	10-2660-432-000-30-31-91	SECURITY, EHS, EQUIP. REPAIR	TO 400	900.00CR	
12/31/2011	INTTR	10-2660-400-000-30-31-91	SECURITY, EHS, CONTR. MAINT.	FROM 432	900.00	
12/31/2011	INTTR	10-2660-810-000-00-00-91	SECURITY, DISTRICT, DUES & FEES	TO 300	334.30CR	
12/31/2011	INTTR	10-2660-300-000-00-00-91	SECURITY, DISTRICT, CONTR. SERV.	FROM 810	334.30	
					.00	INTTR
Total:					.00	
Debits:					29,503.53	
Credits:					29,503.53	
44 Transactions						
0 Unbalanced references						

Jan 03, 2012

001 East Stroudsburg Area School District
BUDGET TRANSFERS EDIT

Page: 3
ID: AC1290

----- END OF BATCH INFORMATION -----

Batch number: 21664 Date of Batch: 1/03/2012

Number of Journals -----

With errors: 0

Without errors: 1

Total: 1

Number of Transactions: 44

FUND TOTALS

Fund	Description	Debit	Credit
00010	GENERAL FUND	29,503.53	29,503.53
		29,503.53	29,503.53

----- END OF JOB INFORMATION -----

Number of Journals	-----
With errors:	0
Without errors:	1
Total:	1

Number of Transactions: 44

FUND TOTALS

Fund	Description	Debit	Credit
00010	GENERAL FUND	29,503.53	29,503.53
		29,503.53	29,503.53

End of Report - 12.35.33

B A T C H I N F O R M A T I O N

Batch number: 21665 Date of Batch: 1/03/2012 Batch Totals Debit Credit
 User ID: KJK
 Re-entry date: 22,254.25 22,254.25
 Re-entry User ID:
 Closing date: 12/31/2011

DK BUDGET TRANSF. FOR 12/31/11 BY FUNCT
December 31, 2011

Date	Refer-ence	Account number	Account title	Description	Amount	Refer-ence
12/31/2011	INTTR	10-2360-550-000-00-00-02	SUPT., PRINTING/BIND.	TO 2310-550-01	200.00	00CR
12/31/2011	INTTR	10-2310-550-000-00-00-01	BOARD SERVICE, PRINTING/BINDING	FROM 2360-550-02	200.00	
12/31/2011	INTTR	10-2830-300-000-00-00-03	PERSONNEL, CONTRACT SERVICE	TO 2835-300	100.00	00CR
12/31/2011	INTTR	10-2835-300-000-00-00-03	MEDICAL SVCS. STAFF EXAM/TESTS	FROM 2830-300	100.00	
12/31/2011	INTTR	10-2620-610-000-30-51-24	EHN CUST. SUPPLIES	TO 1100-761-40	250.00	00CR
12/31/2011	INTTR	10-1100-761-000-30-51-40	F&CS, EHN, INSTR. REPH. EQUIP>2500	FROM 2620-610-24	250.00	
12/31/2011	INTTR	10-2380-580-000-30-32-32	JTL, PRIN., CONFERENCES	TO 2834	2,500.00	00CR
12/31/2011	INTTR	10-2834-580-000-30-32-32	TECH. ED. EHS, SUPPLIES	FROM 2380	2,500.00	
12/31/2011	INTTR	10-1100-610-000-30-31-41	ITEC, GENERAL SUPPLIES	TO 2840-610-06	149.25	25CR
12/31/2011	INTTR	10-2840-610-000-30-31-41	MATH, EHN, TECH SUPPLIES	FROM 1100-610-41	149.25	
12/31/2011	INTTR	10-1100-618-000-30-51-43	MATH, EHN, CERT/INSTR. CONF.	TO 2271-580	570.00	00CR
12/31/2011	INTTR	10-1100-640-000-30-31-43	MATH, EHS, BOOKS/PERIODICALS	FROM 1100-618	570.00	
12/31/2011	INTTR	10-2840-618-000-30-31-43	ITEC, TECH SUPPLIES	TO 2840-618-06	1,200.00	00CR
12/31/2011	INTTR	10-3200-810-000-30-32-44	BAND, JTL, DUES & FEES	FROM 1100-610	1,200.00	
12/31/2011	INTTR	10-1100-610-000-30-32-44	MUSIC, INSTR, JTL, SUPPLIES	TO 3200-810	400.00	00CR
12/31/2011	INTTR	10-1100-400-000-30-32-44	MUSIC, INSTR, JTL, PROP. SERVICE	FROM 3200-810	400.00	
12/31/2011	INTTR	10-3200-610-000-30-32-44	BAND, JTL, SUPPLIES	TO 1100-400	100.00	00CR
12/31/2011	INTTR	10-3200-610-000-30-51-44	MUSIC, INSTR, EHN, TECH SUPPLIES	FROM 1100-618	100.00	
12/31/2011	INTTR	10-1100-618-000-30-51-44	CHORUS, EHN, INSTR. TECH SOFTWARE	TO 2271-580	212.00	00CR
12/31/2011	INTTR	10-3200-650-000-30-51-45	MUSIC, VOCAL, EHN, INST/CERT. CONF.	FROM 3200-650	212.00	
12/31/2011	INTTR	10-3271-580-000-30-51-45	CHORUS, EHN, SUPPLIES	TO 2271-580-52-45	700.00	00CR
12/31/2011	INTTR	10-3200-610-000-30-51-45	MUSIC, VOCAL, LIS, CERT. CONFERENC	FROM 3200-610-51-45	400.00	
12/31/2011	INTTR	10-2271-580-000-30-52-48	SCIENCE, EHN, BOOKS/PERIODICALS	TO 2271-580	400.00	
12/31/2011	INTTR	10-1100-640-000-30-51-48	SCIENCE, EHN, INSTR/CERTIF. CONF.	FROM 1100-640	525.00	00CR
12/31/2011	INTTR	10-2271-580-000-30-51-48	LIFE SKILLS, ELEM, BOOKS/PERIOD.	TO 1211-610	525.00	
12/31/2011	INTTR	10-1211-610-320-10-00-50	LIFE SKILLS, ELEM, SUPPLIES	FROM 1211-610	11,505.00	00CR
12/31/2011	INTTR	10-1231-640-320-10-00-50	EMOT. SUP., ELEM, BOOKS/PERIODIC.	TO 1211-650	11,505.00	
12/31/2011	INTTR	10-1211-650-320-10-00-50	LIFE SKILLS, ELEM, INSTR. TECH SU	FROM 1231-640	2,763.00	00CR
12/31/2011	INTTR	10-2290-610-000-20-00-50	SPEC. ED. ADMIN, SUPPLIES	TO 1241-618	80.00	00CR
12/31/2011	INTTR	10-1241-618-320-20-00-50	LEARN. SUP., INT. TECH SUPPLIES	FROM 2290-610	80.00	
12/31/2011	INTTR	10-2380-530-000-30-51-51	EHN, PRIN., POSTAGE/TELEPHONE	TO 2834-580	600.00	00CR
12/31/2011	INTTR	10-2834-580-000-30-51-51	EHN, PRIN., CERT/N-INSTR. CONF.	FROM 2380-530	600.00	

INTTR

Jan 03, 2012

001 East Stroudsburg Area School District
BUDGET TRANSFERS EDIT

Page: 2
ID: AC1290

DK BUDGET TRANSF. FOR 12/31/11 BY FUNCT
December 31, 2011

(continued)

Date	Refer- -ence	Account number	Account title	Description	Amount	Refer -ence
------	-----------------	----------------	---------------	-------------	--------	----------------

				Total:	.00	
				Debits:	22,254.25	
				Credits:	22,254.25	

34			Transactions			
0			Unbalanced references			

----- END OF BATCH INFORMATION -----

Batch number: 21665 Date of Batch: 1/03/2012

Number of Journals -----

With errors: 0

Without errors: 1

Total: 1

Number of Transactions: 34

FUND TOTALS

Fund	Description	Debit	Credit
00010	GENERAL FUND	22,254.25	22,254.25
		22,254.25	22,254.25

Jan 03, 2012

001 East Stroudsburg Area School District
BUDGET TRANSFERS EDIT

Page: 4
ID: AC1290

----- END OF JOB INFORMATION -----

Number of Journals	-----
With errors:	0
Without errors:	1
Total:	1

Number of Transactions: 34

FUND TOTALS

Fund	Description	Debit	Credit
00010	GENERAL FUND	22,254.25	22,254.25
		22,254.25	22,254.25

End of Report - 12.54.01

98

B A T C H I N F O R M A T I O N

Batch number: 21780 Date of Batch: 1/19/2012 Batch Totals Debit Credit
User ID: KJK Re-entry date: 83,332.28 83,332.28
Re-entry User ID: Closing date: 1/31/2012

DK BUDGET TRANSFERS BY OBJECT 1/23/12
January 23, 2012

Date	Refer- -ence	Account number	Account title	Description	Amount	Refer- -ence
1/23/2012	INNTR	10-2840-348-000-00-00-06	I TEC, DISTRICT, TECHNICAL SVCS	TO 438	35,250.00CR	
1/23/2012	INNTR	10-2840-438-000-00-00-06	I TEC, MAINTAIN/UPGRADE INFOSYS	FROM 348	35,250.00	
1/23/2012	INNTR	10-2840-610-000-00-00-06	I TEC, GENERAL SUPPLIES	TO 618	150.24	
1/23/2012	INNTR	10-2840-618-000-00-00-06	I TEC, TECH SUPPLIES	FROM 610	150.24	
1/23/2012	INNTR	10-2700-626-000-00-00-07	TRANSPORTATION, GASOLINE/OIL	TO 400	20,000.00CR	
1/23/2012	INNTR	10-2700-400-000-00-00-07	TRANSPORTATION, CONT. MAINT.	FROM 626	20,000.00	
1/23/2012	INNTR	10-2700-650-000-00-00-07	TRANSPORTATION, TECH BOOKS	TO 750	24,700.00CR	
1/23/2012	INNTR	10-2700-750-000-00-00-07	TRANSPORTATION, NEW EQUIPMENT	FROM	24,700.00	
1/23/2012	INNTR	10-2420-550-000-10-17-39	MEDICAL, ESE, PRINTING	TO 640	86.70CR	
1/23/2012	INNTR	10-2420-640-000-10-17-39	MEDICAL, ESE, BOOKS/PERIODICALS	FROM 550	86.70	
1/23/2012	INNTR	10-1100-610-000-10-10-44	MUSIC, INSTR, RES, SUPPLIES	TO 750	76.00CR	
1/23/2012	INNTR	10-1100-750-000-10-10-44	MUSIC, INSTR, RES, NEW EQUIPMENT	FROM 610	76.00	
1/23/2012	INNTR	10-1100-400-000-30-52-44	MUSIC, INSTR, LIS, PROPERTY SVC	TO 750	436.00CR	
1/23/2012	INNTR	10-1100-750-000-30-52-44	MUSIC, INSTR, LIS, NEW EQUIPMENT	FROM 400	436.00	
1/23/2012	INNTR	10-2290-750-000-20-00-50	SPEC. ED. INT. NEW EQUIP.	TO 650	63.34CR	
1/23/2012	INNTR	10-2290-650-000-20-00-50	SPEC. ED., INTERM. SOFTWARE	FROM 750	63.34	
1/23/2012	INNTR	10-3200-610-000-30-31-61	GEN. ATHL., EHS, SUPPLIES	TO 810	370.00CR	
1/23/2012	INNTR	10-3200-810-000-30-31-61	GEN. ATHL., EHS, DUES & FEES	FROM 610	370.00	
1/23/2012	INNTR	10-2660-581-000-30-31-91	SECURITY, EHS, IN-DIST. MILEAGE	TO 581-32	200.00CR	
1/23/2012	INNTR	10-2660-581-000-30-32-91	SECURITY, JTL, IN-DIST. MILEAGE	FROM 581-31	200.00	
1/23/2012	INNTR	10-2660-444-000-30-31-91	SECURITY, EHS, VEHICLE LEASE	TO 610	2,000.00CR	
1/23/2012	INNTR	10-2660-610-000-30-31-91	SECURITY, EHS, SUPPLIES	FROM 444	2,000.00	

Total: .00
Debits: 83,332.28
Credits: 83,332.28

22 Transactions
0 Unbalanced references

----- END OF BATCH INFORMATION -----

Batch number: 21780 Date of Batch: 1/19/2012

Number of Journals	-----	
With errors:	0	
Without errors:	1	Number of Transactions: 22
Total:	1	

FUND TOTALS		
Fund	Description	Debit
00010	GENERAL FUND	83,332.28
		83,332.28
		83,332.28

----- END OF JOB INFORMATION -----

Number of Journals	-----
With errors:	0
Without errors:	1
Total:	1

Number of Transactions: 22

FUND TOTALS

Fund	Description	Debit	Credit
00010	GENERAL FUND	83,332.28	83,332.28
		83,332.28	83,332.28

End of Report - 9.07.54

----- B A T C H I N F O R M A T I O N -----
 Batch number: 21782 Date of Batch: 1/19/2012 Batch Totals Debit Credit
 User ID: KJK Re-entry date: 11,138.28 11,138.28 11,138.28
 Re-entry User ID: Closing date: 1/31/2012

DK BUDGET TRANSFERS BY FUNCTION 1/23/12
 January 23, 2012

Date	Refer-ence	Account number	Account title	Description	Amount	Refer-ence
1/23/2012	INNTR	10-2272-580-000-10-10-10	RES, NON CERTIFIED	TO 2271	1,000.00	CR
1/23/2012	INNTR	10-2371-580-000-10-10-10	RES, INSTR./CERT CONFERENCE	FROM 2272	1,000.00	CR
1/23/2012	INNTR	10-2380-610-000-10-14-14	MSE, PRIN., GENERAL SUPPLIES	TO 1100-640	539.38	CR
1/23/2012	INNTR	10-1100-640-000-10-14-14	MSE, INSTR., BOOKS/PERIODICALS	FROM 2380-610	539.38	CR
1/23/2012	INNTR	10-2380-610-000-10-14-14	MSE, PRIN., GENERAL SUPPLIES	TO 1100-610	655.16	CR
1/23/2012	INNTR	10-1100-610-000-10-14-14	MSE, INSTR., SUPPLIES	FROM 2380-610	655.16	CR
1/23/2012	INNTR	10-1100-581-000-10-14-14	MSE, INSTR., IN-DISTRICT MILEAGE	TO 2380-610	500.00	CR
1/23/2012	INNTR	10-2380-610-000-10-14-14	MSE, PRIN., GENERAL SUPPLIES	FROM 1100-581	500.00	CR
1/23/2012	INNTR	10-3200-751-000-30-51-44	BAND, EHN, NEW EQUIPMENT>\$2500	TO 1100-751	2,032.00	CR
1/23/2012	INNTR	10-1100-751-000-30-51-44	MUSIC, INSTR, EHN, NEW EQUIP>2500	FROM 3200-751	2,032.00	CR
1/23/2012	INNTR	10-3200-751-000-30-51-44	BAND, EHN, NEW EQUIPMENT>\$2500	TO 3200-810	500.00	CR
1/23/2012	INNTR	10-3200-810-000-30-51-44	BAND, EHN, DOES & FEES	FROM 3200-751	500.00	CR
1/23/2012	INNTR	10-3200-751-000-30-51-44	BAND, EHN, NEW EQUIPMENT>\$2500	TO 1100-610	1,010.00	CR
1/23/2012	INNTR	10-1100-610-000-30-51-44	MUSIC, INSTR, EHN, SUPPLIES	FROM 33200-751	1,010.00	CR
1/23/2012	INNTR	10-1100-750-000-30-31-44	MUSIC, INSTR, EHS, NEW EQUIPMENT	TO 3200-750	3,810.00	CR
1/23/2012	INNTR	10-3200-750-000-30-31-44	BAND, EHS, NEW EQUIPMENT	FROM 1100-750	156.72	CR
1/23/2012	INNTR	10-2290-640-000-20-00-50	SPEC. ED. SUPV. INT. BOOKS/PERIOD.	TO 1211-640-320	156.72	CR
1/23/2012	INNTR	10-1211-640-320-20-00-50	SPEC. ED. LIFE SKILLS TEXTBOOKS	FROM 2290-640	35.00	CR
1/23/2012	INNTR	10-2290-610-000-20-00-50	SPEC. ED. ADMIN, SUPPLIES	TO 2290-442	900.00	CR
1/23/2012	INNTR	10-2290-442-000-20-00-50	SPEC. ED. SUPV. INT., EQUIP. RENTAL	FROM 2290-610	900.00	CR
1/23/2012	INNTR	10-2290-750-000-20-00-50	SPEC. ED. INT. NEW EQUIP.	TO 2290-618	35.00	CR
1/23/2012	INNTR	10-2290-618-000-20-00-50	SPEC. ED. ADMIN TECH SUPPLIES	FROM 2290-750	900.00	CR
1/23/2012	INNTR	10-3200-610-000-30-52-61	GEN. ATHL., LIS, SUPPLIES	TO 2271-580	900.00	CR
1/23/2012	INNTR	10-2271-580-000-30-52-61	GEN. ATHL., LIS, CERT/INSTR. CONF.	FROM 3200-610	900.00	CR

Total: .00
 Debits: 11,138.28
 Credits: 11,138.28

24 Transactions
 0 Unbalanced references

102

Jan 19, 2012

001 East Stroudsburg Area School District
BUDGET TRANSFERS EDIT

Page: 2
ID: AC1290

----- E N D O F B A T C H I N F O R M A T I O N -----

Batch number: 21782 Date of Batch: 1/19/2012

Number of Journals -----

With errors: 0

Without errors: 1

Total: 1

Number of Transactions: 24

F U N D T O T A L S

Fund	Description	Debit	Credit
00010	GENERAL FUND	11,138.28	11,138.28
		11,138.28	11,138.28

----- END OF JOB INFORMATION -----

Number of Journals -----
 With errors: 0
 Without errors: 1
 Total: 1

Number of Transactions: 24

FUND TOTALS

Fund	Description	Debit	Credit
00010	GENERAL FUND	11,138.28	11,138.28
		11,138.28	11,138.28

End of Report - 9.24.02

Bank: 11 PNC Bank (Concentration)

Check no.	Check Date	Vendor name and comment	Amount
191042	12/01/2011	ABE FENCE, INC. GEN.MAINT., SMI, SUPPLIES	1,167.67
191043	12/01/2011	ASPEN PEST SERVICES, LLC EHN, CUST., EXTERMINATION SERV.	649.90
191044	12/01/2011	AVENUE 365 - PA ESCROW Misc.Revenues-Bank Adj.Taxes	396.05
191045	12/01/2011	BALLARD AND TIGHE TITLE III, BOOKS	734.40
191046	12/01/2011	BANKS' VACUUM SALES AND SERVICE JTL, CUST., SUPPLIES	418.24
191047	12/01/2011	JAMES H. BASS RES, CUST., IN-DISTRICT MILEAGE	6.66
191048	12/01/2011	TIMOTHY BEIGHLEY Misc.Revenues-Bank Adj.Taxes	24.23
191049	12/01/2011	ERIC BELL SEPTIC SYSTEMS, INC. SEWER PLANT, DISPOSAL SERVICES	1,550.00
191050	12/01/2011	KYLE BENTZONI MSE, CUST., MILEAGE	14.43
191051	12/01/2011	BETHLEHEM AREA SCHOOL DISTRICT 3RD.PT.DEAF/HEAR IMP.TUITION	5,343.79
191052	12/01/2011	HOLLY BURNS GIFTED, ELEM, MILEAGE	43.57
191053	12/01/2011	JOHN BURRUS SMI, PRIN., IN-DISTRICT MILEAGE	59.94
191054	12/01/2011	CAPITAL AREA INTERMEDIATE UNIT ACCOUNTABILILTY CERT/INST.CONF	100.00
191055	12/01/2011	LOUIS CARBAJAL ITEC, DIST, N-INSTR/N-CERT.CONF.	48.11
191056	12/01/2011	CARBON LEHIGH IU #21 TITLE III, CONFERENCES	150.00
191057	12/01/2011	BWP CARQUEST AUTO PARTS TRANSPORTATION, REPAIRS & PARTS	34.12
191058	12/01/2011	GIOVANNY GONZALEZ CARRILLO Misc.Revenues-Bank Adj.Taxes	51.55
191059	12/01/2011	CENTRAL SUSQUEHANNA INTERMEDIATE UNIT 3RD.PART/ALT.SPEC.ED SEC.	1,437.50
191060	12/01/2011	CLEAR CUT AWARDS CURRICULUM, GENERAL SUPPLIES	87.75
191061	12/01/2011	COLONIAL INTERMEDIATE UNIT 20 TITLE 1, PRINTING/BINDING	4,990.85
191062	12/01/2011	COMMONWEALTH OF PENNSYLVANIA GEN.MAINT., DUES & FEES	35.00
191063	12/01/2011	COMMONWEALTH OF PENNSYLVANIA GEN.ATHL., EHS, DUES & FEES	10.00
191064	12/01/2011	COMPUTER DISCOUNT WAREHOUSE TECH.ED., EHN, SOFTWARE/VIDEOS	4,732.88
191065	12/01/2011	CLAUDE S. CYPHERS, INC. TRANSPORTATION, REPAIRS & PARTS	16.17

Bank: 11 PNC Bank (Concentration)

Check no.	Check Date	Vendor name and comment	Amount
191066	12/01/2011	JOSEPH CZAJKOWSKI SECURITY, JTL, IN-DIST. MILEAGE	29.97
191067	12/01/2011	D & H DISTRIBUTING COMPANY MATH, EHN, SUPPLIES	1,307.76
191068	12/01/2011	DEVELOPMENTAL EDUCATION SERVICES EHS, CUST., DISPOSAL SERVICE	550.00
191069	12/01/2011	SUSAN EDEN GIFTED ELEM CERTIF/INSTR. CONF	62.99
191070	12/01/2011	EDWARDS BUSINESS SYSTEMS BES, PRIN., EQUIPMENT RENTAL	698.31
191071	12/01/2011	EDWARDS BUSINESS SYSTEMS TECH. ED., EHN, PROPERTY SERVICE	111.58
191072	12/01/2011	EVERGREEN COMMUNITY CHARTER SCHOOL CHARTER/CYBER SCHOOLS- REG. ED.	7,883.10
191073	12/01/2011	EXELON ENERGY COMPANY BUS GARAGE, ELECTRIC	12.09
191074	12/01/2011	THE EXPRESS TIMES BOARD SERVICE, ADVERTISING	448.40
191075	12/01/2011	PATRICIA D FARMER PERSONNEL, MILEAGE	31.08
191076	12/01/2011	BRAD FITZPATRICK ADMIN. SYS., IN-DIST. MILEAGE	134.87
191077	12/01/2011	FOLLETT LIBRARY RESOURCES LIBRARY, EHN, BOOKS/PERIODICALS	2,026.13
191078	12/01/2011	CATHLEEN A. SCHULTZ GUIDANCE, RES, MILEAGE	10.82
191079	12/01/2011	SARAH FRIES GUIDANCE, ESE, N-INSTR/CERT. CONF	24.98
191080	12/01/2011	FRONTIER JTL, CUST., TELEPHONE	82.13
191081	12/01/2011	JOSHUA FULLER Accounts Payable-Donations	143.00
191082	12/01/2011	LUIGI GENTILE Misc. Revenues-Bank Adj. Taxes	38.66
191083	12/01/2011	GLOGSTER ITEC, TECH BOOKS & PERIODICALS	1,699.00
191084	12/01/2011	GPS CITY SECURITY, EHS, SUPPLIES	45.16
191085	12/01/2011	GREGORY GRAHAM PIANO SERVICE MUSIC, VOCAL, RES, PROP. SERVICE	110.00
191086	12/01/2011	GTM SPORTSWEAR BASKETBALL, JTL, GIRLS, SUPPLIES	1,107.00
191087	12/01/2011	HAAN CRAFTS F&CS, LIS, SUPPLIES	1,480.13
191088	12/01/2011	ELBA I HAGGERTY Misc. Revenues-Bank Adj. Taxes	4.00
191089	12/01/2011	BRIAN T HANNAN Misc. Revenues-Bank Adj. Taxes	30.00

Bank: 11 PNC Bank (Concentration)

Check no.	Check Date	Vendor name and comment	Amount
191090	12/01/2011	HILLTOP SALES & SERVICE JTL, CUST., SUPPLIES	352.00
191091	12/01/2011	NICK HOFFMANN ITEC, DIST, N-INSTR/N-CERT. CONF.	186.43
191092	12/01/2011	KIMBERLY A. HOLCOMB TRANSPORTATION, IN-DIST.MILEAGE	104.34
191093	12/01/2011	LYNDA HOPKINS SPEC.ED.SUPV., SEC., MILEAGE	417.74
191094	12/01/2011	IPS LASER EXPRESS CUSTODIAL SVCS, SUPPLIES	318.00
191095	12/01/2011	KAST-A-WAY SWIMWEAR SWIMMING, EHN, SUPPLIES	565.43
191096	12/01/2011	KELVIN ELECTRONICS SCIENCE, LIS, SUPPLIES	33.95
191097	12/01/2011	KING, SPRY, HERMAN, FREUND & FAUL, LLC SPECIAL PROJECTS, PROF.CONTRACT	625.00
191098	12/01/2011	SCOTT KRUEGERS SHEET METAL GEN.MAINT., EHN, SUPPLIES	20.00
191099	12/01/2011	LEVIN LEGAL GROUP LEGAL SVCS., SPECIAL EDUCATION	935.00
191100	12/01/2011	LOSER'S MUSIC, INC. MUSIC, INSTR, JTL, SUPPLIES	565.95
191101	12/01/2011	M&T INVESTMENT GROUP INVESTMENT MANAGEMENT FEES	780.00
191102	12/01/2011	EDWIN MALAVE ITEC, DIST, N-INSTR/N-CERT. CONF.	338.91
191103	12/01/2011	MARTZ TRAILWAYS BAND, EHN, CONTR. TRANSPORTATION	2,450.00
191104	12/01/2011	J.P. MASCARO & SONS, INC. EHS, CUST., DISPOSAL SERVICE	15,894.08
191105	12/01/2011	MASTER CHEMICAL PRODUCTS, INC. SMI, CUST., SUPPLIES	182.81
191106	12/01/2011	MAYER-JOHNSON ESL, TITLE III, SEC., SUPPLIES	163.06
191107	12/01/2011	MCM ELECTRONICS INC. TECH.ED., EHS, SUPPLIES	444.10
191108	12/01/2011	MENTORING MINDS SPEC.ED.SUPV., SEC., SUPPLIES	368.83
191109	12/01/2011	MET-ED JTL, CUST., ELECTRIC	4,498.12
191110	12/01/2011	METUCHEN CENTER, INC. BASKETBALL, LIS, GIRLS, BID SUPPL	1,920.42
191111	12/01/2011	LORIANN MEYERS GUIDANCE, BES, MILEAGE	23.87
191112	12/01/2011	MODERN SCHOOL SUPPLIES, INC. TECH.ED., EHS, SUPPLIES	276.88
191113	12/01/2011	MODERNFOLD OF READING, INC. GEN.MAINT., JTL, SUPPLIES	1,000.00

Bank: 11 PNC Bank (Concentration)

Check no.	Check Date	Vendor name and comment	Amount
191114	12/01/2011	MONROE CAREER AND TECHNICAL INSTITUTE MCTI, HS-S, OPERATING BUDGET	155,517.00
191115	12/01/2011	MONROE COUNTY CONTROL CENTER RES, MAINT. REPAIR/MAINT. EQUIP.	2,925.00
191116	12/01/2011	MOUSER ELECTRONICS TECH. ED., EHN, SUPPLIES	253.97
191117	12/01/2011	MR. JOHN, INC. GEN. ATHL., EHS, PROPERTY SERVICE	991.92
191118	12/01/2011	NASCO (Quote # 4 5 9 5 0) ART, EHS, BID SUPPLIES	786.72
191119	12/01/2011	NASN MEDICAL, MSE, DUES & FEES	250.00
191120	12/01/2011	NATIONAL COUNCIL OF SUPERVISORS CURRICULUM, DUES & FEES	85.00
191121	12/01/2011	NORTHWEST AREA SCHOOL DISTRICT OOD TUITION PAYABLE	473.50
191122	12/01/2011	OFFICE DEPOT BUSINESS OFFICE, GEN. SUPPLIES	42.81
191123	12/01/2011	OFFICE DEPOT ITEC, GENERAL SUPPLIES	9.96
191124	12/01/2011	OFFICE MAX INCORPORATED CHILD ACCT., SUPPLIES	133.80
191125	12/01/2011	OPTECH TITLE III, SOFTWARE	1,801.32
191126	12/01/2011	OPTIMA INC GEN. MAINT., SEC., SUPPLIES	2,892.87
191127	12/01/2011	MARY ORTA Misc. Revenues-Bank Adj. Taxes	564.13
191128	12/01/2011	JONATHAN OSMUN GUIDANCE, ESE, N-INSTR/CERT. CONF	77.70
191129	12/01/2011	OXFORD UNIVERSITY PRESS MUSIC, VOCAL, MSE, SUPPLIES	34.00
191130	12/01/2011	PENNSYLVANIA CYBER CHARTER SCHOOL CHARTER/CYBER SCHOOLS- REG. ED.	84,111.54
191131	12/01/2011	PENNSYLVANIA LEADERSHIP CHARTER SCHOOL CHARTER/CYBER SCHOOL-SPEC. ED.	7,565.39
191132	12/01/2011	PENNSYLVANIA ONE CALL SYSTEM, INC. GEN. MAINT., PROPERTY SERVICES	86.45
191133	12/01/2011	PA RURAL WATER ASSOCIATION GEN. MAINT., PROPERTY SERVICES	109.00
191134	12/01/2011	PA TREATMENT & HEALING 3RD. PART/ALT. SPEC. ED SEC.	28,062.98
191135	12/01/2011	MANVEL R PAGE ITEC, DIST, N-INSTR/N-CERT. CONF.	44.38
191136	12/01/2011	PARENTS MAGAZINE F&CS, EHS, SUPPLIES	12.00
191137	12/01/2011	PARKLAND SCHOOL DISTRICT 3RD. PART/EMOT. SUP/PUBLIC/TUITI	3,508.65

Bank: 11 PNC Bank (Concentration)

Check no.	Check Date	Vendor name and comment	Amount
191138	12/01/2011	PA ASSOCIATION OF SCHOOL ADMINSTRATORS SUPT. ,CERT/N.INSTR.CONFERENCE	195.00
191139	12/01/2011	PA DISTANCE LEARNING CHARTER SCHOOL CHARTER/CYBER SCHOOLS- REG.ED.	788.31
191140	12/01/2011	PENTELEDATA ITEC, INTERNET ACCESS	27,419.68
191141	12/01/2011	J.W.PEPPER & SONS-ACCT.#36-136400 BAND, EHS, SUPPLIES	90.00
191142	12/01/2011	PETROLEUM TRADERS CORP. TRANSPORTATION, SOUTH, DIESEL	26,371.08
191143	12/01/2011	PITNEY BOWES INC. OTHER ADMN.SER. , EQUIP.RENTAL	207.00
191144	12/01/2011	PITNEY BOWES JTL, PRIN. , PROPERTY SERVICE	1,282.62
191145	12/01/2011	PLEASANT VALLEY SCHOOL DISTRICT 3RD.PART/EMOT.SUP/PUBLIC/TUITI	206.15
191146	12/01/2011	POSTMASTER RES, PRIN. , POSTAGE/TELEPHONE	88.00
191147	12/01/2011	PRESTWICK HOUSE ENGLISH, EHN, BOOKS/PERIODICALS	357.97
191148	12/01/2011	RAY PRICE STROUD FORD TRANSPORTATION, REPAIRS & PARTS	12.97
191149	12/01/2011	QUARTERMASTER UNIFORM COMPANY SECURITY, EHS, SUPPLIES	1,063.31
191150	12/01/2011	QUILL CORPORATION LIS, PRIN. , GENERAL SUPPLIES	221.85
191151	12/01/2011	SUSANNE S RASELY-PHILIPPS VIRTUAL ACADEMY, INSTR/CERT.CON	209.11
191152	12/01/2011	READING SCHOOL DISTRICT 3RD.PART/EMOT.SUP/PUBLIC/TUITI	3,080.00
191153	12/01/2011	CAROLINA RODRIGUEZ BUSINESS OFFICE, IN-DISTR.MILES	16.97
191154	12/01/2011	SAFEGUARD BUSINESS SYSTEMS BUSINESS OFFICE, PRINTING	249.75
191155	12/01/2011	SALISBURY TOWNSHIP SCHOOL DISTRICT 3RD.PART/EMOT.SUP/PUBLIC/TUITI	2,294.76
191156	12/01/2011	SCHOLASTIC MAGAZINES JTL, 6TH, BOOKS/PERIODICALS	275.55
191157	12/01/2011	SCHOLASTIC INC. RES, INSTR, SUPPLIES	43.20
191158	12/01/2011	CHECK VOIDED	
191159	12/01/2011	GLORIA SCHULTE LEARN.SUP. , ELEM, MILEAGE	9.99
191160	12/01/2011	POCONO SEW & VAC F&CS, JTL, SUPPLIES	80.06
191161	12/01/2011	AUGUSTO & LUCILIA SILVA Real Estate Refunds, Price	2,333.65
191162	12/01/2011	DEAN & CARA SLONAKER Misc.Revenues-Bank Adj.Taxes	244.82

Bank: 11 PNC Bank (Concentration)

Check no.	Date	Vendor name and comment	Amount
191163	12/01/2011	SWIFT FIRE PROTECTION, INC. BES, CUST., SUPPLIES	304.30
191164	12/01/2011	TRANE U.S. INC. MAINT., ESE, PROPERTY SERVICE	1,772.05
191165	12/01/2011	TSA CONSULTING GROUP, INC. BUSINESS OFFICE, PROF. CONTR. SVC	614.00
191166	12/01/2011	UGI ENERGY SERVICES, INC. JMH, CUST., NATURAL GAS	2,380.69
191167	12/01/2011	UNIVERSITY MUSIC SERVICE CHORUS, JTL, SUPPLIES	88.48
191168	12/01/2011	ELYSE M. VITCHERS BES, INST., IN-DISTRICT MILEAGE	14.71
191169	12/01/2011	WALMART COMMUNITY/GEMB SCIENCE, EHS, SUPPLIES	981.25
191170	12/01/2011	WEIS MARKET, INC. F&CS, EHS, SUPPLIES	232.79
191171	12/01/2011	CORINNE WESELOH JMH, PRIN., IN-DISTRICT MILEAGE	23.31
191172	12/01/2011	THOMAS F. DIRVONAS LEGAL SVCS., NON-RETAINER	247.62
191173	12/01/2011	POSTMASTER TAX COLLECTION, POSTAGE	835.56
191174	12/01/2011	POSTMASTER TAX COLLECTION, POSTAGE	486.64
191175	12/01/2011	POSTMASTER TAX COLLECTION, POSTAGE	236.72
191176	12/01/2011	SCHOLASTIC MAGAZINES JMH, INSTR, SUPPLIES	397.38
191177	12/02/2011	AMERICAN VALUATION GROUP INC. TAX COLLECTION, PROF. CONTR. SVCS	15,000.00
191178	12/07/2011	AMERICAN TIME RECORDER EHS, PRIN., GENERAL SUPPLIES	595.00
191179	12/08/2011	CHECK VOIDED	
191180	12/08/2011	CHECK VOIDED	
191181	12/08/2011	CHECK VOIDED	
191182	12/08/2011	CHECK VOIDED	
191183	12/08/2011	CHECK VOIDED	
191184	12/08/2011	CHECK VOIDED	
191185	12/08/2011	CHECK VOIDED	
191186	12/08/2011	CHECK VOIDED	
191187	12/08/2011	CHECK VOIDED	
191188	12/08/2011	CHECK VOIDED	
191189	12/08/2011	CHECK VOIDED	
191190	12/08/2011	AAHPERD PHYS. ED., JTL, DUES/FEES.	160.00
191191	12/08/2011	AED SUPERSTORE SPECIAL PROJECTS, GEN. SUPPLIES	750.45
191192	12/08/2011	ALL PHASE ELECTRIC C.E.D GEN. MAINT., JTL, SUPPLIES	203.82

Bank: 11 PNC Bank (Concentration)

Check no.	Check Date	Vendor name and comment	Amount
191193	12/08/2011	AMERICAN THERMOPLASTIC CO TECH. ED., EHN, SUPPLIES	289.33
191194	12/08/2011	ANGELA M NEVIN TRANSPORTATION, IN-DIST. MILEAGE	44.40
191195	12/08/2011	ACCESS CREDENTIAL SYSTEM LLC SECURITY, EHS, TECH SUPPLIES	733.50
191196	12/08/2011	BANKS' VACUUM SALES AND SERVICE JTL, CUST., SUPPLIES	488.87
191197	12/08/2011	BAUDVILLE CURRICULUM, GENERAL SUPPLIES	35.45
191198	12/08/2011	JUDE BOUGHTON MUSIC, INSTR, EHN, PROF. CONTR. SVC	1,500.00
191199	12/08/2011	BRODHEAD GARRETT TECH. ED., EHS, BID SUPPLIES	171.17
191200	12/08/2011	MARK BROWN GEN. ATHL., EHS, MILEAGE	290.28
191201	12/08/2011	KRISTEN A BUEKI BES, INST., IN-DISTRICT MILEAGE	14.71
191202	12/08/2011	ADAM BURDETT MUSIC, INSTR, EHN, PROF. CONTR. SVC	2,500.00
191203	12/08/2011	LAURIE BURDETT BAND, EHN, CONTRACT SVCS.	1,900.00
191204	12/08/2011	MARY L. BURKE OUT-OF-DIST-PLACEMENT, MILEAGE	260.30
191205	12/08/2011	JOHN BURRUS SMI, PRIN., IN-DISTRICT MILEAGE	99.62
191206	12/08/2011	BUS PARTS WAREHOUSE TRANSPORTATION, GEN. SUPPLIES	177.26
191207	12/08/2011	ANGELA M. BYRNE ACCOUNTABILITY, MILEAGE	28.86
191208	12/08/2011	BWP CARQUEST AUTO PARTS TRANSPORTATION, REPAIRS & PARTS	228.84
191209	12/08/2011	MARIALENA CASCIOTTA SPEC. ED. SUPV., ELEM., CONFERENCE	79.92
191210	12/08/2011	MICHAEL CATRILLO EHS, PRIN., IN-DISTRICT MILEAGE	93.24
191211	12/08/2011	CENTER CITY PLUMBING SUPPLIES GEN. MAINT., SMI, SUPPLIES	166.35
191212	12/08/2011	CERTIFIED CHEMICAL CO. JTL. CUST., REPAIR/MAINT. EQUIP.	1,314.36
191213	12/08/2011	DAWN CHIGHIZOLA LIBRARY, SMI, IN-DIST. MILEAGE	13.32
191214	12/08/2011	CLEAR CHOICE GLASS AND MIRROR TRANSPORTATION, REPAIRS & PARTS	144.00
191215	12/08/2011	COLLEGE BOARD PUBLICATIONS MATH, EHN, BOOKS/PERIODICALS	41.00
191216	12/08/2011	COLONIAL INTERMEDIATE UNIT 20 COL. IU20/PHYSICAL SUPPORT, SEC.	407,357.72

Bank: 11 PNC Bank (Concentration)

Check no.	Check Date	Vendor name and comment	Amount
191217	12/08/2011	COLT PLUMBING SPECIALTIES GEN.MAINT., EHN, SUPPLIES	2,919.00
191218	12/08/2011	COMMITTEE FOR CHILDREN PUPIL SVCS, ELEM, BOOKS/PERIODIC	1,593.23
191219	12/08/2011	COMPUTER DISCOUNT WAREHOUSE TL.1, READING, ED SOFTWARE	3,861.93
191220	12/08/2011	COUNCIL FOR EXCEPTIONAL CHILDREN SPEC.ED.SUPV., ELEM., DUES/FEES	201.00
191221	12/08/2011	CRAFT OIL CORPORATION TRANSPORTATION, GASOLINE/OIL	92.15
191222	12/08/2011	CRAMER'S HOME CENTER EHS, CUST., SUPPLIES	341.58
191223	12/08/2011	CREATIVE COMPANY LIBRARY, EHS, BOOKS/PERIODICALS	3,080.72
191224	12/08/2011	CREST/GOOD MFG. COMPANY GEN.MAINT., MSE, SUPPLIES	277.02
191225	12/08/2011	COMMUNICATIONS SYSTEMS, INC. MAINT., BES, PROPERTY SERVICE	4,872.38
191226	12/08/2011	DEVEN MIGUEL DAN MUSIC, INSTR, EHN, PROF.CONTR.SVC	300.00
191227	12/08/2011	DECKER EQUIPMENT EHN, PRIN., GENERAL SUPPLIES	742.42
191228	12/08/2011	DEMCO INC LIBRARY, EHS, SUPPLIES	48.93
191229	12/08/2011	DRAMATIC PUBLISHING shipping	8.50
191230	12/08/2011	IRENE DUGGINS CURRICULUM, IN-DISTR.MILEAGE	339.13
191231	12/08/2011	DYNAMITE CASTROL PREMIUM LUBE EXPRESS SECURITY, EHS, CONTR.MAINT.	37.75
191232	12/08/2011	EAST RIVER ENERGY EHN, CUST., OIL	19,879.30
191233	12/08/2011	EMBLEM ENTERPRISES INC. SECURITY, EHS, SUPPLIES	390.36
191234	12/08/2011	EPS/SCHOOL SPECIALTY LITERACY & JMH, INSTR, SUPPLIES	134.75
191235	12/08/2011	EXACT DATA, INC. BUSINESS OFFICE, GEN.SUPPLIES	573.50
191236	12/08/2011	EXELON ENERGY COMPANY JTL, CUST., ELECTRIC	14,359.03
191237	12/08/2011	EYE ON EDUCATION CURRICULUM, ELEM, BOOKS/PERIOD.	69.90
191238	12/08/2011	FASTENAL COMPANY MEDICAL, LIS, SUPPLIES/FIRST AID	442.32
191239	12/08/2011	THE FILING WORKS ACCESS, CONTR.SERVICE	4,415.00
191240	12/08/2011	ERIC D. FORSYTH ADMIN.SYS., IN-DIST.MILEAGE	89.36

Bank: 11 PNC Bank (Concentration)

Check no.	Check Date	Vendor name and comment	Amount
191241	12/08/2011	FRIEDMAN ELECTRIC SUPPLY CO. INC. GEN.MAINT.,SEC.,SUPPLIES	1,937.02
191242	12/08/2011	FRIEDMAN ELECTRIC SUPPLY CO. INC. GEN.MAINT.,ELEM.,SUPPLIES	2,335.36
191243	12/08/2011	FRIEDMAN ELECTRIC SUPPLY CO. INC. GEN.MAINT.,ELEM.,SUPPLIES	1,187.29
191244	12/08/2011	GENERAL BINDING CORPORATION RES,INSTR.,EQUIPMENT RENTAL	232.68
191245	12/08/2011	HAJOCA CORPORATION GEN.MAINT.,ELEM.,SUPPLIES	984.76
191246	12/08/2011	HAJOCA CORPORATION GEN.MAINT.,SEC.,SUPPLIES	61.28
191247	12/08/2011	INDUSTRIAL CONTROLS DISTRIBUTORS LLC GEN.MAINT.,ESE,SUPPLIES	205.00
191248	12/08/2011	KAR BILL ENTERPRISES, INC. GEN.MAINT.,FUELS	4,499.17
191249	12/08/2011	KAR BILL ENTERPRISES, INC. TRANSPORTATION,GASOLINE/OIL	5,959.10
191250	12/08/2011	LINDA KERN STAFF DEV.,SEC.,CONF (Teachers)	25.00
191251	12/08/2011	ERIC KERSTETTER SMI,PRIN.,IN-DISTRICT MILEAGE	5.83
191252	12/08/2011	KOCH HOLDINGS INC. DBA MILHAM FORD GEN.MAINT.,REPLACE.EQUIPMENT	17,500.00
191253	12/08/2011	KATHY KROLL BUSINESS OFFICE,DEDUCTIBLE	14.15
191254	12/08/2011	SCOTT KRUEGERS SHEET METAL GEN.MAINT.,SMI,SUPPLIES	87.15
191255	12/08/2011	SHARON LAVERDURE SUPT., MILEAGE	72.31
191256	12/08/2011	IRENE C. LIVINGSTON ESE,PRIN.,IN-DISTRICT MILEAGE	65.49
191257	12/08/2011	EDWIN MALAVE ITEC,IN-DISTRICT MILEAGE	132.09
191258	12/08/2011	MARTIN'S SEPTIC SERVICE MAINT.,SMI,PROPERTY SERVICE	650.00
191259	12/08/2011	DARYLE MILLER GEN.MAINT.,IN-DISTRICT MILEAGE	165.95
191260	12/08/2011	NEW HORIZONS COMPUTER LEARNING CENTERS ITEC,DIST,N-INSTR/N-CERT.CONF.	5,900.00
191261	12/08/2011	HUGH O'BRIAN YOUTH LEADERSHIP GUIDANCE,EHN,DUES & FEES	150.00
191262	12/08/2011	PA ASSOC ELEM./SEC. SCHOOL PRINCIPALS RES,PRIN.,DUES & FEES	525.00
191263	12/08/2011	PENNSYLVANIA BAR ASSOCIATION MOCK TRIAL,EHS,DUES & FEES	200.00
191264	12/08/2011	JAMES PARTON ESE,INSTR,IN-DISTRICT MILEAGE	3.33

Bank: 11 PNC Bank (Concentration)

Check no.	Check Date	Vendor name and comment	Amount
191265	12/08/2011	PASBO BUSINESS OFF, CERT/N-INST.CONF.	85.00
191266	12/08/2011	PEACHTREE BUSINESS PRODUCTS SECURITY, EHN, SUPPLIES	209.00
191267	12/08/2011	PETROLEUM TRADERS CORP. TRANSPORTATION, NORTH, DIESEL	25,999.66
191268	12/08/2011	PITNEY BOWES INC. SPEC.ED.SUPV.SEC., EQUIP.RENTAL	189.50
191269	12/08/2011	POSTMASTER SUPT., NEWSLETTER POSTAGE	1,611.33
191270	12/08/2011	ANNELLE PREFONTAINE TL.1, GRANTS DIRECTOR, MILEAGE	88.15
191271	12/08/2011	GEORGE PRIMIANO, M.D. PHYSICIAN, EHS, FOOTBALL EXAMS	2,985.00
191272	12/08/2011	PROSSER LABORATORIES, INC. SEWER PLANT, OPERATION SERVICE	418.00
191273	12/08/2011	PA SCHOOL BOARDS ASSOCIATION (PSBA) BOARD SERV, N-CERT/N.INST.CONF.	39.00
191274	12/08/2011	RHODE ISLAND NOVELTY IMPORTERS BES, ACTIVITIES, SUPPLIES	338.40
191275	12/08/2011	S & W TECHNOLOGIES, INC. SECURITY, EHS, CONTR.MAINT.	437.00
191276	12/08/2011	THE SANDONE TIRE & BATTERY TRANSPORTATION, TIRES	7,688.90
191277	12/08/2011	DONALD SANKER MUSIC, INSTR, EHN, PROF.CONTR.SVC	2,600.00
191278	12/08/2011	SCHOOL CLAIMS-ASSURANT SUSPENSE ACCT., LTD INSURANCE	8,549.97
191279	12/08/2011	SCHOOL CLAIMS-ASSURANT SUSPENSE ACCT., LIFE INSURANCE	11,822.51
191280	12/08/2011	SCHOOL HEALTH CORPORATION MEDICAL, MSE, SUPPLIES/FIRST AID	271.59
191281	12/08/2011	SCHOOL SPECIALTY READING, JTL, SUPPLIES	373.15
191282	12/08/2011	JOHN LEON SCHRAM MATH, EHS, SOFTWARE/VIDEOS	495.00
191283	12/08/2011	SCIENTIFIC LEARNING ACCT BLOCK, STAFF DEV CONT SERV	2,150.00
191284	12/08/2011	JONATHAN SEARFOSS MUSIC, INSTR, EHN, PROF.CONTR.SVC	3,000.00
191285	12/08/2011	MAUREEN G. SEIDEL ITEC, IN-DISTRICT MILEAGE	68.54
191286	12/08/2011	MICHELE SHEATS ESE, PRIN., IN-DISTRICT MILEAGE	40.93
191287	12/08/2011	SHRED-IT INC. RES, CUST., DISPOSAL SERVICE	65.28
191288	12/08/2011	KIM STEVENS SPEC.ED.SUPV.INT.MILEAGE	95.46

Bank: 11 PNC Bank (Concentration)

Check no.	Check Date	Vendor name and comment	Amount
191289	12/08/2011	SUN LITHO-PRINT, INC. BUSINESS OFFICE, PRINTING	62.50
191290	12/08/2011	SWIFT FIRE PROTECTION, INC. CUSTODIAL SVCS, SUPPLIES	239.40
191291	12/08/2011	TU-WAY COMMUNICATIONS SECURITY, EHS, EQUIP. REPAIR	180.74
191292	12/08/2011	UNITED WAY OF MONROE COUNTY Accounts Payable-Donations	1,611.95
191293	12/08/2011	UNIVERSITY MUSIC SERVICE CHORUS, EHN, SUPPLIES	3,764.40
191294	12/08/2011	VWR SARGENT WELCH SCIENCE, EHN, SUPPLIES	898.47
191295	12/08/2011	JESSICA WADE ADMIN. SYS., IN-DIST. MILEAGE	16.10
191296	12/08/2011	WEIS MARKET, INC. F&CS, EHS, SUPPLIES	396.06
191297	12/08/2011	SHAWN WESCOTT ITEC, IN-DISTRICT MILEAGE	87.14
191298	12/08/2011	THOMAS WILLIAMS CUSTODIAL SVCS, MILEAGE	49.62
191299	12/08/2011	SUSAN WOLFF BES, INST., IN-DISTRICT MILEAGE	5.82
191300	12/08/2011	XEROX CORPORATION WRR558597	1,140.66
191301	12/08/2011	STEPHEN ZALL EHN, PRIN., IN-DISTRICT MILEAGE	358.91
191302	12/08/2011	CHAPTER 13 TRUSTEE Miscellaneous Deductions	629.60
191303	12/08/2011	ED FOUNDATION OF ES/GENERAL FUND EDUC. FOUNDATION DEDUCTIONS	20.00
191304	12/08/2011	ED FOUNDATION OF ES/SCHOLARSHIP FUND EDUC. FOUNDATION DEDUCTIONS	13.00
191305	12/08/2011	E.S.E.A. ESEA Dues	28,453.60
191306	12/08/2011	EDUCATIONAL CREDIT MANAGEMENT CORP Miscellaneous Deductions	125.58
191307	12/08/2011	HAB-DLT (ER) Miscellaneous Deductions	563.46
191308	12/08/2011	STATE OF NEW JERSEY GROSS INC TAX-NJ 500 NJ State Taxes	792.10
191309	12/08/2011	NYSCSPC (NEW YORK STATE CHILD SUPPORT Miscellaneous Deductions	514.97
191310	12/08/2011	PENNSYLVANIA HIGHER EDUCATION AGENCY Miscellaneous Deductions	888.67
191311	12/08/2011	SOCIAL SECURITY ADMINISTRATION Miscellaneous Deductions	152.72
191312	12/08/2011	U.S. DEPARTMENT OF EDUCATION Miscellaneous Deductions	435.77

Bank: 11 PNC Bank (Concentration)

Check no.	Check Date	Vendor name and comment	Amount
191313	12/08/2011	UNITED STATES TREASURY Miscellaneous Deductions	200.00
191314	12/09/2011	MIDDLE SMITHFIELD TOWNSHIP MSE, CUST., WATER/SEWER	3,180.00
191315	12/09/2011	MIDDLE SMITHFIELD TOWNSHIP Misc.Revenues-Bank Adj.Taxes	3,238.49
191316	12/14/2011	PSERS LEARN.SUP., SEC., RETIREMENT	10.72
191317	12/14/2011	PSERS TRANSPORTATION, RETIREMENT	242.61
191318	12/15/2011	ABC TROPHIES, INC. GEN.ATHL., EHS, SUPPLIES	475.55
191319	12/15/2011	ABINGTON HEIGHTS SCHOOL DISTRICT JTL, ACTIVITIES, DUES & FEES	90.00
191320	12/15/2011	ACDA CHORUS, LIS, DUES & FEES	95.00
191321	12/15/2011	ALLEGHENY INTERMEDIATE UNIT CHARTER/CYBER SCHOOLS- REG.ED.	746.49
191322	12/15/2011	AMERICAN CHORAL DIRECTORS ASSN. MUSIC, VOCAL, EHN, INST/CERT.CONF	225.00
191323	12/15/2011	AMERICAN HOMECARE SUPPLY MEDICAL, SMI, SUPPLIES/FIRST AID	34.00
191324	12/15/2011	APPLIED ARTS PUBLISHERS CURRICULUM, ELEM, BOOKS/PERIOD.	80.00
191325	12/15/2011	ASSOCIATION FOR SUPERVISION EHN, PRIN., DUES & FEES	219.00
191326	12/15/2011	STELLA BARCIA VIRTUAL ACADEMY, TECH.SUP/SOFTW	30.00
191327	12/15/2011	BAUDVILLE TRANSPORTATION, GEN. SUPPLIES	899.40
191328	12/15/2011	BAYARD RUSTIN SCIENCE OLYMPIAD JTL, ACTIVITIES, DUES & FEES	100.00
191329	12/15/2011	KRISTIE BEDARD VIRTUAL ACADEMY, TECH.SUP/SOFTW	30.00
191330	12/15/2011	H.A. BERKHEIMER INC. TAX COLLECTION, PROF.CONTR.SVCS	183.26
191331	12/15/2011	BOROUGH OF EAST STROUDSBURG GEN.MAINT., SEC., PROPERTY SVCS	1,210.00
191332	12/15/2011	BUCKS COUNTY INTERMEDIATE UNIT 3RD.PART/EMOT.SUP/PUBLIC/TUITI	642.00
191333	12/15/2011	KAREN L. BUIS DENTAL, DISTRICT, IN-DISTR.MILES	13.04
191334	12/15/2011	BUSHKILL ELEMENTARY PTO TL.I, PARENT SUPPLIES	60.00
191335	12/15/2011	CASTLE PARK, LLC GUIDANCE, JTL, SUPPLIES	54.60
191336	12/15/2011	CENTER CITY PLUMBING SUPPLIES GEN.MAINT., EHN, SUPPLIES	25.82

Bank: 11 PNC Bank (Concentration)

Check no.	Check Date	Vendor name and comment	Amount
191337	12/15/2011	CENTRAL PENN GAS, INC. EHS, CUST., NATURAL GAS	7,456.74
191338	12/15/2011	JAMES CHIARELLO GEN.MAINT., IN-DISTRICT MILEAGE	155.99
191339	12/15/2011	COLLEGE OF NURSING MEDICAL, JTL, SUPPLIES/FIRST AID	18.00
191340	12/15/2011	COLONIAL INTERMEDIATE UNIT 20 COL.IU20/PHYSICAL SUPPORT, SEC.	284,871.29
191341	12/15/2011	COLONIAL INTERMEDIATE UNIT 20 SPEC.ED.SUPV.INT.CONFERENCE	350.00
191342	12/15/2011	COLONIAL INTERMEDIATE UNIT 20 CURR/FED., CERTIF/N-INSTR.CONF.	106.00
191343	12/15/2011	COMMONWEALTH CONNECTIONS ACADEMY CHARTER/CYBER SCHOOLS- REG.ED.	47,259.37
191344	12/15/2011	COSI SCIENCE, EHN, INSTR/CERTIF.CONF.	230.00
191345	12/15/2011	JANINE CUEVAS VIRTUAL ACADEMY, TECH.SUP/SOFTW	30.00
191346	12/15/2011	DARLENE Y.CULLEN-ZEN VIRTUAL ACADEMY, TECH.SUP/SOFTW	30.00
191347	12/15/2011	CLAUDE S. CYPHERS, INC. GEN.MAINT., SUPPLIES	3.46
191348	12/15/2011	DELAWARE RIVER PRINTING & MARKETING SUPT., NEWSL/CALENDAR PRINTG.	8,950.00
191349	12/15/2011	DIANA M. DELEON VIRTUAL ACADEMY, TECH.SUP/SOFTW	30.00
191350	12/15/2011	IRENE DUGGINS CURR/FED., CERT/NON-INSTR.CONF.	259.76
191351	12/15/2011	EAST RIVER ENERGY SMI, CUST., OIL	38,344.33
191352	12/15/2011	EAST STROUDSBURG UNIVERSITY ATHL.TRAINER, JTL, CONT SERVICE	22,250.00
191353	12/15/2011	SCOTT ELDER Misc.Revenues-Bank Adj.Taxes	388.12
191354	12/15/2011	EPS/SCHOOL SPECIALTY LITERACY & ESE, INSTR, BOOKS/PERIODICALS	1,894.97
191355	12/15/2011	MARILYN ESPINOZA ACCOUNTABALITY, MILEAGE	114.33
191356	12/15/2011	EUREKA STONE QUARRY, INC. GEN.MAINT., LIS, PROPERTY SVC.	966.01
191357	12/15/2011	EXELON ENERGY COMPANY EHN, CUST., ELECTRIC	33,235.93
191358	12/15/2011	FRANTZ's TOUCH OF COLOR GEN.MAINT., EHS, SUPPLIES	513.81
191359	12/15/2011	FRONTIER EHS, CUST., TELEPHONE	5,842.11
191360	12/15/2011	FRONTIER EHN, CUST., TELEPHONE	2,036.76

Bank: 11 PNC Bank (Concentration)

Check no.	Check Date	Vendor name and comment	Amount
191361	12/15/2011	CAROL GEIGES BES, INST., IN-DISTRICT MILEAGE	5.83
191362	12/15/2011	SHARON J GERBERICH TAX COLLECTION, GEN. SUPPLIES	149.98
191363	12/15/2011	HEATHER GRESS JMH, INST, IN-DISTRICT MILEAGE	8.88
191364	12/15/2011	TRINDADE CAMARA TRANSPORTATION, IN-DIST. MILEAGE	26.50
191365	12/15/2011	GAIL HAMILTON SPEC. ED. SUPV., ELEM., MILEAGE	164.01
191366	12/15/2011	ALEXANDER HAMILTON INSTITUTE TRANSPORTATION, BOOKS/PERIOD.	26.50
191367	12/15/2011	ROBERT C. HARTMAN MUSIC, VOCAL, SMI, PROP. SERVICE	105.00
191368	12/15/2011	HILLTOP SALES & SERVICE JTL, CUST., SUPPLIES	6.24
191369	12/15/2011	HOME DEPOT CREDIT SERVICE GEN. MAINT., SEC., SUPPLIES	765.54
191370	12/15/2011	HOME DEPOT CREDIT SERVICE GEN. MAINT., ELEM., SUPPLIES	1,555.60
191371	12/15/2011	HOME DEPOT CREDIT SERVICE GEN. MAINT., SEC., SUPPLIES	1,518.93
191372	12/15/2011	DEBORAH IAPICHINO VIRTUAL ACADEMY, TECH. SUP/SOFTW	30.00
191373	12/15/2011	INTEGRAONE ITEC, MAINTAIN/UPGRADE INFOSYS	553.00
191374	12/15/2011	JAY & D COPY CENTER JTL, INSTR, SUPPLIES	350.91
191375	12/15/2011	CRAIG KARINJA VIRTUAL ACADEMY, TECH. SUP/SOFTW	30.00
191376	12/15/2011	PAMELA KITCHEN VIRTUAL ACADEMY, TECH. SUP/SOFTW	30.00
191377	12/15/2011	SCOTT KRUEGERS SHEET METAL GEN. MAINT., SUPPLIES	150.96
191378	12/15/2011	RONALD LABAR'S LOCK SERVICE EHN, CUST., SUPPLIES	84.00
191379	12/15/2011	BROOKE K LANGAN ITEC, IN-DISTRICT MILEAGE	103.79
191380	12/15/2011	LAWN AND GOLF SUPPLY CO., INC. GEN. MAINT., SUPPLIES	478.58
191381	12/15/2011	LEHIGH LEARNING ACADEMY 3RD, PART, ALT/SPEC ED. SEC. TUIT.	10,687.50
191382	12/15/2011	LOSER'S MUSIC, INC. MUSIC, VOCAL, RES, SUPPLIES	440.48
191383	12/15/2011	LVPA CHARTER/CYBER SCHOOLS- REG. ED.	1,576.62
191384	12/15/2011	LYNN CARD COMPANY ESE, PRIN., GENERAL SUPPLIES	116.95

Bank: 11 PNC Bank (Concentration)

Check no.	Check Date	Vendor name and comment	Amount
191385	12/15/2011	MANWALAMINK WATER COMPANY SMI, CUST., WATER/SEWER	551.98
191386	12/15/2011	MCGRAW-HILL INC. Shipping Cost	14.54
191387	12/15/2011	MET-ED MSE, CUST., ELECTRIC	1,689.16
191388	12/15/2011	MET-ED EHN, CUST., ELECTRIC	6,890.42
191389	12/15/2011	METCO TECH. ED., LIS, 7&8, BID SUPPLIES	300.38
191390	12/15/2011	METROPOLITAN MUSIC CO. OF PA MUSIC, VOCAL, JTL, PROPERTY SVC	108.00
191391	12/15/2011	DOROTHY E. MITCHELL REFUND OF PRIOR YEAR REVENUE	241.84
191392	12/15/2011	MODERN GAS SALES, INC. ESE, CUST., PROPANE (HEAT & A/C)	14,798.42
191393	12/15/2011	SAKINA MOHYUDDIN REFUND OF PRIOR YEAR REVENUE	925.00
191394	12/15/2011	MONROE COUNTY CONSERVATION DISTRICT SOC. STUDIES, JTL. CONT. SRV.	363.00
191395	12/15/2011	MORLEY ATHLETIC SUPPLY COMPANY, INC. GEN. ATHL., EHN, SUPPLIES	4,433.40
191396	12/15/2011	CHERYL L. MURPHY SPEC. ED. SUPV., ELEM., MILEAGE	20.26
191397	12/15/2011	NASCO (Quote # 4 5 9 5 0) ART, EHS, SUPPLIES	55.92
191398	12/15/2011	NATIONAL ATHLETIC TRAINER'S ASSOCIATION ATHL. TRAINER, EHS, DUES & FEES	249.00
191399	12/15/2011	NATIONAL COUNCIL OF TEACHERS CURRICULUM, DUES & FEES	144.00
191400	12/15/2011	NATIONAL GEOGRAPHIC TITLE III, BOOKS	249.39
191401	12/15/2011	NORTH POCONO BUS COMPANY, INC. TRANSP, CONTRACT, SEC, FIELD TRIP	701.00
191402	12/15/2011	HUGH O'BRIAN YOUTH LEADERSHIP GUIDANCE, EHS, DUES & FEES	350.00
191403	12/15/2011	OFFICE DEPOT BUSINESS OFFICE, GEN. SUPPLIES	1,789.11
191404	12/15/2011	OFFICE DIRECT, INC. ESE, PRIN., GENERAL SUPPLIES	15.00
191405	12/15/2011	OFFICE MAX INCORPORATED SCIENCE, EHS, SUPPLIES	227.36
191406	12/15/2011	OMNI PUBLISHING CO. SUPT., TECH SUPPLIES	96.95
191407	12/15/2011	OPDYKE'S SALES & SERVICE TRANSPORTATION, REPAIRS & PARTS	101.64
191408	12/15/2011	ORIENTAL TRADING BES, ACTIVITIES, SUPPLIES	111.99

Bank: 11 PNC Bank (Concentration)

Check no.	Check Date	Vendor name and comment	Amount
191409	12/15/2011	P & S GARAGE BAND, EHN, VEHICLE REPAIR/MAINT.	2,208.61
191410	12/15/2011	PA TREATMENT & HEALING 3RD. PART. ALT. ED. REG. SEC. TUITIO	211.53
191411	12/15/2011	PENNSYLVANIA VIRTUAL CHARTER SCHOOL CHARTER/CYBER SCHOOL-SPEC. ED.	15,891.89
191412	12/15/2011	PRAPTI PATEL JMH, PRIN., PROF. CONTRACT SVCS	54.00
191413	12/15/2011	PEARSON EDUCATION, INC. TITLE III, BOOKS	1,729.86
191414	12/15/2011	J.W. PEPPER & SONS-ACCT.#36-136400 MUSIC, INSTR, EHN, SUPPLIES	224.61
191415	12/15/2011	PETROLEUM TRADERS CORP. TRANSPORTATION, SOUTH, DIESEL	26,244.51
191416	12/15/2011	PICKEREL INN DRIVER ED., EHN, SUPPLIES	96.88
191417	12/15/2011	PITNEY BOWES LIS, PRIN., EQUIPMENT RENTAL	187.87
191418	12/15/2011	POCONO RECORD TRANSPORTATION, ADVERTISING	1,224.28
191419	12/15/2011	E.F. POSSINGER & SONS, INC. MAINT., EHN, PROPERTY SERVICE	2,460.00
191420	12/15/2011	POSTMASTER TAX COLLECTION, POSTAGE	220.00
191421	12/15/2011	PP&L EHS, CUST., ELECTRIC	99.59
191422	12/15/2011	PRUFROCK PRESS GIFTED, INT., SUPPLIES	24.90
191423	12/15/2011	PSADA GEN. ATHL., EHS, CERT/N-INST. CONF	345.00
191424	12/15/2011	PSBA INSURANCE TRUST BOARD SERVICE, LIABILITY INS.	355.00
191425	12/15/2011	QUILL CORPORATION MSE, PRIN., GENERAL SUPPLIES	260.30
191426	12/15/2011	ROBERT REISTAD VIRTUAL ACADEMY, TECH. SUP/SOFTW	30.00
191427	12/15/2011	CHARLES RICCIUTI VIRTUAL ACADEMY, TECH. SUP/SOFTW	30.00
191428	12/15/2011	CAROLINA RODRIGUEZ BUSINESS OFFICE, IN-DISTR. MILES	56.06
191429	12/15/2011	NOEL RODRIGUEZ VIRTUAL ACADEMY, TECH. SUP/SOFTW	30.00
191430	12/15/2011	ROBINSON RODRIGUEZ JR. ITEC, IN-DISTRICT MILEAGE	12.77
191431	12/15/2011	ROSEN CLASSROOM TITLE III, BOOKS	545.55
191432	12/15/2011	SAW SALES AND MACHINERY CO. TECH. ED., EHS, PROPERTY SERVICE	847.30

Bank: 11 PNC Bank (Concentration)

Check no.	Check Date	Vendor name and comment	Amount
191433	12/15/2011	SCHOOL NURSE SUPPLY INC. SPECIAL PROJECTS, GEN. SUPPLIES	771.45
191434	12/15/2011	SCHOOL SPECIALTY LEARN. SUP., ELEM, SUPPLIES	827.52
191435	12/15/2011	SCHUYLKILL VALLEY SPORTING GOODS BASKETBALL, EHS, GIRLS, SUPPLIES	1,416.50
191436	12/15/2011	DONATO SCOCOZZA VIRTUAL ACADEMY, TECH. SUP/SOFTW	30.00
191437	12/15/2011	SEVEN GENERATIONS CHARTER SCHOOL CHARTER/CYBER SCHOOLS- REG. ED.	1,576.62
191438	12/15/2011	SHAMOKIN AREA SCHOOL DISTRICT 3RD. PART/EMOT. SUP/PUBLIC/TUITI	8,116.20
191439	12/15/2011	RANDI SNOOK VIRTUAL ACADEMY, TECH. SUP/SOFTW	30.00
191440	12/15/2011	SRI MARUTI ENTERPRISES LLC EHN, CUST., GASOLINE	234.00
191441	12/15/2011	SUSAN STEAKIN ESE, INSTR, IN-DISTRICT MILEAGE	3.33
191442	12/15/2011	KIM STEVENS SPEC. ED. SUPV. INT. CONFERENCE	48.84
191443	12/15/2011	STRAND POOL SUPPLY, LLP EHS, CUST., SUPPLIES	1,480.40
191444	12/15/2011	HENRY K. & BETTY M. SWARTLEY REFUND OF PRIOR YEAR REVENUE	89.23
191445	12/15/2011	SWOREN'S TRANSMISSION & AUTO GEN. MAINT., PROPERTY SERVICES	346.80
191446	12/15/2011	TRI-STATE INDUSTRIAL LAUNDRIES INC. EHS, CUST., UNIFORM RENTAL	569.23
191447	12/15/2011	TRI-STATE INDUSTRIAL LAUNDRIES INC. EHN, CUST., UNIFORM RENTAL	633.48
191448	12/15/2011	TRI-STATE INDUSTRIAL LAUNDRIES INC. EHS, CUST., UNIFORM RENTAL	516.62
191449	12/15/2011	TRI-STATE INDUSTRIAL LAUNDRIES INC. MSE, CUST., UNIFORM RENTAL	33.08
191450	12/15/2011	ROBERT TUDOR VIRTUAL ACADEMY, TECH. SUP/SOFTW	30.00
191451	12/15/2011	UGI ENERGY SERVICES, INC. EHS, CUST., NATURAL GAS	8,184.72
191452	12/15/2011	EFRAIN ILLISIAH VARGAS VIRTUAL ACADEMY, TECH. SUP/SOFTW	30.00
191453	12/15/2011	RAMONA VAUGHN VIRTUAL ACADEMY, TECH. SUP/SOFTW	30.00
191454	12/15/2011	WILLIAM VITULLI JR ITEC, DIST, N-INSTR/N-CERT. CONF.	164.64
191455	12/15/2011	VWR SARGENT WELCH SCIENCE, EHN, SUPPLIES	1,273.73
191456	12/15/2011	WEIS MARKET, INC. F&CS, EHS, SUPPLIES	626.01

Bank: 11 PNC Bank (Concentration)

Check no.	Check Date	Vendor name and comment	Amount
191457	12/15/2011	WEST PAYMENT CENTER RES, PRIN., BOOKS/PERIODICALS	197.52
191458	12/15/2011	WHITMORE'S GARAGE GEN.MAINT., PROPERTY SERVICES	326.25
191459	12/15/2011	NICOLE WHITNEY BAND, EHS, PROF. CONTR. SVCS.	1,840.00
191460	12/15/2011	WOLFINGTON BODY COMPANY, INC. TRANSPORTATION, REPAIRS & PARTS	1,306.38
191461	12/15/2011	WOLFINGTON BODY COMPANY, INC. TRANSPORTATION, REPAIRS & PARTS	3,823.61
191462	12/15/2011	WOLFINGTON BODY COMPANY, INC. TRANSPORTATION, REPAIRS & PARTS	655.00
191463	12/15/2011	XEROX CORPORATION EHS, INSTR, EQUIPMENT RENTAL	1,062.47
191464	12/15/2011	YOUNG'S, INC. JTL, PRIN., GENERAL SUPPLIES	344.91
191465	12/15/2011	ZESWITZ MUSIC COMPANY MUSIC, VOCAL, BES, SUPPLIES	337.00
191466	12/15/2011	21ST CENTURY CYBER CHARTER SCHOOL CHARTER/CYBER SCHOOLS- REG.ED.	3,941.55
191467	12/15/2011	95 PERCENT GROUP INC. TL. I, READING, TEXTBOOKS	1,219.90
191468	12/21/2011	ABC TROPHIES, INC. BOARD SERVICE, SUPPLIES	286.20
191469	12/21/2011	ABD SMITHFIELD INC. Real Estate Refunds, Smithfld.	4,473.24
191470	12/21/2011	ADVANCED BUSINESS EQUIPMENT TECH.ED., EHN, PROPERTY SERVICE	195.00
191471	12/21/2011	AMERICAN CHORAL DIRECTORS ASSN. MUSIC, VOCAL, LIS, CERT. CONFERENC	225.00
191472	12/21/2011	APPLE COMPUTER, INC. JTL, INSTR. TECH. SUPPLY/SOFTWARE	392.95
191473	12/21/2011	ASSOCIATION FOR SUPERVISION AND JMH, PRIN., DUES & FEES	49.00
191474	12/21/2011	ASSOCIATION FOR SUPERVISION EHN, PRIN., DUES & FEES	49.00
191475	12/21/2011	ASPEN PEST SERVICES, LLC EHN, CUST., EXTERMINATION SERV.	675.88
191476	12/21/2011	BANDRIBBONS MUSIC, INSTR, EHN, SUPPLIES	286.00
191477	12/21/2011	BANKS' VACUUM SALES AND SERVICE BES, CUST., SUPPLIES	511.99
191478	12/21/2011	LORI J. BARRY TITLE III, CONFERENCES	75.00
191479	12/21/2011	BEARPORT PUBLISHING LIBRARY, SMI, BOOKS/PERIODICALS	1,568.61
191480	12/21/2011	LISA LEE BLOISE TRANSP, CONTR DRIVER, SPEC EDUC	3,894.00

Bank: 11 PNC Bank (Concentration)

Check no.	Check Date	Vendor name and comment	Amount
191481	12/21/2011	BOROUGH OF EAST STROUDSBURG EHS, CUST., WATER/SEWER	5,207.54
191482	12/21/2011	GEORGE CARAMELLA TRANSP, CONTR DRIVER, SPEC EDUC	2,744.94
191483	12/21/2011	BWP CARQUEST AUTO PARTS TRANSPORTATION, REPAIRS & PARTS	418.55
191484	12/21/2011	CERTIFIED CHEMICAL CO. JTL.CUST., REPAIR/MAINT.EQUIP.	265.00
191485	12/21/2011	TARA COLLINS TRANSPORTATION, PARENT TRANSPOR	754.80
191486	12/21/2011	COMMONWEALTH OF PA -USTIF TRANSPORTATION, DUES & FEES	3,300.00
191487	12/21/2011	COMPUTER DISCOUNT WAREHOUSE LIS, INSTR, TECH.SOFTWARE/SUPPLY	27,394.17
191488	12/21/2011	COMPUTER DISCOUNT WAREHOUSE LIS, 6TH, SOFTWARE/VIDEOS	2,069.16
191489	12/21/2011	REGINA CONNORS Misc.Revenues-Bank Adj.Taxes	20.00
191490	12/21/2011	CORELOGIC TAX SERVICES Misc.Revenues-Bank Adj.Taxes	106.31
191491	12/21/2011	CREATIVE COMPANY LIBRARY, SMI, BOOKS/PERIODICALS	1,551.79
191492	12/21/2011	JOSEPH CZAJKOWSKI SECURITY, JTL, IN-DIST.MILEAGE	24.98
191493	12/21/2011	CHRISTINE DAVIS TRANSP, CONTR DRIVER, SPEC EDUC	1,775.80
191494	12/21/2011	FRANCIS C. DISALVO TRANSPORTATION, REPAIRS & PARTS	127.95
191495	12/21/2011	SUSAN DREIBELBIS TITLE III, CONFERENCES	137.16
191496	12/21/2011	EAST RIVER ENERGY MSE, CUST., OIL	38,347.16
191497	12/21/2011	EATA, INC. ATHL. TRAIN., EHN, CERT/INST.CONF	125.00
191498	12/21/2011	SUSAN EDEN GIFTED, ELEM, MILEAGE	15.82
191499	12/21/2011	EDWARDS BUSINESS SYSTEMS LIS, PRIN., GENERAL SUPPLIES	372.56
191500	12/21/2011	EPLUS TECHNOLOGY, INC. GEN.ATHL., EHS, SUPPLIES	98.65
191501	12/21/2011	EXELON ENERGY COMPANY EHS, CUST., ELECTRIC	33,207.42
191502	12/21/2011	EXELON ENERGY COMPANY RES, CUST., ELECTRIC	4,704.26
191503	12/21/2011	FEDEX SPEC.ED.ADMIN., POSTAGE/TEL	139.69
191504	12/21/2011	CARLEEN FINK TRANSP, CONTR DRIVER, SPEC EDUC	4,323.55

Bank: 11 PNC Bank (Concentration)

Check no.	Check Date	Vendor name and comment	Amount
191505	12/21/2011	FIRST NATIONAL COMMUNITY BANK Misc.Revenues-Bank Adj.Taxes	2,417.53
191506	12/21/2011	FLAGSEXPRESS.COM RES, PRIN., GENERAL SUPPLIES	222.90
191507	12/21/2011	JOHN & LORI FRANCIS Misc.Revenues-Bank Adj.Taxes	10.75
191508	12/21/2011	MARIA FRASCELLA TRANSP, CONTR DRIVER, SPEC EDUC	3,986.62
191509	12/21/2011	JENNY GALUNIC TRANSP, CONTR DRIVER, SPEC EDUC	4,615.16
191510	12/21/2011	LISA GERST TRANSP, CONTR DRIVER, SPEC EDUC	2,057.66
191511	12/21/2011	ROSALYN R. GILMORE TRANSPORTATION, CONT.DRIVER	1,185.14
191512	12/21/2011	AILEEN GOODMAN REFUND OF PRIOR YEAR REVENUE	174.63
191513	12/21/2011	GROVE CITY AREA SCHOOL DISTRICT 3RD.PART/EMOT.SUP/PUBLIC/TUITI	1,860.75
191514	12/21/2011	ROBERT C HIND Misc.Revenues-Bank Adj.Taxes	1.91
191515	12/21/2011	DEBORAH HOLMES TRANSP, CONTR DRIVER, SPEC EDUC	2,702.92
191516	12/21/2011	JILL JENNINGS MID.SMITH., INST., TUITION REIM.	1,161.00
191517	12/21/2011	KAST-A-WAY SWIMWEAR SWIMMING, EHN, SUPPLIES	276.95
191518	12/21/2011	NEIL A. KJOS MUSIC COMPANY MUSIC, INSTR, EHN, SUPPLIES	4.50
191519	12/21/2011	DIANE KRUPSKI TRANSP, CONTR DRIVER, SPEC EDUC	6,190.88
191520	12/21/2011	GINA D. LABADIE TRANSP, CONTR DRIVER, SPEC EDUC	4,233.02
191521	12/21/2011	KARLA J LABAR TRANSPORTATION, CONT.DRIVER	8,739.06
191522	12/21/2011	CHRISTOPHER LASTRA TRANSP, CONTR DRIVER, SPEC EDUC	5,798.76
191523	12/21/2011	STEVEN LASTRA TRANSP, CONTR DRIVER, SPEC EDUC	3,133.16
191524	12/21/2011	CHRISTOPHER LYNCH MEDICAL SVCS., STAFF EXAM/TESTS	20.00
191525	12/21/2011	HUGH & DANA MAINO Misc.Revenues-Bank Adj.Taxes	34.90
191526	12/21/2011	KAMAL F MAKHOUL Real Estate Refunds, Mid.Smith	31.90
191527	12/21/2011	JENNIFER MALSCH TITLE III, CONFERENCES	75.00
191528	12/21/2011	JOSEPH P. MARTIN ITEC, IN-DISTRICT MILEAGE	87.14

Bank: 11 PNC Bank (Concentration)

Check no.	Check Date	Vendor name and comment	Amount
191529	12/21/2011	ELIZABETH MAZZEI GUIDANCE, EHN, TUITION REIMB.	375.00
191530	12/21/2011	CARA S. MCCORMICK LEARN. SUP., ELEM, TUITION REIMB.	2,322.00
191531	12/21/2011	TESHA MCDONALD TRANSPORTATION, PARENT TRANSPOR	466.20
191532	12/21/2011	MET-ED EHS, CUST., ELECTRIC	6,455.90
191533	12/21/2011	MONROE CAREER AND TECHNICAL INSTITUTE MCTI, HS-S, OPERATING BUDGET	155,517.00
191534	12/21/2011	MONROE FAMILY PRACTICE TRANSPORTATION, PROF. CONT. SERV	720.00
191535	12/21/2011	SHERRY MORRO SPEC. ED. SUPV., SEC., MILEAGE	195.36
191536	12/21/2011	PETER MUTI TRANSP, CONTR DRIVER, SPEC EDUC	1,784.82
191537	12/21/2011	NATIONAL ATHLETIC TRAINER'S ASSOCIATION ATHL. TRAINER, LIS, DUES & FEES	498.00
191538	12/21/2011	DEBORAH J. NIETZ BUSINESS OFF, N-CERT/N-INST.CON	81.70
191539	12/21/2011	NORTHEASTERN EDUCATIONAL I.U.19 DISTRICT COL. IU-AUTISTIC, CONTR.SRV.	11,476.26
191540	12/21/2011	JOHN O'ROURKE, JR. TRANSP, CONTR DRIVER, SPEC EDUC	3,856.82
191541	12/21/2011	ONLINE STORES INC. CUSTODIAL SVCS, SUPPLIES	589.72
191542	12/21/2011	PA ASSOC ELEM./SEC. SCHOOL PRINCIPALS JMH, PRIN., DUES & FEES	525.00
191543	12/21/2011	PENNSYLVANIA ONE CALL SYSTEM, INC. GEN.MAINT., PROPERTY SERVICES	57.27
191544	12/21/2011	PAFPC TL.1, NON-INST CERTIFIED, CONF	335.00
191545	12/21/2011	MANVEL R PAGE ITEC, IN-DISTRICT MILEAGE	38.30
191546	12/21/2011	LOUIS & KAREN PALLITO REFUNDS, PRIOR YEAR, MID. SM.	1,158.50
191547	12/21/2011	PASBO BUSINESS OFF, N-CERT/N-INST.CON	555.00
191548	12/21/2011	PATRIOT WORKWEAR SECURITY, EHN, SUPPLIES	3,293.00
191549	12/21/2011	PBS DISTRIBUTION, LLC SPEC. ED. ADMIN, SUPPLIES	104.65
191550	12/21/2011	PEARSON EDUCATION, INC. RES, INSTR, BOOKS/PERIODICALS	11,931.90
191551	12/21/2011	J.W.PEPPER & SONS-ACCT.#36-136400 MUSIC, INSTR, JTL, 6TH, SUPPLIES	986.99
191552	12/21/2011	PETROLEUM TRADERS CORP. TRANSPORTATION, NORTH, DIESEL	26,209.23

Bank: 11 PNC Bank (Concentration)

Check no.	Check Date	Vendor name and comment	Amount
191553	12/21/2011	PITNEY BOWES LIS, PRIN., EQUIPMENT RENTAL	187.87
191554	12/21/2011	PLAQUES & SUCH BAND, EHS, SUPPLIES	156.05
191555	12/21/2011	PRECISION SOLUTIONS INC. WRESTLING, EHS, PROPERTY SERVICE	478.65
191556	12/21/2011	BARBARA PREVOST TRANSP, CONTR DRIVER, SPEC EDUC	3,601.76
191557	12/21/2011	RAY PRICE STROUD FORD TRANSPORTATION, REPAIRS & PARTS	237.50
191558	12/21/2011	PSERS MSE, CUST., RETIREMENT	136.06
191559	12/21/2011	STEPHEN & ELIZABETH PURCELL Misc.Revenues-Bank Adj.Taxes	58.36
191560	12/21/2011	QUILL CORPORATION ESE, PRIN., GENERAL SUPPLIES	140.99
191561	12/21/2011	STEPHEN RAYMOND & DAWN LEWIS REFUNDS, PRIOR YEAR, SMITHF.	1,422.65
191562	12/21/2011	JOHN RENNA ITEC, IN-DISTRICT MILEAGE	58.83
191563	12/21/2011	RESEARCH PRESS SPEC.ED., ACCESS, ELEM, SUPPLIES	2,348.91
191564	12/21/2011	RESERVE ACCOUNT EHS, PRIN., POSTAGE/TELEPHONE	2,000.00
191565	12/21/2011	ALL AMERICAN/RIDDELL, INC. FOOTBALL, JTL, BID SUPPLIES	38.00
191566	12/21/2011	JANICE RODRIGUEZ TITLE III, CONFERENCES	141.60
191567	12/21/2011	DONNA L. ROTHWELL SPEC.ED., EM.SUP., SEC., TUIT.RM.	1,161.00
191568	12/21/2011	LISANDRA SANTIAGO TRANSPORTATION, PARENT TRANSPOR	932.40
191569	12/21/2011	SCHOLASTIC INC. CURRICULUM, ELEM, BOOKS/PERIOD.	54.20
191570	12/21/2011	SCHOOL HEALTH CORPORATION MEDICAL, JMH, SUPPLIES/FIRST AID	430.07
191571	12/21/2011	SCHOOL OUTFITTERS BUSINESS OFFICE, GEN.SUPPLIES	163.73
191572	12/21/2011	SCHOOL PRIDE GEN.ATHL., EHS, SUPPLIES	20.00
191573	12/21/2011	SCHOOL SPECIALTY PHYS.ED., EHS, SUPPLIES	3,882.07
191574	12/21/2011	SCHUYLKILL VALLEY SPORTING GOODS WRESTLING, JTL, SUPPLIES	1,574.75
191575	12/21/2011	MAUREEN G. SEIDEL CURR.DEV.TUITION REIMB.ELEM.	495.00
191576	12/21/2011	DESIREE SELINSKI TRANSPORTATION, PARENT TRANSPOR	2,163.61

Bank: 11 PNC Bank (Concentration)

Check no.	Check Date	Vendor name and comment	Amount
191577	12/21/2011	SEVEN GENERATIONS CHARTER SCHOOL CHARTER/CYBER SCHOOLS- REG.ED.	1,576.62
191578	12/21/2011	DOUGLAS L. SISKA TRANSP, CONTR DRIVER, SPEC EDUC	5,511.00
191579	12/21/2011	DUSTIN SISKA TRANSP, CONTR DRIVER, SPEC EDUC	4,726.26
191580	12/21/2011	A.J. SMITH ELECTRIC MOTOR SERVICE GEN.MAINT., SUPPLIES	150.00
191581	12/21/2011	DOROTHY A SOCHINSKY SECURITY, EHS, IN-DIST.MILEAGE	35.53
191582	12/21/2011	CHRISTOPHER SOLLIDAY MUSIC, VOCAL, EHS, PROPERTY SVC	120.00
191583	12/21/2011	SPORT SUPPLY GROUP, INC. MEDICAL, EHN, BID SUPPLIES	12.96
191584	12/21/2011	SHARON STOFIK TRANSP, CONTR DRIVER, SPEC EDUC	4,868.60
191585	12/21/2011	STROUDSBURG ELECTRIC MOTOR SERVICE GEN.MAINT., EHS, SUPPLIES	530.74
191586	12/21/2011	SUPER HEAT, INC. TRANSPORTATION, CONT. MAINT.	682.07
191587	12/21/2011	SWEETWATER SOUND, INC. MUSIC, VOCAL, MSE, SOFTWARE/VIDEO	49.99
191588	12/21/2011	TEAM EXPRESS SOFTBALL, LIS, SUPPLIES	822.65
191589	12/21/2011	JOYCELYN THOMAS TRANSPORTATION, PARENT TRANSPOR	341.88
191590	12/21/2011	PETER & RHONDA TIERNAN Misc.Revenues-Bank Adj.Taxes	436.64
191591	12/21/2011	UGI ENERGY SERVICES, INC. JMH, CUST., NATURAL GAS	3,466.40
191592	12/21/2011	UNITED WAY OF MONROE COUNTY Accounts Payable-Donations	289.21
191593	12/21/2011	KATHLEEN VARKADOS TRANSPORTATION, PARENT TRANSPOR	1,245.42
191594	12/21/2011	KATHARINE VITANZA TRANSP, CONTR DRIVER, SPEC EDUC	2,623.72
191595	12/21/2011	VWR SARGENT WELCH SCIENCE, EHN, SUPPLIES	66.00
191596	12/21/2011	DEMETRIUS & WENDY WALKER REFUNDS, PRIOR YEAR, SMITHF.	2,549.62
191597	12/21/2011	WAREHOUSE BATTERY OUTLET, INC. MSE, CUST., SUPPLIES	115.77
191598	12/21/2011	DR. SCOTT WATSON MUSIC, INSTR, SMI, PROF.CONTR.SVC	1,000.00
191599	12/21/2011	WEIS MARKET, INC. F&CS, JTL, SUPPLIES	341.51
191600	12/21/2011	MATTHEW WHITNEY MUSIC, INSTR, JTL, 6TH, DUES/FEES	96.00

Bank: 11 PNC Bank (Concentration)

Check no.	Check Date	Vendor name and comment	Amount
191601	12/21/2011	XEROX CORPORATION RYU419719	68.31
191602	12/21/2011	ZESWITZ MUSIC COMPANY MUSIC, INSTR, EHN, PROPERTY SVC	15.00
191603	12/21/2011	CHRISTINE ZIPP TITLE III, CONFERENCES	75.00
191604	12/21/2011	EAST STROUDSBURG School Service Personnel Dues	15,850.87
191605	12/21/2011	CHAPTER 13 TRUSTEE Miscellaneous Deductions	629.60
191606	12/21/2011	ED FOUNDATION OF ES/GENERAL FUND EDUC. FOUNDATION DEDUCTIONS	20.00
191607	12/21/2011	ED FOUNDATION OF ES/SCHOLARSHIP FUND EDUC. FOUNDATION DEDUCTIONS	13.00
191608	12/21/2011	E.S.E.A. ESEA Dues	28,398.00
191609	12/21/2011	EDUCATIONAL CREDIT MANAGEMENT CORP Miscellaneous Deductions	121.25
191610	12/21/2011	HAB-DLT (ER) Miscellaneous Deductions	472.96
191611	12/21/2011	NYSCSPC (NEW YORK STATE CHILD SUPPORT Miscellaneous Deductions	514.97
191612	12/21/2011	PENNSYLVANIA HIGHER EDUCATION AGENCY Miscellaneous Deductions	939.13
191613	12/21/2011	SOCIAL SECURITY ADMINISTRATION Miscellaneous Deductions	137.28
191614	12/21/2011	U.S. DEPARTMENT OF EDUCATION Miscellaneous Deductions	435.77
191615	12/21/2011	UNITED STATES TREASURY Miscellaneous Deductions	200.00
191616	12/21/2011	IRENE DUGGINS CURRICULUM, DEDUCTIBLE	158.00
191617	12/21/2011	DIANE L KELLY BUSINESS OFFICE, DEDUCTIBLE	25.00
191618	12/21/2011	SCHOOL CLAIMS-ASSURANT SUSPENSE ACCT., LIFE INSURANCE	11,929.76
191619	12/21/2011	SCHOOL CLAIMS-ASSURANT SUSPENSE ACCT., LTD INSURANCE	8,554.34
191620	12/21/2011	CYNTHIA SCHROEDER BUSINESS OFFICE, DEDUCTIBLE	25.00
191621	12/22/2011	GE MONEY BANK/AMAZON SCIENCE, EHS, BOOKS/PERIODICALS	519.45
			----- 2,243,846.23

**EAST STROUDSBURG AREA SCHOOL DISTRICT
CAPITAL PROJECTS - BOND FUND - 2011-2012**

Dec-11

DATE	PNC CONST	2008 PLGIT	2011A	2011D (QZAB)	TOTAL
Beg Bal	\$ 50,799.16	\$ 1,561,465.83	\$ 766,712.16	\$ 462,686.98	\$ 2,841,664.13
ADJ TO BEG BAL					\$ -
Deposit					\$ -
Transfers	\$ 422,748.79	\$ (301,651.29)	\$ (112,097.50)	\$ (9,000.00)	\$ -
Interest	\$ 10.98	\$ 23.14	\$ 11.63	\$ 7.35	\$ 53.10
Expense	\$ (405,176.03)				\$ (405,176.03)
End Bal	\$ 68,382.90	\$ 1,259,837.68	\$ 654,626.29	\$ 453,694.33	\$ 2,436,541.20

**EAST STROUDSBURG AREA SCHOOL DISTRICT
STATEMENT OF CASH / CAPITAL RESERVE FUND
2011-2012**

	<u>December 31, 2011</u>		<u>July 1, 2011</u> <u>December 31, 2011</u>		<u>Prior Year July 1, 2010 to June 30, 2011</u>	
Beginning Balance:		\$ 2,922,185.67		\$ 2,964,118.89		\$ 557,791.32
Adjustment to Beginning Balance						
Deposit:	\$ -		\$ 5,548.52		\$ 2,655,364.59	
Recoverable Bus Purchase:						
Reimbursement to/from G.F.			\$ -		0.00	
Reimbursement to/from PLGIT			\$ -		0.00	
Wolffington Bus Buy Back				5,548.52	0.00	2,655,364.59
Interest:						
PLGIT	\$ 39.35	39.35	402.07	402.07	420.50	420.50
TOTAL RECEIPTS		<u>39.35</u>		<u>5,950.59</u>		<u>2,655,785.09</u>
TOTAL RESOURCES		<u>\$ 2,922,225.02</u>		<u>\$ 2,970,069.48</u>		<u>\$ 3,213,576.41</u>
Disbursements:						
Transportation - New Buses			\$ -		0.00	
Due to General Fund			-		19,759.99	
Due to PLGIT			-		0.00	
Land Acquisition Costs			-		0.00	
'09 Water Main Break-JTL			-		0.00	
District Security - JTL			-		0.00	
District Security - HSN			-		0.00	
District Security - JM Hill			-		0.00	
District Security - Resica			-		0.00	
District Security - Bushkill			-		0.00	
District Security			-		32,197.66	
District Software			-		0.00	
District Tech Equipment			-		4,004.99	
Cust Supplies - Bushkill			-		7,620.00	
Land Imp. - JMH			-		2,961.21	
Maint. - BES			-		21,806.43	
Maint. - RES			12,700.00		12,478.70	
Maint. - JMH			28,994.55		44,549.02	
Maint. - MSE			-		0.00	
Maint. - SME			-		0.00	
Maint. - HSN			-		0.00	
Maint. - HSS			-		13,700.00	
Maint. - JTL			2,430.02		0.00	
Maint. - LEH			-		0.00	
Bldg Imp. - BSE			-		0.00	
Bldg Imp. - HSN			-		369.00	
Bldg Imp. - HSS			-		0.00	
Bldg Imp. - JMH			-		4,000.00	
Bldg Imp. - JTL			-		0.00	
Bldg Imp. - LIS			-		3,988.27	
Bldg Imp. - ESE			-		0.00	
Bldg Imp. - MSE			-		0.00	
Bldg Imp. - RES			-		2,558.81	
Site Imp. - Trans			-		0.00	
Site Imp. - District			-		0.00	
Site Imp. - BES			-		5,002.00	
Site Imp. - HSN			-		1,203.32	
Site Imp. - HSS			-		0.00	
Site Imp. - JMH	5,500.41		9,220.30		29,780.11	
Site Imp. - JTL			-		13,392.00	
Site Imp. -SME			-		0.00	
Site Imp. - RES			-		0.00	
Site Imp. - LIS			-		0.00	
Site Imp. - ESE			-		0.00	
Site Imp. - MSE			-		0.00	
		<u>5,500.41</u>		<u>53,344.87</u>	<u>30,086.01</u>	<u>249,457.52</u>
Ending Balance		<u>\$ 2,916,724.61</u>		<u>\$ 2,916,724.61</u>		<u>\$ 2,964,118.89</u>
Cash Summary:						
PLGIT	2,916,724.61		\$ 2,916,724.61		2,964,118.89	
Ending Balance		<u>\$ 2,916,724.61</u>		<u>\$ 2,916,724.61</u>		<u>\$ 2,964,118.89</u>

Bank: 21 PLGIT - Capital Reserve

Check no.	Check Date	Vendor name and comment	Amount
1176	12/09/2011	T&M ASSOCIATES SITE IMP.JMH,OTHER PROF.SERV.	5,500.41
			----- 5,500.41

End of Report - 13.12.32

**EAST STROUDSBURG AREA SCHOOL DISTRICT
STATEMENT OF CASH / GENERAL FUND
December 31, 2011**

	December 31, 2011		July 1, 2011 to December 31, 2011		Prior Year July 1, 2010 to June 30, 2011	
	\$	89,282,570.06	\$	41,537,563.17	\$	32,956,735.34
Beginning Balance:						
Adjustment to Beginning Balance						
Receipts:						
Earned Income Tax	\$	240,352.62		1,166,300.32	\$	3,054,067.42
Occupational Privilege Tax		4,638.59	\$	29,157.85		72,373.48
		244,991.21		1,185,458.17		3,127,340.80
Real Estate Transfer Tax:						
Monroe	\$	65,538.72		232,913.15	\$	410,415.09
Pike		7,580.23	73,118.96	48,159.18		152,268.18
				279,072.31		562,703.27
Delinquent Taxes:						
Monroe	\$	-		3,852,584.87	\$	5,457,823.82
Pike		-		1,328,188.76		1,656,302.83
				4,978,783.63		7,416,126.45
Real Estate Taxes:						
East Stroudsburg	\$	407,429.20		11,234,627.76	\$	11,069,838.21
Middle Smithfield		1,417,378.50		32,511,959.37		34,375,395.52
Price		475,480.18		6,024,155.83		5,943,973.44
Smithfield		874,508.58		16,407,951.17		18,302,431.11
Lehman		822,704.44		20,242,725.22		19,566,383.71
Porter		132,848.75	4,130,347.65	1,904,908.07		1,833,950.98
				88,326,327.22		88,111,972.95
Interest:						
PLGIT	\$	169.31		1,022.47	\$	4,036.10
PLGIT/PLUS		553.27		1,198.73		10,231.46
PLGIT/TERM		-		-		-
PLGIT/CD's		-		4,618.82		-
PSDLAF		5,181.47		22,541.72		62,064.06
PNC NOW		2,842.29		13,743.23		15,528.30
PNC MMA		-	8,726.34	-		1.20
				43,122.77		81,861.12
ACH State Transfers:						
Basic Ed	\$	1,403,432.92		4,815,916.92	\$	10,603,382.22
Alt Ed for Disr Yth		-		-		-
Charter School Tr		-		-		485,869.40
DEP		-		-		-
DCEd Anti Gang Initiative		-		-		-
Drivers Ed		-		-		-
Dual Enrollment		-		-		5,851.00
Education Assistance Grant		-		-		816,846.75
Health Reimb		-		164,847.33		171,307.00
Homebound		-		-		-
Incarcerated Ed		-		-		-
Lieu of Taxes		-		39,989.46		50,887.31
Colonial IU20 Refund		-		-		-
NP Transportation		58,905.00		60,485.31		153,574.69
NSLP Sub		216,981.73		550,661.18		1,635,842.13
OB/IO Excess Revenue - MCTI		-		-		153,177.35
PA Accountability Grant		-		504,703.00		1,284,600.00
Perf Incentives		-		-		-
Property Tax Relief		-		4,341,927.75		4,345,729.94
PURTA		-		133,733.60		123,660.27
Rental Subsidy		504,094.22		2,257,744.50		890,156.80
Retirement		605,556.22		1,117,788.61		1,927,054.97
School Improvement		-		-		-
SD Special Ed Funding		-		1,821,575.00		3,212,078.22
SD Transportation		1,277,582.00		1,561,489.00		3,379,597.75
Section 1305/1306		-		-		594,614.81
Social Security		166,179.17		1,269,787.57		2,752,074.37
Tuition Transfer		-		-		-
Vocational Ed-PDE		-		162,693.87		56,974.00
Vocational Ed-MCTI		-		-		-
Ward of State		-		-		27,562.12
WIA Summer Youth		4,232,731.26		-		14,991.00
				18,603,543.08		32,686,836.10
Federal Revenue:						
Access		-		564,866.23		554,001.50
Academic Achievement		-		-		5,400.00
ARRA - Fiscal Stabilization-Basic Ed		-		253,506.30		1,514,206.50
ARRA-IDEA		-		203,109.37		1,179,394.00
ARRA-Title I Part A Grant		-		-		134,360.00
ARRA-Title I School Improvement		-		-		82,210.82
Classrooms for the Future		-		-		-
Drug Free Schools		-		-		-
Grant		-		-		15,000.00
Impact Aid		173,471.00		429,254.00		455,815.00
IU 20 IDEA		-		56,596.04		1,607,411.37
Pregnant & Parent		-		-		-
Project 720 High School		-		-		-
Program Improvement-Set Aside		24,595.20		84,699.48		76,728.74
Title I		-		288,006.08		978,386.02
Title II		-		54,511.00		285,373.70
Title III		-		-		75,632.94
Title V		-		-		-
Title VI		198,066.20		-		-
				1,914,489.10		6,943,921.49
Other Revenue:						
Refunds		-		-	\$	5,750.22
Miscellaneous		18,419.84		30,032.12		100,080.10
Jury Duty Reimb		50.79		2,944.05		-
Local Grants		-		11,540.00		-
Bus Reimbursement-Outside ESASD		-		675.00		-
Donations		15.00		1,000.00		1,000.00
Parking Permits/Smoking Fines/Locker Fees/D's		-		2,232.22		2,394.75
Cell Tower		1,092.72		6,556.32		13,176.28
Online Summer School		-		18,459.00		15,540.00
Credit Recovery Program		185.00		1,295.00		185.00
Use of Facilities		-		3,953.22		61,159.80
Use of Facilities Deposit		-		783.00		-
QSCB Federal Subsidy		-		29,463.15		26,025.85
Restitutions		169.97		930.40		16,018.64
Settlement Proceeds		-		24.34		11,813.86
Shawnee Academy		19,933.32		1,420.51		1,177,935.19
				111,308.33		1,430,870.49

**EAST STROUDSBURG AREA SCHOOL DISTRICT
STATEMENT OF CASH / GENERAL FUND
December 31, 2011**

	December 31, 2011		July 1, 2011 to December 31, 2011		Prior Year July 1, 2010 to June 30, 2011	
Credit to Expense:						
Wage/Tuition Reimb	\$ 100.00		2,578.72		\$ 21,477.99	
Misc. Expense			93.83		-	
Cafeteria Reimb			150.00		64.00	
Misc. Reimb/Refunds	4,042.77		21,696.74		234,011.34	
Insurance Reimbursements	2,687.00		16,074.81		-	
Bus Reimbursement-Inside ESASD			6,325.00		-	
Custodian/Security Fees			-		-	
Donations			-		100.00	
Obligations	1,807.20		2,314.36		6,582.79	
Bond/Const. Fund to GF			3,087.50		1,760.00	
Capital Reserve to GF			-		19,274.99	
Concession Stand to GF			-		1,200.00	
Special/Student Activity to GF	925.00		1,352.00		12,220.17	
Sub Teacher Permits			530.00		535.00	
PayPal to GF			-		-	
Portnoff Fees			1,160.00		45,670.72	
MCTI			-		-	
Bus Buy-Back (Wolfington)			-		2,330,800.00	
Shawnee Reconciliation			-		-	
Blue Cross Pymt/COBRA	17,580.04	28,042.01	107,910.36	163,274.22	238,159.33	2,911,692.33
TOTAL RECEIPTS			<u>\$ 8,935,656.04</u>	<u>115,805,378.83</u>	<u>144,283,534.10</u>	
TOTAL RESOURCES			<u>\$ 88,218,527.00</u>	<u>157,142,942.00</u>	<u>177,240,269.44</u>	
Disbursements:						
Accounts Payable	5,040,587.05		28,316,128.85		55,093,278.33	
Payroll	3,186,680.28		19,876,993.88		42,147,229.36	
Investment Fees	843.20		4,427.47		1,256.43	
Prior Months Voids/Adj	(6,938.70)		(18,579.84)		(12,792.03)	
Accrued Interest			-		-	
1998A GOB Principal & Int			-		-	
1998AA GOB Principal & Int			-		-	
2000 GOB Principal & Int			-		-	
2001 GOB Principal & Int			-		-	
2001A GOB Principal & Int			-		-	
2001AA GOB Principal & Int			-		-	
2002 GOB Principal & Int			-		-	
2002A GOB Principal & Int			-		-	
2003 GOB Principal & Int			-		-	
2003A GOB - Principal & Int			-		-	
2004 GOB Principal & Int			-		-	
2004A GOB Principal & Int			379,900.00		568,475.00	
2005 GOB Principal & Int			-		-	
2005A GOB Principal & Int			-		-	
2006 GOB Principal & Int			-		2,176,437.02	
2007 GOB Principal & Int			-		-	
2007A GOB Principal & Int			1,818,823.75		7,355,210.00	
2008 GOB Principal & Int			2,550,000.00		2,300,000.00	
2009 GOB Principal & Int			811,341.25		1,617,782.50	
2009A GOB Principal & Int			67,937.50		68,025.00	
2009 GON Principal & Int			500,150.00		528,400.00	
2010 GOB Principal & Int			189,668.75		379,337.50	
2010A GOB Principal & Int			2,837,000.00		1,556,382.08	
2010A QSCB Principal & Int			773,481.25		320,176.85	
2011 GOB Principal & Int			35,500.00		26,941.67	
2011A GOB Principal & Int			411,879.23		-	
GOB CP \$37.5M			34,540.22		-	
Blue Cross Payment (EBTEP)	1,398,903.52		8,380,364.40		14,500,126.36	
Blue Cross Payment - Pioneer Credit Recovery Inc.			-		-	
Due to/from Capital Projects			-		-	
Due to/from Capital Reserves			-		2,602,240.00	
96 VRLP \$7M Principal, Int & Annual Trust Fee	5,283.56		32,549.08		444,931.37	
96 VRLP \$10M Principal, Int & Annual Trust Fee	7,223.39		44,500.49		664,308.83	
T.R.A.N. & Interest			-		-	
Bus Buy-Back (Wolfington)			-		-	
Balance:			<u>\$ 9,632,782.28</u>	<u>3,510,590.00</u>	<u>3,362,960.00</u>	<u>135,702,706.27</u>
			<u>\$ 88,585,744.72</u>	<u>88,585,744.72</u>	<u>41,537,583.17</u>	
CASH SUMMARY:						
PNC Bank - NOW	\$ 32,036,227.06		32,036,227.06		\$ 4,519,583.22	
PSDLAF	30,730,569.08		30,730,569.08		19,708,027.38	
PLGIT	16,067,097.72		16,067,097.72		11,275,101.73	
PLGIT/PLUS	5,042,850.88		5,042,850.88		5,042,850.88	
PLGIT/TERM			-		-	
PLGIT/CD	4,709,000.00		4,709,000.00		992,000.00	
Balance:			<u>\$ 88,585,744.72</u>	<u>-</u>	<u>68,585,744.72</u>	<u>41,537,583.17</u>

001 East Stroudsburg Area School District
 STATEMENT OF INCOME
 For the Period Ending October 31, 2011

CAFETERIA FUND

	Current Period	Year-to-Date	Account number
REVENUE FROM LOCAL SOURCES			
EARNINGS ON INVESTMENTS			
INTEREST ON INVESTMENTS	70.26	318.34	50-6510-000
TOTAL EARNINGS ON INVESTMENTS	70.26	318.34	
REVENUE FROM OPERATIONS			
SALES, LUNCH - PAID	78,840.70	163,928.80	50-6611-000
SALES, LUNCH - REDUCED	4,296.00	8,607.20	50-6612-000
SUMMER SALES - B-FAST & LUNCH	.00	1,002.46	50-6614-000
SALES, BREAKFAST - PAID	7,284.90	13,415.40	50-6615-000
SALES, BREAKFAST - REDUCED	845.40	1,558.80	50-6616-000
SALES, ADULT LUNCH	2,987.00	6,114.70	50-6620-000
SALES, A LA CARTE LUNCH	74,241.76	153,242.24	50-6621-000
MISCELLANEOUS-PEPSI COMMISSION	251.12	251.12	50-6622-000
MISC. WEBSITE COMMISSION	1,587.50	3,522.50	50-6625-000
SALES, IN-HOUSE-EVENTS	6,200.19	10,383.76	50-6630-000
TOTAL SALES	176,534.57	362,026.98	
TOTAL LOCAL REVENUE	176,604.83	362,345.32	
REVENUE FROM STATE SOURCES			
STATE SUBSIDY	17,438.28	35,413.91	50-7600-000
STATE SUBSIDY -SOCIAL SECURITY	4,068.57	8,448.92	50-7810-000
STATE SUBSIDY -RETIREMENT	9,107.31	13,867.97	50-7820-000
TOTAL STATE REVENUE	30,614.16	57,730.80	
REVENUE FROM FEDERAL SOURCES			
FEDERAL SUBSIDY	199,543.45	412,746.22	50-8530-000
TOTAL FEDERAL REVENUE	199,543.45	412,746.22	
INTERFUND TRANSFERS			
TOTAL INTERFUND TRANSFERS	.00	.00	
TOTAL CAFETERIA REVENUE	\$406,762.44	\$832,822.34	
EXPENSES OF OPERATIONS			
Salary, Manager	8,643.21	28,469.36	50-3100-110
SALARIES, SUMMER WORKERS	.00	2,555.61	50-3100-160
SALARIES, WORKERS	97,723.80	189,857.99	50-3100-170
MEDICAL INSURANCE	40,016.92	189,301.18	50-3100-210
LIFE INSURANCE	625.01	2,815.02	50-3100-213
LTD INSURANCE	159.20	633.47	50-3100-214
FICA OASDI	6,594.79	13,694.74	50-3100-220
FICA HI	1,542.34	3,202.95	50-3100-221
RETIREMENT	18,214.61	27,419.03	50-3100-230
UNEMPLOYMENT	.00	54.72	50-3100-250
WORKERS COMPENSATION	2,895.20	4,604.08	50-3100-260
PROFESSIONAL CONTRACT SERVICES	.00	480.00	50-3100-300
CONTRACT MAINTENANCE	1,271.53	5,086.12	50-3100-400
MAINTENANCE/REPAIRS	1,181.05	13,874.63	50-3100-430
AUTO INSURANCE	.00	1,242.47	50-3100-522
PRINTING EXPENSE	661.12	1,079.76	50-3100-550
CONF/TRAVEL/MILEAGE	833.18	833.18	50-3100-580
SUPPLIES, NON-FOOD	7,930.73	17,365.02	50-3100-610
TECHNOLOGY SUPPLIES	.00	3,265.68	50-3100-618
FUEL	305.87	898.47	50-3100-620
Food Purchases	65,510.26	104,738.16	50-3100-631
MILK PURCHASES	38,777.86	39,285.16	50-3100-632
DEPRECIATION OF EQUIPMENT	435.75	1,743.00	50-3100-741
DUES & FEES	.00	58.25	50-3100-810
PREPAY FEES	1,082.64	1,600.15	50-3100-811
TOTAL FOOD SERVICE EXPENSES	\$294,405.07	\$654,158.20	
Net Income / (Loss)	112,357.37	\$ 178,664.14	

Bank: 45 PNC BANK-CAFETERIA

Check no.	Check Date	Vendor name and comment	Amount
103618	10/11/2011	REISH FARM Food Purchases	200.00
103619	10/13/2011	AN-RAE SERVICES, INC. gloves	347.50
103620	10/13/2011	BOB COLIN SERVICE MAINTENANCE/REPAIRS	488.33
103621	10/13/2011	BUTTER KRUST BAKING CO. Food Purchases	3,598.70
103622	10/13/2011	CHEF ALICE COOKING Food for Thai Cooking Demo	75.00
103623	10/13/2011	ECOLAB SUPPLIES, NON-FOOD	1,526.59
103624	10/13/2011	FEESEER'S FOOD DISTRIBUTORS Food Purchases	19,923.86
103625	10/13/2011	MARYELLEN FINVER account refund 108514	11.70
103626	10/13/2011	DENISE A. FLYNN CONF/TRAVEL/MILEAGE	508.20
103627	10/13/2011	FRITO-LAY, INC. Food Purchases	3,497.73
103628	10/13/2011	KASA'S FOODS DIST CO INC. september	9,861.44
103629	10/13/2011	KEYCO DISTRIBUTORS INC. Food Purchases	228.00
103630	10/13/2011	SCOTT KRUEGERS SHEET METAL SUPPLIES, NON-FOOD	100.00
103631	10/13/2011	M & M REFRIGERATION & AIR CONDITIONING MAINTENANCE/REPAIRS	587.72
103632	10/13/2011	OFFICE DIRECT, INC. SUPPLIES, NON-FOOD	142.96
103633	10/13/2011	PEPSI-COLA Food Purchases	6,338.43
103634	10/13/2011	POCONO MOUNTAIN DAIRIES August - September	38,777.86
103635	10/13/2011	PAUL H. SCHMID CONF/TRAVEL/MILEAGE	324.98
103636	10/13/2011	SYSCO FOOD SERVICES OF CENTRAL PA Food Purchases	21,719.13
103637	10/13/2011	TASTY BAKING COMPANY (REMIT) Food Purchases	274.92
103638	10/13/2011	US FOODSERVICE, INC. Food Purchases	21,904.86
103639	10/13/2011	WEIS MARKETS, INC. STORE #158 8/21/11-9/24/11	49.45
103640	10/21/2011	AN-RAE SERVICES, INC. 43130	347.50
103641	10/21/2011	DELAWARE RIVER PRINTING & MARKETING 249,250	661.12

Bank: 45 PNC BANK-CAFETERIA

Check no.	Check Date	Vendor name and comment	Amount
103642	10/21/2011	M & M REFRIGERATION & AIR CONDITIONING #1130	105.00
103643	10/21/2011	MARCY KASHANSKY 135811	13.85
103644	10/21/2011	SELLERS FOOD GROUP 5569	1,011.15
			----- 132,625.98

End of Report - 13.49.19

001 East Stroudsburg Area School District
 STATEMENT OF INCOME
 For the Period Ending November 30, 2011

CAFETERIA FUND

	Current Period	Year-to-Date	Account number
REVENUE FROM LOCAL SOURCES			
EARNINGS ON INVESTMENTS			
INTEREST ON INVESTMENTS	74.62	392.96	50-6510-000
TOTAL EARNINGS ON INVESTMENTS	74.62	392.96	
REVENUE FROM OPERATIONS			
SALES, LUNCH - PAID	73,238.00	237,166.80	50-6611-000
SALES, LUNCH - REDUCED	3,841.60	12,448.80	50-6612-000
SUMMER SALES - B-FAST & LUNCH	.00	1,002.46	50-6614-000
SALES, BREAKFAST - PAID	7,078.30	20,493.70	50-6615-000
SALES, BREAKFAST - REDUCED	768.90	2,327.70	50-6616-000
SALES, ADULT LUNCH	3,367.00	9,481.70	50-6620-000
SALES, A LA CARTE LUNCH	66,107.05	219,349.29	50-6621-000
MISCELLANEOUS-PEPSI COMMISSION	.00	251.12	50-6622-000
MISC. WEBSITE COMMISSION	1,482.50	5,005.00	50-6625-000
SALES, IN-HOUSE-EVENTS	4,689.89	15,073.65	50-6630-000
TOTAL SALES	160,573.24	522,600.22	
TOTAL LOCAL REVENUE	160,647.86	522,993.18	
REVENUE FROM STATE SOURCES			
STATE SUBSIDY	15,994.14	51,408.05	50-7600-000
STATE SUBSIDY -SOCIAL SECURITY	4,344.46	12,793.38	50-7810-000
STATE SUBSIDY -RETIREMENT	4,911.93	18,779.90	50-7820-000
TOTAL STATE REVENUE	25,250.53	82,981.33	
REVENUE FROM FEDERAL SOURCES			
FEDERAL SUBSIDY	182,022.13	594,768.35	50-8530-000
TOTAL FEDERAL REVENUE	182,022.13	594,768.35	
TOTAL CAFETERIA REVENUE	\$367,920.52	\$1,200,742.86	
EXPENSES OF OPERATIONS			
Salary, Manager	8,678.61	37,147.97	50-3100-110
SALARIES, SUMMER WORKERS	.00	2,555.61	50-3100-160
SALARIES, WORKERS	103,832.50	293,690.49	50-3100-170
MEDICAL INSURANCE	50,970.74	240,271.92	50-3100-210
LIFE INSURANCE	308.18	3,123.20	50-3100-213
LTD INSURANCE	159.20	792.67	50-3100-214
FICA OASDI	7,041.90	20,736.64	50-3100-220
FICA HI	1,646.87	4,849.82	50-3100-221
RETIREMENT	10,140.75	37,559.78	50-3100-230
UNEMPLOYMENT	.00	54.72	50-3100-250
WORKERS COMPENSATION	1,626.78	6,230.86	50-3100-260
PROFESSIONAL CONTRACT SERVICES	.00	480.00	50-3100-300
CONTRACT MAINTENANCE	.00	5,086.12	50-3100-400
MAINTENANCE/REPAIRS	773.50	14,648.13	50-3100-430
AUTO INSURANCE	.00	1,242.47	50-3100-522
PRINTING EXPENSE	371.24	1,451.00	50-3100-550
CONF/TRAVEL/MILEAGE	847.70	1,680.88	50-3100-580
SUPPLIES, NON-FOOD	7,443.63	24,808.65	50-3100-610
TECHNOLOGY SUPPLIES	.00	3,265.68	50-3100-618
FUEL	442.14	1,340.61	50-3100-620
Food Purchases	116,185.08	220,923.24	50-3100-631
MILK PURCHASES	33,330.32	72,615.48	50-3100-632
DEPRECIATION OF EQUIPMENT	435.75	2,178.75	50-3100-741
DUES & FEES	.00	58.25	50-3100-810
PREPAY FEES	1,134.16	2,734.31	50-3100-811
TOTAL FOOD SERVICE EXPENSES	\$345,369.05	\$999,527.25	
Net Income/(Loss)	\$22,551.47	\$201,215.61	

Bank: 45 PNC BANK-CAFETERIA

Check no.	Check Date	Vendor name and comment	Amount
103645	11/02/2011	RICH PRODUCTS CORPORATION Food Purchases	1,652.00
103646	11/02/2011	DELAWARE RIVER PRINTING & MARKETING PRINTING EXPENSE	185.62
103647	11/02/2011	GOULD'S PRODUCE AND FARM MARKET inv. 1309 & 1408	388.00
103648	11/02/2011	KASA'S FOODS DIST CO INC. Food Purchases	1,751.76
103649	11/02/2011	M & M REFRIGERATION & AIR CONDITIONING invoices 1190 & 1138	459.00
103650	11/02/2011	WEIS MARKETS, INC. STORE #158 card #1644 107.40 & #1645 45.08	152.48
103651	11/10/2011	BUTTER KRUST BAKING CO. 10/01/11-10/31/11	4,363.44
103652	11/10/2011	FEESER'S FOOD DISTRIBUTORS Food Purchases	36,653.71
103653	11/10/2011	DENISE A. FLYNN commodity show and conference	847.70
103654	11/10/2011	FRITO-LAY, INC. Food Purchases	3,612.65
103655	11/10/2011	MONA HARTLE account refund 108412	15.45
103656	11/10/2011	KEYCO DISTRIBUTORS INC. Food Purchases	779.76
103657	11/10/2011	LOS CABOS Food Purchases	1,320.85
103658	11/10/2011	PEPSI-COLA Food Purchases	7,203.76
103659	11/10/2011	POCONO MOUNTAIN DAIRIES 10/01/11 to 10/30/11	33,330.32
103660	11/10/2011	SYSCO FOOD SERVICES OF CENTRAL PA Food Purchases	23,201.73
103661	11/10/2011	TASTY BAKING COMPANY (REMIT) Food Purchases	260.88
103662	11/10/2011	US FOODSERVICE, INC. Food Purchases	25,843.64
103663	11/17/2011	DELAWARE RIVER PRINTING & MARKETING PRINTING EXPENSE	185.62
103664	11/17/2011	GOULD'S PRODUCE AND FARM MARKET Food Purchases	150.00
103665	11/17/2011	KASA'S FOODS DIST CO INC. Food Purchases	8,985.48
103666	11/17/2011	M & M REFRIGERATION & AIR CONDITIONING MAINTENANCE/REPAIRS	314.50
103667	11/17/2011	MULLEN MARKETING, LLC Food Purchases	3,614.00
103668	11/17/2011	CHERYL M POPP acct refunds 121509 124142	14.80

Bank: 45 PNC BANK-CAFETERIA

Check no.	Date	Vendor name and comment	Amount
103669	11/17/2011	TASTY BRANDS, LLC Food Purchases	145.83
			----- 155,432.98

End of Report - 15.06.14

School TODAY THIS YEAR LAST YEAR			
	1/03/2012 - 1/03/2012				8/29/2011 - 1/03/2012				8/31/2010 - 6/06/2011			
	ADM	ADA	% Att	% Tdy	ADM	ADA	% Att	% Tdy	ADM	ADA	% Att	% Tdy
Intermediate Unit 20	63.10	63.10	100.00	.00	63.64	63.22	99.33	.00	66.51	65.46	98.40	.52
OOD Awaiting Place	11.00	11.00	100.00	.00	7.93	7.90	99.53	.00	1.74	1.72	99.04	.00
E Stroudsburg Elemen	727.00	727.00	100.00	.00	731.53	699.65	95.62	1.87	797.61	759.01	95.16	1.95
E Stroudsburg HS - S	1391.60	1269.60	91.23	1.65	1400.00	1302.91	93.08	3.70	1411.15	1298.54	92.05	4.17
JM Hill Elementary	397.50	371.40	93.43	1.51	392.39	372.96	95.00	3.19	373.04	351.31	94.22	2.88
Smithfield Elem	338.70	338.70	100.00	.00	338.52	322.20	95.17	2.25	357.02	335.71	94.02	2.34
Middle Smithfield El	526.00	486.00	92.40	.00	520.34	493.68	94.86	2.64	573.56	540.51	94.26	3.56
Lambert Intermediate	972.90	972.90	100.00	.00	969.85	918.88	94.68	2.35	991.05	930.48	93.89	2.81
Bushkill Elementary	510.10	450.10	88.24	.00	509.77	474.92	93.16	1.31	561.22	526.83	93.89	1.51
Lehman Intermediate	813.00	813.00	100.00	.00	809.63	760.20	93.86	1.29	805.71	758.00	94.09	1.51
ES Senior High North	1210.30	1210.30	100.00	.00	1209.53	1111.49	91.94	3.37	1220.63	1123.96	92.09	4.09
Resica Elementary	549.10	524.10	95.45	2.00	545.99	520.63	95.31	2.03	559.14	529.49	94.71	2.90
Shawnee Academy	.00	.00	.00	.00	.00	.00	.00	.00	36.15	36.15	100.00	.00
Bucks Cty IU 22	1.00	1.00	100.00	.00	1.00	1.00	100.00	.00	1.00	1.00	100.00	.00
Lehigh Cty Det Ctr	.00	.00	.00	.00	.13	.03	20.00	.00	.22	.22	100.00	.00
Chester Cty Prison	.00	.00	.00	.00	.00	.00	.00	.00	1.00	1.00	100.00	.00
Leh Val Hosp Adoles	.00	.00	.00	.00	.06	.00	.00	.00	.02	.00	.00	.00
Jefferson Center	2.00	2.00	100.00	.00	2.00	2.00	100.00	.00	1.00	1.00	100.00	.00
DTA	1.00	1.00	100.00	.00	.99	.99	100.00	.00	.43	.43	100.00	.00
La-Sa-Quik Resident	.00	.00	.00	.00	.00	.00	.00	.00	.36	.36	100.00	.00
Bradley Center	.00	.00	.00	.00	.48	.48	100.00	.00	1.00	1.00	100.00	.00
White Deer Treat Ctr	.00	.00	.00	.00	.00	.00	.00	.00	.12	.12	100.00	.00
Cornell Abraxas	2.00	2.00	100.00	.00	1.30	1.30	100.00	.00	1.30	1.30	100.00	.00
The Horsham Clinic	.00	.00	.00	.00	.00	.00	.00	.00	.33	.19	57.63	.00
Summit Quest Academy	.00	.00	.00	.00	.06	.06	100.00	.00	.03	.01	18.18	.00
Pyramid Behavioral	.00	.00	.00	.00	.00	.00	.00	.00	.12	.12	100.00	.00
Susquehanna House	.00	.00	.00	.00	.04	.04	100.00	.00	1.00	1.00	100.00	.00
Devereux Kanner Ctr	1.00	1.00	100.00	.00	1.00	1.00	100.00	.00	1.00	1.00	100.00	.00
Children's Home/Read	1.00	1.00	100.00	.00	1.00	.99	98.75	.00	.10	.08	83.33	.00
BLAST 17 WELLSBORO	.00	.00	.00	.00	.04	.00	.00	.00	.41	.41	100.00	.00
Pike Co Corrections	1.00	1.00	100.00	.00	1.06	1.03	96.47	.00	.31	.31	100.00	.00
Children's Svc Ctr	.00	.00	.00	.00	.00	.00	.00	.00	.12	.12	100.00	.00
La Sa Quik	2.00	2.00	100.00	.00	1.28	1.27	99.02	.00	.66	.66	100.00	.00
KidsPeace (Tutorial)	.00	.00	.00	.00	.53	.41	75.82	.00	1.11	1.03	93.47	.00
N Central Treatment	1.00	1.00	100.00	.00	1.00	1.00	100.00	.00	.79	.79	100.00	.00
Northwestern Academy	5.00	5.00	100.00	.00	5.13	5.08	99.02	.00	3.91	3.89	99.57	.00
Youth Services Agenc	4.00	4.00	100.00	.00	4.44	4.37	98.59	.56	4.08	4.08	100.00	.00
Vision Quest(Waynes)	1.00	1.00	100.00	.00	1.00	1.00	100.00	.00	2.40	2.40	100.00	.00
GeorgeJr Repub Grove	2.00	2.00	100.00	.00	1.95	1.95	100.00	.00	1.00	1.00	100.00	.00
Glen Mills School	1.00	1.00	100.00	.00	1.00	1.00	100.00	.00	1.62	1.62	100.00	.00
Pittsburgh Job Corps	.00	.00	.00	.00	.00	.00	.00	.00	1.00	1.00	100.00	.00
Cyber Charter School	214.00	214.00	100.00	.00	211.22	210.44	99.62	.00	224.50	223.58	99.58	.00
TOTAL:	7749.30	7476.20	96.48	.52	7735.83	7284.08	94.15	2.47	8005.47	7506.89	93.78	2.86